



STATE OF NORTH CAROLINA  
DEPARTMENT OF TRANSPORTATION

MICHAEL F. EASLEY  
GOVERNOR

Wednesday, June 18, 2008

LYNDO TIPPETT  
SECRETARY

**MEMORANDUM TO:** Mr. C.E. Lassiter, PE  
Division Engineer  
Division 2

**FROM:** Information, Mapping, and Graphics Unit

**SUBJECT:** 2008 District 2 Road System Changes

The Road Inventory Information Section has been authorized to make the following changes to the state road system as indicated below. We request that you make similar changes to the related maps and files in your Division and District offices, and install appropriate road number signs if necessary. We have updated our records and county maps accordingly. If our system changes do not conform to the actual conditions in the field, please return this memorandum with recommendations.

Petition Number	County	Approval Date
48602	CARTERET	4/3/2008

Inquires about changes should be referred to one of the following: Ron Tucker at (919) 212-6080 or Tom Schroder at (919) 212-6090. If you have further questions, please contact Hardee Cox, Road Inventory Information Section Manager at (919) 212-6060. Thank you for your assistance.

HRC  
enclosures ( )

- cc: BSIP
- Bridge Maintenance
- Division Right of Way
- GIS
- Pavement Management
- Permit Unit
- State Road Maintenance
- Traffic Engineering
- Traffic Surveys

**MAILING ADDRESS:**  
NC DEPARTMENT OF TRANSPORTATION  
INFORMATION, MAPPING AND GRAPHICS UNIT  
1587 MAIL SERVICE CENTER  
RALEIGH NC 27699-1587

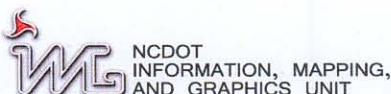

**LOCATION:**  
3401 CARL SANDBURG CT.  
RALEIGH, NC 27610

# 2008 ROAD SYSTEM CHANGES

PETITION NUMBER	COUNTY	APPROVAL DATE	NEW NUMBER	EXISTING NUMBER	STREET NAME	LENGTH (miles)	TYPE OF CHANGE	REMARKS (See Attached Map)
48602	CARTERET	4/3/2008	SR 1491		HIDDEN HARBOR LANE	0.25	SYSTEM ADDITION VIA PETITION	MAP , SEGMENT
48602	CARTERET	4/3/2008	SR 1490		SANDY HUSS DRIVE	0.22	SYSTEM ADDITION VIA PETITION	MAP , SEGMENT

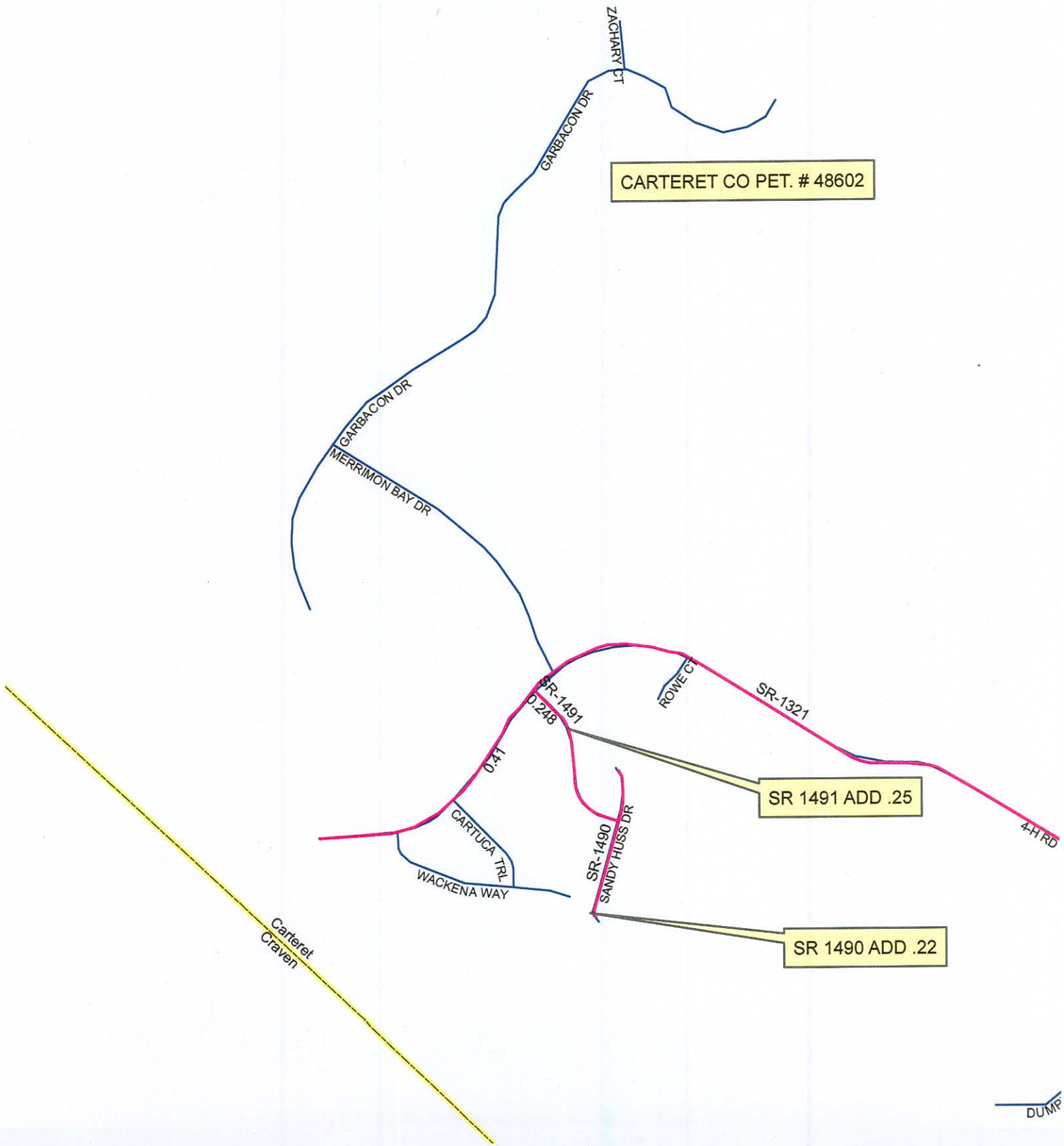

CARTERET CO PET. # 48602

SR-1491  
0.248

SR-1321

SR 1491 ADD .25

SR 1490 ADD .22

SR-1490  
SANDY HUSS DR

CARTUCA TRL  
WACKENA WAY

ROWE CT

GARBACON DR

MERRIMON BAY DR

GARBACON DR

ZACHARY CT

Carteret  
Craven

DUMP