



STATE OF NORTH CAROLINA  
DEPARTMENT OF TRANSPORTATION

MICHAEL F. EASLEY  
GOVERNOR

February 26, 2008

LYNDO TIPPETT  
SECRETARY

**MEMORANDUM TO:** Mr. J. Wally Bowman , PE  
Division Engineer  
Division 5

**FROM:** Information, Mapping, and Graphics Unit

**SUBJECT:** 2008 District 2 Road System Changes

The Road Inventory Information Section has been authorized to make the following changes to the state road system as indicated below. We request that you make similar changes to the related maps and files in your Division and District offices, and install appropriate road number signs if necessary. We have updated our records and county maps accordingly. If our system changes do not conform to the actual conditions in the field, please return this memorandum with recommendations.

Petition Number	County	Approval Date
48557	DURHAM	2/6/2008

Inquires about changes should be referred to one of the following: Ron Tucker at (919) 212-6080 or Tom Schroder at (919) 212-6090. If you have further questions, please contact Hardee Cox, Road Inventory Information Section Manager at (919) 212-6060. Thank you for your assistance.

HRC  
enclosures ( )

cc: BSIP  
Bridge Maintenance  
Division Right of Way  
GIS  
Pavement Management  
Permit Unit  
State Road Maintenance  
Traffic Engineering  
Traffic Surveys

**MAILING ADDRESS:**  
NC DEPARTMENT OF TRANSPORTATION  
INFORMATION, MAPPING AND GRAPHICS UNIT  
1587 MAIL SERVICE CENTER  
RALEIGH NC 27699-1587

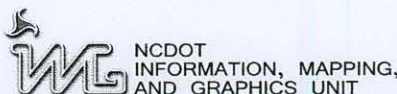

**LOCATION:**  
3401 CARL SANDBURG CT.  
RALEIGH, NC 27610

# 2008 ROAD SYSTEM CHANGES

PETITION NUMBER	COUNTY	APPROVAL DATE	NEW NUMBER	EXISTING NUMBER	STREET NAME	LENGTH (miles)	TYPE OF CHANGE	REMARKS (See Attached Map)
48557	DURHAM	2/6/2008		SR 1989	EAST INSTITUTE DR	0.06	SYSTEM DELETION VIA PETITION	MAP , SEGMENT



PETITION: 48557

CO: Durham

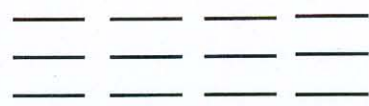
SR #: 1989



Approval Date: 06 Feb. 08 Map Date: 26 Feb. 08

 Addition  
 Deletion  
 Reassignment

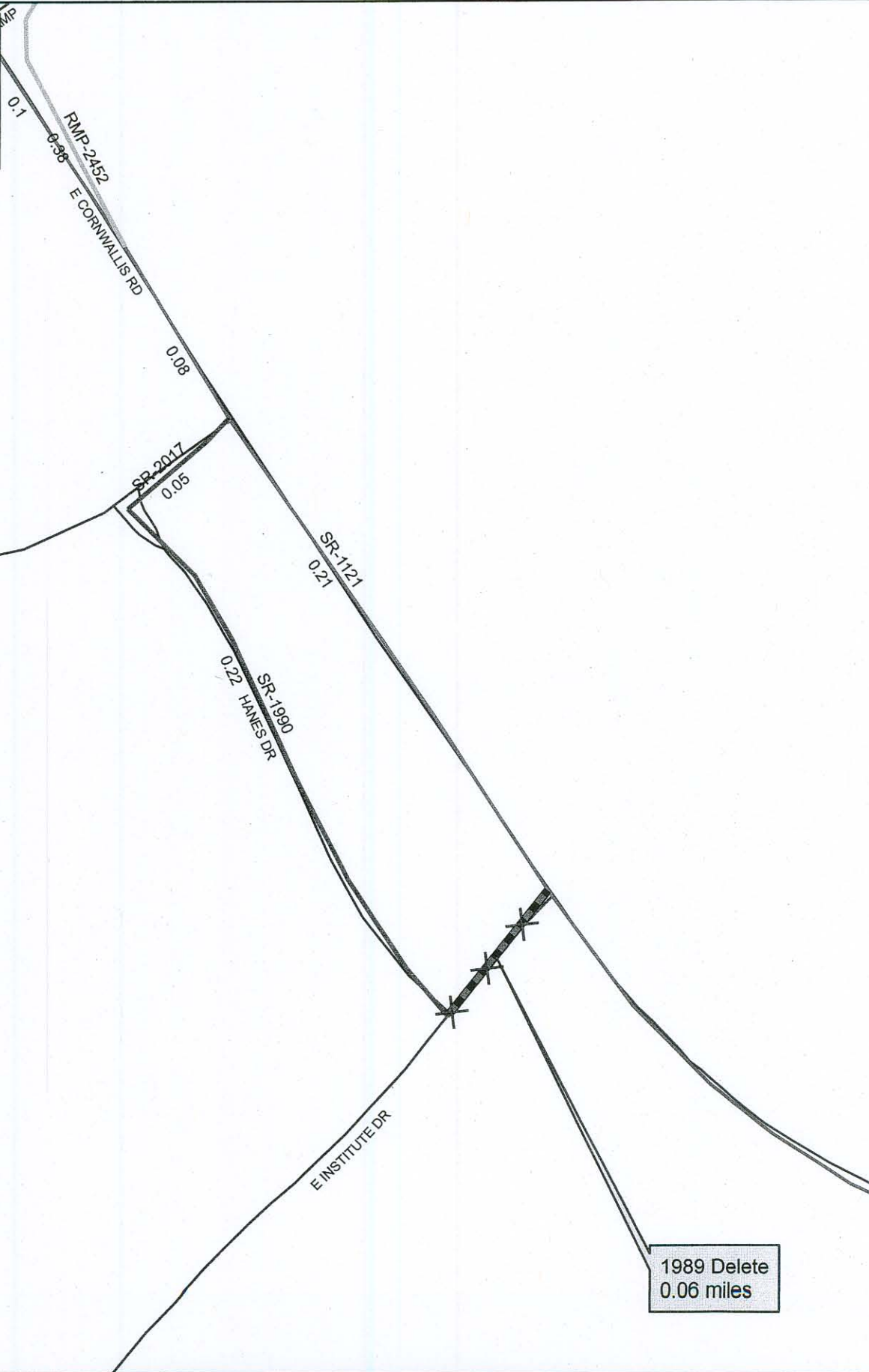

1989 Delete  
0.06 miles

Source: Plat

NAME: RBT

SCALE: XXX

Map: A