



STATE OF NORTH CAROLINA  
DEPARTMENT OF TRANSPORTATION

BEVERLY EAVES PERDUE  
GOVERNOR

Monday, November 16, 2009

EUGENE A. CONTI, JR.  
SECRETARY

**MEMORANDUM TO:** Mr. Mike Mills, PE  
Division Engineer  
Division 7

**FROM:** John C. Farley, Manager  
Geographic Information Systems Unit

**SUBJECT:** 2009 District 2 Road System Changes

The Data Conversion Group has been authorized to make the following changes to the state road system as indicated below. We request that you make similar changes to the related maps and files in your Division and District offices, and install appropriate road number signs if necessary. We have updated our records accordingly. If our system changes do not conform to the actual conditions in the field, please return this memorandum with recommendations.

Document Number	County	Approval Date
U-2717	GUILFORD	1/9/2008

Inquiries about changes should be referred to the GIS Help Desk at (919) 707-2152.  
Thank you for your assistance.

JCF

cc: BSIP  
Bridge Maintenance  
Division Right of Way  
IMG  
Pavement Management  
Permit Unit  
State Road Maintenance  
Traffic Engineering  
Traffic Surveys

**MAILING ADDRESS:**  
NC DEPARTMENT OF TRANSPORTATION  
GEOGRAPHIC INFORMATION SYSTEMS  
1521 MAIL SERVICE CENTER  
RALEIGH NC 27699-1521

  
NC DOT  
WWW.NC DOT.ORG/IT/GIS







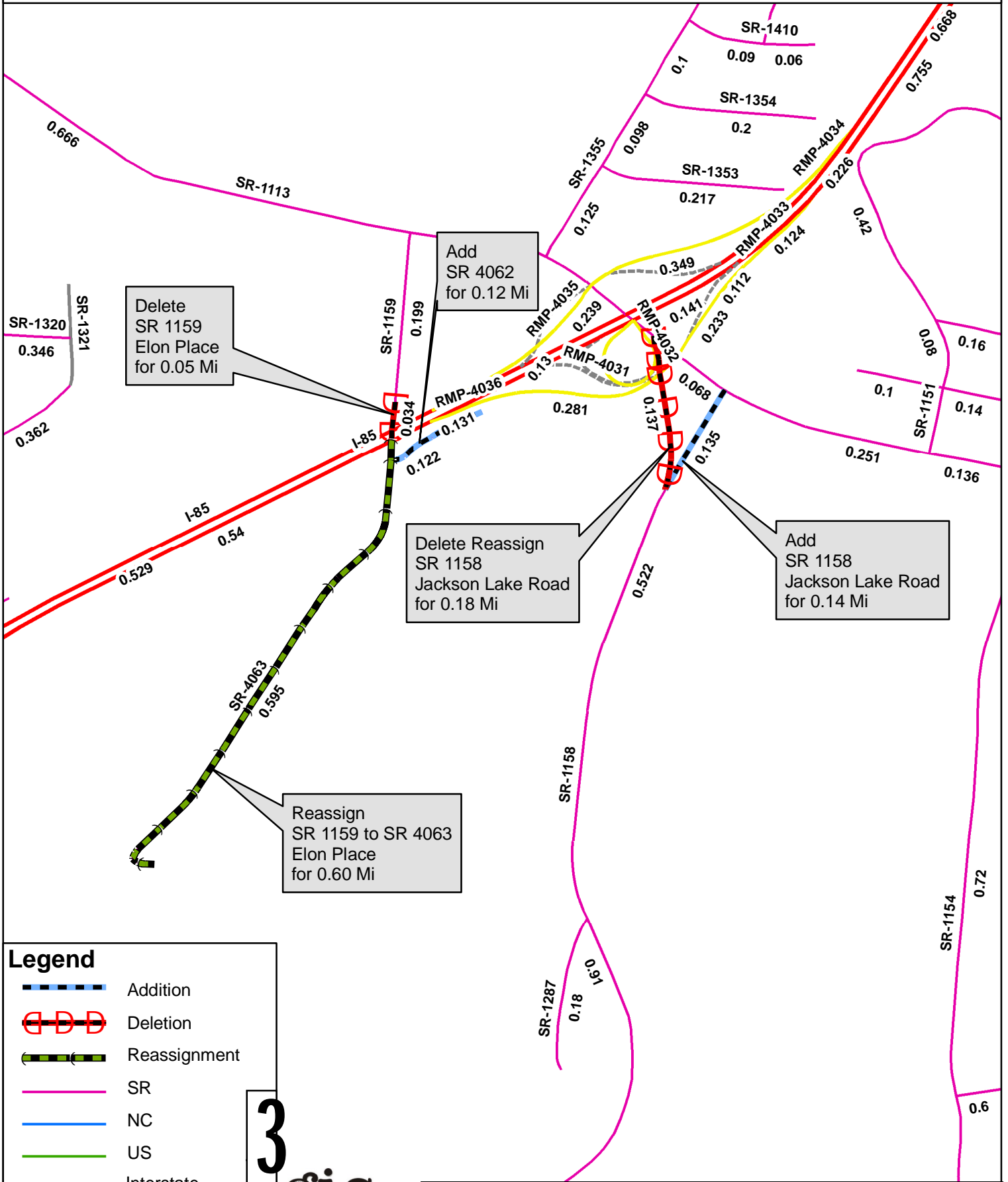

**Delivery Address:**  
41 01 CAPITAL BLVD.  
RALEIGH, NC 27604  
PHONE: (919) 707-2152  
FAX: (919) 707-2214

# 2009 ROAD SYSTEM CHANGES

<b>DOCUMENT NUMBER</b>	<b>COUNTY</b>	<b>APPROVAL DATE</b>	<b>NEW NUMBER</b>	<b>EXISTING NUMBER</b>	<b>STREET NAME</b>	<b>LENGTH (miles)</b>	<b>TYPE OF CHANGE</b>	<b>REMARKS (See Attached Map)</b>
U-2717	GUILFORD	1/9/2008	SR 4063	SR 1159	ELON PLACE	0.60	NUMBER REASSIGNMENT VIA TIP	MAP , SEGMENT
U-2717	GUILFORD	1/9/2008	SR 4062			0.12	SYSTEM ADDITION - NEW VIA TIP	MAP , SEGMENT
U-2717	GUILFORD	1/9/2008		SR 1159	ELON PLACE	0.05	SYSTEM DELETION VIA TIP	MAP , SEGMENT
U-2717	GUILFORD	1/9/2008		SR 1158	JACKSON LAKE ROAD	0.18	SYSTEM DELETION VIA TIP	MAP , SEGMENT
U-2717	GUILFORD	1/9/2008		SR 1158	JACKSON LAKE ROAD	0.14	SYSTEM ADDITION - EXISTING VIA TIP	MAP , SEGMENT



**Legend**

-  Addition
-  Deletion
-  Reassignment
-  SR
-  NC
-  US
-  Interstate
-  Ramp

