



STATE OF NORTH CAROLINA  
DEPARTMENT OF TRANSPORTATION

MICHAEL F. EASLEY  
GOVERNOR

December 20, 2007

LYNDO TIPPETT  
SECRETARY

**MEMORANDUM TO:** Mr. Michael L. Holder, PE  
Division Engineer  
Division 12

**FROM:** Information, Mapping, and Graphics Unit

**SUBJECT:** 2007 District 2 Road System Changes

The Road Inventory Information Section has been authorized to make the following changes to the state road system as indicated below. We request that you make similar changes to the related maps and files in your Division and District offices, and install appropriate road number signs if necessary. We have updated our records and county maps accordingly. If our system changes do not conform to the actual conditions in the field, please return this memorandum with recommendations.

Petition Number	County	Approval Date
48489	IREDELL	12/6/2007

Inquires about changes should be referred to one of the following: Ron Tucker at (919) 212-6080 or Tom Schroder at (919) 212-6090. If you have further questions, please contact Hardee Cox, Road Inventory Information Section Manager at (919) 212-6060. Thank you for your assistance.

HRC  
enclosures ( )

cc: BSIP  
Bridge Maintenance  
Division Right of Way  
GIS  
Pavement Management  
Permit Unit  
State Road Maintenance  
Traffic Engineering  
Traffic Surveys

**MAILING ADDRESS:**  
NC DEPARTMENT OF TRANSPORTATION  
INFORMATION, MAPPING AND GRAPHICS UNIT  
1587 MAIL SERVICE CENTER  
RALEIGH NC 27699-1587

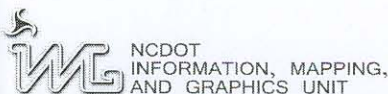

**LOCATION:**  
3401 CARL SANDBURG CT.  
RALEIGH, NC 27610

# 2007 ROAD SYSTEM CHANGES

<b>PETITION NUMBER</b>	<b>COUNTY</b>	<b>APPROVAL DATE</b>	<b>NEW NUMBER</b>	<b>EXISTING NUMBER</b>	<b>STREET NAME</b>	<b>LENGTH (miles)</b>	<b>TYPE OF CHANGE</b>	<b>REMARKS (See Attached Map)</b>
48489	IREDELL	12/6/2007	SR 3190		COMET TRAIL	0.28	SYSTEM ADDITION VIA PETITION	MAP , SEGMENT

PETITION: 48489

CO: IREDELL



SR #: 3190

Approval Date: 12/06/07

Map Date: 12/20/07



SR-1005  
0.91

	Addition
	Deletion
	Reassignment

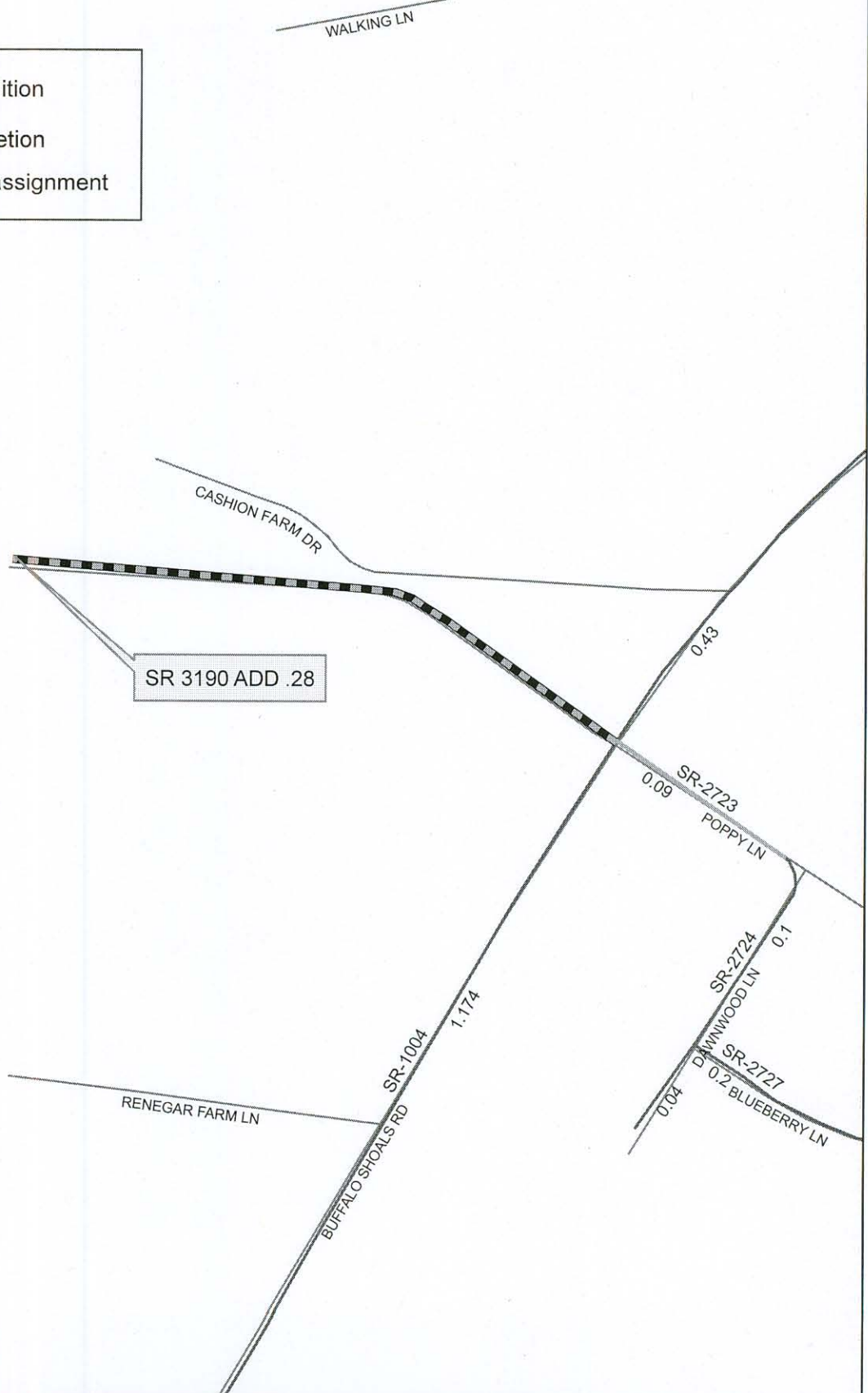

Source: XXXXXXXXX

NAME: GBW

SCALE: XXX

Map: X