



STATE OF NORTH CAROLINA
DEPARTMENT OF TRANSPORTATION

BEVERLY EAVES PERDUE
GOVERNOR

Friday, December 18, 2009

EUGENE A. CONTI, JR.
SECRETARY

MEMORANDUM TO: Mr. J. Wally Bowman, PE
Division Engineer
Division 5

FROM: John C. Farley, Manager
Geographic Information Systems Unit

SUBJECT: 2009 District 2 Road System Changes

The Data Conversion Group has been authorized to make the following changes to the state road system as indicated below. We request that you make similar changes to the related maps and files in your Division and District offices, and install appropriate road number signs if necessary. We have updated our records accordingly. If our system changes do not conform to the actual conditions in the field, please return this memorandum with recommendations.

| Document Number | County | Approval Date |
|-----------------|--------|---------------|
| I-0306DB | DURHAM | 10/5/2007 |

Inquiries about changes should be referred to the GIS Help Desk at (919) 707-2152.
Thank you for your assistance.

JCF

cc: BSIP
Bridge Maintenance
Division Right of Way
IMG
Pavement Management
Permit Unit
State Road Maintenance
Traffic Engineering
Traffic Surveys

MAILING ADDRESS:
NC DEPARTMENT OF TRANSPORTATION
GEOGRAPHIC INFORMATION SYSTEMS
1521 MAIL SERVICE CENTER
RALEIGH NC 27699-1521



NCDOT
WWW.NC DOT.ORG/IT/GIS

Delivery Address:
41 01 CAPITAL BLVD.
RALEIGH, NC 27604
PHONE: (919) 707-2152
FAX: (919) 707-2214

2009 ROAD SYSTEM CHANGES

| DOCUMENT NUMBER | COUNTY | APPROVAL DATE | NEW NUMBER | EXISTING NUMBER | STREET NAME | LENGT H | TYPE OF CHANGE | REMARKS (See Attached Map) |
|-----------------|--------|---------------|------------|-----------------|--------------|---------|--|-------------------------------|
| I-0306DB | DURHAM | 10/5/2007 | | US 501 | N DUKE ST | 0.13 | SYSTEM DELETION VIA TIP | MAP A, SEGMENT 1 |
| I-0306DB | DURHAM | 10/5/2007 | | US 501 NBL | N DUKE ST | 0.13 | SYSTEM ADDITION - EXISTING VIA TIP | MAP B, SEGMENT 1 |
| I-0306DB | DURHAM | 10/5/2007 | | SR 1327 | N GREGSON ST | 0.19 | SYSTEM DELETION VIA TIP | MAP C, SEGMENT 1 |
| I-0306DB | DURHAM | 10/5/2007 | | SR 1327 NBL | N GREGSON ST | 0.27 | SYSTEM ADDITION - EXISTING VIA TIP | MAP D, SEGMENT 1 |
| I-0306DB | DURHAM | 10/5/2007 | | US 501 SBL | N GREGSON ST | 0.11 | SYSTEM ADDITION - EXISTING VIA TIP | MAP B, SEGMENT 2 |
| I-0306DB | DURHAM | 10/5/2007 | | SR 1445 | N DUKE ST | 0.11 | SYSTEM DELETION VIA TIP | MAP C, SEGMENT 2 |
| I-0306DB | DURHAM | 10/5/2007 | | SR 1327 SBL | N GREGSON ST | 0.26 | SYSTEM ADDITION - EXISTING VIA TIP | MAP D, SEGMENT 2 |
| I-0306DB | DURHAM | 10/5/2007 | | SR 1445 | N DUKE ST | 0.11 | SYSTEM ADDITION - EXISTING VIA TIP | MAP D, SEGMENT 3 |

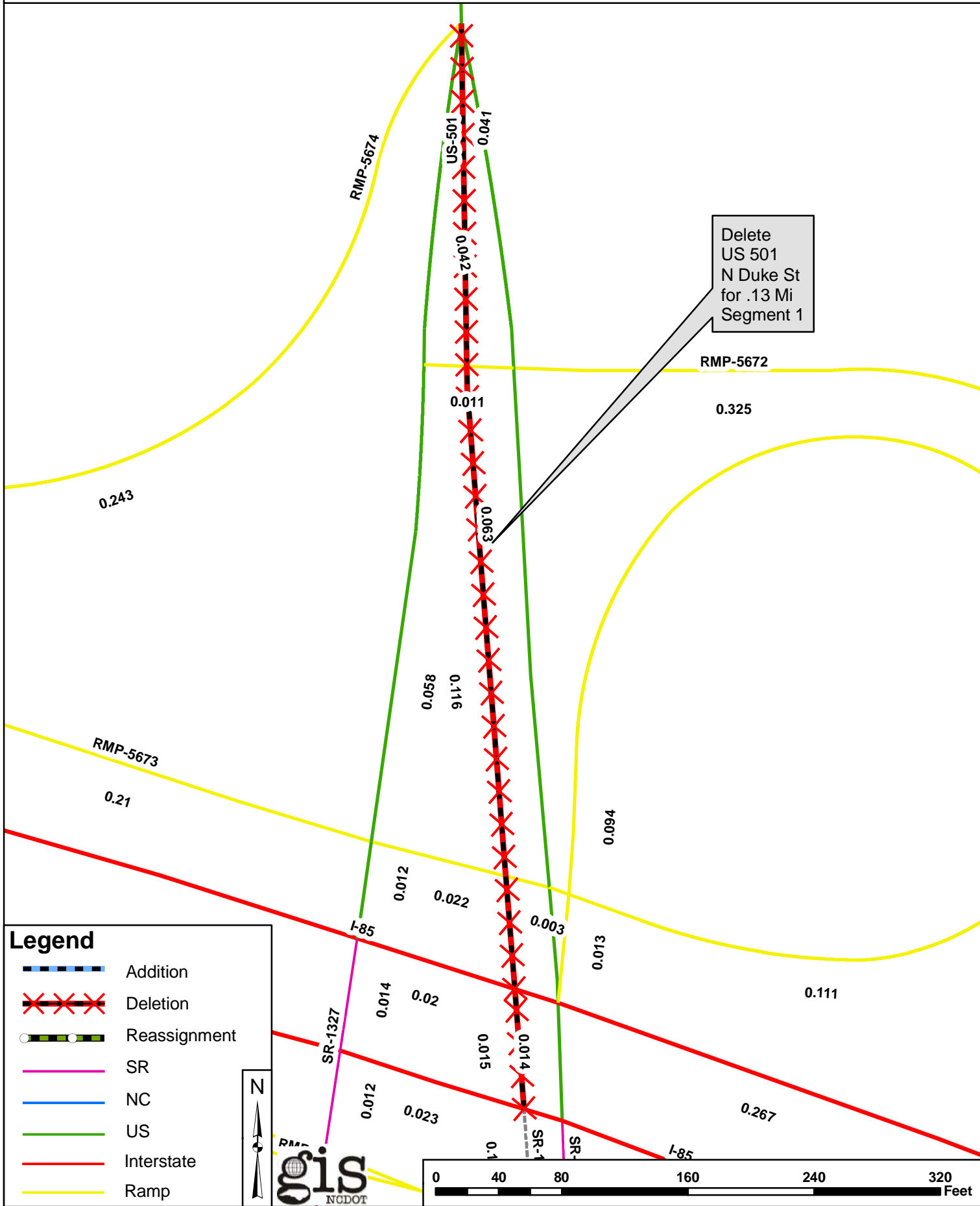
Map A



Delete
US 501
N Duke St
for .13 Mi
Segment 1

Legend

- Addition
- Deletion
- Reassignment
- SR
- NC
- US
- Interstate
- Ramp

gis
NGDOT

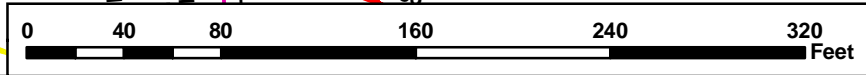

Map B

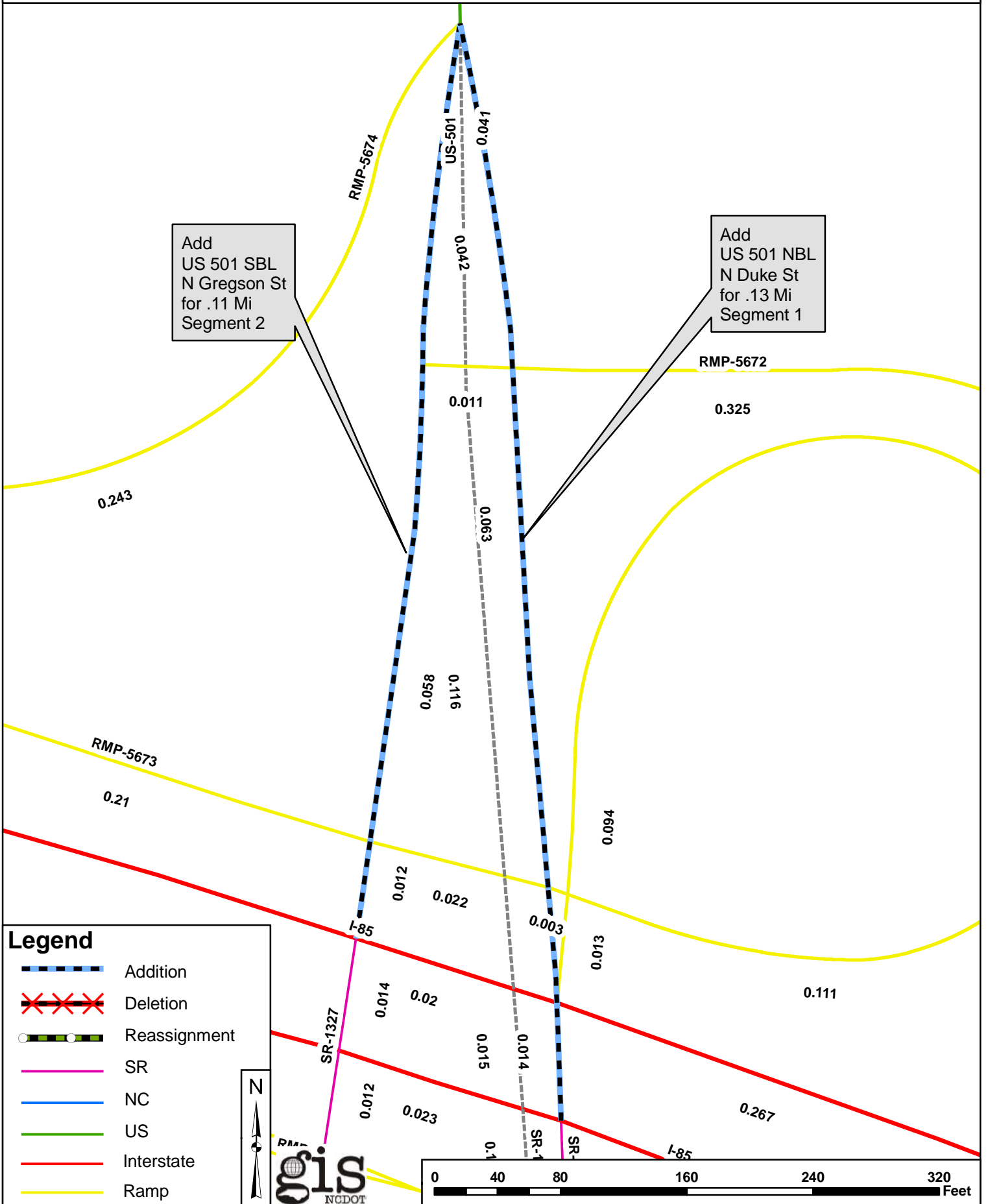

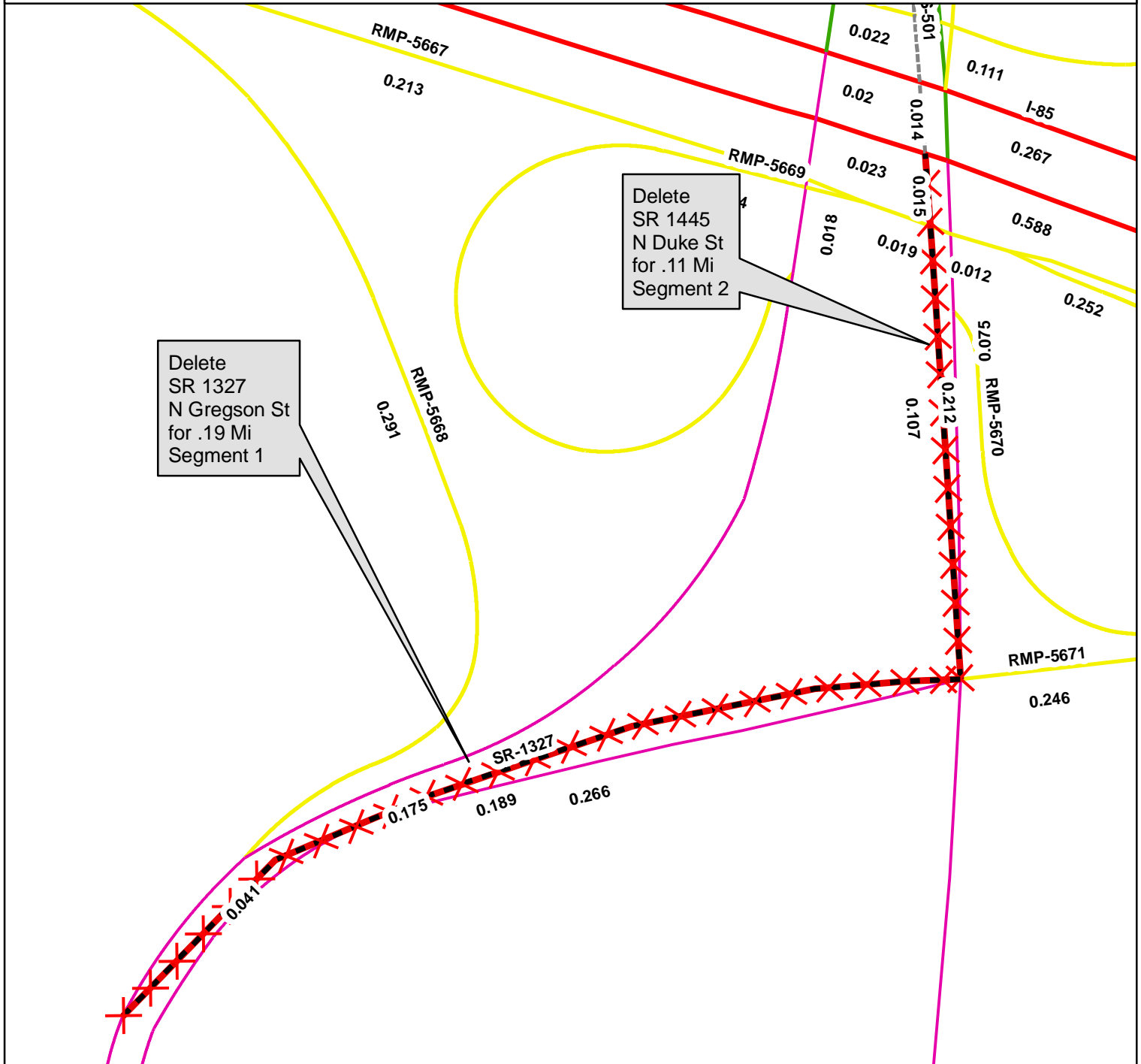

Legend

- Addition
- Deletion
- Reassignment
- SR
- NC
- US
- Interstate
- Ramp

N
↑

