



STATE OF NORTH CAROLINA  
DEPARTMENT OF TRANSPORTATION

MICHAEL F. EASLEY  
GOVERNOR

January 14, 2008

LYNDO TIPPETT  
SECRETARY

**MEMORANDUM TO:** Mr. Anthony W. Roper, PE  
Division Engineer  
Division 1

**FROM:** Information, Mapping, and Graphics Unit

**SUBJECT:** 2007 District 1 Road System Changes

The Road Inventory Information Section has been authorized to make the following changes to the state road system as indicated below. We request that you make similar changes to the related maps and files in your Division and District offices, and install appropriate road number signs if necessary. We have updated our records and county maps accordingly. If our system changes do not conform to the actual conditions in the field, please return this memorandum with recommendations.

Petition Number	County	Approval Date
48387	CAMDEN	10/4/2007

Inquires about changes should be referred to one of the following: Ron Tucker at (919) 212-6080 or Tom Schroder at (919) 212-6090. If you have further questions, please contact Hardee Cox, Road Inventory Information Section Manager at (919) 212-6060. Thank you for your assistance.

HRC  
enclosures ( )

cc: BSIP  
Bridge Maintenance  
Division Right of Way  
GIS  
Pavement Management  
Permit Unit  
State Road Maintenance  
Traffic Engineering  
Traffic Surveys

# 2007 ROAD SYSTEM CHANGES

PETITION NUMBER	COUNTY	APPROVAL DATE	NEW NUMBER	EXISTING NUMBER	STREET NAME	LENGTH (miles)	TYPE OF CHANGE	REMARKS (See Attached Map)
48387	CAMDEN	10/4/2007	SR 1276		AMY DRIVE	0.12	SYSTEM ADDITION VIA PETITION	MAP , SEGMENT
48387	CAMDEN	10/4/2007	SR 1275		MARGARET DRIVE	0.18	SYSTEM ADDITION VIA PETITION	MAP , SEGMENT
48387	CAMDEN	10/4/2007		SR 1263	BELL FARM DRIVE EXT	0.06	SYSTEM ADDITION VIA PETITION	MAP , SEGMENT

PETITION: 48387

CO: CAMDEN



SR #: 1263 1275 1276 \_\_\_\_\_

Approval Date: 10/04/07

Map Date: 01/14/08



Legend:

-  Addition
-  Deletion
-  Reassignment

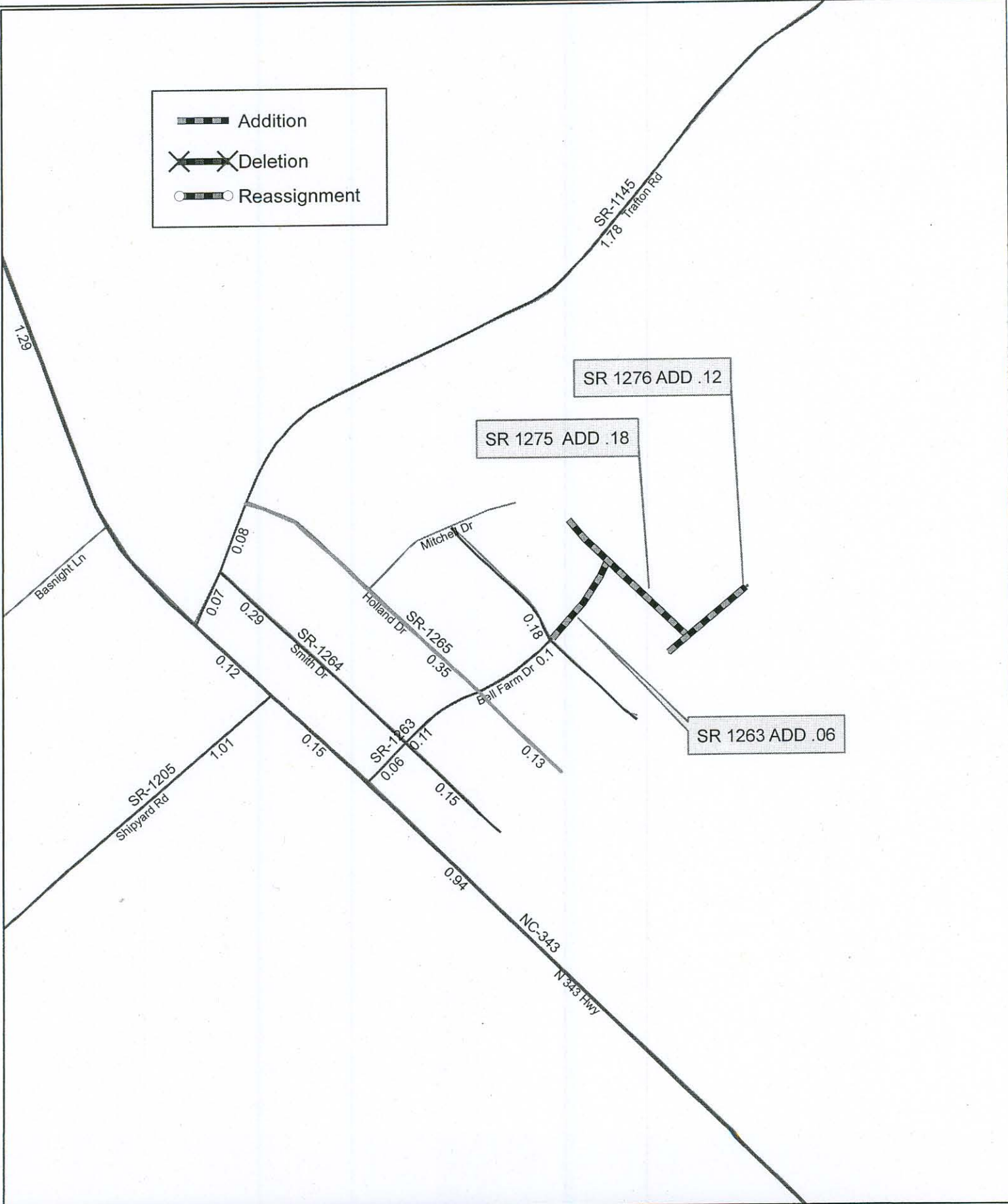

Source: XXXXXXXX

NAME: GBW

SCALE: XXX

Map: X