



STATE OF NORTH CAROLINA  
DEPARTMENT OF TRANSPORTATION

MICHAEL F. EASLEY  
GOVERNOR

Friday, November 09, 2007

LYNDO TIPPETT  
SECRETARY

**MEMORANDUM TO:** Mr. J. Wally Bowman , PE  
Division Engineer  
Division 5

**FROM:** L.C. Smith, Director  
Information, Mapping, and Graphics Unit

**SUBJECT:** 2007 District 1 Road System Changes

The Road Inventory Information Section has been authorized to make the following changes to the state road system as indicated below. We request that you make similar changes to the related maps and files in your Division and District offices, and install appropriate road number signs if necessary. We have updated our records and county maps accordingly. If our system changes do not conform to the actual conditions in the field, please return this memorandum with recommendations.

Project Number	County	Approval Date
R2000AAABAC	WAKE	7/14/2007

Inquires about changes should be referred to one of the following: Ron Tucker at (919) 212-6080 or Tom Schroder at (919) 212-6090. If you have further questions, please contact Hardee Cox, Road Inventory Information Section Manager at (919) 212-6060. Thank you for your assistance.

LCS/hrc  
enclosures ( )

- cc: BSIP  
Bridge Maintenance  
Division Right of Way  
GIS  
Pavement Management  
Permit Unit  
State Road Maintenance  
Traffic Engineering  
Traffic Surveys

# 2007 ROAD SYSTEM CHANGES

PROJECT NUMBER	COUNTY	APPROVAL DATE	NEW NUMBER	EXISTING NUMBER	STREET NAME	LENGTH (miles)	TYPE OF CHANGE	REMARKS (See Attached Map)
R2000AAABAC	WAKE	7/14/2007		SR 3119	ALSTON AVE	0.49	SYSTEM DELETION VIA PROJECT	MAP A, SEGMENT
R2000AAABAC	WAKE	7/14/2007		SR 1726	PETTY FARM ROAD	0.06	SYSTEM ADDITION VIA PROJECT	MAP A, SEGMENT
R2000AAABAC	WAKE	7/14/2007		SR 1726	PETTY FARM RD	0.07	SYSTEM DELETION VIA PROJECT	MAP A, SEGMENT
R2000AAABAC	WAKE	7/14/2007		SR 1628	OKELLY CHAPEL RD	0.52	SYSTEM ADDITION VIA PROJECT	MAP A, SEGMENT
R2000AAABAC	WAKE	7/14/2007		SR 1625	GREEN LEVEL ROAD	0.17	SYSTEM DELETION VIA PROJECT	MAP A, SEGMENT
R2000AAABAC	WAKE	7/14/2007		SR 3119	ALSTON AVE	0.05	SYSTEM DELETION VIA PROJECT	MAP B, SEGMENT
R2000AAABAC	WAKE	7/14/2007		SR 3119	ALSTON AVE	0.04	SYSTEM ADDITION VIA PROJECT	MAP B, SEGMENT
R2000AAABAC	WAKE	7/14/2007	NC 540			3.48	SYSTEM ADDITION VIA PROJECT	MAP C, SEGMENT

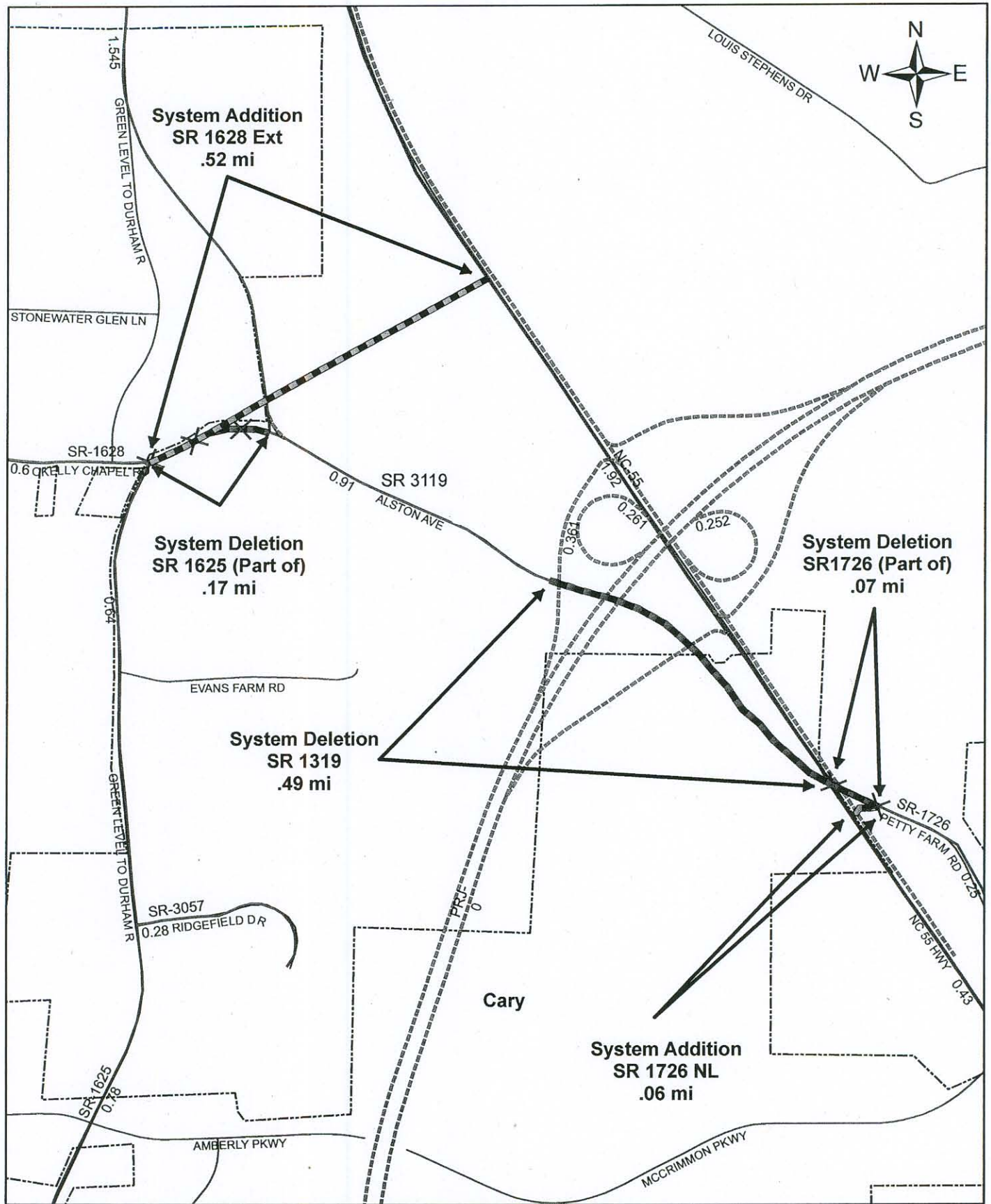

**WAKE COUNTY  
R2000AA/AB/AC  
Map "A"**



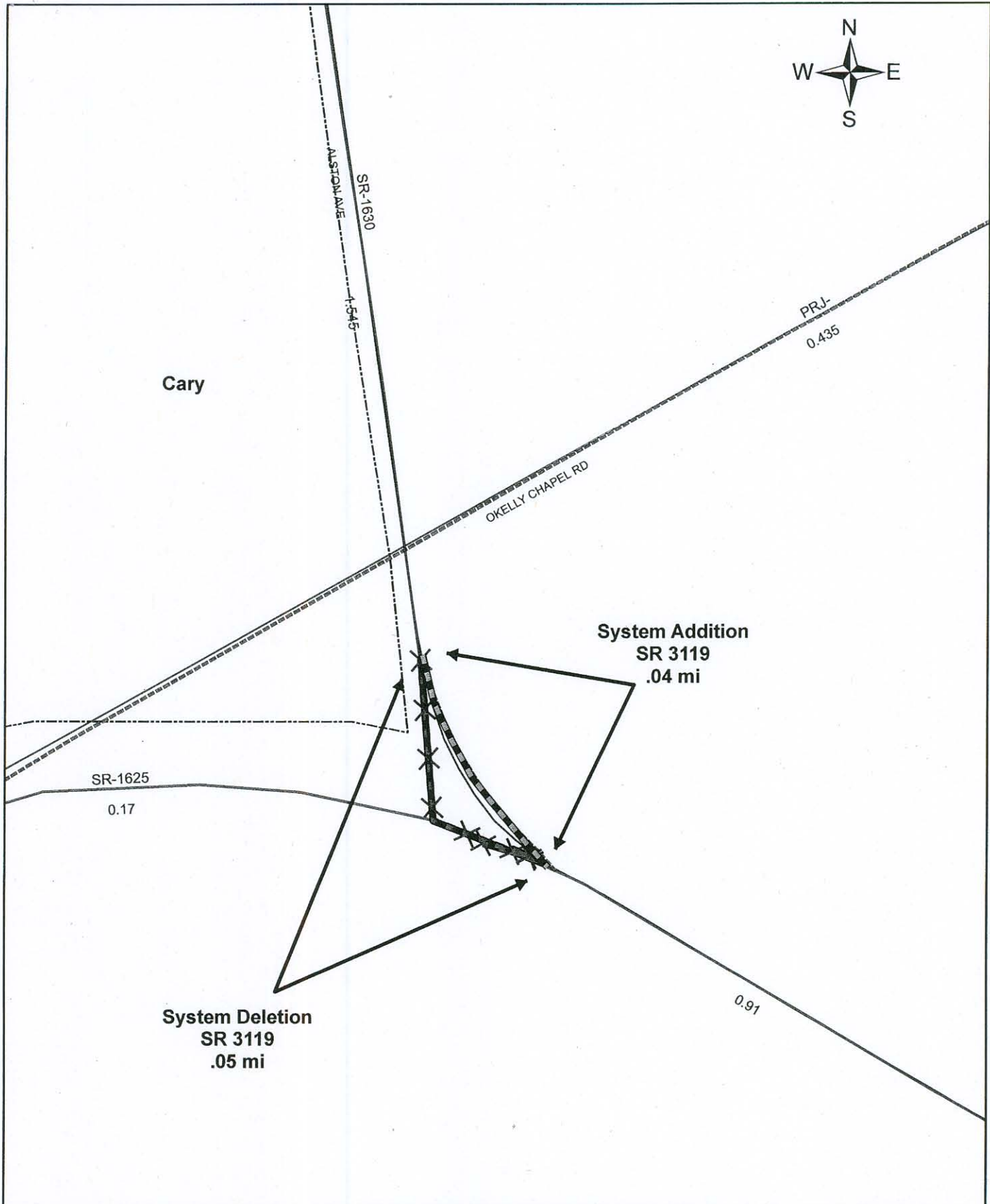

**WAKE COUNTY  
R2000AA/AB/AC  
Map "B"**



**System Addition  
NC 540  
3.48 Mi**

Durham

Durham  
Wake

KIT CREEK RD

ALSTON AVE

Cary

MCCRIMMON PKWY

NC 540 HWY

Morrisville

KURTNER CT  
SHAKESPEARE ST  
OLD MAYNARD RD

WINTER WALK CR

MCCRIMMON PKWY  
PUTNAM DR

KOPPER'S RD

SOWTER DR

LAKE GRACE BLVD

DOWN HILL DR

TREYBROOKE DR

CHapel Hill Rd  
PERIMETER PARK DR

PARAMOUNT PKWY

1540

**WAKE COUNTY  
R2000AA/AB/AC  
Map "C"**