



STATE OF NORTH CAROLINA  
DEPARTMENT OF TRANSPORTATION

BEVERLY EAVES PERDUE  
GOVERNOR

Monday, September 20, 2010

EUGENE A. CONTI, JR.  
SECRETARY

**MEMORANDUM TO:** Mr. Jay Swain, PE  
Division Engineer  
Division 13

**FROM:** John C. Farley, Manager  
Geographic Information Systems Unit

**SUBJECT:** 2010 District 2 Road System Changes

The Data Conversion Group has been authorized to make the following changes to the state road system as indicated below. We request that you make similar changes to the related maps and files in your Division and District offices, and install appropriate road number signs if necessary. We have updated our records accordingly. If our system changes do not conform to the actual conditions in the field, please return this memorandum with recommendations.

Document Number	County	Approval Date
R-2813C	BUNCOMBE	6/22/2007

Inquiries about changes should be referred to the GIS Help Desk at (919) 707-2152.  
Thank you for your assistance.

JCF

cc: BSIP  
Bridge Maintenance  
Division Right of Way  
IMG  
Pavement Management  
Permit Unit  
State Road Maintenance  
Traffic Engineering  
Traffic Surveys

**MAILING ADDRESS:**  
NC DEPARTMENT OF TRANSPORTATION  
GEOGRAPHIC INFORMATION SYSTEMS  
1521 MAIL SERVICE CENTER  
RALEIGH NC 27699-1521

  
NCDOT  
WWW.NCDOT.ORG/IT/GIS

**Delivery Address:**  
41 01 CAPITAL BLVD.  
RALEIGH, NC 27604  
PHONE: (919) 707-2152  
FAX: (919) 707-2214

# 2010 ROAD SYSTEM CHANGES

<b>DOCUMENT NUMBER</b>	<b>COUNTY</b>	<b>APPROVAL DATE</b>	<b>NEW NUMBER</b>	<b>EXISTING NUMBER</b>	<b>STREET NAME</b>	<b>LENGT H</b>	<b>TYPE OF CHANGE</b>	<b>REMARKS (See Attached Map)</b>
R-2813C	BUNCOMBE	6/22/2007		SR 3520	PLOTT PLACE	0.03	SYSTEM ADDITION - EXISTING VIA TIP	MAP , SEGMENT
R-2813C	BUNCOMBE	6/22/2007		SR 3519		0.12	SYSTEM DELETION VIA TIP	MAP , SEGMENT
R-2813C	BUNCOMBE	6/22/2007		NC 146		0.38	SYSTEM DELETION VIA TIP	MAP , SEGMENT
R-2813C	BUNCOMBE	6/22/2007		NC 146		0.37	SYSTEM ADDITION - EXISTING VIA TIP	MAP , SEGMENT

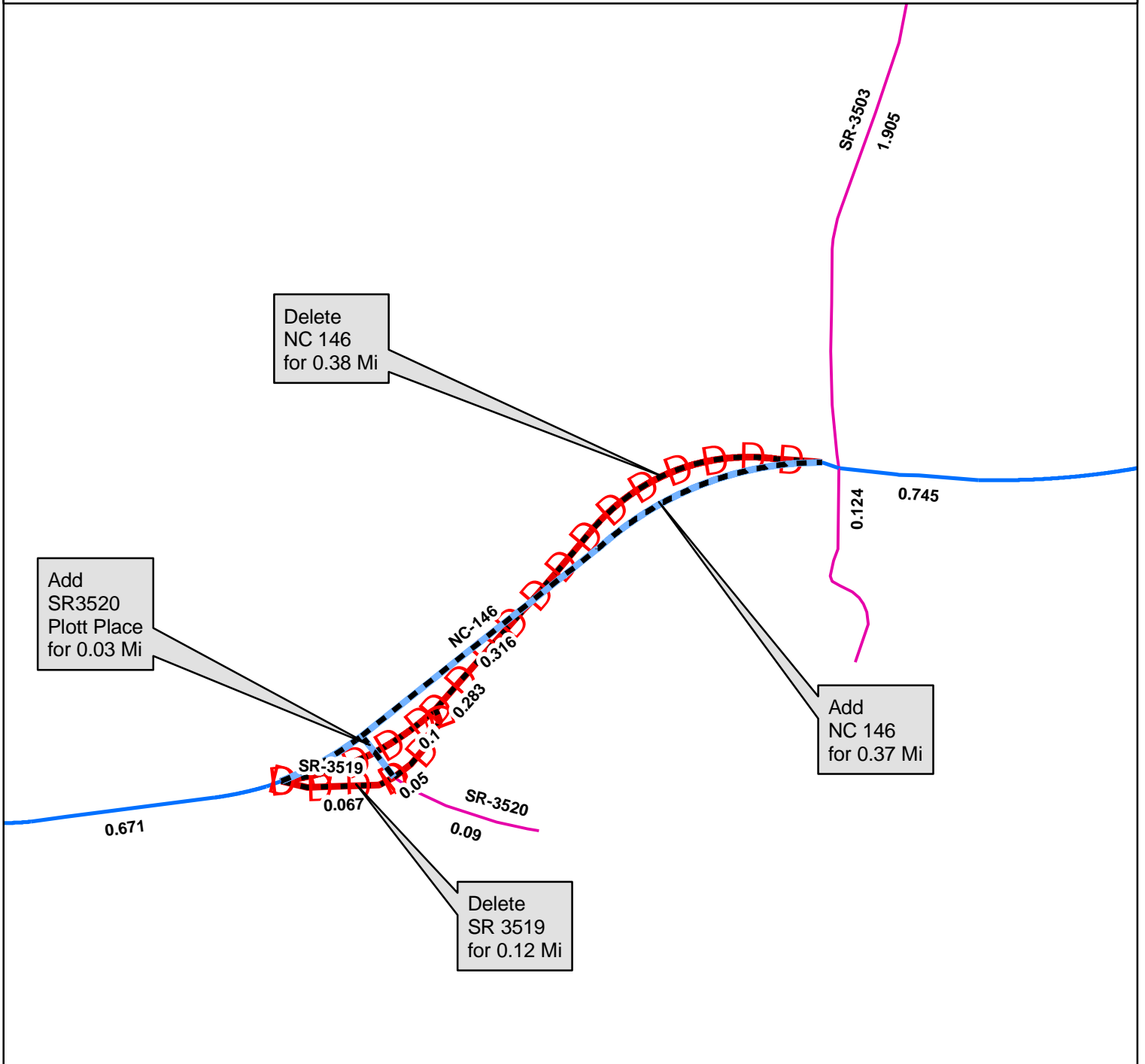

Add SR3520 Plott Place for 0.03 Mi

Delete NC 146 for 0.38 Mi

Add NC 146 for 0.37 Mi

Delete SR 3519 for 0.12 Mi

**Legend**

- Addition
- Deletion
- Reassignment
- SR
- NC
- US
- Interstate
- Ramp

**3gis**  
NCDOT

