



STATE OF NORTH CAROLINA
DEPARTMENT OF TRANSPORTATION

MICHAEL F. EASLEY
GOVERNOR

September 07, 2007

LYNDO TIPPETT
SECRETARY

MEMORANDUM TO: Mr. Barry S. Moose, PE
Division Engineer
Division 10

FROM: L.C. Smith
GIS Director

SUBJECT: 2007 District 3 Road System Changes

The Data Compilation Section has been authorized to make the following changes to the state road system as indicated below. We request that you make similar changes to the related maps and files in your Division and District offices, and install appropriate road number signs if necessary. We have updated our records and county maps accordingly. If our system changes do not conform to the actual conditions in the field, please return this memorandum with recommendations.

Petition Number	County	Approval Date
48125	UNION	1/11/2007

Inquires about changes should be referred to one of the following: Ron Tucker (Div 3,6,7,8) at (919) 212-6080, Ron Nealy (Div 5,9,11,13,14) at (919) 212-5980, or Lori Mann (Div 1,2,4,10,12) at (919) 212-6075. If you have further questions, please contact Hardee Cox, Data Compilation Section Manger at (919) 212-6060. Thank you for your assistance.

LCS/hrc
enclosures ()

cc: BSIP
Bridge Maintenance
Division Right of Way
Pavement Management
Permit Unit
State Road Maintenance
Traffic Engineering
Traffic Surveys

MAILING ADDRESS:
NC DEPARTMENT OF TRANSPORTATION
GEOGRAPHIC INFORMATION SYSTEMS
1587 MAIL SERVICE CENTER
RALEIGH NC 27699-1587



DELIVERY ADDRESS:
3401 CARL SANDBURG CT.
RALEIGH, NC 27610
PHONE: (919) 212-6000
FAX: (919) 212-5999

2007 ROAD SYSTEM CHANGES

PETITION NUMBER	COUNTY	APPROVAL DATE	NEW NUMBER	EXISTING NUMBER	STREET NAME	LENGTH (miles)	TYPE OF CHANGE	REMARKS (See Attached Map)
48125	UNION	1/11/2007	SR 3084		BROOK PATH LANE	0.04	SYSTEM ADDITION VIA PETITION	MAP , SEGMENT
48125	UNION	1/11/2007	SR 3083		CREEK COURT	0.02	SYSTEM ADDITION VIA PETITION	MAP , SEGMENT
48125	UNION	1/11/2007	SR 3082		STEVEN SCHULTZ DRIVE	0.06	SYSTEM ADDITION VIA PETITION	MAP , SEGMENT
48125	UNION	1/11/2007	SR 3081		LAWRENCE DANIEL DRIVE	0.58	SYSTEM ADDITION VIA PETITION	MAP , SEGMENT

PETITION #: 48125

CO: UNION

SR #:

3081 3082 3083 3084

Approval Date: 01/11/07

Map Date: 09/07/07

_____	_____	_____	_____
_____	_____	_____	_____
_____	_____	_____	_____
_____	_____	_____	_____

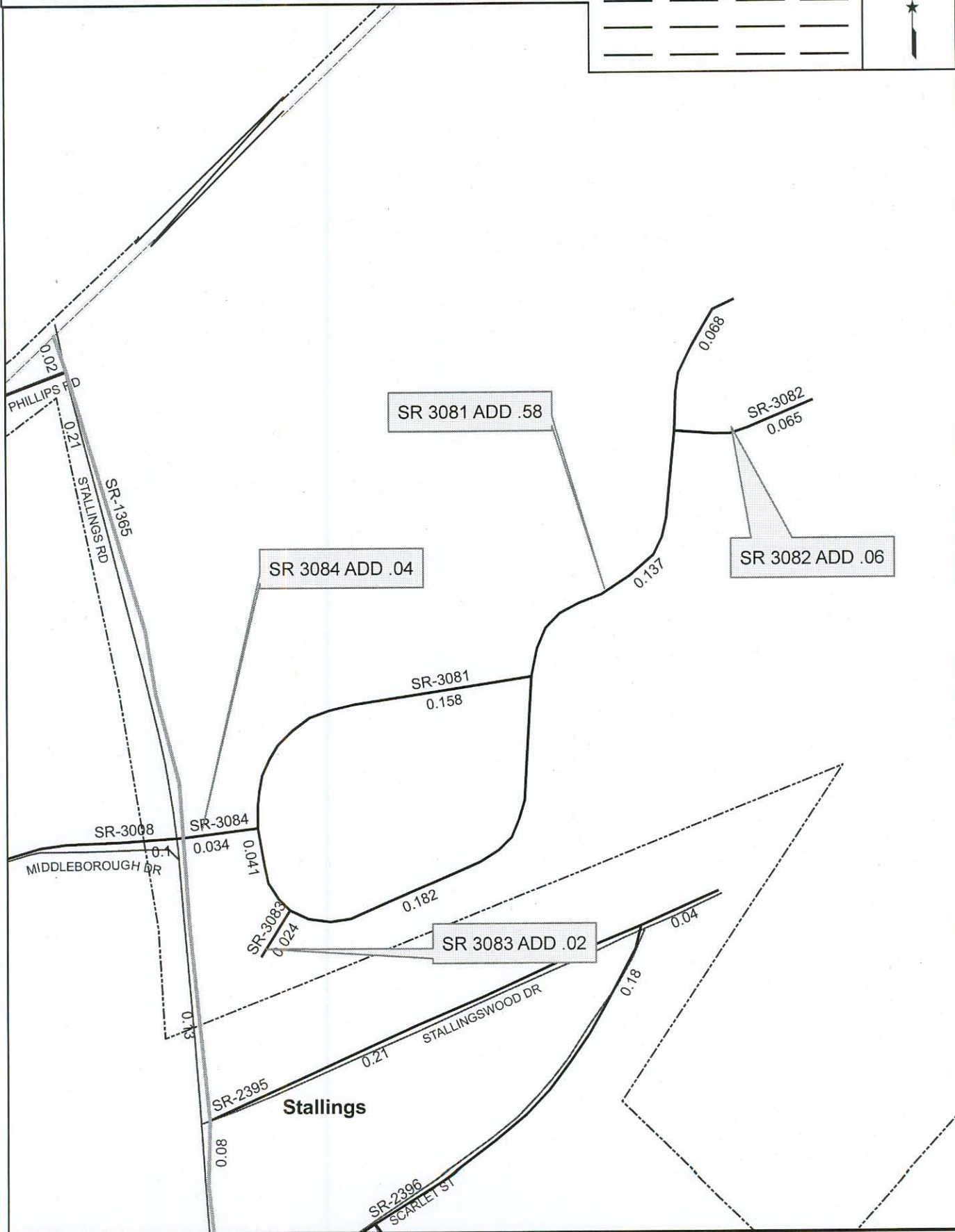

Source: .

NAME: GBW

SCALE: .

Page: .