



STATE OF NORTH CAROLINA  
DEPARTMENT OF TRANSPORTATION

MICHAEL F. EASLEY  
GOVERNOR

September 12, 2007

LYNDO TIPPETT  
SECRETARY

**MEMORANDUM TO:** Mr. Timothy Johnson, PE  
Division Engineer  
Division 8

**FROM:** L.C. Smith  
GIS Director

**SUBJECT:** 2007 District 3 Road System Changes

The Road Inventory Section has been authorized to make the following changes to the state road system as indicated below. We request that you make similar changes to the related maps and files in your Division and District offices, and install appropriate road number signs if necessary. We have updated our records and county maps accordingly. If our system changes do not conform to the actual conditions in the field, please return this memorandum with recommendations.

Petition Number	County	Approval Date
48121	RICHMOND	1/11/2007

Inquires about secondary road petition changes should be referred to Ron Tucker, Secondary Roads Group Supervisor at (919) 212-6080. Inquires about TIP Project changes should be referred to Tom Schroeder, Primary Highway Group Supervisor at (919) 212-6074. If you have further questions, please contact Hardee Cox, Road Inventory Manager at (919) 212-6060. Thank you for your assistance.

LCS/hrc  
enclosures ( )

cc: BSIP  
Bridge Maintenance  
Division Right of Way  
Pavement Management  
Permit Unit  
State Road Maintenance  
Traffic Engineering  
Traffic Surveys

**MAILING ADDRESS:**  
NC DEPARTMENT OF TRANSPORTATION  
GEOGRAPHIC INFORMATION SYSTEMS  
1587 MAIL SERVICE CENTER  
RALEIGH NC 27699-1587



[www.ncdot.org/it/gis](http://www.ncdot.org/it/gis)

**DELIVERY ADDRESS:**  
3401 CARL SANDBURG CT.  
RALEIGH, NC 27610  
PHONE: (919) 212-6000  
FAX: (919) 212-5999

# 2007 ROAD SYSTEM CHANGES

<b>PETITION NUMBER</b>	<b>COUNTY</b>	<b>APPROVAL DATE</b>	<b>NEW NUMBER</b>	<b>EXISTING NUMBER</b>	<b>STREET NAME</b>	<b>LENGTH (miles)</b>	<b>TYPE OF CHANGE</b>	<b>REMARKS (See Attached Map)</b>
48121	RICHMOND	1/11/2007	SR 1570		PAYTON CT	0.12	SYSTEM REASSIGNMENT VIA PETITION	MAP , SEGMENT
48121	RICHMOND	1/11/2007		SR 1565 EXT	LAKE POINT DR	0.34	SYSTEM ADDITION VIA PETITION	MAP , SEGMENT

PETITION #: 48121

CO: Richmond

SR #: 1565ex 1570



MATCH

MAP A

DATE 5/8/07

ADDITION —————

DELETION -----

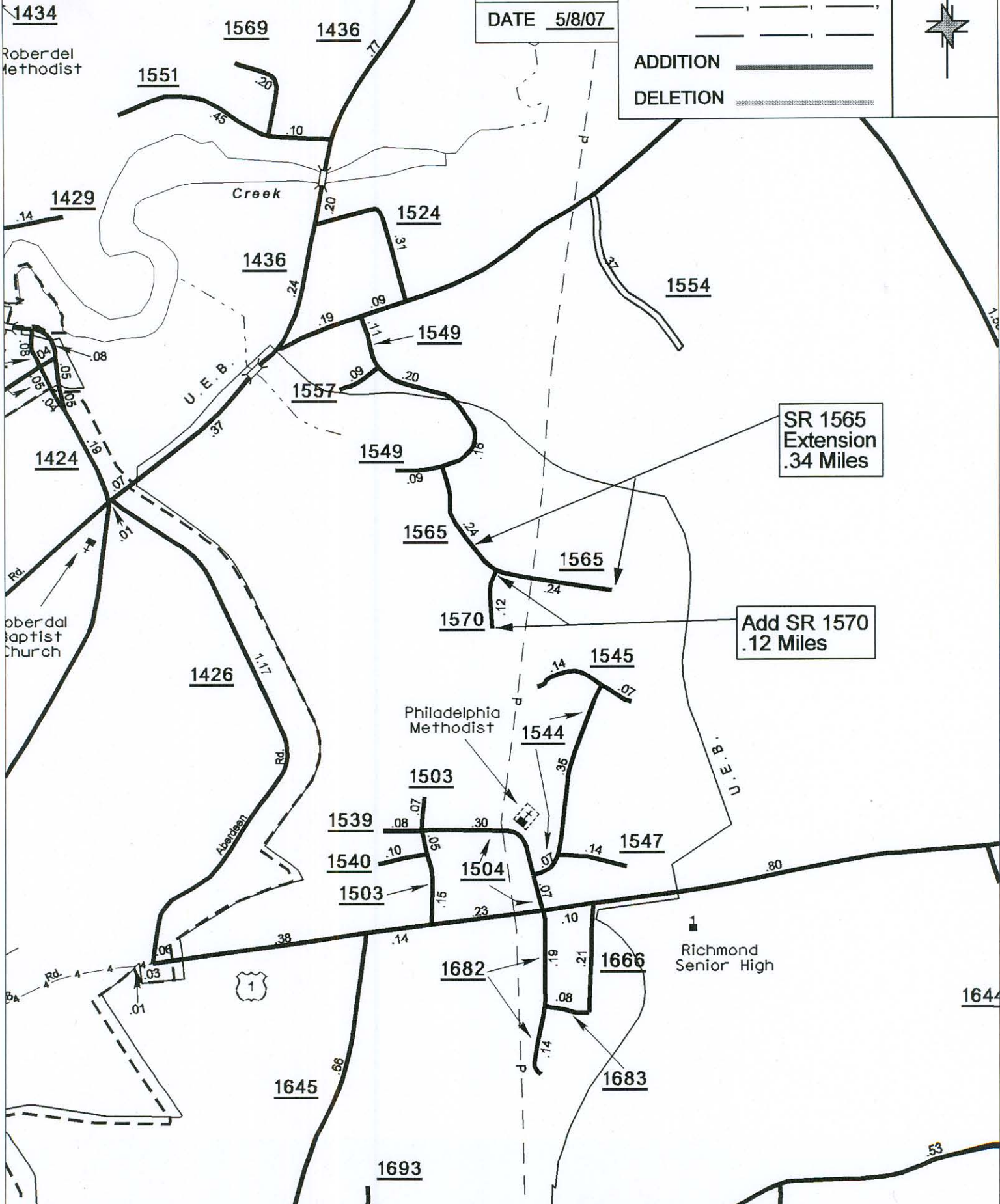

SR 1565  
Extension  
.34 Miles

Add SR 1570  
.12 Miles

SOURCE: Plat

SHEET: 2 OF 3

NAME: LM

SCALE: 4:1