



STATE OF NORTH CAROLINA  
DEPARTMENT OF TRANSPORTATION

Beverly Eaves Perdue  
GOVERNOR

Thursday, September 30, 2010

EUGENE A. CONTI, JR.  
SECRETARY

**MEMORANDUM TO:** Mr. Michael L. Holder, PE  
Division Engineer  
Division 12

**FROM:** Information, and Mapping Unit

**SUBJECT:** 2006 District 2 Road System Changes

The Road Inventory Information Section has been authorized to make the following changes to the state road system as indicated below. We request that you make similar changes to the related maps and files in your Division and District offices, and install appropriate road number signs if necessary. We have updated our records and county maps accordingly. If our system changes do not conform to the actual conditions in the field, please return this memorandum with recommendations.

| Petition Number | County  | Approval Date |
|-----------------|---------|---------------|
| 48055           | IREDELL | 11/2/2006     |

Inquires about changes should be referred to one of the following: For Primary Roads call Paulette Smith at (919)-212-6100, and for Secondary Roads call Ron Tucker at (919)-212-6085. Thank you for your assistance.

JLC  
enclosures ( )

- cc: BSIP
- Bridge Maintenance
- Division Right of Way
- GIS
- Pavement Management
- Permit Unit
- State Road Maintenance
- Traffic Engineering
- Traffic Surveys

# 2006 ROAD SYSTEM CHANGES

| <b>PETITION NUMBER</b> | <b>COUNTY</b> | <b>APPROVAL DATE</b> | <b>NEW NUMBER</b> | <b>EXISTING NUMBER</b> | <b>STREET NAME</b> | <b>LENGTH (miles)</b> | <b>TYPE OF CHANGE</b>              | <b>REMARKS (See Attached Map)</b> |
|------------------------|---------------|----------------------|-------------------|------------------------|--------------------|-----------------------|------------------------------------|-----------------------------------|
| 48055                  | IREDELL       | 11/2/2006            | SR 3185           |                        | DONNIVE DR         | 0.08                  | SYSTEM ADDITION<br>VIA<br>PETITION | MAP , SEGMENT                     |
| 48055                  | IREDELL       | 11/2/2006            |                   | SR 3089                | APPLE BLOSSOM DR   | 0.03                  | SYSTEM ADDITION<br>VIA<br>PETITION | MAP , SEGMENT                     |

PETITION #: 48055

CO: IREDELL

SR #: 3185, \_\_\_\_\_, \_\_\_\_\_

3089 \_\_\_\_\_, \_\_\_\_\_

MAP A  
DATE 11/2/06

ADDITION \_\_\_\_\_

DELETION \_\_\_\_\_

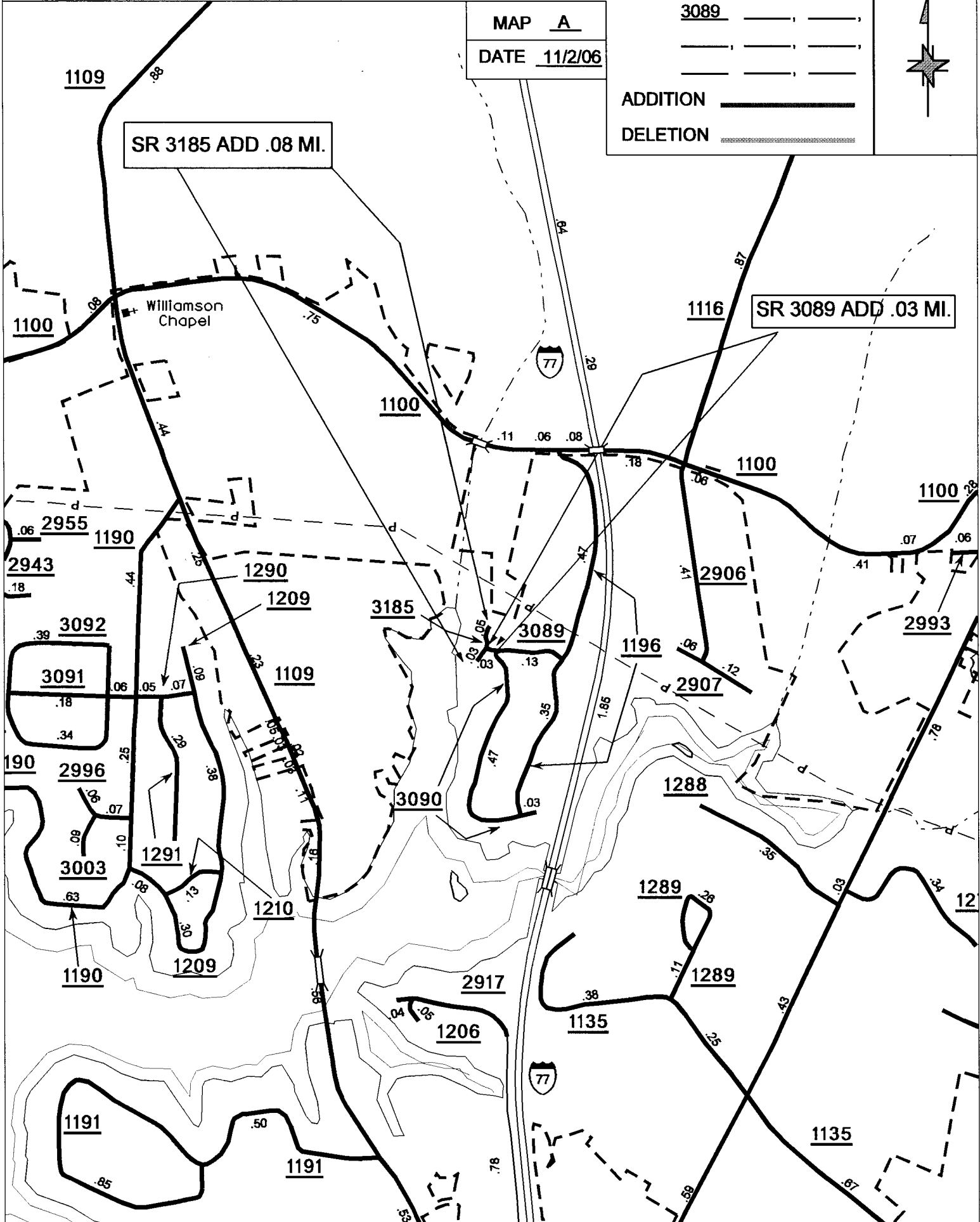

SR 3185 ADD .08 MI.

SR 3089 ADD .03 MI.

SOURCE: PLAT

SHEET: 3 OF 5

NAME: SRL-C

SCALE: 1:4