



STATE OF NORTH CAROLINA  
DEPARTMENT OF TRANSPORTATION

Beverly Eaves Perdue  
GOVERNOR

Tuesday, September 28, 2010

EUGENE A. CONTI, JR.  
SECRETARY

**MEMORANDUM TO:** Mr. Barry S. Moose, PE  
Division Engineer  
Division 10

**FROM:** Information, and Mapping Unit

**SUBJECT:** 2006 District 2 Road System Changes

The Road Inventory Information Section has been authorized to make the following changes to the state road system as indicated below. We request that you make similar changes to the related maps and files in your Division and District offices, and install appropriate road number signs if necessary. We have updated our records and county maps accordingly. If our system changes do not conform to the actual conditions in the field, please return this memorandum with recommendations.

Petition Number	County	Approval Date
47950	MECKLENBURG	8/6/2006

Inquires about changes should be referred to one of the following: For Primary Roads call Paulette Smith at (919)-212-6100, and for Secondary Roads call Ron Tucker at (919)-212-6085. Thank you for your assistance.

JLC  
enclosures ( )

- cc: BSIP  
Bridge Maintenance  
Division Right of Way  
GIS  
Pavement Management  
Permit Unit  
State Road Maintenance  
Traffic Engineering  
Traffic Surveys

# 2006 ROAD SYSTEM CHANGES

<b>PETITION NUMBER</b>	<b>COUNTY</b>	<b>APPROVAL DATE</b>	<b>NEW NUMBER</b>	<b>EXISTING NUMBER</b>	<b>STREET NAME</b>	<b>LENGTH (miles)</b>	<b>TYPE OF CHANGE</b>	<b>REMARKS (See Attached Map)</b>
47950	MECKLENBURG	8/6/2006	SR 6014			0.07	SYSTEM ADDITION VIA PETITION	MAP , SEGMENT
47950	MECKLENBURG	8/6/2006	SR 6013			0.08	SYSTEM ADDITION VIA PETITION	MAP , SEGMENT
47950	MECKLENBURG	8/6/2006	SR 6012			0.08	SYSTEM ADDITION VIA PETITION	MAP , SEGMENT
47950	MECKLENBURG	8/6/2006	SR 6011			0.04	SYSTEM ADDITION VIA PETITION	MAP , SEGMENT
47950	MECKLENBURG	8/6/2006	SR 6010			0.02	SYSTEM ADDITION VIA PETITION	MAP , SEGMENT
47950	MECKLENBURG	8/6/2006	SR 6009			0.13	SYSTEM ADDITION VIA PETITION	MAP , SEGMENT
47950	MECKLENBURG	8/6/2006	SR 6008			0.31	SYSTEM ADDITION VIA PETITION	MAP , SEGMENT
47950	MECKLENBURG	8/6/2006	SR 6007			0.53	SYSTEM ADDITION VIA PETITION	MAP , SEGMENT
47950	MECKLENBURG	8/6/2006	SR 6006			0.02	SYSTEM ADDITION VIA PETITION	MAP , SEGMENT

PETITION #: 47950

CO: Mecklenburg

SR #: 6006, 6007, 6008,

6009, 6010, 6011,

6012, 6013, 6014,

\_\_\_\_\_, \_\_\_\_\_, \_\_\_\_\_

MAP A  
DATE 5/10/07



ADDITION —————

DELETION -----

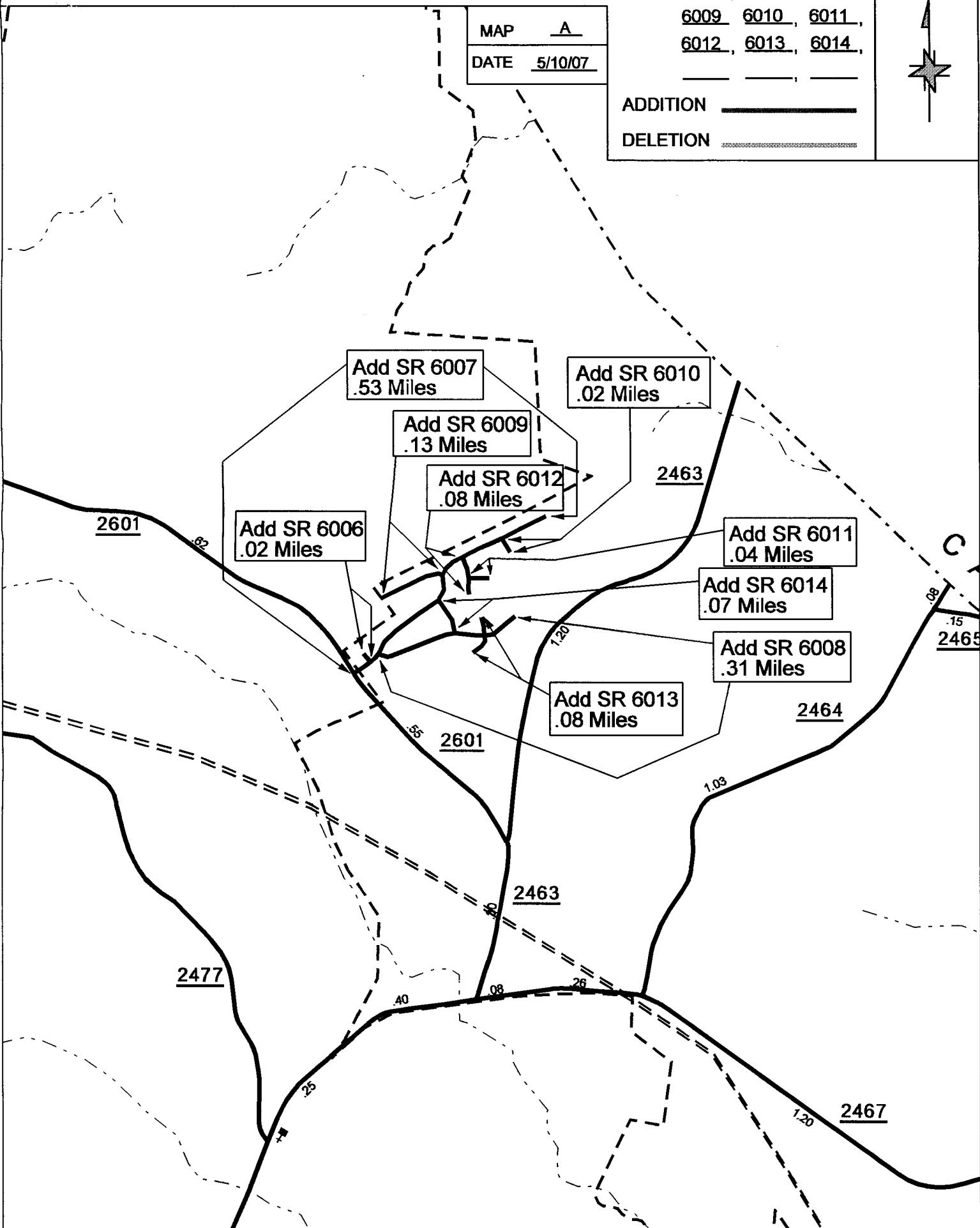

Add SR 6007  
.53 Miles

Add SR 6010  
.02 Miles

Add SR 6009  
.13 Miles

Add SR 6012  
.08 Miles

Add SR 6006  
.02 Miles

Add SR 6011  
.04 Miles

Add SR 6014  
.07 Miles

Add SR 6008  
.31 Miles

Add SR 6013  
.08 Miles

2601

2463

C

2465

2464

2601

2477

2463

2467