



STATE OF NORTH CAROLINA  
DEPARTMENT OF TRANSPORTATION

MICHAEL F. EASLEY  
GOVERNOR

June 21, 2007

LYNDO TIPPETT  
SECRETARY

**MEMORANDUM TO:** Mr. Mike Mills, PE  
Division Engineer  
Division 7

**FROM:** L.C. Smith  
GIS Director

**SUBJECT:** 2006 District 1 Road System Changes

The Data Compilation Section has been authorized to make the following changes to the state road system as indicated below. We request that you make similar changes to the related maps and files in your Division and District offices, and install appropriate road number signs if necessary. We have updated our records and county maps accordingly. If our system changes do not conform to the actual conditions in the field, please return this memorandum with recommendations.

Petition Number	County	Approval Date
47862	ORANGE	5/4/2006

Inquires about changes should be referred to one of the following: Ron Tucker (Div 3,6,7,8) at (919) 212-6080, Ron Nealy (Div 5,9,11,13,14) at (919) 212-5980, or Lori Mann (Div 1,2,4,10,12) at (919) 212-6075. If you have further questions, please contact Hardee Cox, Data Compilation Section Manger at (919) 212-6060. Thank you for your assistance.

LCS/hrc  
enclosures ( )

cc: BSIP  
Bridge Maintenance  
Division Right of Way  
Pavement Management  
Permit Unit  
State Road Maintenance  
Traffic Engineering  
Traffic Surveys

MAILING ADDRESS:  
NC DEPARTMENT OF TRANSPORTATION  
GEOGRAPHIC INFORMATION SYSTEMS  
1587 MAIL SERVICE CENTER  
RALEIGH NC 27699-1587



DELIVERY ADDRESS:  
3401 CARL SANDBURG CT.  
RALEIGH, NC 27610  
PHONE: (919) 212-6000  
FAX: (919) 212-5999

# 2006 ROAD SYSTEM CHANGES

PETITION NUMBER	COUNTY	APPROVAL DATE	NEW NUMBER	EXISTING NUMBER	STREET NAME	LENGTH (miles)	TYPE OF CHANGE	REMARKS (See Attached Map)
47862	ORANGE	5/4/2006	SR 2283		CREEK RIDGE LANE	0.40	SYSTEM ADDITION VIA PETITION	MAP A, SEGMENT 1
47862	ORANGE	5/4/2006	SR 2282		CREEK RUN COURT	0.09	SYSTEM ADDITION VIA PETITION	MAP A, SEGMENT 1
47862	ORANGE	5/4/2006	SR 2281		CREEK WOOD DRIVE	0.92	SYSTEM ADDITION VIA PETITION	MAP A, SEGMENT 1

PETITION #: 47862

CO: Orange

SR #: \_\_\_\_\_, \_\_\_\_\_, \_\_\_\_\_

MAP A

DATE 6/12/06

ADDITION ADDITION

DELETION \_\_\_\_\_



SR 2281 Add  
0.92 Mile

SR 2283 Add  
0.40 Mile

SR 2282 Add  
0.09 Mile

86  
DUKE  
FOREST

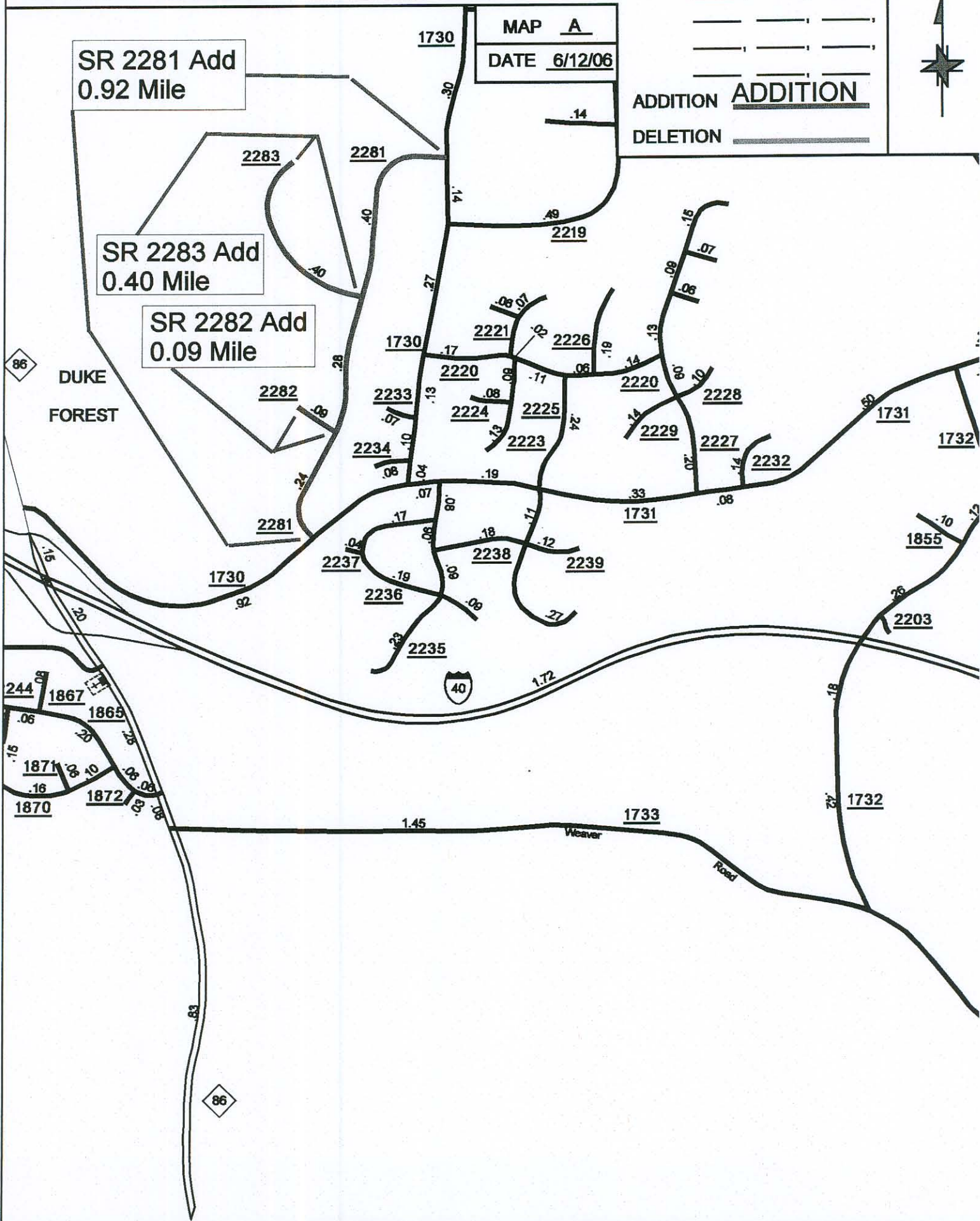

SOURCE: Plat

SHEET: 2 OF 2

NAME: RLN

SCALE: 4 to 1