



STATE OF NORTH CAROLINA  
DEPARTMENT OF TRANSPORTATION

MICHAEL F. EASLEY  
GOVERNOR

September 28, 2007

LYNDO TIPPETT  
SECRETARY

**MEMORANDUM TO:** Mr. Timothy Johnson, PE  
Division Engineer  
Division 8

**FROM:** L.C. Smith, Director  
Information, Mapping, and Graphics Unit

**SUBJECT:** 2007 District 2 Road System Changes

The Road Inventory Information Section has been authorized to make the following changes to the state road system as indicated below. We request that you make similar changes to the related maps and files in your Division and District offices, and install appropriate road number signs if necessary. We have updated our records and county maps accordingly. If our system changes do not conform to the actual conditions in the field, please return this memorandum with recommendations.

TIP Number	County	Approval Date
R-210C	LEE	3/31/2006

Inquires about changes should be referred to one of the following: Ron Tucker at (919) 212-6080 or Tom Schroder at (919) 212-6090. If you have further questions, please contact Hardee Cox, Road Inventory Information Section Manager at (919) 212-6060. Thank you for your assistance.

LCS/hrc  
enclosures ( )

cc: BSIP  
Bridge Maintenance  
Division Right of Way  
GIS  
Pavement Management  
Permit Unit  
State Road Maintenance  
Traffic Engineering  
Traffic Surveys

# 2007 ROAD SYSTEM CHANGES

TIP NUMBER	COUNTY	APPROVAL DATE	NEW NUMBER	EXISTING NUMBER	STREET NAME	LENGTH (miles)	TYPE OF CHANGE	REMARKS (See Attached Map)
R-210C	LEE	3/31/2006		US 1		1.83	SYSTEM ADDITION VIA PROJECT	MAP A, SEGMENT 1
R-210C	LEE	3/31/2006	SR 1754			0.35	SYSTEM ADDITION VIA PROJECT	MAP B, SEGMENT 1
R-210C	LEE	3/31/2006	SR 1754	US 1		1.59	SYSTEM REASSIGNMENT VIA PROJECT	MAP B, SEGMENT 2
R-210C	LEE	3/31/2006	SR 1754			0.08	SYSTEM ADDITION VIA PROJECT	MAP B, SEGMENT 3
R-210C	LEE	3/31/2006	SR 1752			1.78	SYSTEM ADDITION VIA PROJECT	MAP B, SEGMENT 5
R-210C	LEE	3/31/2006		US 1		0.09	SYSTEM DELETION VIA PROJECT	MAP A, SEGMENT 10





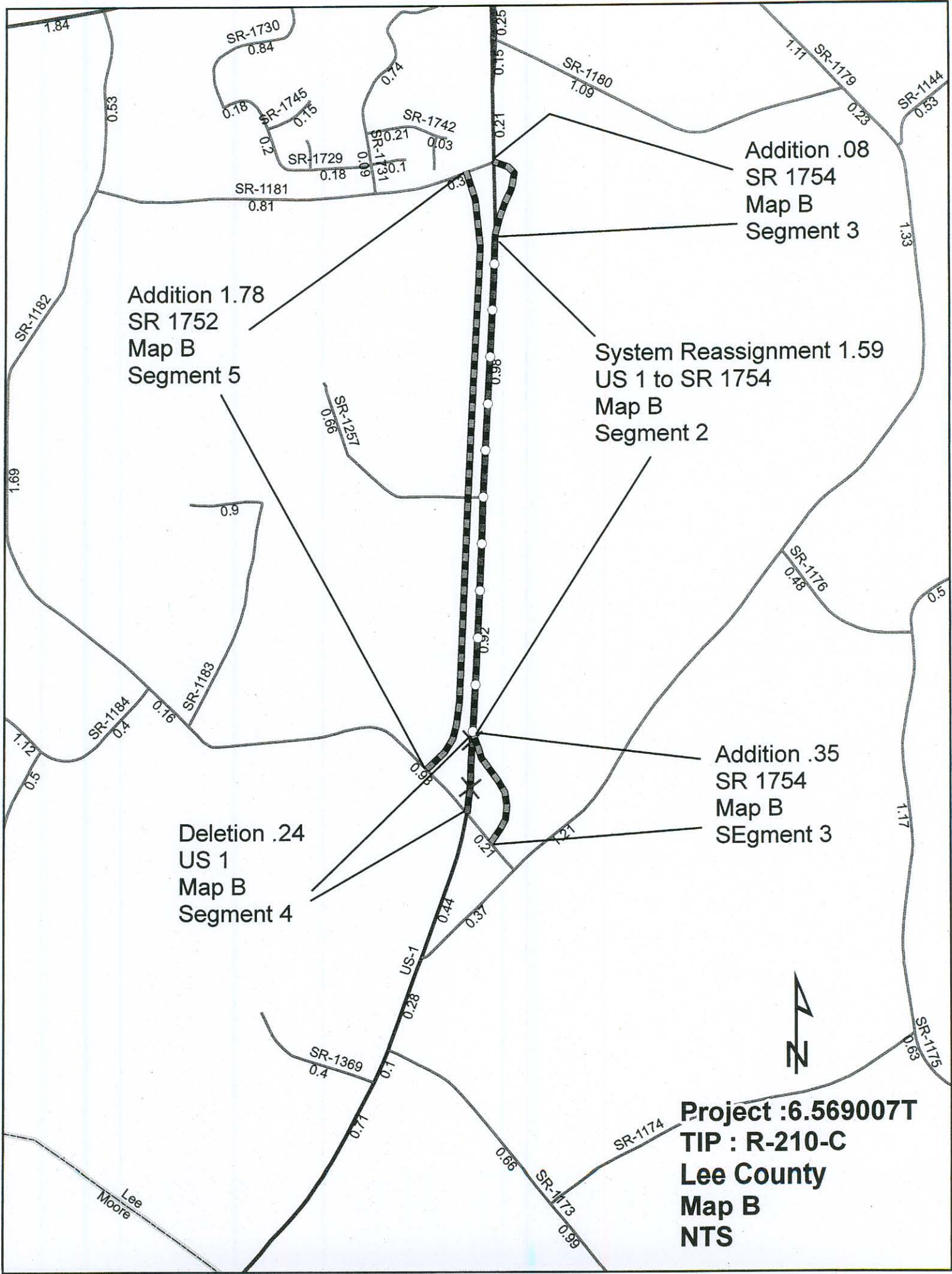

Addition .08  
SR 1754  
Map B  
Segment 3

Addition 1.78  
SR 1752  
Map B  
Segment 5

System Reassignment 1.59  
US 1 to SR 1754  
Map B  
Segment 2

Addition .35  
SR 1754  
Map B  
Segment 3

Deletion .24  
US 1  
Map B  
Segment 4

**Project :6.569007T**  
**TIP : R-210-C**  
**Lee County**  
**Map B**  
**NTS**

