



STATE OF NORTH CAROLINA
DEPARTMENT OF TRANSPORTATION

MICHAEL F. EASLEY
GOVERNOR

Tuesday, June 26, 2007

LYNDO TIPPETT
SECRETARY

MEMORANDUM TO: Mr. Michael L. Holder, PE
Division Engineer
Division 12

FROM: L.C. Smith
GIS Director

SUBJECT: 2006 District 3 Road System Changes

The Data Compilation Section has been authorized to make the following changes to the state road system as indicated below. We request that you make similar changes to the related maps and files in your Division and District offices, and install appropriate road number signs if necessary. We have updated our records and county maps accordingly. If our system changes do not conform to the actual conditions in the field, please return this memorandum with recommendations.

Petition Number	County	Approval Date
3512250206	LINCOLN	2/7/2006

Inquires about changes should be referred to one of the following: Ron Tucker (Div 3,6,7,8) at (919) 212-6080, Ron Nealy (Div 5,9,11,13,14) at (919) 212-5980, or Lori Mann (Div 1,2,4,10,12) at (919) 212-6075. If you have further questions, please contact Hardee Cox, Data Compilation Section Manger at (919) 212-6060. Thank you for your assistance.

LCS/hrc
enclosures ()

cc: BSIP
Bridge Maintenance
Division Right of Way
Pavement Management
Permit Unit
State Road Maintenance
Traffic Engineering
Traffic Surveys

MAILING ADDRESS:
NC DEPARTMENT OF TRANSPORTATION
GEOGRAPHIC INFORMATION SYSTEMS
1587 MAIL SERVICE CENTER
RALEIGH NC 27699-1587



DELIVERY ADDRESS:
3401 CARL SANDBURG CT.
RALEIGH, NC 27610
PHONE: (919) 212-6000
FAX: (919) 212-5999

2006 ROAD SYSTEM CHANGES

PETITION NUMBER	COUNTY	APPROVAL DATE	NEW NUMBER	EXISTING NUMBER	STREET NAME	LENGTH (miles)	TYPE OF CHANGE	REMARKS (See Attached Map)
3512250206	LINCOLN	2/7/2006		SR 1963	FOURTH FAIRWAY DR	0.30	SYSTEM DELETION VIA PETITION	MAP , SEGMENT
3512250206	LINCOLN	2/7/2006		SR 1962	GLENN OAKS DR	0.23	SYSTEM DELETION VIA PETITION	MAP , SEGMENT

PETITION #: mun

CO: LINCOLN

SR #: 1962, _____, _____

1963, _____, _____

MAP A

DATE 06/26/07

ADDITION _____

DELETION _____



1,320,000'

1,350,000'

SR 1963 Delete .30 mi

SR 1962 Delete .23 mi

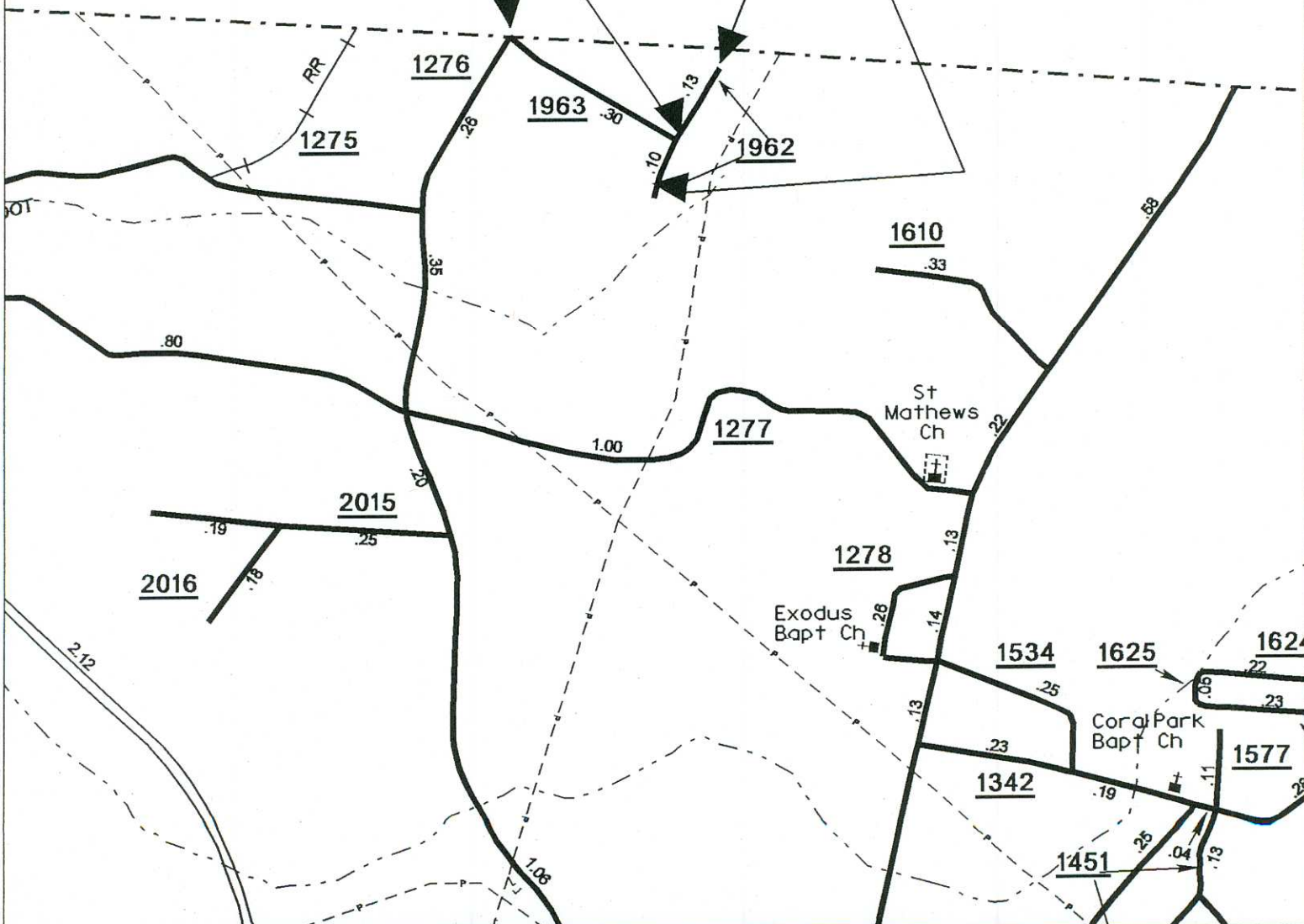

SOURCE: PLAT

SHEET: 1 OF 3

NAME: SRL-C

SCALE: 4:1