



STATE OF NORTH CAROLINA
DEPARTMENT OF TRANSPORTATION

MICHAEL F. EASLEY
GOVERNOR

February 19, 2008

LYNDO TIPPETT
SECRETARY

MEMORANDUM TO: Mr. Jay Swain, PE
Division Engineer
Division 13

FROM: Information, Mapping, and Graphics Unit

SUBJECT: 2007 District 1 Road System Changes

The Road Inventory Information Section has been authorized to make the following changes to the state road system as indicated below. We request that you make similar changes to the related maps and files in your Division and District offices, and install appropriate road number signs if necessary. We have updated our records and county maps accordingly. If our system changes do not conform to the actual conditions in the field, please return this memorandum with recommendations.

TIP Number	County	Approval Date
R-2598	MITCHELL	12/6/2005

Inquires about changes should be referred to one of the following: Ron Tucker at (919) 212-6080 or Tom Schroder at (919) 212-6090. If you have further questions, please contact Hardee Cox, Road Inventory Information Section Manager at (919) 212-6060. Thank you for your assistance.

HRC
enclosures ()

cc: BSIP
Bridge Maintenance
Division Right of Way
GIS
Pavement Management
Permit Unit
State Road Maintenance
Traffic Engineering
Traffic Surveys

MAILING ADDRESS:
NC DEPARTMENT OF TRANSPORTATION
INFORMATION, MAPPING AND GRAPHICS UNIT
1587 MAIL SERVICE CENTER
RALEIGH NC 27699-1587

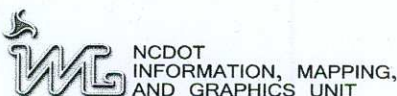

LOCATION:
3401 CARL SANDBURG CT.
RALEIGH, NC 27610

2007 ROAD SYSTEM CHANGES

TIP NUMBER	COUNTY	APPROVAL DATE	NEW NUMBER	EXISTING NUMBER	STREET NAME	LENGTH (miles)	TYPE OF CHANGE	REMARKS (See Attached Map)
R-2598	MITCHELL	12/6/2005		SR 1106	DALE ROAD	0.01	SYSTEM ADDITION VIA PROJECT	MAP A, SEGMENT 1
R-2598	MITCHELL	12/6/2005		SR 1106	DALE ROAD	0.01	SYSTEM ADDITION VIA PROJECT	MAP A, SEGMENT 2
R-2598	MITCHELL	12/6/2005		SR 1119	WHITE OAK ROAD	0.06	SYSTEM DELETION VIA PROJECT	MAP A, SEGMENT 3
R-2598	MITCHELL	12/6/2005		SR 1119	WHITE OAK ROAD	0.04	SYSTEM ADDITION VIA PROJECT	MAP A, SEGMENT 4

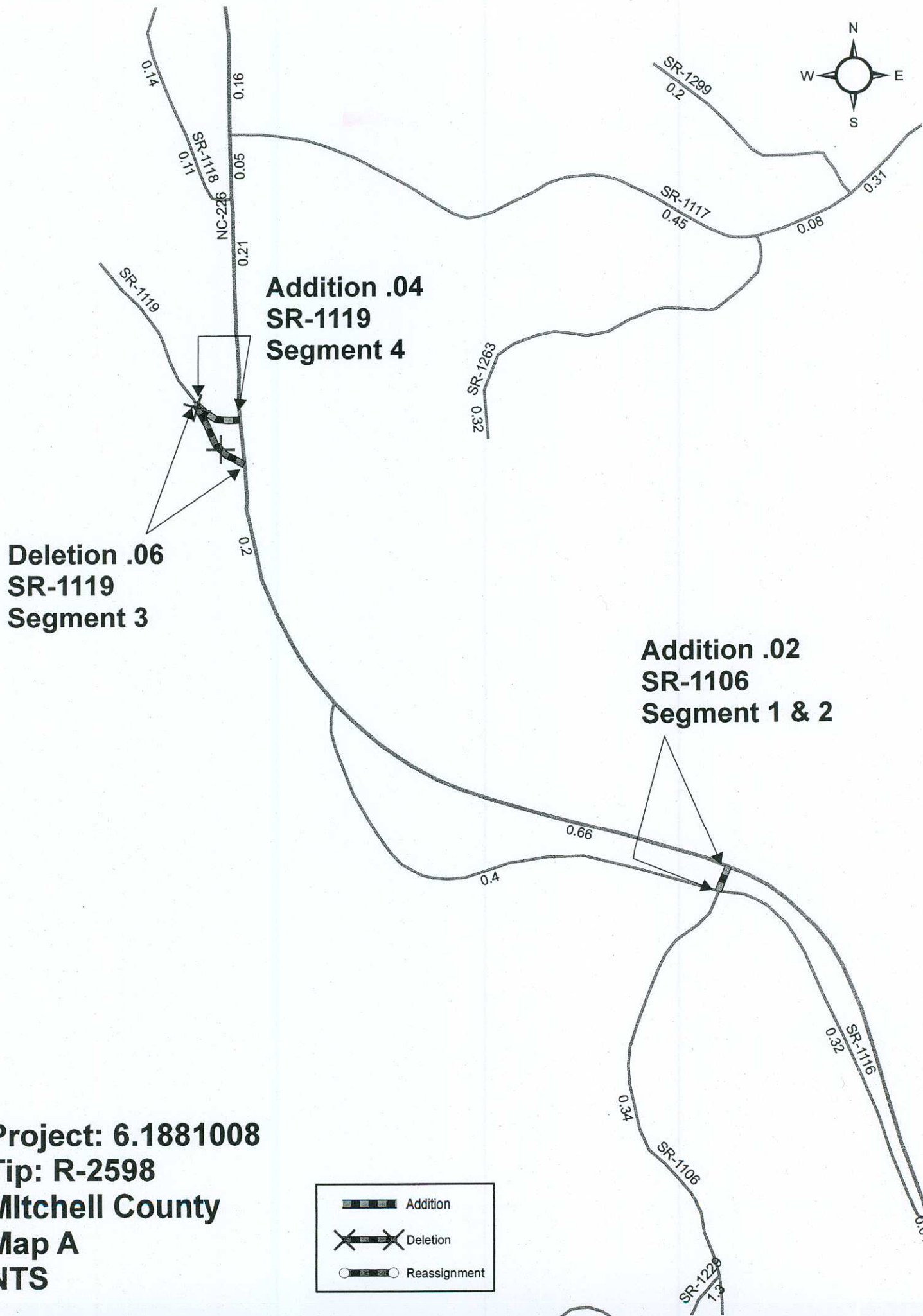

Project: 6.1881008
Tip: R-2598
Mitchell County
Map A
NTS

