



STATE OF NORTH CAROLINA
DEPARTMENT OF TRANSPORTATION

MICHAEL F. EASLEY
GOVERNOR

June 27, 2007

LYNDO TIPPETT
SECRETARY

MEMORANDUM TO: Mr. Mike Mills, PE
Division Engineer
Division 7

FROM: L.C. Smith
GIS Director

SUBJECT: 2006 District 2 Road System Changes

The Data Compilation Section has been authorized to make the following changes to the state road system as indicated below. We request that you make similar changes to the related maps and files in your Division and District offices, and install appropriate road number signs if necessary. We have updated our records and county maps accordingly. If our system changes do not conform to the actual conditions in the field, please return this memorandum with recommendations.

Hwy. Ordinance #	County	Approval Date
HTO US311	GUILFORD	12/30/2005

Inquires about changes should be referred to one of the following: Ron Tucker (Div 3,6,7,8) at (919) 212-6080, Ron Nealy (Div 5,9,11,13,14) at (919) 212-5980, or Lori Mann (Div 1,2,4,10,12) at (919) 212-6075. If you have further questions, please contact Hardee Cox, Data Compilation Section Manger at (919) 212-6060. Thank you for your assistance.

LCS/hrc
enclosures ()

cc: BSIP
Bridge Maintenance
Division Right of Way
Pavement Management
Permit Unit
State Road Maintenance
Traffic Engineering
Traffic Surveys

MAILING ADDRESS:
NC DEPARTMENT OF TRANSPORTATION
GEOGRAPHIC INFORMATION SYSTEMS
1587 MAIL SERVICE CENTER
RALEIGH NC 27699-1587



DELIVERY ADDRESS:
3401 CARL SANDBURG CT.
RALEIGH, NC 27610
PHONE: (919) 212-6000
FAX: (919) 212-5999

2006 ROAD SYSTEM CHANGES

HWY. ORDINANCE	COUNTY	APPROVAL DATE	NEW NUMBER	EXISTING NUMBER	STREET NAME	LENGTH (miles)	TYPE OF CHANGE	REMARKS (See Attached Map)
HTO US311	GUILFORD	12/30/2005	US 311 BUS	US 311	MAIN ST	5.33	NUMBER REASSIGNMENT VIA HIGHWAY TRAFFIC ORD	MAP A, SEGMENT 1
HTO US311	GUILFORD	12/30/2005	US 311 BUS NBL	US 311 NBL	MAIN ST	1.17	NUMBER REASSIGNMENT VIA HIGHWAY TRAFFIC ORD	MAP B, SEGMENT 1
HTO US311	GUILFORD	12/30/2005	I- 85 BUS US 29/70 US 311	I- 85 BUS US 29/70	I-85B	1.33	NUMBER REASSIGNMENT VIA HIGHWAY TRAFFIC ORD	MAP A, SEGMENT 2
HTO US311	GUILFORD	12/30/2005	US 311 NBL	SR 1979 SBL		2.66	SYSTEM REASSIGNMENT VIA HIGHWAY TRAFFIC ORD	MAP B, SEGMENT 2
HTO US311	GUILFORD	12/30/2005	US 311 SBL	SR 1979 NBL		2.27	SYSTEM REASSIGNMENT VIA HIGHWAY TRAFFIC ORD	MAP B, SEGMENT 3
HTO US311	GUILFORD	12/30/2005	US 311 BUS SBL	US 311 SBL	MAIN ST	0.72	NUMBER REASSIGNMENT VIA HIGHWAY TRAFFIC ORD	MAP B, SEGMENT 4

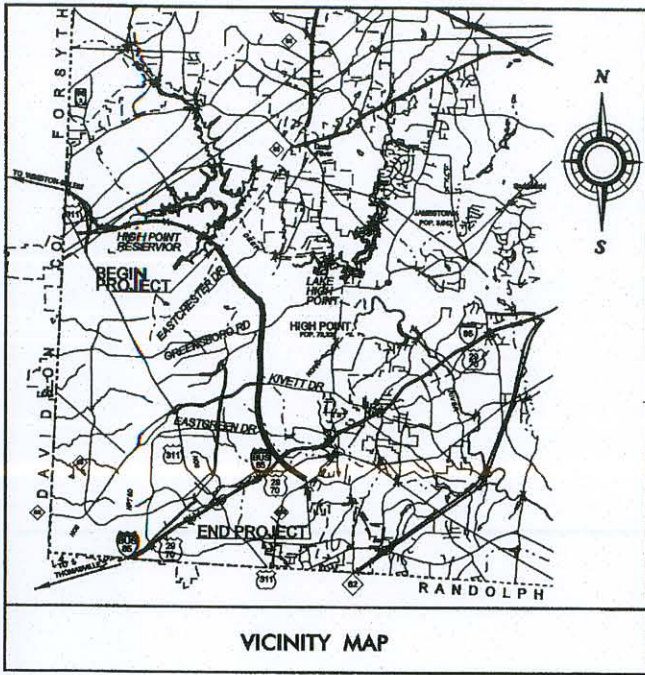

Number Reassignment 5.33
 US-311 to US-311B
 Segment 1

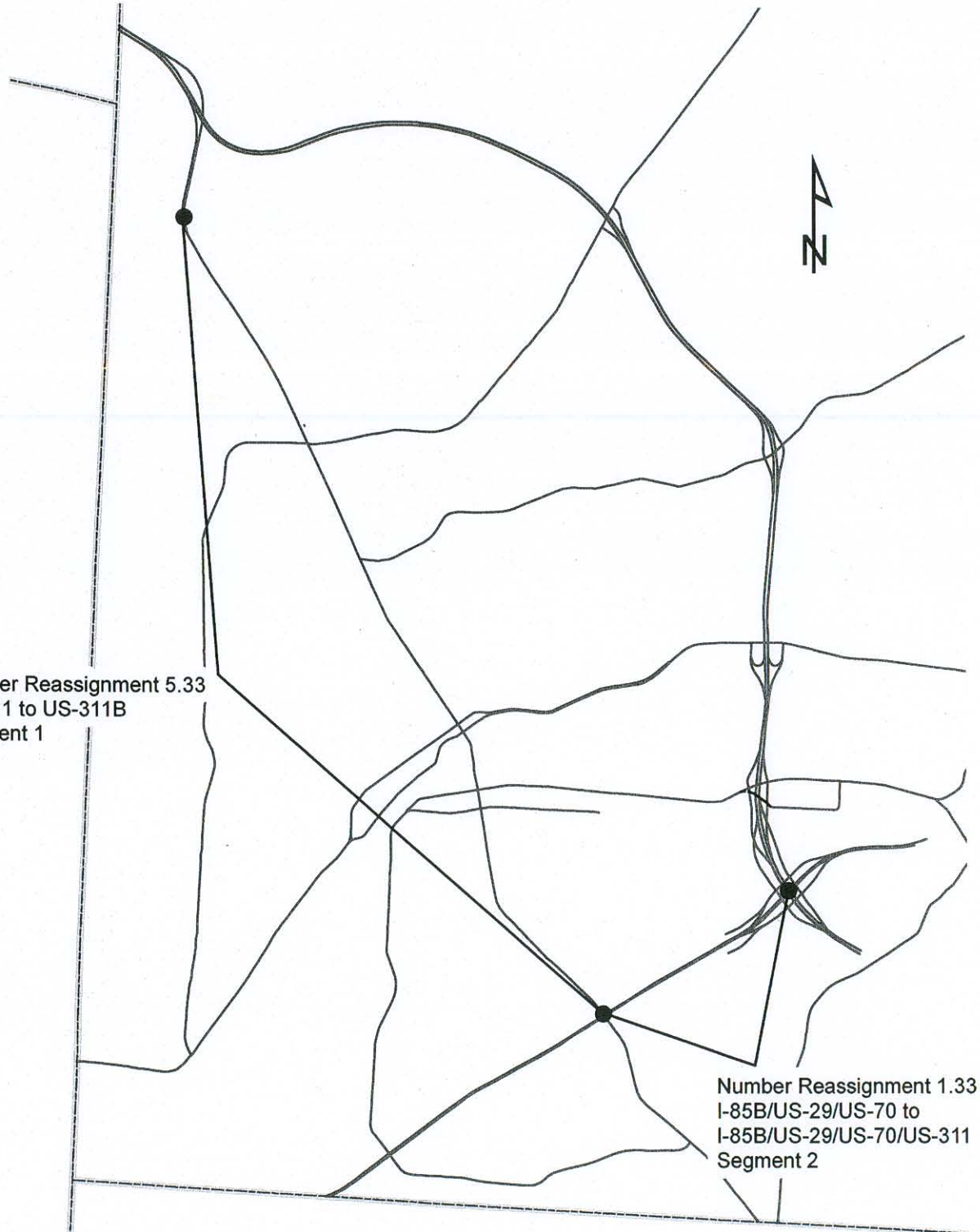

Project: HTO US 311
 Guilford County
 Map A
 NTS

Project: HTO US 311
Guilford County
Map B
NTS

Number Reassignment .72
US 311 SBL to US 311B SBL
Segment 4

Number Reassignment 1.17
US 311 NBL to US 311B NBL
Segment 1

Number Reassignment 2.66
SR 1979 SBL to US 311 NBL
Segment 2

Number Reassignment 2.27
SR 1979 NBL to US 311 SBL
Segment 3

