



STATE OF NORTH CAROLINA
DEPARTMENT OF TRANSPORTATION

MICHAEL F. EASLEY
GOVERNOR

February 06, 2006

LYNDO TIPPETT
SECRETARY

MEMORANDUM TO: Mr. Mike Mills, PE
Division Engineer
Division 7

FROM: L.C. Smith
GIS Director

SUBJECT: 2005 District 1 Road System Changes

The Road Inventory Section has been authorized to make the following changes to the state road system as indicated below. We request that you make similar changes to the related maps and files in your Division and District offices, and install appropriate road number signs if necessary. We have updated our records and county maps accordingly. If our system changes do not conform to the actual conditions in the field, please return this memorandum with recommendations.

Petition Number	County	Approval Date
47670	ALAMANCE	12/1/2005

Inquires about secondary road petition changes should be referred to Ron Tucker, Secondary Roads Group Supervisor at (919) 212-6080. Inquires about TIP Project changes should be referred to Tom Schroeder, Primary Highway Group Supervisor at (919) 212-6074. If you have further questions, please contact Hardee Cox, Road Inventory Manager at (919) 212-6060. Thank you for your assistance.

LCS/hrc
enclosures ()

cc: BSIP
Bridge Maintenance
Pavement Management
Permit Unit
Right of Way
Safety Management
State Road Maintenance
Traffic Engineering
Traffic Surveys

2005 ROAD SYSTEM CHANGES

PETITION NUMBER	COUNTY	APPROVAL DATE	NEW NUMBER	EXISTING NUMBER	STREET NAME	LENGTH (miles)	TYPE OF CHANGE	REMARKS (See Attached Map)
47670	ALAMANCE	12/1/2005	SR 2510		FERNWAY DRIVE	0.40	SYSTEM ADDITION VIA PETITION	MAP A, SEGMENT 1
47670	ALAMANCE	12/1/2005	SR 2511		MOSSY LANE	0.05	SYSTEM ADDITION VIA PETITION	MAP A, SEGMENT 2
47670	ALAMANCE	12/1/2005	SR 2512		CLOVER COURT	0.13	SYSTEM ADDITION VIA PETITION	MAP A, SEGMENT 3
47670	ALAMANCE	12/1/2005	SR 2513		BRIGHTWOOD DRIVE	0.11	SYSTEM ADDITION VIA PETITION	MAP A, SEGMENT 4
47670	ALAMANCE	12/1/2005	SR 2514		CREEKVIEW COURT	0.08	SYSTEM ADDITION VIA PETITION	MAP A, SEGMENT 5
47670	ALAMANCE	12/1/2005	SR 2515		CROSSRIDGE DRIVE	0.05	SYSTEM ADDITION VIA PETITION	MAP A, SEGMENT 6

MAP A

DATE 1/30/96

ADDITION ADDITION

DELETION _____

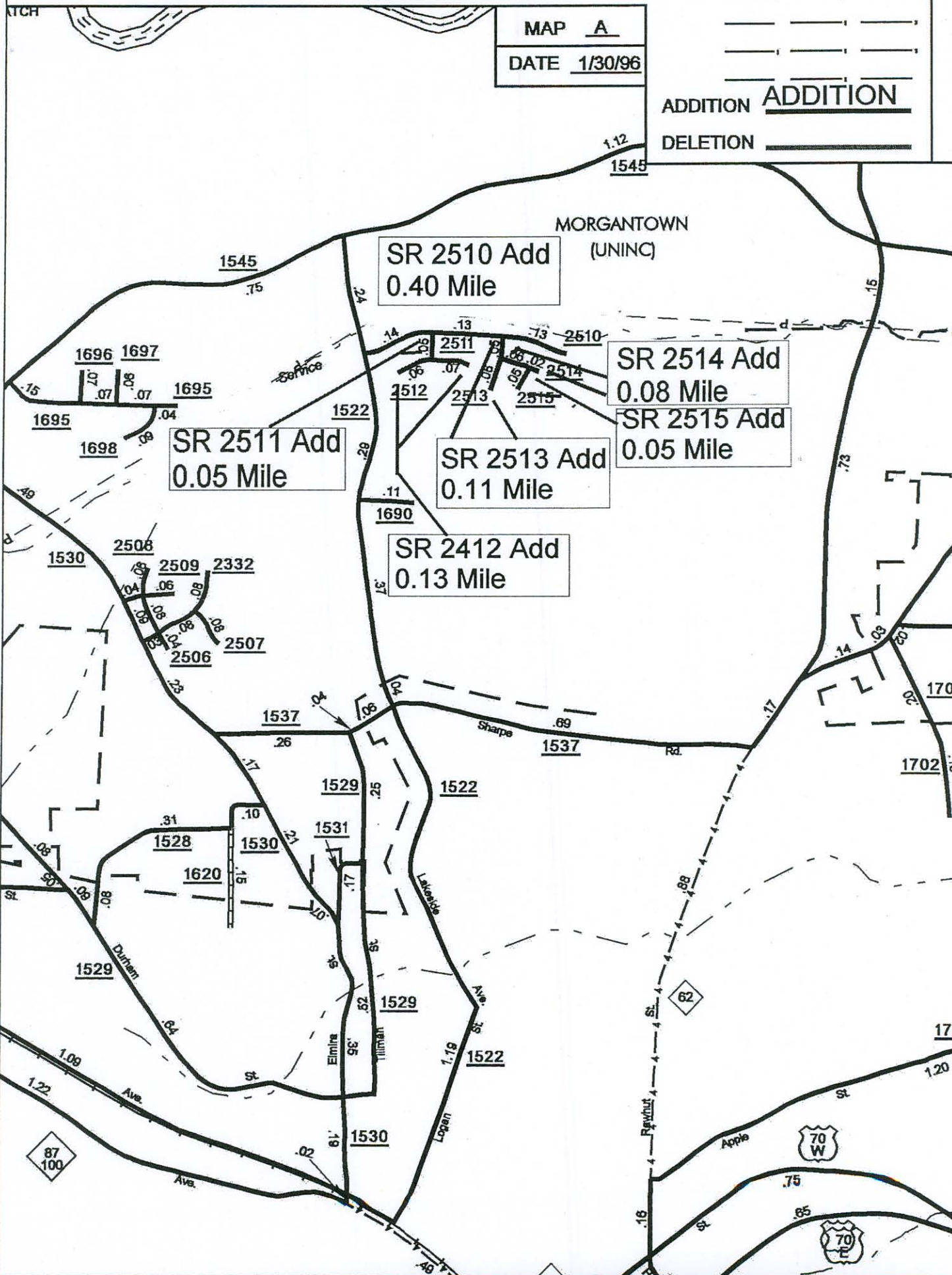

SR 2510 Add
0.40 Mile

SR 2514 Add
0.08 Mile

SR 2515 Add
0.05 Mile

SR 2511 Add
0.05 Mile

SR 2513 Add
0.11 Mile

SR 2412 Add
0.13 Mile