



STATE OF NORTH CAROLINA
DEPARTMENT OF TRANSPORTATION

MICHAEL F. EASLEY
GOVERNOR

December 14, 2005

LYNDO TIPPETT
SECRETARY

MEMORANDUM TO: Mr. Mike Mills, PE
Division Engineer
Division 7

FROM: L.C. Smith
GIS Director

SUBJECT: 2005 District 2 Road System Changes

The Road Inventory Section has been authorized to make the following changes to the state road system as indicated below. We request that you make similar changes to the related maps and files in your Division and District offices, and install appropriate road number signs if necessary. We have updated our records and county maps accordingly. If our system changes do not conform to the actual conditions in the field, please return this memorandum with recommendations.

Petition Number	County	Approval Date
47628	GUILFORD	11/3/2005

Inquires about secondary road petition changes should be referred to Ron Tucker, Secondary Roads Group Supervisor at (919) 212-6080. Inquires about TIP Project changes should be referred to Tom Schroeder, Primary Highway Group Supervisor at (919) 212-6074. If you have further questions, please contact Hardee Cox, Road Inventory Manager at (919) 212-6060. Thank you for your assistance.

LCS/hrc
enclosures ()

- cc: BSIP
Bridge Maintenance
Pavement Management
Permit Unit
Right of Way
Safety Management
State Road Maintenance
Traffic Engineering
Traffic Surveys

2005 ROAD SYSTEM CHANGES

PETITION NUMBER	COUNTY	APPROVAL DATE	NEW NUMBER	EXISTING NUMBER	STREET NAME	LENGTH (miles)	TYPE OF CHANGE	REMARKS (See Attached Map)
47628	GUILFORD	11/3/2005	SR 3742		OAKMOOR DRIVE	0.44	SYSTEM ADDITION VIA PETITION	MAP A, SEGMENT 1
47628	GUILFORD	11/3/2005	SR 3743		BEARWICK CIRCLE	0.07	SYSTEM ADDITION VIA PETITION	MAP A, SEGMENT 2
47628	GUILFORD	11/3/2005	SR 3744		SMITHFIELD DRIVE	0.15	SYSTEM ADDITION VIA PETITION	MAP A, SEGMENT 3
47628	GUILFORD	11/3/2005	SR 3745		OAKMOOR CIRCLE	0.06	SYSTEM ADDITION VIA PETITION	MAP A, SEGMENT 4
47628	GUILFORD	11/3/2005	SR 3746		OLD WELL PLACE	0.14	SYSTEM ADDITION VIA PETITION	MAP A, SEGMENT 5
47628	GUILFORD	11/3/2005	SR 3747		LAUREL OAKS DRIVE	0.24	SYSTEM ADDITION VIA PETITION	MAP A, SEGMENT 6
47628	GUILFORD	11/3/2005	SR 3748		SHAW FARM CIRCLE	0.24	SYSTEM ADDITION VIA PETITION	MAP A, SEGMENT 7
47628	GUILFORD	11/3/2005	SR 3749		SOUTHEAST DRIVE	0.11	SYSTEM ADDITION VIA PETITION	MAP A, SEGMENT 8
47628	GUILFORD	11/3/2005	SR 3750		BELL TOWER COURT	0.13	SYSTEM ADDITION VIA PETITION	MAP A, SEGMENT 9

PETITION #: 47628

CO: Gullford

SR #: 3746, 3747, 3748,

3749, 3750, _____,

_____, _____,

_____, _____

ADDITION X

DELETION _____



MAP A
DATE 11/21/05

SR 3747 add .24 miles

SR 3749 add .11 miles

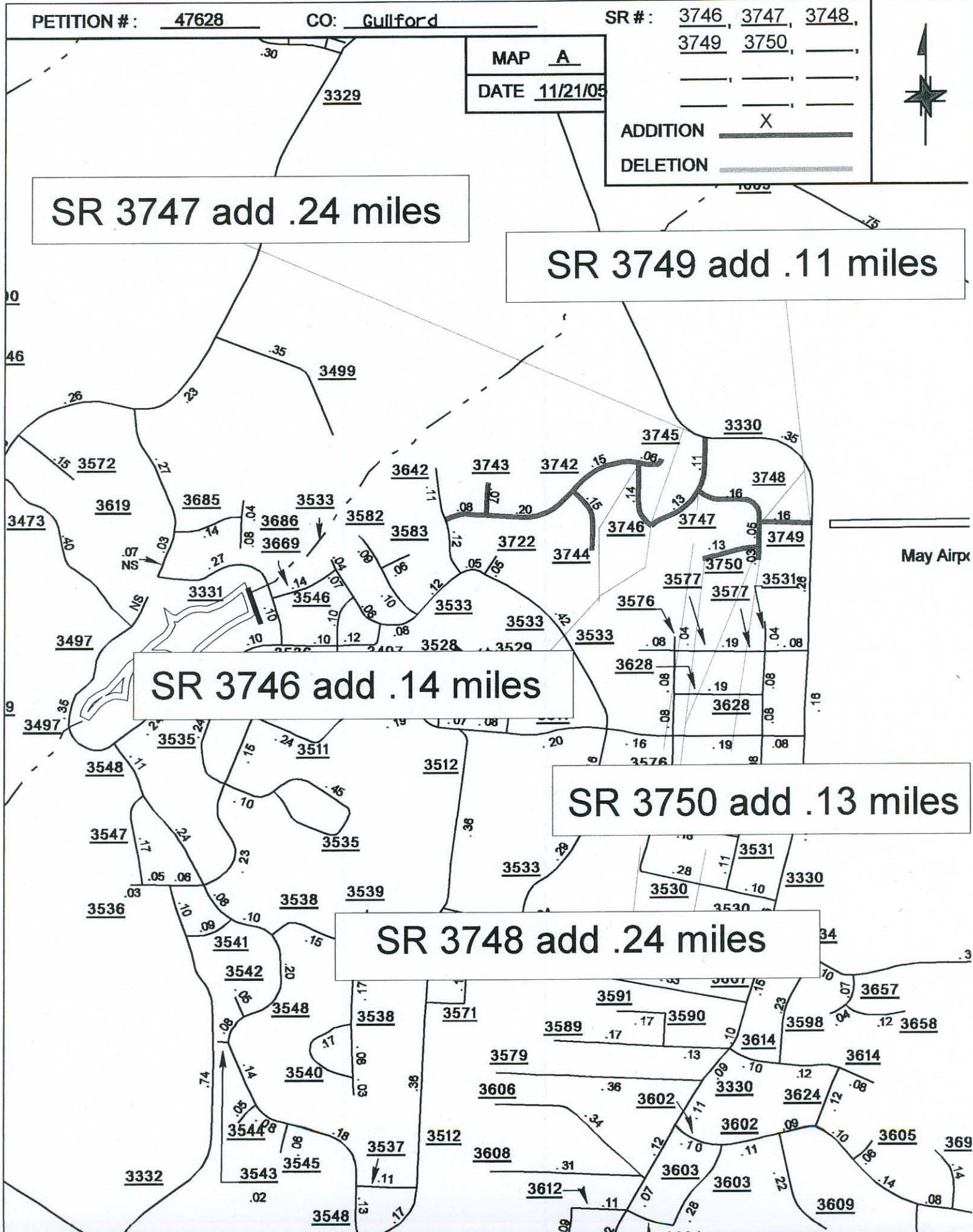

SR 3746 add .14 miles

SR 3750 add .13 miles

SR 3748 add .24 miles

PETITION #: 47628

CO: Gulford

SR #: 3742, 3743, 3744,

3745 _____,

_____, _____,

_____, _____,

ADDITION X

DELETION _____

MAP A

DATE 11/21/05



SR 3742 add .44 miles

SR 3743 add .07 miles

SR 3744 add .15 miles

SR 3745 add .06 miles

May Airp

