



STATE OF NORTH CAROLINA  
DEPARTMENT OF TRANSPORTATION

MICHAEL F EASLEY  
GOVERNOR

September 21, 2005

LYNDO TIPPETT  
SECRETARY

**MEMORANDUM TO:** Mr Michael A Pettyjohn, PE  
Division Engineer  
Division 11

**FROM:** L C Smith  
GIS Director

**SUBJECT:** 2005 District 2 Road System Changes

The Road Inventory Section has been authorized to make the following changes to the state road system as indicated below We request that you make similar changes to the related maps and files in your Division and District offices, and install appropriate road number signs if necessary We have updated our records and county maps accordingly If our system changes do not conform to the actual conditions in the field, please return this memorandum with recommendations

| Petition Number | County | Approval Date |
|-----------------|--------|---------------|
| 47550           | AVERY  | 10/6/05       |

Inquires about secondary road petition changes should be referred to Ron Tucker, Secondary Roads Group Supervisor at (919) 212-6080 Inquires about TIP Project changes should be referred to Tom Schroeder, Primary Highway Group Supervisor at (919) 212-6074 If you have further questions, please contact Hardee Cox, Road Inventory Manager at (919) 212-6060 Thank you for your assistance

LCS/hrc  
enclosures ( )

- cc BSIP
- Bridge Maintenance
- Pavement Management
- Permit Unit
- Right of Way
- Safety Management
- State Road Maintenance
- Traffic Engineering
- Traffic Surveys

MAILING ADDRESS  
NC DEPARTMENT OF TRANSPORTATION  
GEOGRAPHIC INFORMATION SYSTEMS  
1587 MAIL SERVICE CENTER  
RALEIGH NC 27699-1587



DELIVERY ADDRESS.  
3401 CARL SANDBURG CT  
RALEIGH, NC 27610  
PHONE (919) 212-6000  
FAX (919) 212-5999

# 2005 ROAD SYSTEM CHANGES

| PETITION NUMBER | COUNTY | APPROVAL DATE | NEW NUMBER | EXISTING NUMBER     | STREET NAME     | LENGTH (miles) | TYPE OF CHANGE               | REMARKS (See Attached Map) |
|-----------------|--------|---------------|------------|---------------------|-----------------|----------------|------------------------------|----------------------------|
| 47550           | AVERY  | 10/6/05       |            | SR 1545(PORTION OF) | LINVILLE AVENUE | 0.31           | SYSTEM DELETION VIA PETITION | MAP A, SEGMENT 1           |

PETITION # 47550

CO. AVERY

SR #: 1545

MAP A

DATE 9/21/05

ADDITION

DELETION Abandon

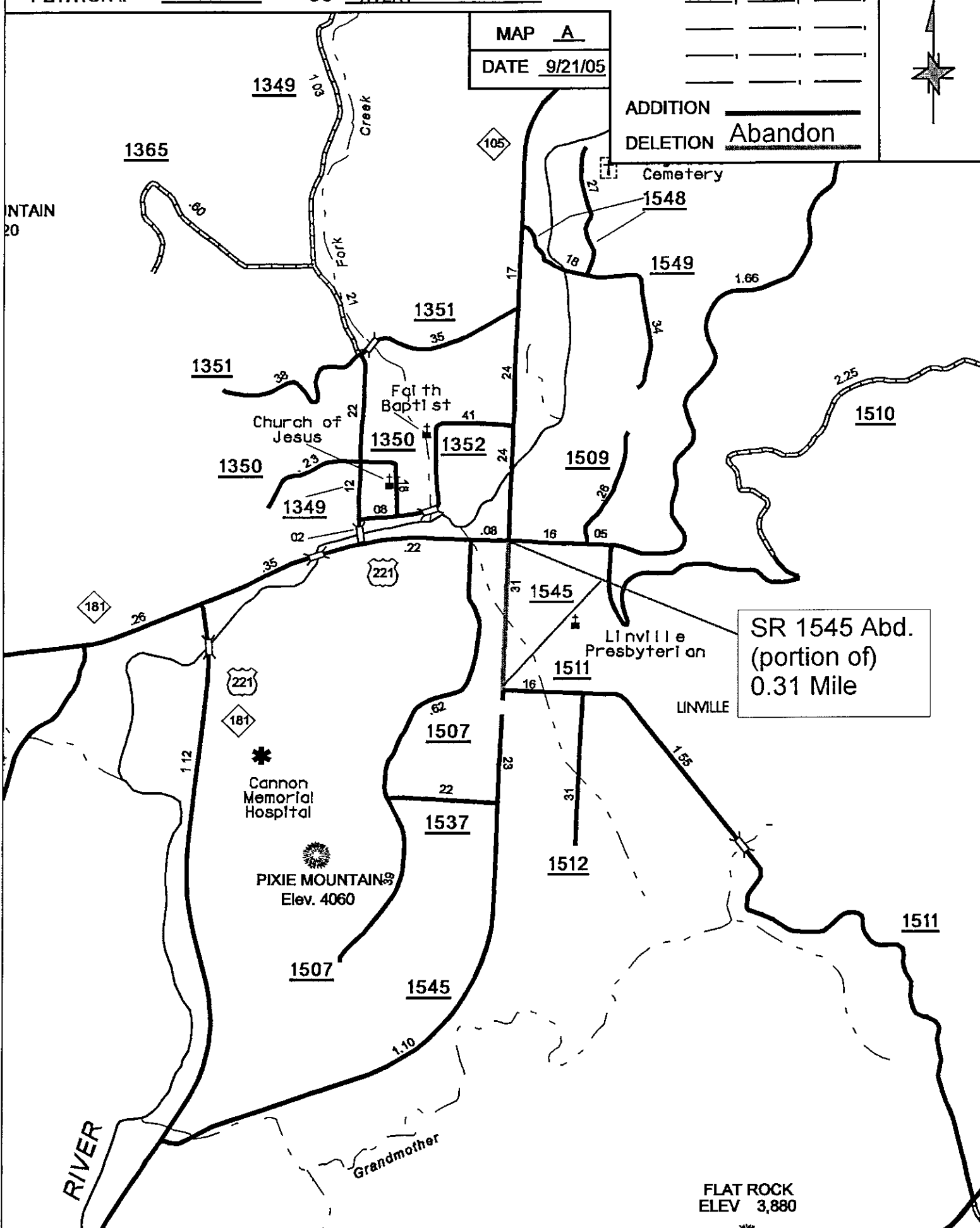

SR 1545 Abd.  
(portion of)  
0.31 Mile

FLAT ROCK  
ELEV 3,880