



STATE OF NORTH CAROLINA  
DEPARTMENT OF TRANSPORTATION

MICHAEL F. EASLEY  
GOVERNOR

Thursday, February 23, 2006

LYNDO TIPPETT  
SECRETARY

**MEMORANDUM TO:** Mr. Terry R. Gibson, PE  
Division Engineer  
Division 6

**FROM:** L.C. Smith  
GIS Director

**SUBJECT:** 2005 District 2 Road System Changes **-REVISED**

The Road Inventory Section has been authorized to make the following changes to the state road system as indicated below. We request that you make similar changes to the related maps and files in your Division and District offices, and install appropriate road number signs if necessary. We have updated our records and county maps accordingly. If our system changes do not conform to the actual conditions in the field, please return this memorandum with recommendations.

Project Number	County	Approval Date
6.449012T	CUMBERLAND	9/30/2005
8.T441307	CUMBERLAND	5/15/2005

Inquires about secondary road petition changes should be referred to Ron Tucker, Secondary Roads Group Supervisor at (919) 212-6080. Inquires about TIP Project changes should be referred to Tom Schroeder, Primary Highway Group Supervisor at (919) 212-6074. If you have further questions, please contact Hardee Cox, Road Inventory Manager at (919) 212-6060. Thank you for your assistance.

LCS/hrc  
enclosures ( )

cc: BSIP  
Bridge Maintenance  
Pavement Management  
Permit Unit  
Right of Way  
Safety Management  
State Road Maintenance  
Traffic Engineering  
Traffic Surveys

**MAILING ADDRESS:**  
NC DEPARTMENT OF TRANSPORTATION  
GEOGRAPHIC INFORMATION SYSTEMS  
1587 MAIL SERVICE CENTER  
RALEIGH NC 27699-1587

[www.ncdot.org/it/gis](http://www.ncdot.org/it/gis)

**DELIVERY ADDRESS:**  
3401 CARL SANDBURG CT.  
RALEIGH, NC 27610  
PHONE: (919) 212-6000  
FAX: (919) 212-5999

# 2005 ROAD SYSTEM CHANGES

PROJECT NUMBER	COUNTY	APPROVAL DATE	NEW NUMBER	EXISTING NUMBER	STREET NAME	LENGTH (miles)	TYPE OF CHANGE	REMARKS (See Attached Map)
6.449012T	CUMBERLAND	9/30/2005	NC 295			0.56	SYSTEM ADDITION VIA PROJECT	MAP A, SEGMENT 1
8.T441307	CUMBERLAND	5/15/2005	NC 295			3.78	SYSTEM ADDITION VIA PROJECT	MAP A, SEGMENT 1
6.449012T	CUMBERLAND	9/30/2005		SR 1932		0.25	SYSTEM DELETION VIA PROJECT	MAP A, SEGMENT 2
6.449012T	CUMBERLAND	9/30/2005		SR 1931		0.13	SYSTEM DELETION VIA PROJECT	MAP A, SEGMENT 3
6.449012T	CUMBERLAND	9/30/2005		SR 1933		0.01	SYSTEM DELETION VIA PROJECT	MAP A, SEGMENT 4
6.449012T	CUMBERLAND	9/30/2005	SR 1936			0.05	SYSTEM ADDITION VIA PROJECT	MAP A, SEGMENT 5

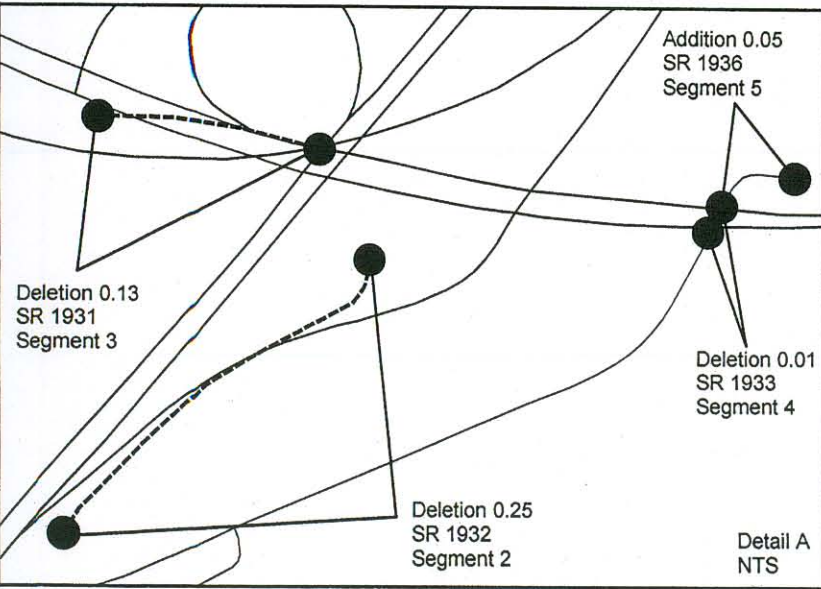
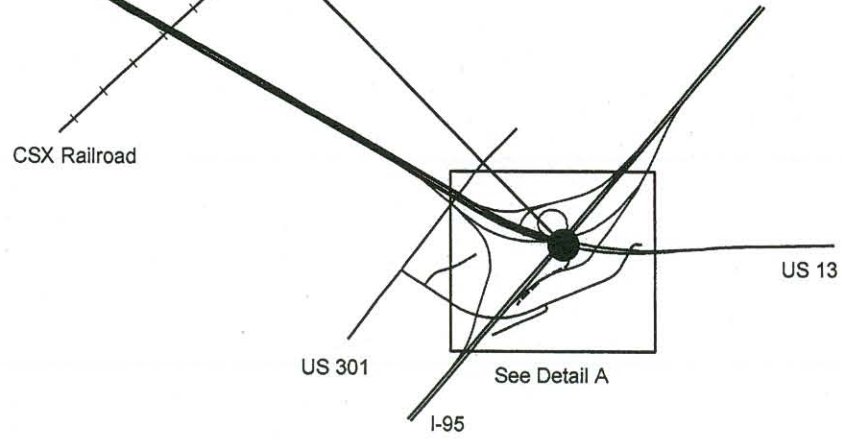
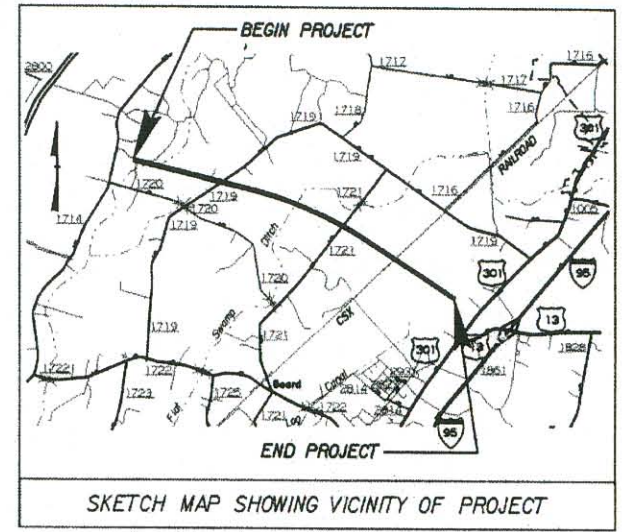
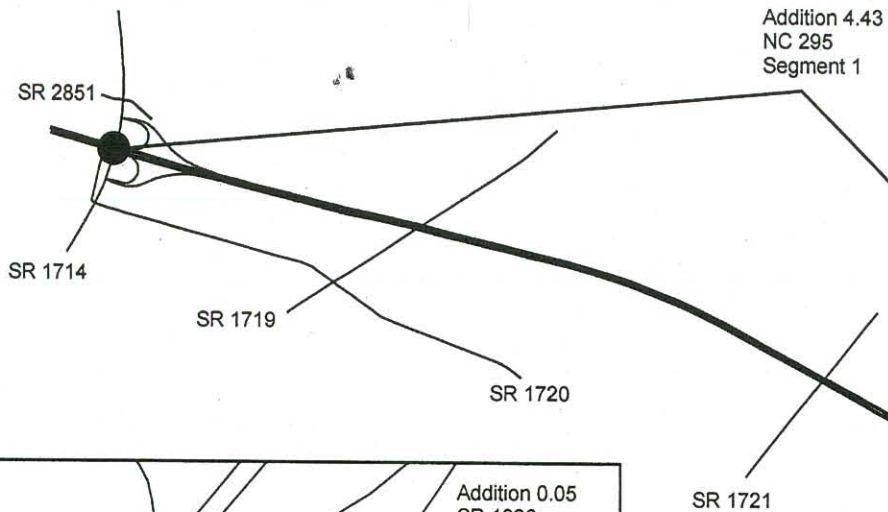

Project: 6.449012T, 8.T441307, 8.T441305  
 Tip: X-0002DD, X-0002DF, X-0002DA  
 Cumberland County  
 Map A NTS