



STATE OF NORTH CAROLINA
DEPARTMENT OF TRANSPORTATION

LYNDO TIPPETT
SECRETARY

MICHAEL F. EASLEY
GOVERNOR

02 December, 2005

MEMORANDUM TO: Mr. H. Allen Pope, PE
Division Engineer
Division 3

FROM: L.C. Smith
GIS Director

SUBJECT: 2005 District 3 Road System Changes

The Road Inventory Section has been authorized to make the following changes to the state road system as indicated below. We request that you make similar changes to the related maps and files in your Division and District offices, and install appropriate road number signs if necessary. We have updated our records and county maps accordingly. If our system changes do not conform to the actual conditions in the field, please return this memorandum with recommendations.

Petition Number	County	Approval Date
47522	NEW HANOVER	8/4/2005

Inquires about secondary road petition changes should be referred to Ron Tucker, Secondary Roads Group Supervisor at (919) 212-6080. Inquires about TIP Project changes should be referred to Tom Schroeder, Primary Highway Group Supervisor at (919) 212-6074. If you have further questions, please contact Hardee Cox, Road Inventory Manager at (919) 212-6060. Thank you for your assistance.

LCS/hrc
enclosures ()

- cc: BSIP
- Bridge Maintenance
- Pavement Management
- Permit Unit
- Right of Way
- Safety Management
- State Road Maintenance
- Traffic Engineering
- Traffic Surveys



2005 ROAD SYSTEM CHANGES

PETITION NUMBER	COUNTY	APPROVAL DATE	NEW NUMBER	EXISTING NUMBER	STREET NAME	LENGTH (miles)	TYPE OF CHANGE	REMARKS (See Attached Map)
47522	NEW HANOVER	8/4/2005		SR 2346 EXT ✓	GLENARTHUR DRIVE	0.05	SYSTEM ADDITION VIA PETITION	MAP A, SEGMENT 1
47522	NEW HANOVER	8/4/2005	SR 2375 ✓		CHELWOOD COURT	0.06	SYSTEM ADDITION VIA PETITION	MAP A, SEGMENT 2
47522	NEW HANOVER	8/4/2005	SR 2376 ✓		MACKAY COURT	0.01	SYSTEM ADDITION VIA PETITION	MAP A, SEGMENT 3
47522	NEW HANOVER	8/4/2005	SR 2377 ✓		OLIVER COURT	0.03	SYSTEM ADDITION VIA PETITION	MAP A, SEGMENT 4
47522	NEW HANOVER	8/4/2005	SR 2378 ✓		CHORLEY ROAD	0.05	SYSTEM ADDITION VIA PETITION	MAP A, SEGMENT 5
47522	NEW HANOVER	8/4/2005	SR 2379 ✓		BANCROFT DRIVE	0.15	SYSTEM ADDITION VIA PETITION	MAP A, SEGMENT 6
47522	NEW HANOVER	8/4/2005	SR 2380 ✓		DANTON STREET	0.18	SYSTEM ADDITION VIA PETITION	MAP A, SEGMENT 7
47522	NEW HANOVER	8/4/2005	SR 2381 ✓		BURROUGHS DRIVE	0.22	SYSTEM ADDITION VIA PETITION	MAP A, SEGMENT 8
47522	NEW HANOVER	8/4/2005	SR 2382 ✓		STODDARD ROAD	0.17	SYSTEM ADDITION VIA PETITION	MAP A, SEGMENT 9
47522	NEW HANOVER	8/4/2005	SR 2383 ✓		HAILSHAM DRIVE	0.29	SYSTEM ADDITION VIA PETITION	MAP A, SEGMENT 10
47522	NEW HANOVER	8/4/2005	SR 2384 ✓		WEDDERBURN DRIVE	0.22	SYSTEM ADDITION VIA PETITION	MAP A, SEGMENT 11
47522	NEW HANOVER	8/4/2005	SR 2385 ✓		TEVIOT ROAD	0.14	SYSTEM ADDITION VIA PETITION	MAP A, SEGMENT 12
47522	NEW HANOVER	8/4/2005	SR 2386 ✓		DORRINGTON DRIVE	0.28	SYSTEM ADDITION VIA PETITION	MAP A, SEGMENT 13

PETITION #: 47522

CO: New Hanover

SR #: 2346, 2375, 2376,

2377, 2378, 2379,

2380, 2381, 2382,

2383, 2384, 2385

MAP A

DATE 8/24/05

ADDITION _____

DELETION _____



2568

.09
.04
.02
.10

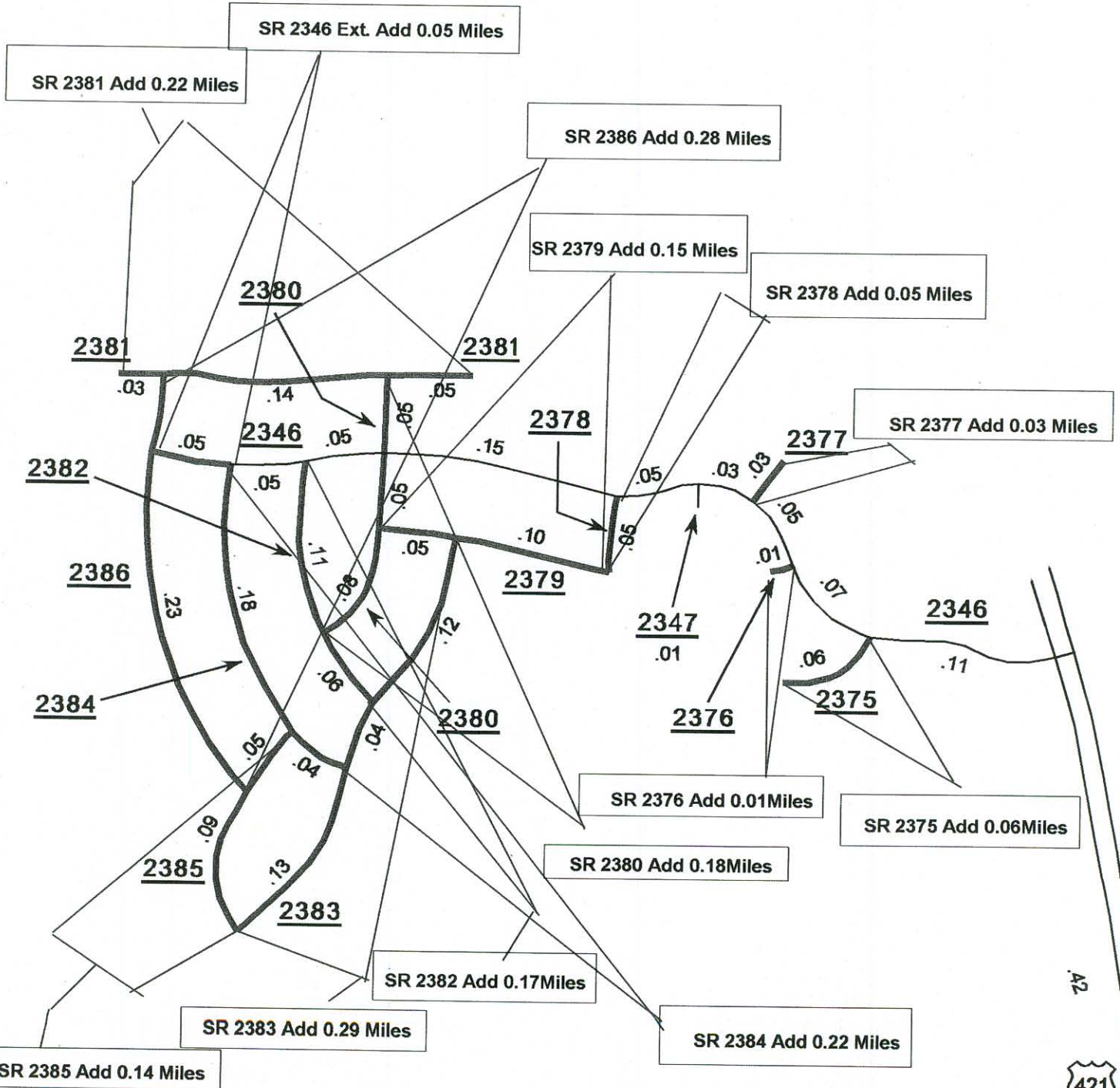

SOURCE: PLAT

SHEET: 4 OF 6

NAME: BCH

SCALE: NTS

