



STATE OF NORTH CAROLINA  
DEPARTMENT OF TRANSPORTATION

BEVERLY EAVES PERDUE  
GOVERNOR

Monday, July 26, 2010

EUGENE A. CONTI, JR  
SECRETARY

**MEMORANDUM TO:** Mr. J. Wally Bowman, PE  
Division Engineer  
Division 5

**FROM:** John C. Farley, Manager  
Geographic Information Systems Unit

**SUBJECT:** 2010 District 2 Road System Changes

The Data Conversion Group has been authorized to make the following changes to the state road system as indicated below. We request that you make similar changes to the related maps and files in your Division and District offices, and install appropriate road number signs if necessary. we have updated our records accordingly. If our system changes do not conform to the actual conditions in the field, please return this memorandum with recommendations.

Document Number	County	Approval Date
U-2102	DURHAM	6/1/2005

Inquiries about changes should be referred to the GIS Help Desk at (919) 707-2152.  
Thank you for your assistance.

JCF

- cc: BSIP
- Bridge Maintenance
- Division Right of Way
- IMG
- Pavement Management
- Permit Unit
- State Road Maintenance
- Traffic Engineering
- Traffic Surveys

# 2010 ROAD SYSTEM CHANGES

<b>DOCUMENT NUMBER</b>	<b>COUNTY</b>	<b>APPROVAL DATE</b>	<b>NEW NUMBER</b>	<b>EXISTING NUMBER</b>	<b>STREET NAME</b>	<b>LENGTH (miles)</b>	<b>TYPE OF CHANGE</b>	<b>REMARKS (See Attached Map)</b>
U-2102	DURHAM	6/1/2005		SR 1404	ROSE OF SHARON RD	0.01	SYSTEM ADDITION - EXISTING VIA TIP	MAP A, SEGMENT
U-2102	DURHAM	6/1/2005		SR 1449	UMSTEAD RD	0.06	SYSTEM DELETION VIA TIP	MAP B, SEGMENT
U-2102	DURHAM	6/1/2005		SR 1449	UMSTEAD RD	0.05	SYSTEM ADDITION - EXISTING VIA TIP	MAP B, SEGMENT
U-2102	DURHAM	6/1/2005		SR 1448	LATTA RD	0.01	SYSTEM ADDITION - EXISTING VIA TIP	MAP B, SEGMENT

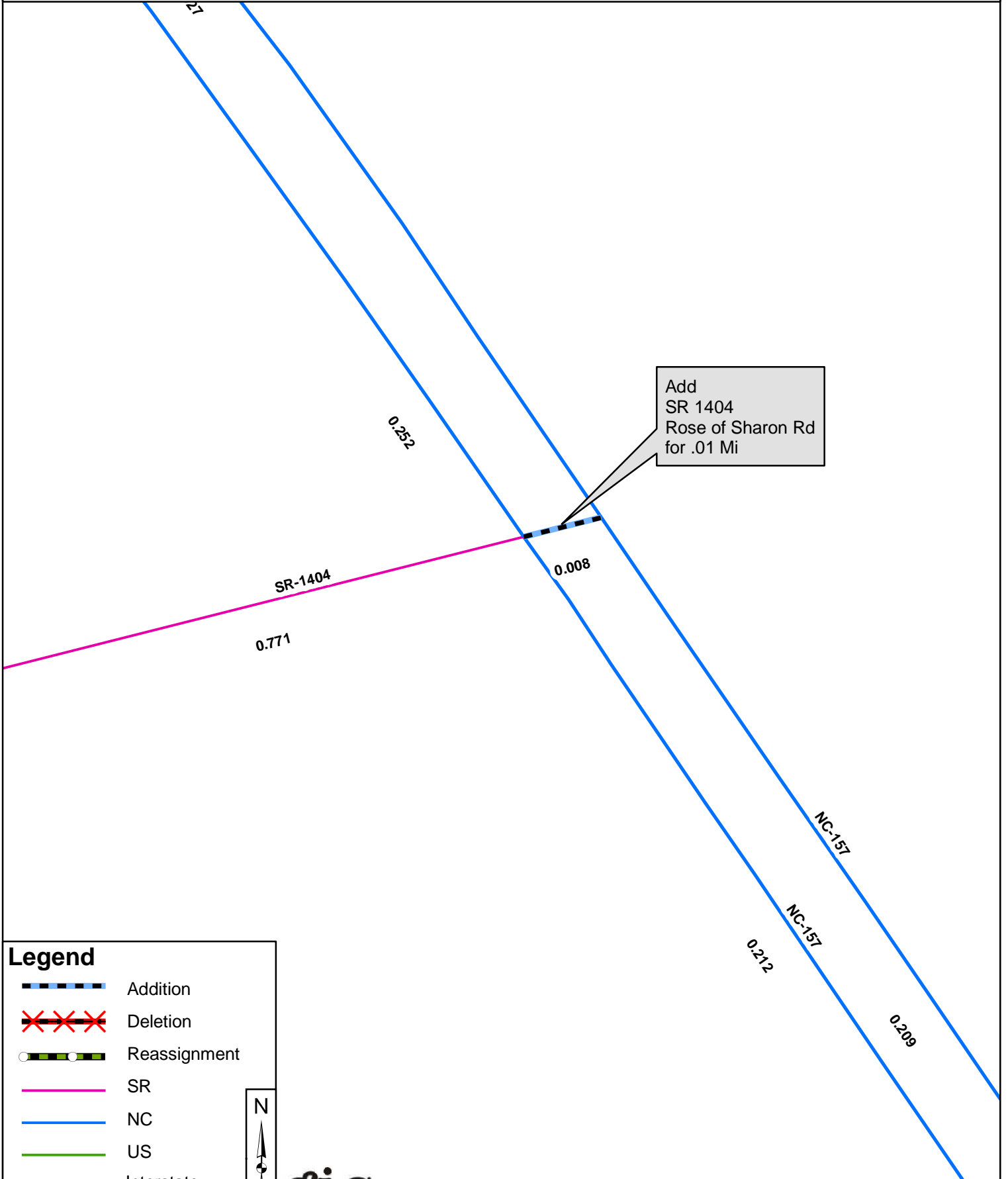

**Legend**

- Addition
- Deletion
- Reassignment
- SR
- NC
- US
- Interstate
- Ramp

N

