



STATE OF NORTH CAROLINA
DEPARTMENT OF TRANSPORTATION

MICHAEL F. EASLEY
GOVERNOR

Thursday, June 23, 2005

LYNDO TIPPETT
SECRETARY

MEMORANDUM TO: Mr. Jon G. Nance, PE
Division Engineer
Division 5

FROM: Forrest L. Robson, PE
GIS Director

SUBJECT: 2005 District 1 Road System Changes

The Road Inventory Section has been authorized to make the following changes to the state road system as indicated below. We request that you make similar changes to the related maps and files in your Division and District offices, and install appropriate road number signs if necessary. We have updated our records and county maps accordingly. If our system changes do not conform to the actual conditions in the field, please return this memorandum with recommendations.

Petition Number	County	Approval Date
47460	WAKE	6/2/05

Inquires about secondary road petition changes should be referred to Ron Tucker, Secondary Roads Group Supervisor at (919) 212-6080. Inquires about TIP Project changes should be referred to Tom Schroeder, Primary Highway Group Supervisor at (919) 212-6074. If you have further questions, please contact Hardee Cox, Road Inventory Manager at (919) 212-6060. Thank you for your assistance.

FLR/hrc
enclosures ()

cc: BSIP
Bridge Maintenance
Pavement Management
Permit Unit
Right of Way
Safety Management
State Road Maintenance
Traffic Engineering
Traffic Surveys

MAILING ADDRESS:
NC DEPARTMENT OF TRANSPORTATION
GEOGRAPHIC INFORMATION SYSTEMS
1587 MAIL SERVICE CENTER
RALEIGH NC 27699-1587



www.ncdot.org/statewide/planning/gis

DELIVERY ADDRESS:
3401 CARL SANDBURG CT.
RALEIGH, NC 27610
PHONE: (919) 212-6000
FAX: (919) 212-5999

2005 ROAD SYSTEM CHANGES

PETITION NUMBER	COUNTY	APPROVAL DATE	NEW NUMBER	EXISTING NUMBER	STREET NAME	LENGTH (miles)	TYPE OF CHANGE	REMARKS (See Attached Map)
47460	WAKE	6/2/05	SR 5416		WAKEFIELD FARM ROAD	0.61	SYSTEM ADDITION VIA PETITION	MAP A, SEGMENT 1

PETITION #: 47460

CO: Wake

SR #: 5416, _____, _____,

MAP A

DATE 6/17/05

ADDITION X

DELETION _____



SR 5416 add .61 miles

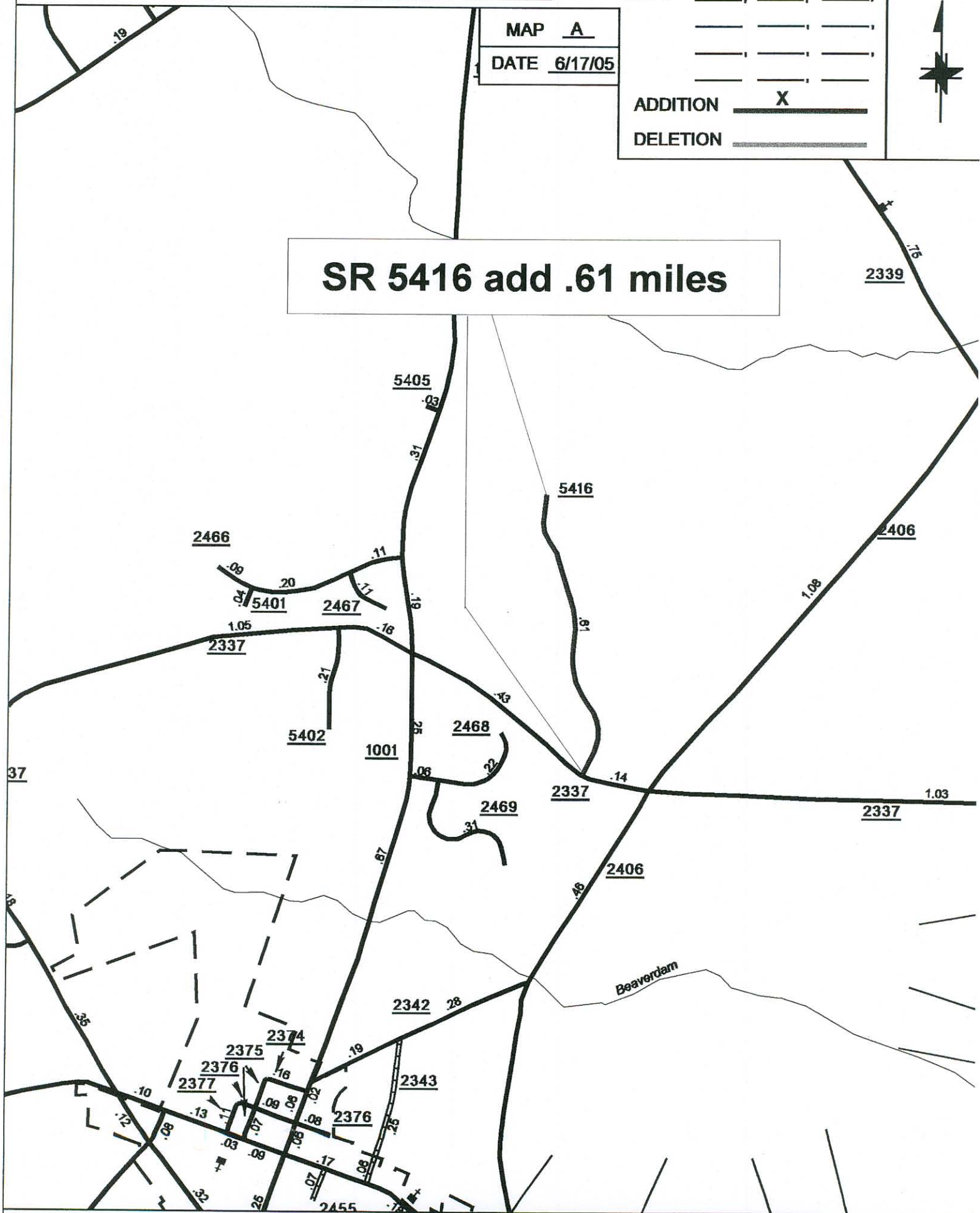

SOURCE: Plat SHEET: 7 OF 9 NAME: RLN SCALE: 4:1