



STATE OF NORTH CAROLINA
DEPARTMENT OF TRANSPORTATION

MICHAEL F. EASLEY
GOVERNOR

Friday, June 23, 2006

LYNDO TIPPETT
SECRETARY

MEMORANDUM TO: Mr. Anthony W. Roper, PE
Division Engineer
Division 1

FROM: L.C. Smith
GIS Director

SUBJECT: 2005 District 3 Road System Changes

The Road Inventory Section has been authorized to make the following changes to the state road system as indicated below. We request that you make similar changes to the related maps and files in your Division and District offices, and install appropriate road number signs if necessary. We have updated our records and county maps accordingly. If our system changes do not conform to the actual conditions in the field, please return this memorandum with recommendations.

	County	Approval Date
6.139006T	TYRRELL	8/24/2005

Inquires about secondary road petition changes should be referred to Ron Tucker, Secondary Roads Group Supervisor at (919) 212-6080. Inquires about TIP Project changes should be referred to Tom Schroeder, Primary Highway Group Supervisor at (919) 212-6074. If you have further questions, please contact Hardee Cox, Road Inventory Manager at (919) 212-6060. Thank you for your assistance.

LCS/hrc
enclosures ()

- cc: BSIP
Bridge Maintenance
Pavement Management
Permit Unit
Right of Way
Safety Management
State Road Maintenance
Traffic Engineering
Traffic Surveys

MAILING ADDRESS:
NC DEPARTMENT OF TRANSPORTATION
GEOGRAPHIC INFORMATION SYSTEMS
1587 MAIL SERVICE CENTER
RALEIGH NC 27699-1587



DELIVERY ADDRESS:
3401 CARL SANDBURG CT.
RALEIGH, NC 27610
PHONE: (919) 212-6000
FAX: (919) 212-5000

2005 ROAD SYSTEM CHANGES

	COUNTY	APPROVAL DATE	NEW NUMBER	EXISTING NUMBER	STREET NAME	LENGTH (miles)	TYPE OF CHANGE	REMARKS (See Attached Map)
6.139006T	TYRRELL	8/24/2005		SR 1117	RACCOON ROAD	0.20	SYSTEM DELETION VIA FIELD RESEARCH	MAP A, SEGMENT 1
6.139006T	TYRRELL	8/24/2005		NC 94		0.43	SYSTEM ADDITION VIA FIELD RESEARCH	MAP B, SEGMENT 1
6.139006T	TYRRELL	8/24/2005		SR 1110	OLD COLUMBIA ROAD	0.05	SYSTEM DELETION VIA FIELD RESEARCH	MAP C, SEGMENT 1
6.139006T	TYRRELL	8/24/2005	SR 1113	SR 1110		2.18	NUMBER REASSIGNMENT VIA FIELD RESEARCH	MAP D, SEGMENT 1
6.139006T	TYRRELL	8/24/2005		NC 94		0.58	SYSTEM ADDITION VIA FIELD RESEARCH	MAP E, SEGMENT 1
6.139006T	TYRRELL	8/24/2005		US 64 NC 94		0.08	SYSTEM DELETION VIA FIELD RESEARCH	MAP F, SEGMENT 1
6.139006T	TYRRELL	8/24/2005	NC 94	US 64 NC 94		6.03	SYSTEM REASSIGNMENT VIA FIELD RESEARCH	MAP G, SEGMENT 1
6.139006T	TYRRELL	8/24/2005		SR 1117	RACCOON ROAD	0.02	SYSTEM ADDITION VIA FIELD RESEARCH	MAP A, SEGMENT 2
6.139006T	TYRRELL	8/24/2005		NC 94		0.41	SYSTEM DELETION VIA FIELD RESEARCH	MAP B, SEGMENT 2
6.139006T	TYRRELL	8/24/2005		SR 1113	TRAVIS RD	0.67	SYSTEM ADDITION VIA FIELD RESEARCH	MAP C, SEGMENT 2
6.139006T	TYRRELL	8/24/2005		SR 1113		0.06	SYSTEM ADDITION VIA FIELD RESEARCH	MAP D, SEGMENT 2
6.139006T	TYRRELL	8/24/2005		NC 94		0.54	SYSTEM DELETION VIA FIELD RESEARCH	MAP E, SEGMENT 2
6.139006T	TYRRELL	8/24/2005		NC 94		0.06	SYSTEM ADDITION VIA FIELD RESEARCH	MAP F, SEGMENT 2

	COUNTY	APPROVAL DATE	NEW NUMBER	EXISTING NUMBER	STREET NAME	LENGTH (miles)	TYPE OF CHANGE	REMARKS (See Attached Map)
6.139006T	TYRRELL	8/24/2005		US 64		6.01	SYSTEM ADDITION VIA FIELD RESEARCH	MAP G, SEGMENT 2
6.139006T	TYRRELL	8/24/2005		SR 1113		0.38	SYSTEM DELETION VIA FIELD RESEARCH	MAP C, SEGMENT 3
6.139006T	TYRRELL	8/24/2005		SR 1110	OLD COLUMBIA ROAD	0.06	SYSTEM DELETION VIA FIELD RESEARCH	MAP D, SEGMENT 3
6.139006T	TYRRELL	8/24/2005		US 64 NC 94		0.04	SYSTEM ADDITION VIA FIELD RESEARCH	MAP F, SEGMENT 3

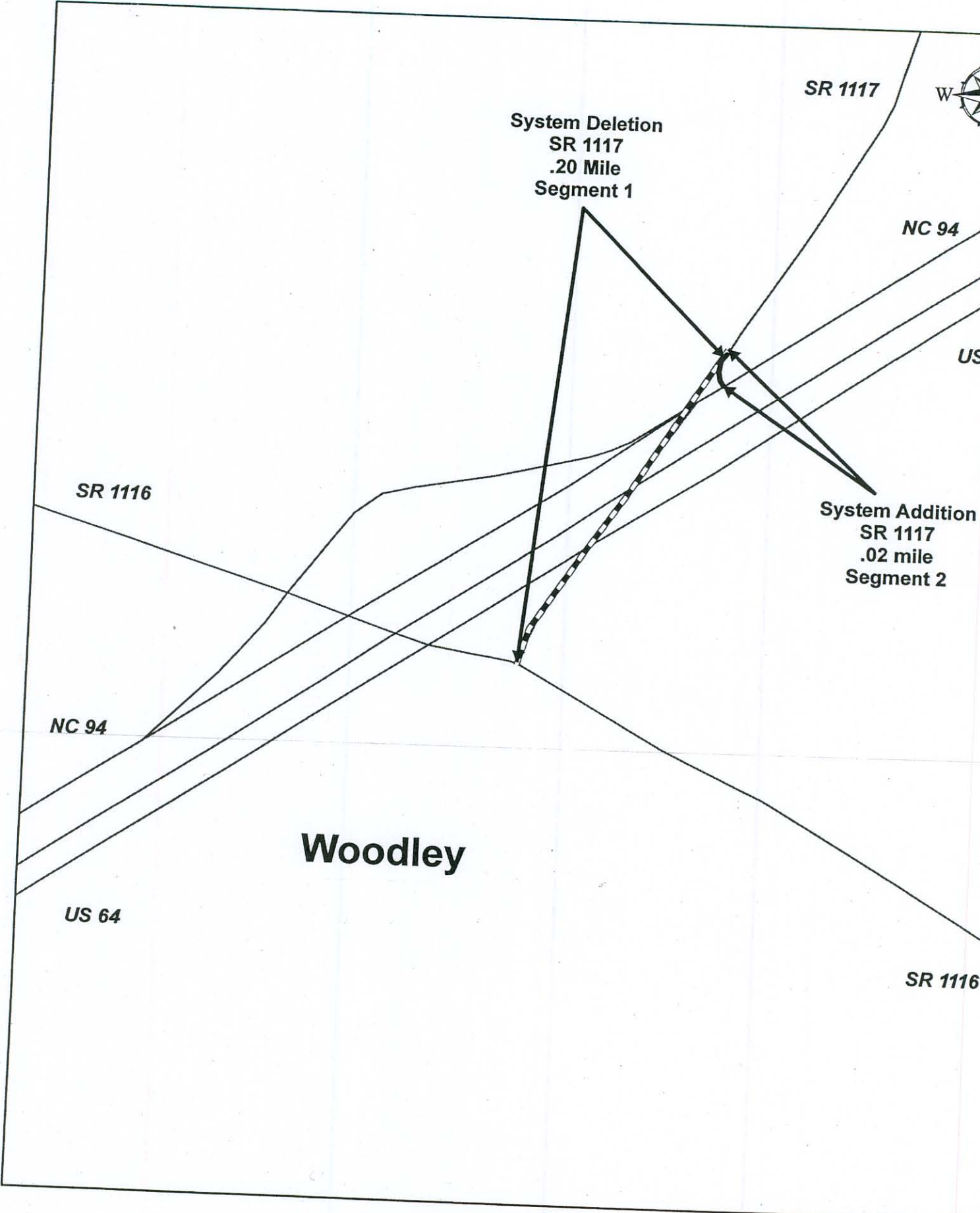

TYRRELL COUNTY
Project No. 6.139006T
TIP R-2548 E
MAP "A"



SR 1117

System Addition
NC 94
.43 mile
Segment 1

NC 94

US 64

SR 1116

System Deletion
NC 94
.41 Mile
Segment 2

NC 94

Woodley

US 64

SR 1116

TYRRELL COUNTY
Project No. 6.139006T
TIP R-2548 E
MAP "B"

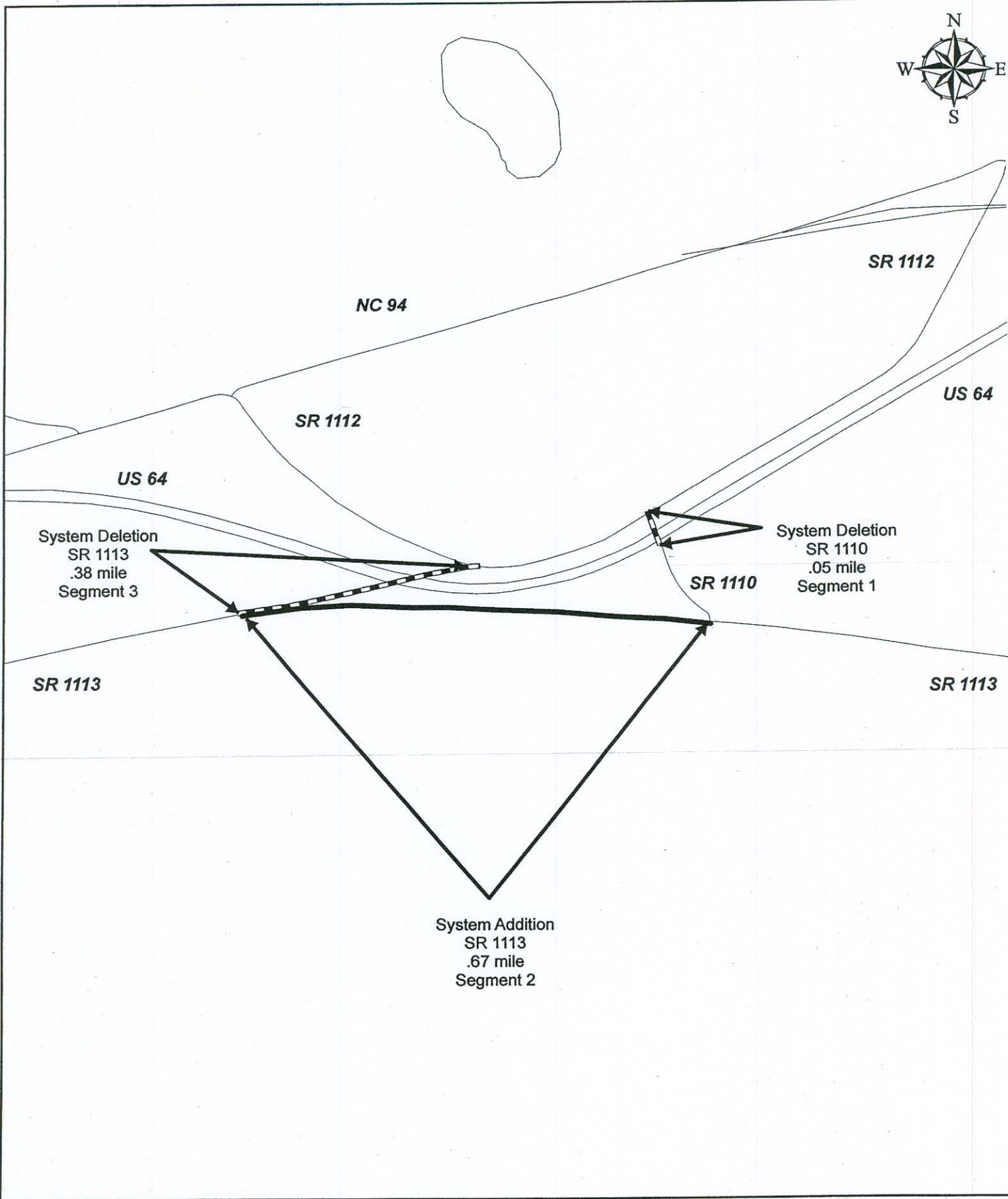

TYRRELL COUNTY
Project No. 6.139006T
TIP R-2548 E
Map "C"

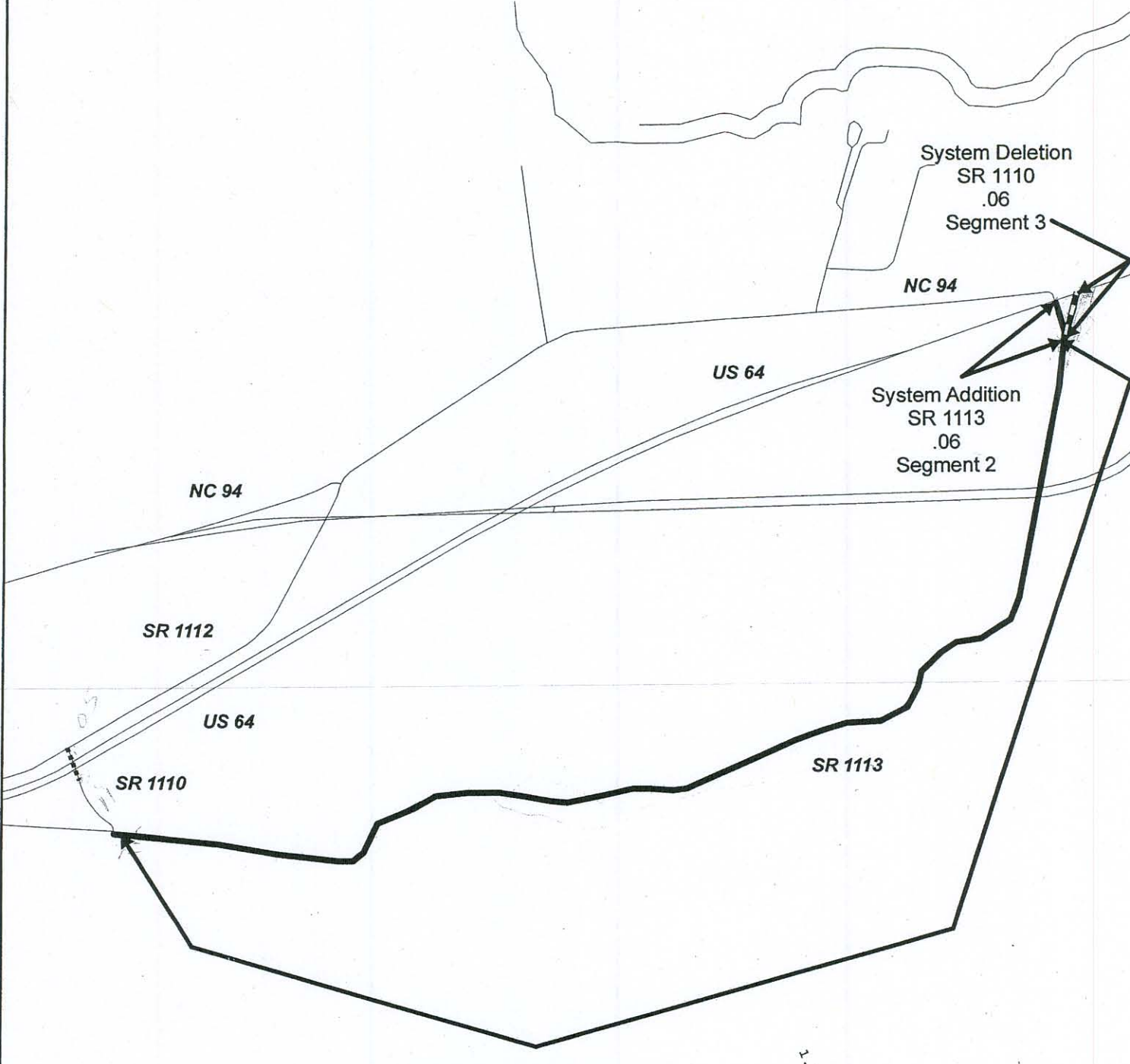

Number Reassignment
SR 1110 to SR 1113
2.18
Segment 1

xxxx1



**System Addition
NC 94
.58
Segment 1**

SR 1200

SR 1206

SR 1113

NC 94

US 64

NC 94

US 64

SR 1113

**System Deletion
NC 94
.54 mile
Segment 2**

SR 1114

SR 1115

**TYRRELL COUNTY
Project No 6.139006T
TIP R-2548 E
Map "E"**

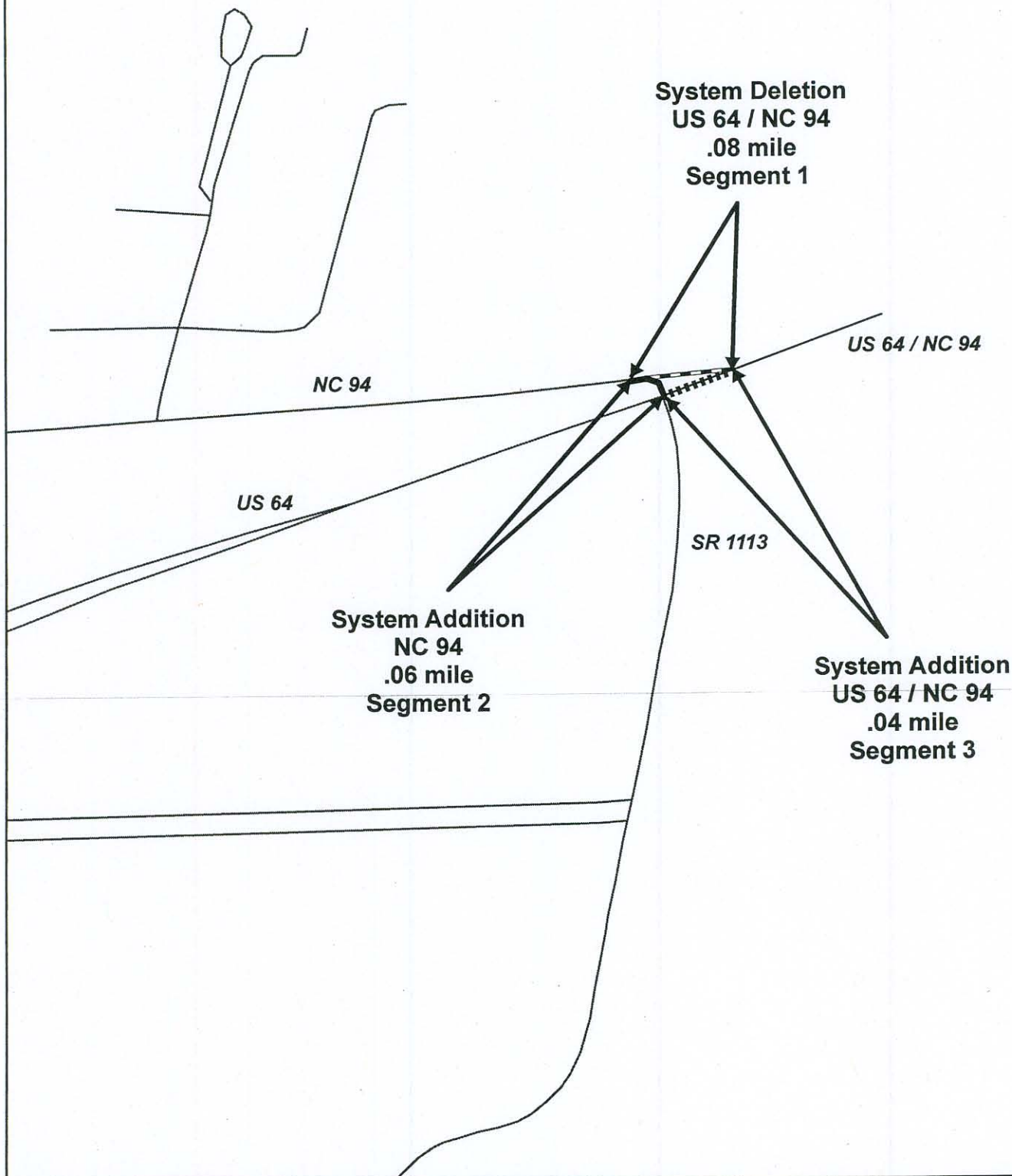

TYRRELL COUNTY
Project No. 6.149002T
TIP R-2548 E
Map "F"



**System Reassignment
US 64 / NC 94 to NC 94
6.03 miles
Segment 1**



**System Addition
US 64
6.01 miles
Segment 2**

Tyrrell
County

Washington
County

NC 94

US 64

NC 94

US 64

**TYRRELL COUNTY
Project No. 6.139006T
TIP R-2548 E
Map "G"**