



STATE OF NORTH CAROLINA
DEPARTMENT OF TRANSPORTATION

MICHAEL F EASLEY
GOVERNOR

February 11, 2005

LYNDO TIPPETT
SECRETARY

MEMORANDUM TO: Mr S Pat Ivey, PE
Division Engineer
Division 9

FROM: Forrest L Robson, PE
GIS Director

SUBJECT: 2005 District 1 Road Sytem Changes

The Road Inventory Section has been authorized to make the following changes to the state road system as indicated below We request that you make similar changes to the related maps and files in your Division and District offices, and install appropriate road number signs if necessary We have updated our records and county maps accordingly If our system changes do not conform to the actual conditions in the field please return this memorandum with recommendations

Petition Number	County	Approval Date
47304	ROWAN	1/6/05

Inquires about secondary road petition changes should be referred to Ron Tucker Secondary Roads Group Supervisor at (919) 212-6080 Inquires about TIP Project changes should be referred to Tom Schroeder, Primary Highway Group Supervisor at (919) 212-6074 If you have further questions, please contact Hardee Cox, Road Inventory Manager at (919) 212-6060 Thank you for your assistance

FLR/hrc
enclosures ()

- cc BSIP
- Bridge Maintenance
- Pavement Management
- Permit Unit
- Right of Way
- Safety Management
- State Road Maintenance
- Traffic Engineering
- Traffic Surveys

Corrected Copy

MAILING ADDRESS
NC DEPARTMENT OF TRANSPORTATION
GEOGRAPHIC INFORMATION SYSTEMS
1587 MAIL SERVICE CENTER
RALEIGH NC 27699-1587



www.ncdot.org/statewide/planning/gis

DELIVERY ADDRESS
3401 CARL SANDBURG CT
RALEIGH, NC 27610
PHONE (919) 212-6000
FAX (919) 212-5999

2005 ROAD SYSTEM CHANGES

PETITION NUMBER	COUNTY	APPROVAL DATE	NEW NUMBER	EXISTING NUMBER	STREET NAME	LENGTH (miles)	TYPE OF CHANGE	REMARKS (See Attached Map)
47304	ROWAN	1/6/05	SR 2675		COPPER LEAF LANE	0.19	SYSTEM ADDITION VIA PETITION	MAP A SEGMENT 1

PETITION #: 47304

CO ROWAN

SR #: 2675, _____, _____

2537

1002

MAP A

DATE 02/11/05



ADDITION ADD

DELETION _____

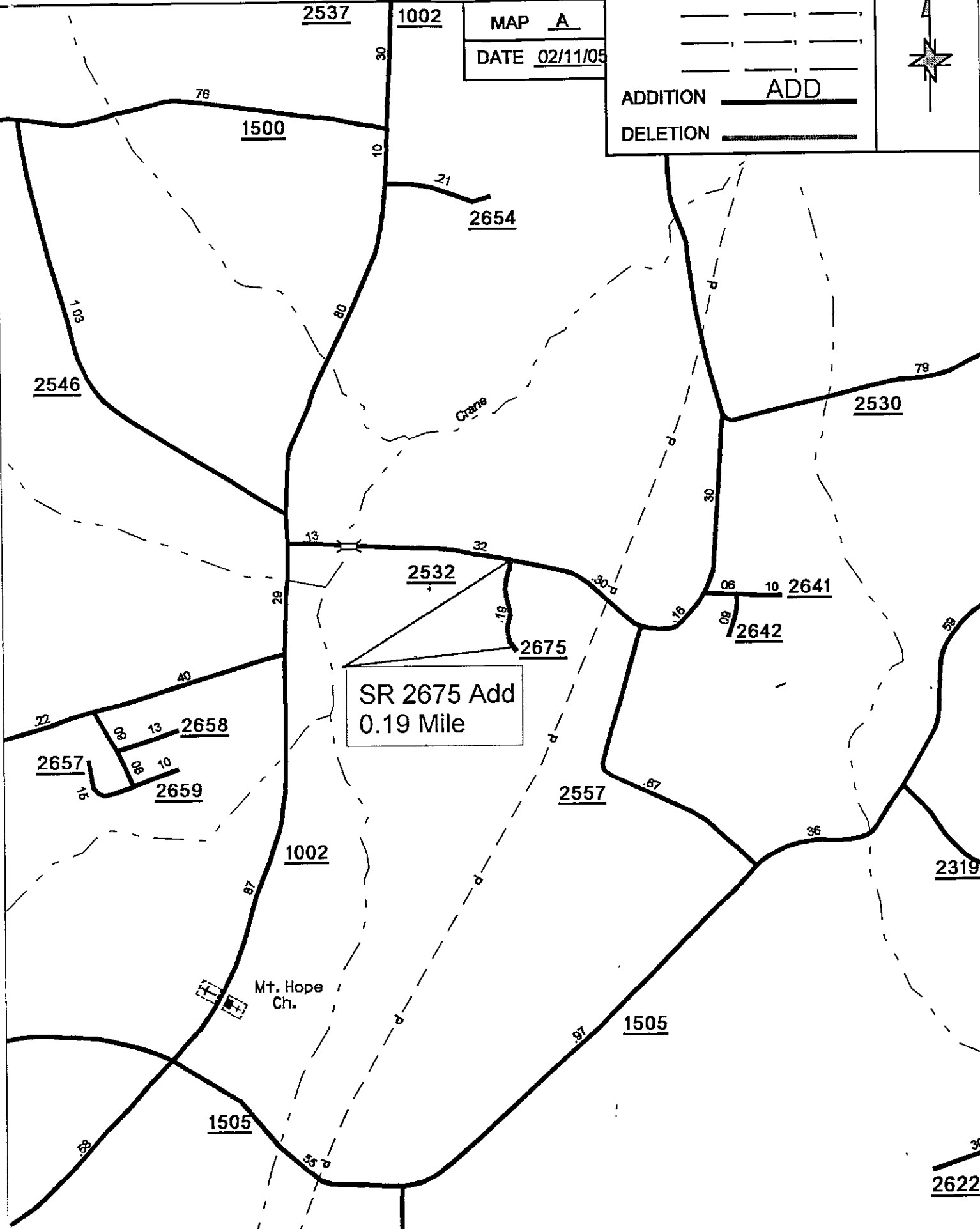

SR 2675 Add
0.19 Mile

SOURCE: DOQQ

SHEET: 3 OF 5

NAME: YRT

SCALE: 4:1