



STATE OF NORTH CAROLINA
DEPARTMENT OF TRANSPORTATION

MICHAEL F. EASLEY
GOVERNOR

November 08, 2004

LYNDO TIPPETT
SECRETARY

MEMORANDUM TO: Mr. Mike Mills, PE
Division Engineer
Division 7

FROM: Forrest L. Robson, PE
GIS Director

SUBJECT: Road System Changes

The Road Inventory Section has been authorized to make the following changes to the state road system as indicated below. We request that you make similar changes to the related maps and files in your Division and District offices, and install appropriate road number signs if necessary. We have updated our records and county maps accordingly. If our system changes do not conform to the actual conditions in the field, please return this memorandum with recommendations.

| Petition Number | County | Approval Date |
|-----------------|--------|---------------|
| 47215 | ORANGE | 11/4/04 |

Inquires about secondary road petition changes should be referred to Ron Tucker, Secondary Roads Group Supervisor at (919) 212-6080. Inquires about TIP Project changes should be referred to Tom Schroeder, Primary Highway Group Supervisor at (919) 212-6074. If you have further questions, please contact Hardee Cox, Road Inventory Manager at (919) 212-6060. Thank you for your assistance.

FLR/hrc
enclosures ()

cc: BSIP
Bridge Maintenance
Pavement Management
Permit Unit
Right of Way
Safety Management
State Road Maintenance
Traffic Engineering
Traffic Surveys

Road System Changes

| PETITION NUMBER | COUNTY | APPROVAL DATE | NEW NUMBER | EXISTING NUMBER | STREET NAME | LENGTH (miles) | TYPE OF CHANGE | REMARKS (See Attached Map) |
|-----------------|--------|---------------|------------|-----------------|-------------|----------------|------------------------------------|----------------------------|
| 47215 | ORANGE | 11/4/04 | | SR 1195 EXT | MEADOW LANE | 0.23 | SYSTEM ADDITION VIA PETITION | MAP A, SEGMENT 1 |

PETITION #: 47215

CO: Orange

SR #: 1195 ext.

MAP a

DATE 11/10/04

ADDITION X

DELETION _____



SR 1195 add .23 miles

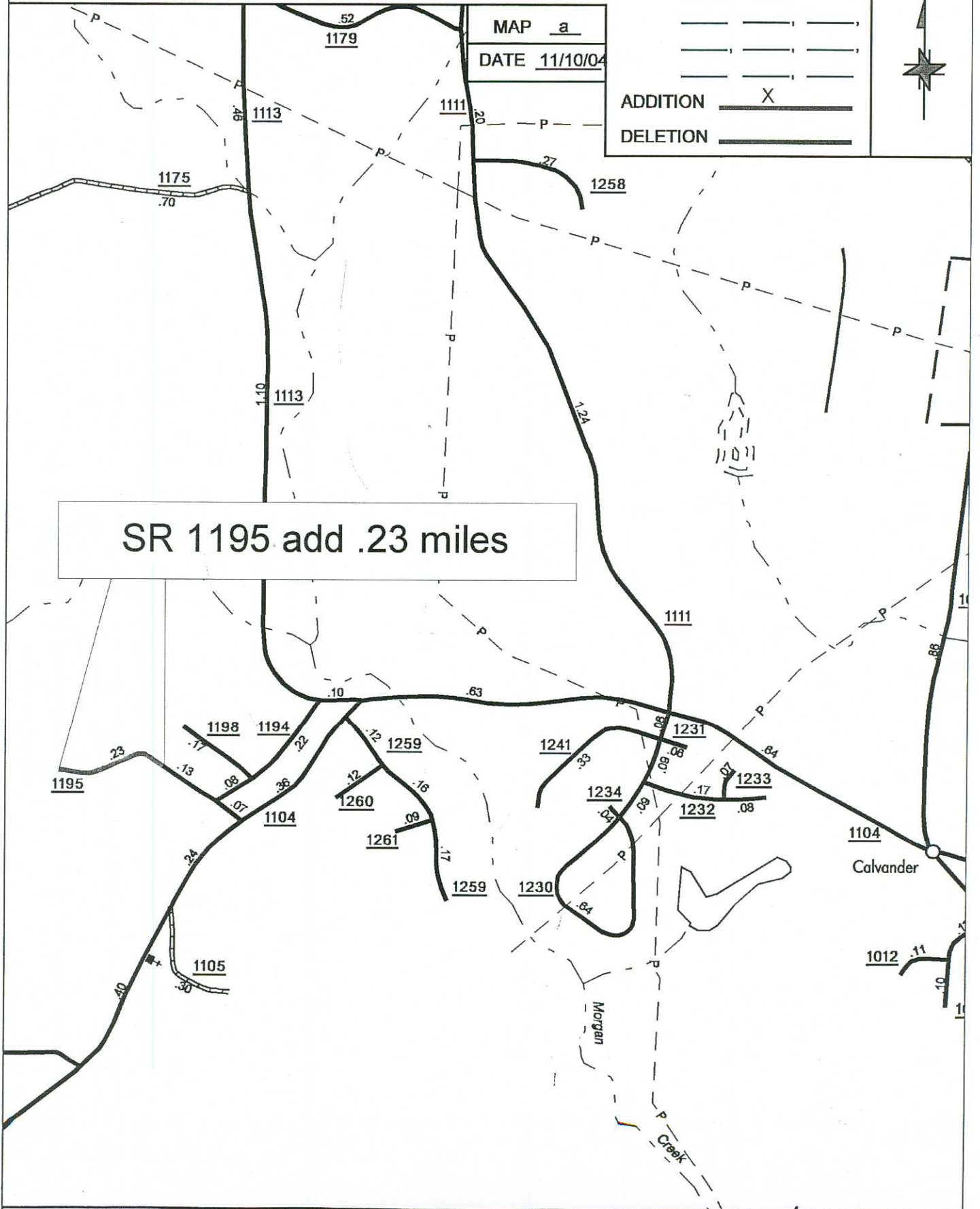

SOURCE: sid

SHEET: 2 OF 2

NAME: RLN

SCALE: 4 to 1