



STATE OF NORTH CAROLINA
DEPARTMENT OF TRANSPORTATION

Beverly Eaves Perdue
GOVERNOR

Thursday, September 23, 2010

EUGENE A. CONTI, JR.
SECRETARY

MEMORANDUM TO: Mr. Barry S. Moose, PE
Division Engineer
Division 10

FROM: Information, and Mapping Unit

SUBJECT: 2004 District 3 Road System Changes

The Road Inventory Information Section has been authorized to make the following changes to the state road system as indicated below. We request that you make similar changes to the related maps and files in your Division and District offices, and install appropriate road number signs if necessary. We have updated our records and county maps accordingly. If our system changes do not conform to the actual conditions in the field, please return this memorandum with recommendations.

| Petition Number | County | Approval Date |
|-----------------|--------|---------------|
| 47109 | UNION | 8/5/2004 |

Inquires about changes should be referred to one of the following: For Primary Roads call Paulette Smith at (919)-212-6100, and for Secondary Roads call Ron Tucker at (919)-212-6085. Thank you for your assistance.

JLC
enclosures ()

cc: BSIP
Bridge Maintenance
Division Right of Way
GIS
Pavement Management
Permit Unit
State Road Maintenance
Traffic Engineering
Traffic Surveys

2004 ROAD SYSTEM CHANGES

| PETITION NUMBER | COUNTY | APPROVAL DATE | NEW NUMBER | EXISTING NUMBER | STREET NAME | LENGTH (miles) | TYPE OF CHANGE | REMARKS (See Attached Map) |
|----------------------------|---------------|--------------------------|-----------------------|----------------------------|------------------------|---------------------------|------------------------------------|---------------------------------------|
| 47109 | UNION | 8/5/2004 | SR 1993 | | CARDINAL RIDGE ROAD | 0.20 | SYSTEM ADDITION VIA PETITION | MAP A, SEGMENT |

PETITION #: 47109

CO: UNION

SR #: 1993

MAP A

DATE 08/10/04

ADDITION

DELETION

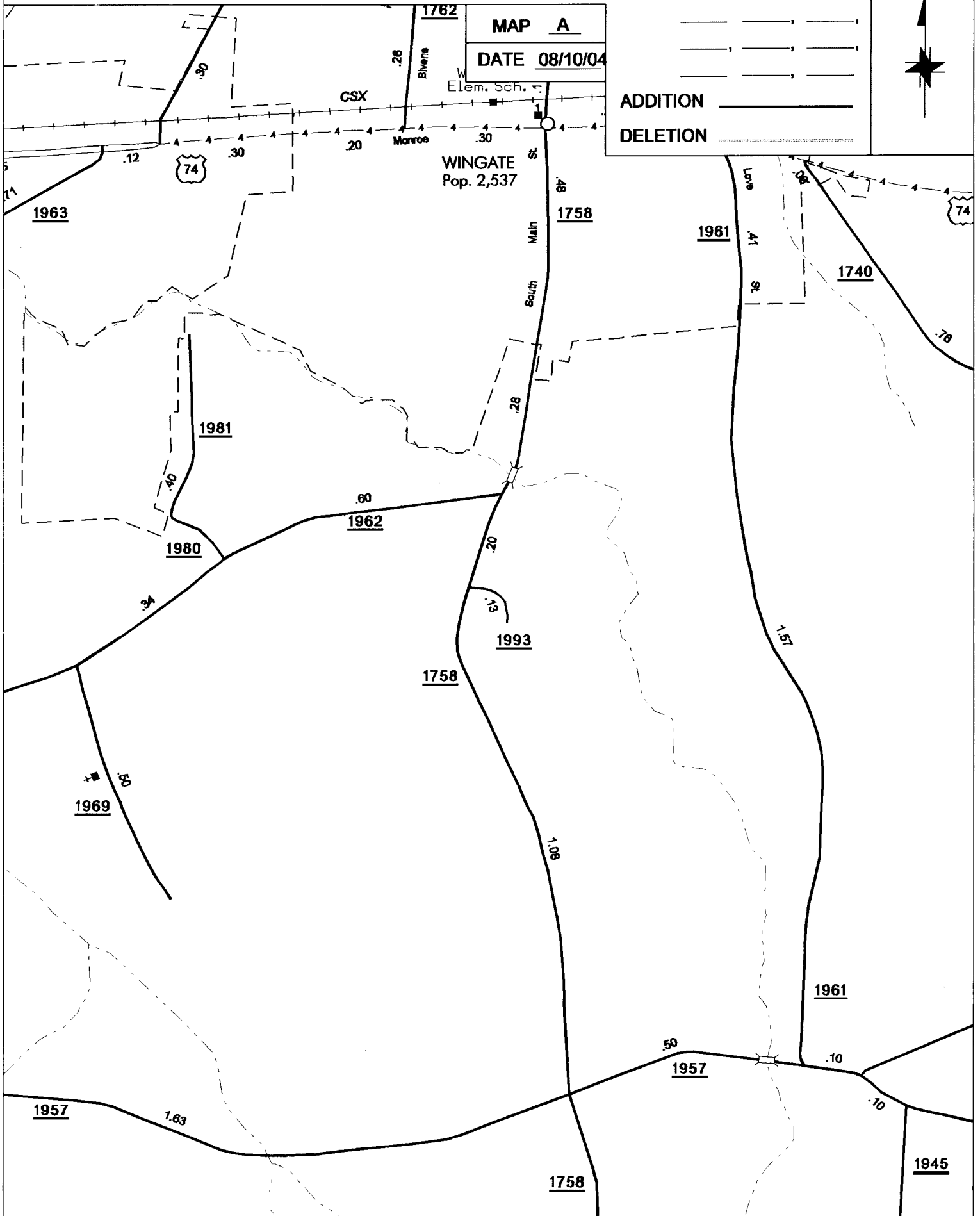

WINGATE
Pop. 2,537

74

74

1963

1758

1961

1740

1981

1962

1980

1993

1758

1969

1.57

1961

1957

1957

1.63

.10

.10

1758

1945

SOURCE: PLAT

SHEET: 2 OF 5

NAME: YRT

SCALE: 4:1