



STATE OF NORTH CAROLINA  
DEPARTMENT OF TRANSPORTATION

MICHAEL F. EASLEY  
GOVERNOR

July 15, 2004

LYNDO TIPPETT  
SECRETARY

**MEMORANDUM TO:** Mr. Michael A. Pettyjohn, PE  
Division Engineer  
Division 11

**FROM:** Forrest L. Robson, PE  
GIS Director

**SUBJECT:** Road System Changes

The Road Inventory Section has been authorized to make the following changes to the state road system as indicated below. We request that you make similar changes to the related maps and files in your Division and District offices, and install appropriate road number signs if necessary. We have updated our records and county maps accordingly. If our system changes do not conform to the actual conditions in the field, please return this memorandum with recommendations.

Petition Number	County	Approval Date
47068	WILKES	7/8/04

Inquires about secondary road petition changes should be referred to Ron Tucker, Secondary Roads Group Supervisor at (919) 212-6080. Inquires about TIP Project changes should be referred to Tom Schroeder, Primary Highway Group Supervisor at (919) 212-6074. If you have further questions, please contact Hardee Cox, Road Inventory Manager at (919) 212-6060. Thank you for your assistance.

FLR/hrc  
enclosures ( )

- cc: BSIP  
Bridge Maintenance  
Pavement Management  
Permit Unit  
Right of Way  
Safety Management  
State Road Maintenance  
Traffic Engineering  
Traffic Surveys

**MAILING ADDRESS:**  
NC DEPARTMENT OF TRANSPORTATION  
GEOGRAPHIC INFORMATION SYSTEMS  
1587 MAIL SERVICE CENTER  
RALEIGH NC 27699-1587



[www.ncdot.org/statewide/planning/gis](http://www.ncdot.org/statewide/planning/gis)

**DELIVERY ADDRESS:**  
3401 CARL SANDBURG CT.  
RALEIGH, NC 27610  
PHONE: (919) 212-6000  
FAX: (919) 212-5999

# Road System Changes

PETITION NUMBER	COUNTY	APPROVAL DATE	NEW NUMBER	EXISTING NUMBER	STREET NAME	LENGTH (miles)	TYPE OF CHANGE	REMARKS (See Attached Map)
47068	WILKES	7/8/04	SR 1649		SPAINHOUR STREET	0.23	SYSTEM ADDITION VIA PETITION	MAP A, SEGMENT 1

MAP A  
DATE 07/15/04

1649, \_\_\_\_\_  
\_\_\_\_\_  
\_\_\_\_\_  
ADDITION \_\_\_\_\_  
DELETION \_\_\_\_\_

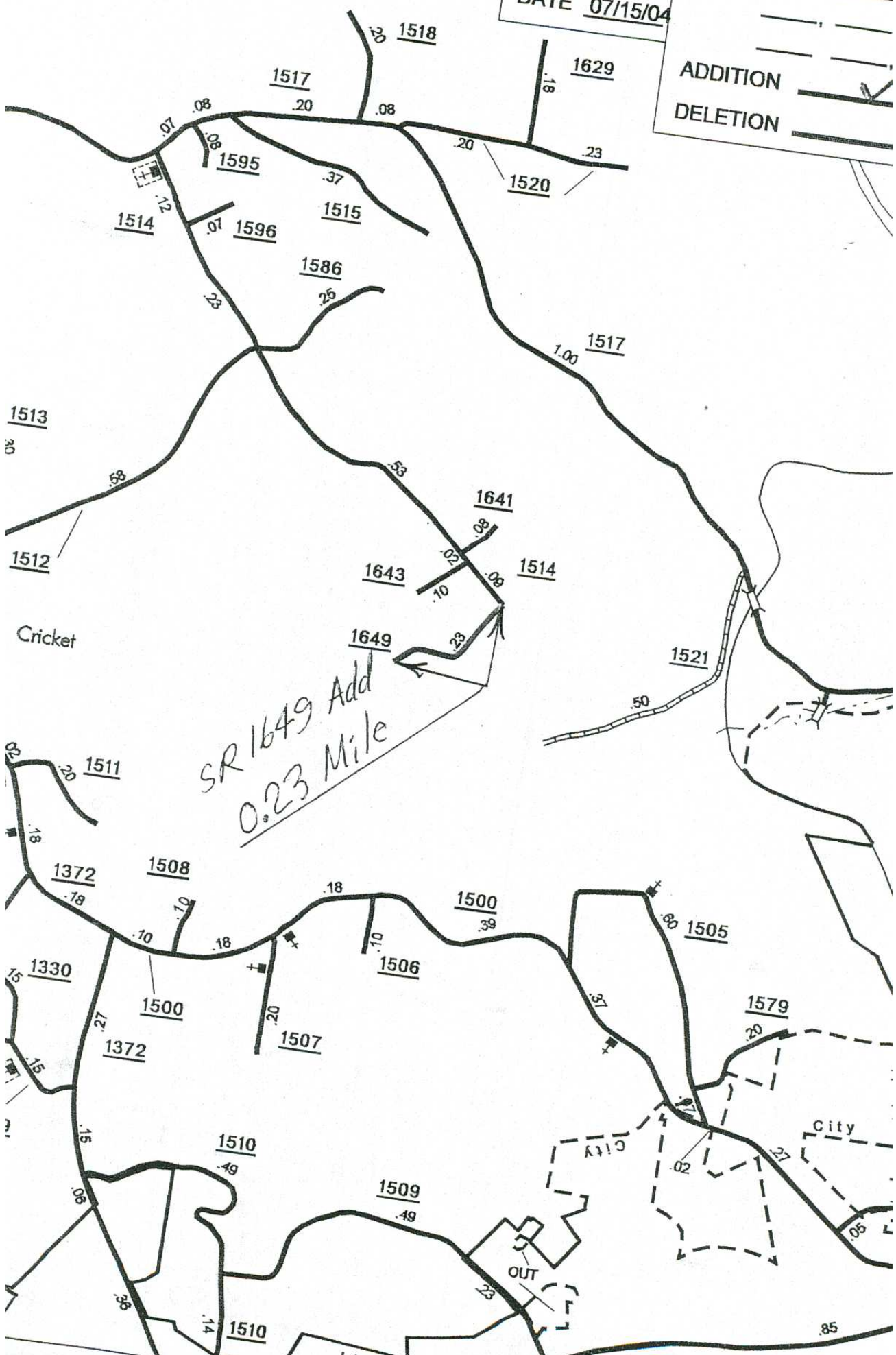

SR 1649 Add  
0.23 Mile

Cricket

City

OUT

Limit

SHEET