



STATE OF NORTH CAROLINA
DEPARTMENT OF TRANSPORTATION

MICHAEL F. EASLEY
GOVERNOR

June 27, 2007

LYNDO TIPPETT
SECRETARY

MEMORANDUM TO: Mr. Richard E. Greene, Jr., P.E.
Division Engineer
Division 4

FROM: L.C. Smith
GIS Director

SUBJECT: 2006 District 3 Road System Changes

The Data Compilation Section has been authorized to make the following changes to the state road system as indicated below. We request that you make similar changes to the related maps and files in your Division and District offices, and install appropriate road number signs if necessary. We have updated our records and county maps accordingly. If our system changes do not conform to the actual conditions in the field, please return this memorandum with recommendations.

TIP Number	County	Approval Date
R-1030 AB	WAYNE	5/11/2004

Inquires about changes should be referred to one of the following: Ron Tucker (Div 3,6,7,8) at (919) 212-6080, Ron Nealy (Div 5,9,11,13,14) at (919) 212-5980, or Lori Mann (Div 1,2,4,10,12) at (919) 212-6075. If you have further questions, please contact Hardee Cox, Data Compilation Section Manger at (919) 212-6060. Thank you for your assistance.

LCS/hrc
enclosures ()

- cc: BSIP
Bridge Maintenance
Division Right of Way
Pavement Management
Permit Unit
State Road Maintenance
Traffic Engineering
Traffic Surveys

MAILING ADDRESS:
NC DEPARTMENT OF TRANSPORTATION
GEOGRAPHIC INFORMATION SYSTEMS
1587 MAIL SERVICE CENTER
RALEIGH NC 27699-1587



DELIVERY ADDRESS:
3401 CARL SANDBURG CT.
RALEIGH, NC 27610
PHONE: (919) 212-6000
FAX: (919) 212-5999

2006 ROAD SYSTEM CHANGES

TIP NUMBER	COUNTY	APPROVAL DATE	NEW NUMBER	EXISTING NUMBER	STREET NAME	LENGTH (miles)	TYPE OF CHANGE	REMARKS (See Attached Map)
R-1030 AB	WAYNE	5/11/2004		SR 1336	NAHUNTA ROAD	0.05	SYSTEM DELETION VIA PROJECT	MAP A, SEGMENT 1
R-1030 AB	WAYNE	5/11/2004	SR 1320	SR 1336	NAHUNTA ROAD	0.53	NUMBER REASSIGNMENT VIA PROJECT	MAP B, SEGMENT 1
R-1030 AB	WAYNE	5/11/2004		SR 1300	SALEM CHURCH ROAD	0.28	SYSTEM DELETION VIA PROJECT	MAP A, SEGMENT 2
R-1030 AB	WAYNE	5/11/2004		SR 1336	NAHUNTA ROAD	0.33	SYSTEM ADDITION VIA PROJECT	MAP B, SEGMENT 2
R-1030 AB	WAYNE	5/11/2004	SR 1464			0.08	SYSTEM ADDITION VIA PROJECT	MAP B, SEGMENT 3
R-1030 AB	WAYNE	5/11/2004	SR 1465	SR 1336		0.08	NUMBER REASSIGNMENT VIA PROJECT	MAP B, SEGMENT 4
R-1030 AB	WAYNE	5/11/2004	SR 1468	SR 1336		0.09	NUMBER REASSIGNMENT VIA PROJECT	MAP B, SEGMENT 5
R-1030 AB	WAYNE	5/11/2004	SR 1468			0.04	SYSTEM ADDITION VIA PROJECT	MAP B, SEGMENT 6
R-1030 AB	WAYNE	5/11/2004	SR 1469			0.02	SYSTEM ADDITION VIA PROJECT	MAP B, SEGMENT 7
R-1030 AB	WAYNE	5/11/2004	SR 1469	SR 1336		0.06	NUMBER REASSIGNMENT VIA PROJECT	MAP B, SEGMENT 8
R-1030 AB	WAYNE	5/11/2004	SR 1467	SR 1320		0.08	NUMBER REASSIGNMENT VIA PROJECT	MAP B, SEGMENT 9
R-1030 AB	WAYNE	5/11/2004		SR 1300	SALEM CHURCH ROAD	0.47	SYSTEM ADDITION VIA PROJECT	MAP B, SEGMENT 11
R-1030 AB	WAYNE	5/11/2004	SR 1470	SR 1300	SALEM CHURCH ROAD	0.37	NUMBER REASSIGNMENT VIA PROJECT	MAP B, SEGMENT 12

TIP NUMBER	COUNTY	APPROVAL DATE	NEW NUMBER	EXISTING NUMBER	STREET NAME	LENGTH (miles)	TYPE OF CHANGE	REMARKS (See Attached Map)
R-1030 AB	WAYNE	5/11/2004	SR 1466	SR 1320		0.06	NUMBER REASSIGNMENT VIA PROJECT	MAP A, SEGMENT 15

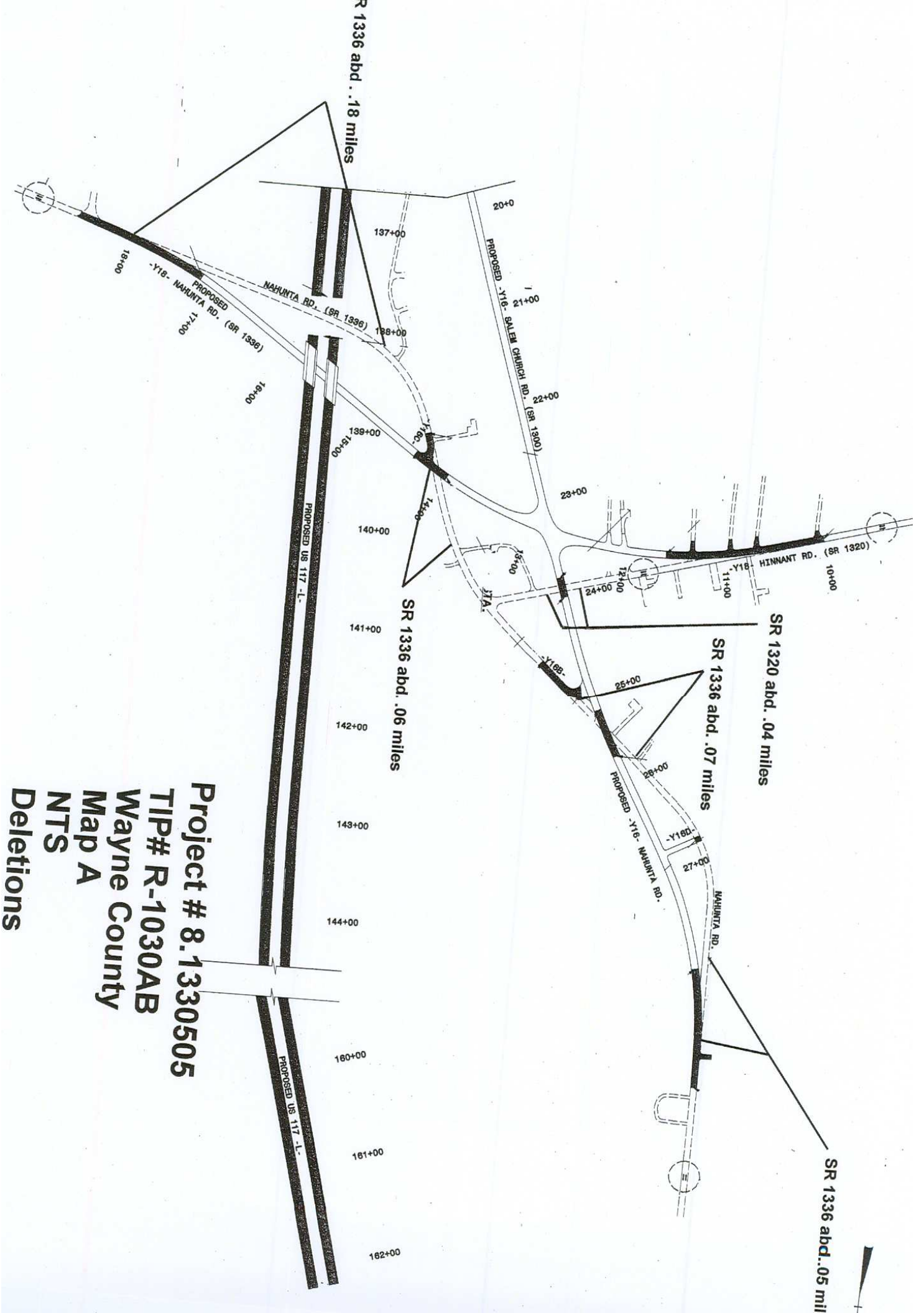

Project # 8.1330505
TIP# R-1030AB
Wayne County
Map A
NTS
Deletions

SR 1467 No. Chg. from SR 1320 .08 miles

SR 1465 No. Chg. from SR 1336 .08 miles

SR 1300 add .47 miles

SR 1468 No. Chg. from SR 1336 .13 miles

SR 1466 No. Chg. from SR 1320 .06 miles

SR 1464 add .03 miles

SR 1469 No. Chg. from SR 1336 .08 miles

SR 1320 No. Chg. from SR 1336 .53 miles

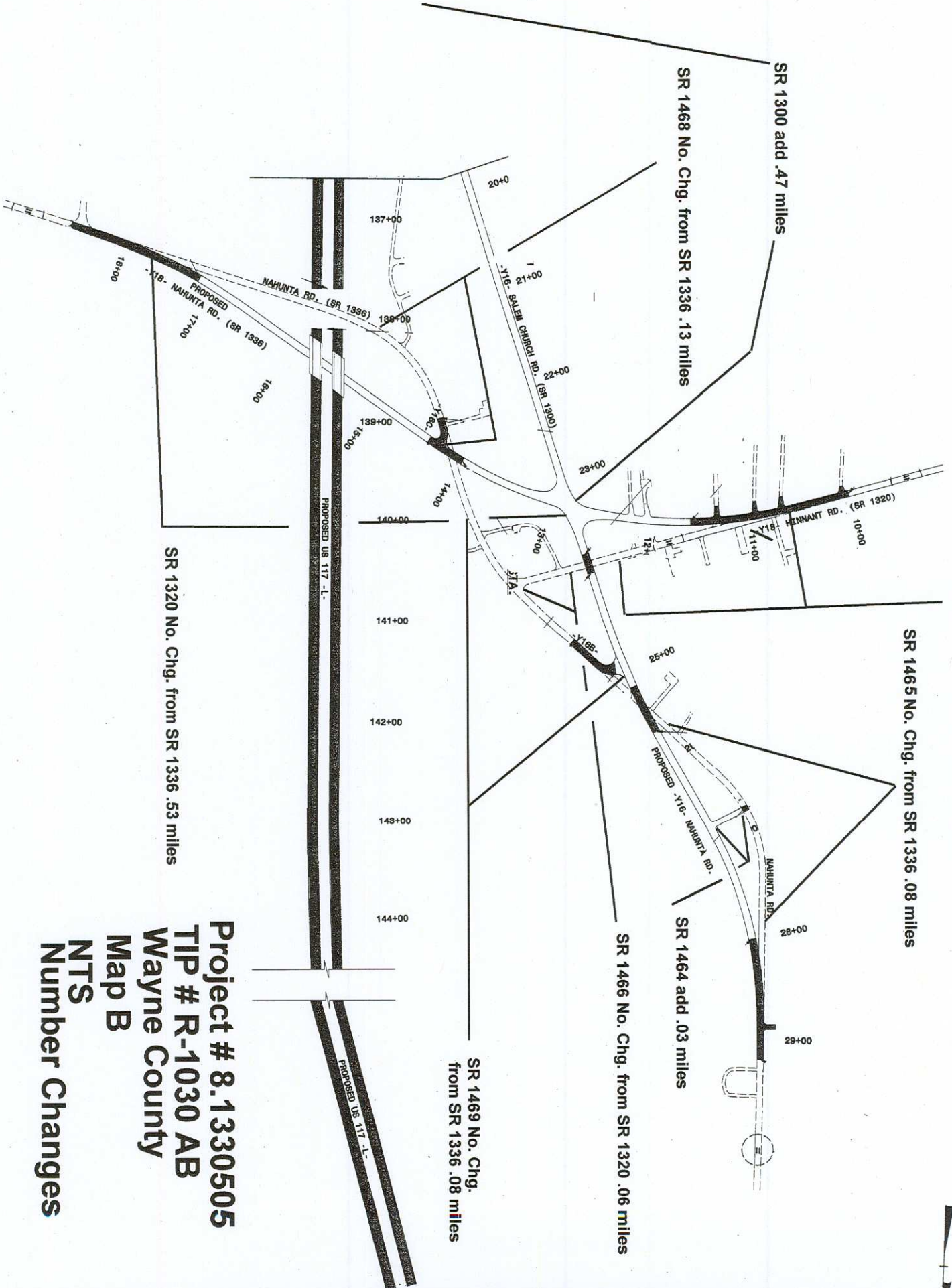

Project # 8.1330505
TIP # R-1030 AB
Wayne County
Map B
NTS
Number Changes