



STATE OF NORTH CAROLINA
DEPARTMENT OF TRANSPORTATION

MICHAEL F. EASLEY
GOVERNOR

April 27, 2004

LYNDO TIPPETT
SECRETARY

MEMORANDUM TO: Mr. Timothy Johnson, PE
Division Engineer
Division 8

FROM: Forrest L. Robson, PE
GIS Director

SUBJECT: Road System Changes

The Road Inventory Section has been authorized to make the following changes to the state road system as indicated below. We request that you make similar changes to the related maps and files in your Division and District offices, and install appropriate road number signs if necessary. We have updated our records and county maps accordingly. If our system changes do not conform to the actual conditions in the field, please return this memorandum with recommendations.

Petition Number	County	Approval Date
46911	HOKE	3/4/04

Inquires about secondary road petition changes should be referred to Ron Tucker, Secondary Roads Group Supervisor at (919) 212-6080. Inquires about TIP Project changes should be referred to Tom Schroeder, Primary Highway Group Supervisor at (919) 212-6074. If you have further questions, please contact Hardee Cox, Road Inventory Manager at (919) 212-6060. Thank you for your assistance.

FLR/hrc
enclosures ()

- cc: BSIP
Bridge Maintenance
Pavement Management
Permit Unit
Right of Way
Safety Management
State Road Maintenance
Traffic Engineering
Traffic Surveys

*Corrected Copy
Replacing Prior
Copy*

MAILING ADDRESS:
NC DEPARTMENT OF TRANSPORTATION
GEOGRAPHIC INFORMATION SYSTEMS
1587 MAIL SERVICE CENTER
RALEIGH NC 27699-1587



www.ncdot.org/statewide/planning/gis

DELIVERY ADDRESS:
3401 CARL SANDBURG CT.
RALEIGH, NC 27610
PHONE: (919) 212-6000
FAX: (919) 212-5999

Road System Changes

PETITION NUMBER	COUNTY	APPROVAL DATE	NEW NUMBER	EXISTING NUMBER	STREET NAME	LENGTH (miles)	TYPE OF CHANGE	REMARKS (See Attached Map)
46911	HOKE	3/4/04	SR 1398		OAKBLUFF DRIVE	0.18	SYSTEM ADDITION VIA PETITION	MAP A, SEGMENT 1
46911	HOKE	3/4/04	SR 1397		OAK LEAF DRIVE	0.13	SYSTEM ADDITION VIA PETITION	MAP A, SEGMENT 1
46911	HOKE	3/4/04	SR 1396		OAKVIEW DRIVE	0.25	SYSTEM ADDITION VIA PETITION	MAP A, SEGMENT 1

PETITION #: 46911

CO: HOKE

SR #: 1398

MAP A

DATE 03/16/04

1397

1396

ADDITION

DELETION



79° 05'

35° 05'

LAND

SR 1397 Add 0.13 Mile

SR 1398 Add 0.18 Mile

SR 1396 Add 0.25 Mile

US 401

TO FAYETTEVILLE

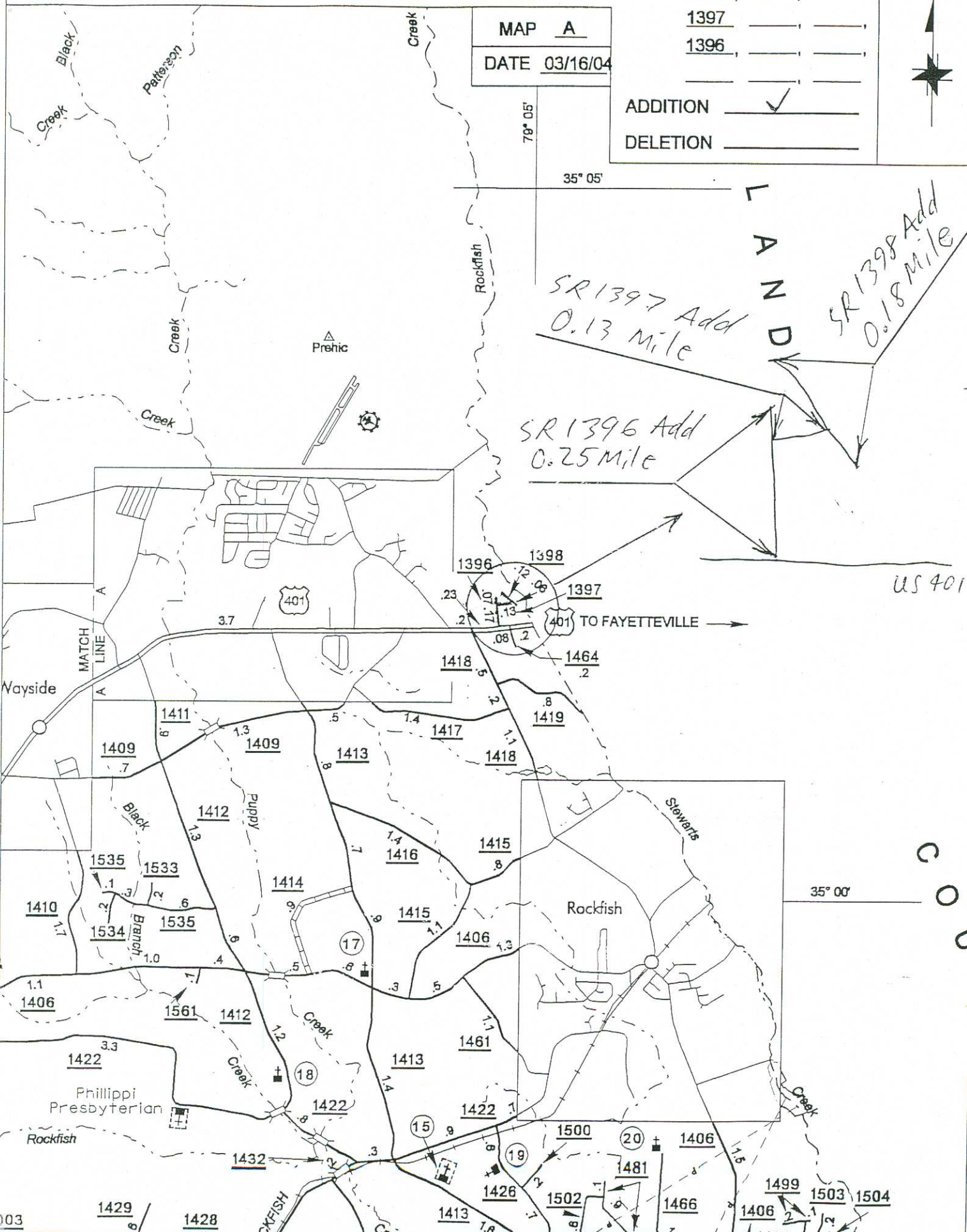

SOURCE: DOQQ

SHEET: 1 OF 1

NAME: JDH

SCALE: 1:1