



STATE OF NORTH CAROLINA
DEPARTMENT OF TRANSPORTATION

MICHAEL F. EASLEY
GOVERNOR

January 09, 2004

LYNDO TIPPETT
SECRETARY

MEMORANDUM TO: Mr. Anthony W. Roper, PE
Division Engineer
Division 4

FROM: Forrest L. Robson, PE
GIS Director

SUBJECT: Road System Changes

The Road Inventory Section has been authorized to make the following changes to the state road system as indicated below. We request that you make similar changes to the related maps and files in your Division and District offices, and install appropriate road number signs if necessary. We have updated our records and county maps accordingly. If our system changes do not conform to the actual conditions in the field, please return this memorandum with recommendations.

Project/ Petition Number	County	Approval Date
46750	JOHNSTON	12/4/03

Inquires about secondary road petition changes should be referred to Ron Tucker, Secondary Roads Group Supervisor at (919) 212-6080. Inquires about TIP Project changes should be referred to Tom Schroeder, Primary Highway Group Supervisor at (919) 212-6074. If you have further questions, please contact Hardee Cox, Road Inventory Manager at (919) 212-6060. Thank you for your assistance.

FLR/hrc
enclosures ()

- cc: BSIP
Bridge Maintenance
Pavement Management
Permit Unit
Right of Way
Safety Management
State Road Maintenance
Traffic Engineering
Traffic Surveys

MAILING ADDRESS:
NC DEPARTMENT OF TRANSPORTATION
GEOGRAPHIC INFORMATION SYSTEMS
1587 MAIL SERVICE CENTER
RALEIGH NC 27699-1587



www.ncdot.org/statewide/planning/gis

DELIVERY ADDRESS:
3401 CARL SANDBURG CT
RALEIGH, NC 27610
PHONE: (919) 212-6000
FAX (919) 212-5999

Road System Changes

PROJECT/ PETITION #	COUNTY	APPROVAL DATE	NEW NUMBER	EXISTING NUMBER	STREET NAME	LENGTH	TYPE OF CHANGE	REMARKS (See Attached)
46750	JOHNSTON	12/4/03	SR 2665		HOMESTEAD WAY	0.26	SYSTEM ADDITION VIA PETITION	MAP A
46750	JOHNSTON	12/4/03	SR 2664		ATHOL COURT	0.10	SYSTEM ADDITION VIA PETITION	MAP A
46750	JOHNSTON	12/4/03	SR 2663		ALBEMARLE DRIVE	0.36	SYSTEM ADDITION VIA PETITION	MAP A
46750	JOHNSTON	12/4/03	SR 2662		REGENT COURT	0.06	SYSTEM ADDITION VIA PETITION	MAP A
46750	JOHNSTON	12/4/03	SR 2661		KINGSTON COURT	0.15	SYSTEM ADDITION VIA PETITION	MAP A
46750	JOHNSTON	12/4/03	SR 2660		COTTSWORTH COURT	0.06	SYSTEM ADDITION VIA PETITION	MAP A
46750	JOHNSTON	12/4/03	SR 2659		NORWOOD DRIVE	0.69	SYSTEM ADDITION VIA PETITION	MAP A

PETITION #: 46750

CO: JOHNSTON

SR #: 2659, 2660, 2661,
2662, 2663, 2664,
2665, _____, _____,

MAP A
DATE 03/18/04



ADDITION X
DELETION

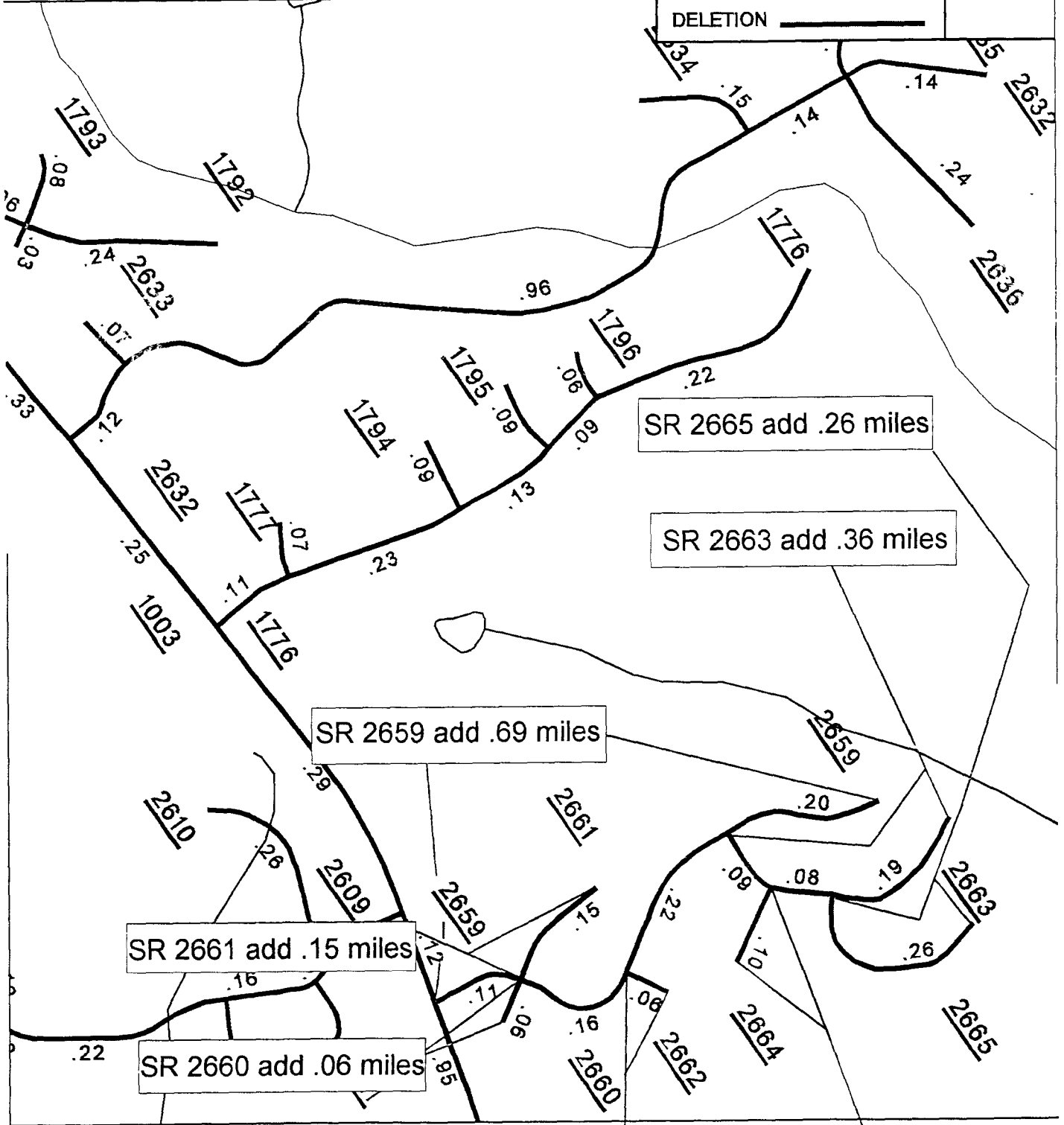

SR 2665 add .26 miles

SR 2663 add .36 miles

SR 2659 add .69 miles

SR 2661 add .15 miles

SR 2660 add .06 miles

SR 2662 add .06 miles

SR 2664 add .10 miles