



STATE OF NORTH CAROLINA
DEPARTMENT OF TRANSPORTATION

MICHAEL F. EASLEY
GOVERNOR

November 26, 2003

LYNDO TIPPETT
SECRETARY

MEMORANDUM TO: Mr. Benton G. Payne, PE
Division Engineer
Division 10

FROM: Forrest L. Robson, PE
GIS Director

SUBJECT: Road System Changes

The Road Inventory Section has been authorized to make the following changes to the state road system as indicated below. We request that you make similar changes to the related maps and files in your Division and District offices, and install appropriate road number signs if necessary. We have updated our records and county maps accordingly. If our system changes do not conform to the actual conditions in the field, please return this memorandum with recommendations.

Project/ Petition Number	County	Approval Date
46654	CABARRUS	9/11/03

Inquires about secondary road petition changes should be referred to Ron Tucker, Secondary Roads Group Supervisor at (919) 212-6080. Inquires about TIP Project changes should be referred to Tom Schroeder, Primary Highway Group Supervisor at (919) 212-6074. If you have further questions, please contact Hardee Cox, Road Inventory Manager at (919) 212-6060. Thank you for your assistance.

FLR/hrc
enclosures ()

cc: BSIP
Bridge Maintenance
Pavement Management
Permit Unit
Right of Way
Safety Management
State Road Maintenance
Traffic Engineering
Traffic Surveys

MAILING ADDRESS:
NC DEPARTMENT OF TRANSPORTATION
GEOGRAPHIC INFORMATION SYSTEMS
1587 MAIL SERVICE CENTER
RALEIGH NC 27699-1587



www.ncdot.org/statewide/planning/gis

DELIVERY ADDRESS:
3401 CARL SANDBURG CT
RALEIGH, NC 27610
PHONE: (919) 212-6000
FAX: (919) 212-5999

Road System Changes

PROJECT/ PETITION #	COUNTY	APPROVAL DATE	NEW NUMBER	EXISTING NUMBER	STREET NAME	LENGTH	TYPE OF CHANGE	REMARKS (See Attached)
46654	CABARRUS	9/11/03	SR 2397		SCHIEER CT.	0.07	SYSTEM ADDITION VIA PETITION	MAP A
46654	CABARRUS	9/11/03	SR 2396		REVERE LN.	0.13	SYSTEM ADDITION VIA PETITION	MAP A
46654	CABARRUS	9/11/03		SR 2356	SNOW DR.	0.16	SYSTEM ADDITION VIA PETITION	MAP A
46654	CABARRUS	9/11/03	SR 2395		KELLY CT	0.03	SYSTEM ADDITION VIA PETITION	MAP A
46654	CABARRUS	9/11/03	SR 2394		SANGER CT.	0.13	SYSTEM ADDITION VIA PETITION	MAP A
46654	CABARRUS	9/11/03	SR 2393		HESTER CT.	0.05	SYSTEM ADDITION VIA PETITION	MAP A
46654	CABARRUS	9/11/03	SR 2392		BETH LN	0.15	SYSTEM ADDITION VIA PETITION	MAP A
46654	CABARRUS	9/11/03	SR 2391		OLIVER CT.	0.05	SYSTEM ADDITION VIA PETITION	MAP A
46654	CABARRUS	9/11/03		SR 2358	GERHARDT CT	0.03	SYSTEM ADDITION VIA PETITION	MAP A

PETITION #: 46654

CO: CABARRUS

SR #: 2356EX2358EX 2391

MAP A

DATE 11/20/03

2392 2393 2394

2395 2396 2397

ADDITION _____

DELETION _____

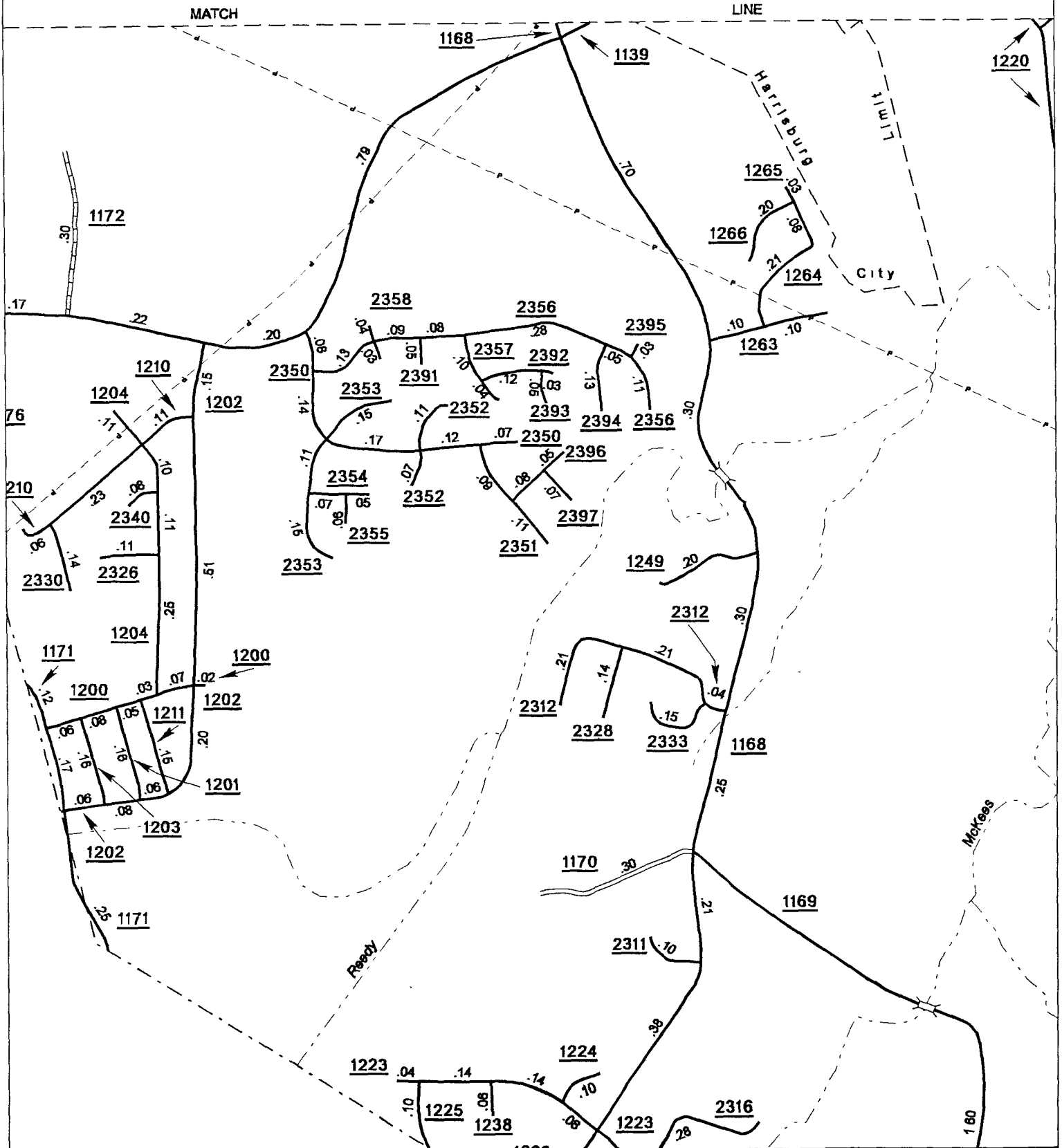

SOURCE: DOQQ

SHEET: 1 OF 3

NAME: YRT

SCALE: 4:1