



STATE OF NORTH CAROLINA
DEPARTMENT OF TRANSPORTATION

MICHAEL F. EASLEY
GOVERNOR

December 01, 2003

LYNDO TIPPETT
SECRETARY

MEMORANDUM TO: Mr. W. F. Rosser, PE
Division Engineer
Division 8

FROM: Forrest L. Robson, PE
GIS Director

SUBJECT: Road System Changes

The Road Inventory Section has been authorized to make the following changes to the state road system as indicated below. We request that you make similar changes to the related maps and files in your Division and District offices, and install appropriate road number signs if necessary. We have updated our records and county maps accordingly. If our system changes do not conform to the actual conditions in the field, please return this memorandum with recommendations.

Project/ Petition Number	County	Approval Date
46631	HOKE	9/11/03

Inquires about secondary road petition changes should be referred to Ron Tucker, Secondary Roads Group Supervisor at (919) 212-6080. Inquires about TIP Project changes should be referred to Tom Schroeder, Primary Highway Group Supervisor at (919) 212-6074. If you have further questions, please contact Hardee Cox, Road Inventory Manager at (919) 212-6060. Thank you for your assistance.

FLR/hrc
enclosures ()

cc: BSIP
Bridge Maintenance
Pavement Management
Permit Unit
Right of Way
Safety Management
State Road Maintenance
Traffic Engineering
Traffic Surveys

MAILING ADDRESS:
NC DEPARTMENT OF TRANSPORTATION
GEOGRAPHIC INFORMATION SYSTEMS
1587 MAIL SERVICE CENTER
RALEIGH NC 27699-1587

www.ncdot.org/statewide/planning/gis

DELIVERY ADDRESS:
3401 CARL SANDBURG CT
RALEIGH, NC 27610
PHONE: (919) 212-6000
FAX: (919) 212-5999

Road System Changes

PROJECT/ PETITION #	COUNTY	APPROVAL DATE	NEW NUMBER	EXISTING NUMBER	STREET NAME	LENGTH	TYPE OF CHANGE	REMARKS (See Attached)
46631	HOKE	9/11/03	SR 1381		DAVID COURT	0.04	SYSTEM ADDITION VIA PETITION	MAP A
46631	HOKE	9/11/03	SR 1380		CATHERINE STREET	0.07	SYSTEM ADDITION VIA PETITION	MAP A
46631	HOKE	9/11/03	SR 1379		STACY LANE	0.28	SYSTEM ADDITION VIA PETITION	MAP A

PETITION #: 46631

CO: HOKE

SR #: 1379, _____, _____

1380 _____, _____

1381 _____, _____

MAP A
DATE 12/02/03

ADDITION

DELETION _____



COUNTY

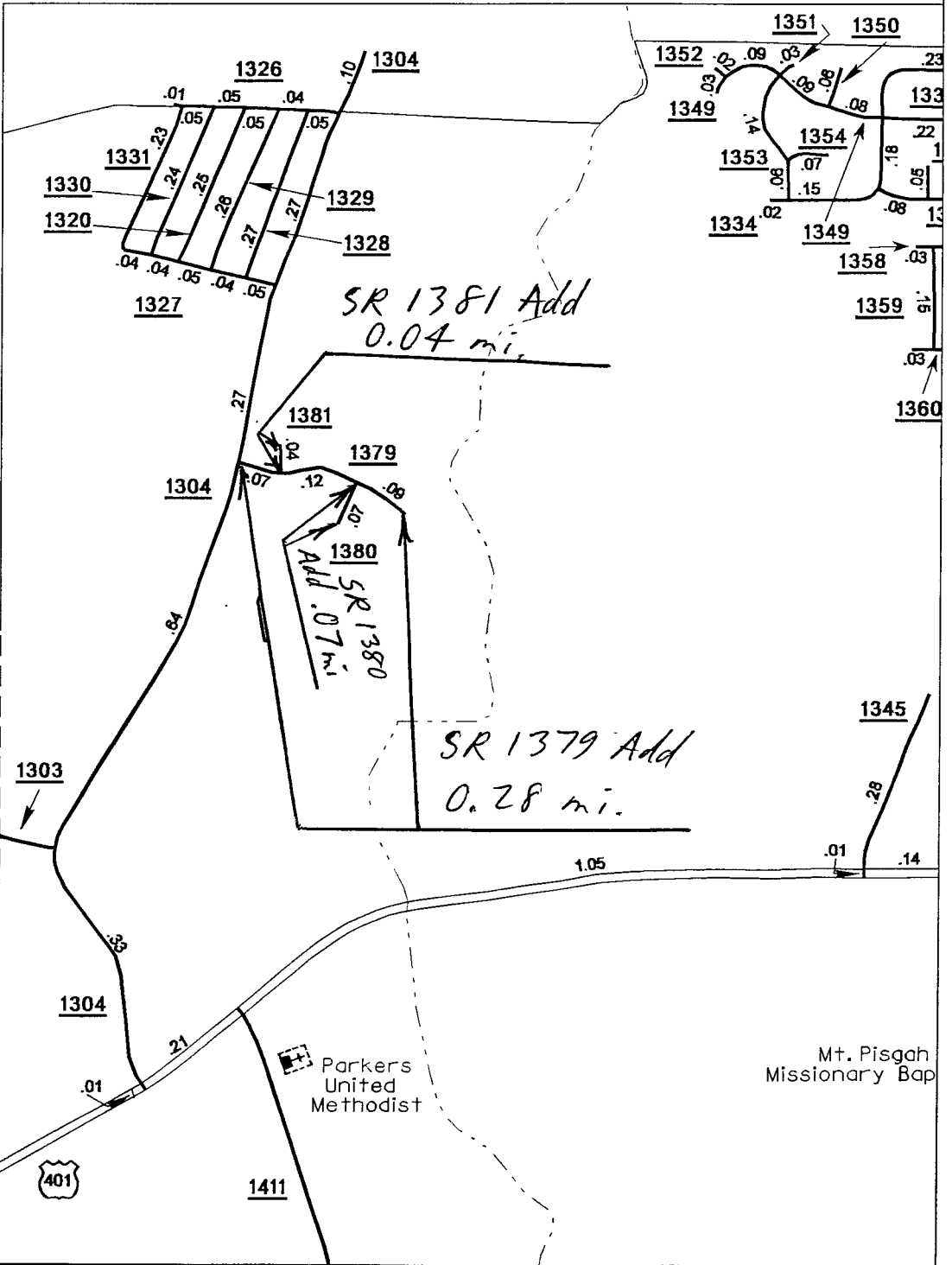

Inset 1

SOURCE: PLAT

SHEET: 1 OF 1

NAME: JDH

SCALE: 4:1