



STATE OF NORTH CAROLINA
DEPARTMENT OF TRANSPORTATION

MICHAEL F. EASLEY
GOVERNOR

December 05, 2003

LYNDO TIPPETT
SECRETARY

MEMORANDUM TO: Mr. Anthony W. Roper, PE
Division Engineer
Division 4

FROM: Forrest L. Robson, PE
GIS Director

SUBJECT: Road System Changes

The Road Inventory Section has been authorized to make the following changes to the state road system as indicated below. We request that you make similar changes to the related maps and files in your Division and District offices, and install appropriate road number signs if necessary. We have updated our records and county maps accordingly. If our system changes do not conform to the actual conditions in the field, please return this memorandum with recommendations.

| Project/ Petition Number | County | Approval Date |
|--------------------------|--------|---------------|
| 46621 | NASH | 9/11/03 |

Inquires about secondary road petition changes should be referred to Ron Tucker, Secondary Roads Group Supervisor at (919) 212-6080. Inquires about TIP Project changes should be referred to Tom Schroeder, Primary Highway Group Supervisor at (919) 212-6074. If you have further questions, please contact Hardee Cox, Road Inventory Manager at (919) 212-6060. Thank you for your assistance.

FLR/hrc
enclosures ()

- cc: BSIP
- Bridge Maintenance
- Pavement Management
- Permit Unit
- Right of Way
- Safety Management
- State Road Maintenance
- Traffic Engineering
- Traffic Surveys

MAILING ADDRESS:
NC DEPARTMENT OF TRANSPORTATION
GEOGRAPHIC INFORMATION SYSTEMS
1587 MAIL SERVICE CENTER
RALEIGH NC 27699-1587



www.ncdot.org/statewide/planning/gis

DELIVERY ADDRESS:
3401 CARL SANDBURG CT.
RALEIGH, NC 27610
PHONE: (919) 212-6000
FAX: (919) 212-5999

Road System Changes

| PROJECT/ PETITION # | COUNTY | APPROVAL DATE | NEW NUMBER | EXISTING NUMBER | STREET NAME | LENGTH | TYPE OF CHANGE | REMARKS (See Attached) |
|------------------------|--------|------------------|---------------|--------------------|----------------------|--------|------------------------------------|---------------------------|
| 46621 | NASH | 9/11/03 | SR 1867 | | BRIDGE TENDER CIRCLE | 0.10 | SYSTEM ADDITION VIA PETITION | MAP A |

PETITION #: 46621

CO: NASH

SR #: 1867

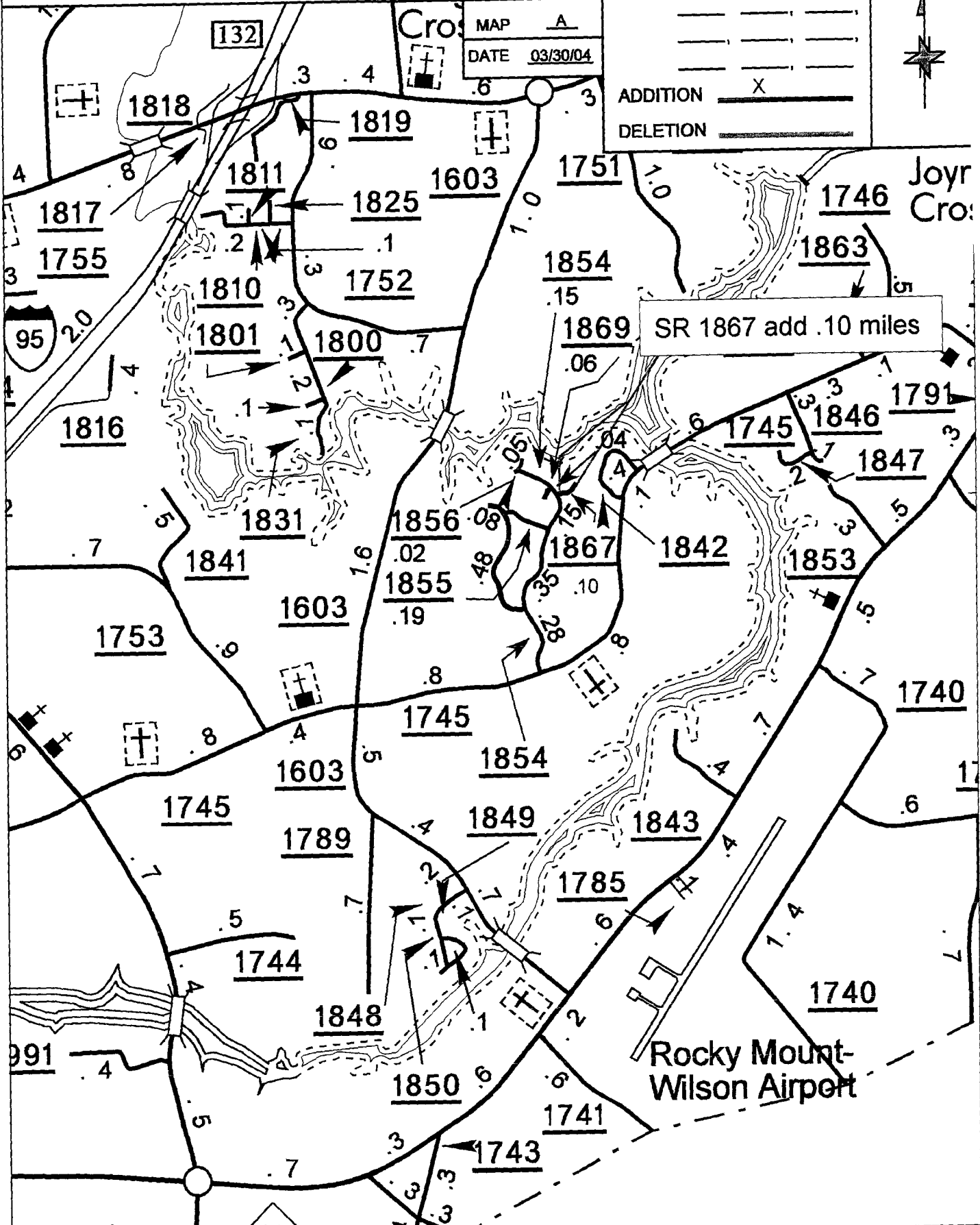

| | |
|------|----------|
| MAP | A |
| DATE | 03/30/04 |

| | |
|----------|---|
| ADDITION | X |
| DELETION | |

SR 1867 add .10 miles