



STATE OF NORTH CAROLINA
DEPARTMENT OF TRANSPORTATION

MICHAEL F. EASLEY
GOVERNOR

April 30, 2004

LYNDO TIPPETT
SECRETARY

MEMORANDUM TO: Mr. H. Allen Pope, PE
Division Engineer
Division 3

FROM: Forrest L. Robson, PE
GIS Director

SUBJECT: Road System Changes

The Road Inventory Section has been authorized to make the following changes to the state road system as indicated below. We request that you make similar changes to the related maps and files in your Division and District offices, and install appropriate road number signs if necessary. We have updated our records and county maps accordingly. If our system changes do not conform to the actual conditions in the field, please return this memorandum with recommendations. *66-0314-03-03*

Municipality	County	Approval Date
66030603	ONSLow	3/6/03

Inquires about secondary road petition changes should be referred to Ron Tucker, Secondary Roads Group Supervisor at (919) 212-6080. Inquires about TIP Project changes should be referred to Tom Schroeder, Primary Highway Group Supervisor at (919) 212-6074. If you have further questions, please contact Hardee Cox, Road Inventory Manager at (919) 212-6060. Thank you for your assistance.

FLR/hrc
enclosures ()

- cc: BSIP
Bridge Maintenance
Pavement Management
Permit Unit
Right of Way
Safety Management
State Road Maintenance
Traffic Engineering
Traffic Surveys

MAILING ADDRESS:
NC DEPARTMENT OF TRANSPORTATION
GEOGRAPHIC INFORMATION SYSTEMS
1587 MAIL SERVICE CENTER
RALEIGH NC 27699-1587



www.ncdot.org/statewide/planning/gis

DELIVERY ADDRESS:
3401 CARL SANDBURG CT.
RALEIGH, NC 27610
PHONE: (919) 212-6000
FAX: (919) 212-5999

Road System Changes

MUNICIPALITY	COUNTY	APPROVAL DATE	NEW NUMBER	EXISTING NUMBER	STREET NAME	LENGTH (miles)	TYPE OF CHANGE	REMARKS (See Attached Map)
66030603	ON SLOW	3/6/03		SR 1451		0.73	SYSTEM DELETION VIA MUNICIPAL AGREEMENT	MAP A, SEGMENT 1
66030603	ON SLOW	3/6/03		SR 1451		0.46	SYSTEM DELETION VIA MUNICIPAL AGREEMENT	MAP A, SEGMENT 2
66030603	ON SLOW	3/6/03		SR 1466		0.51	SYSTEM DELETION VIA MUNICIPAL AGREEMENT	MAP A, SEGMENT 3
66030603	ON SLOW	3/6/03		SR 1467		0.11	SYSTEM DELETION VIA MUNICIPAL AGREEMENT	MAP A, SEGMENT 4
66030603	ON SLOW	3/6/03		SR 1468		0.17	SYSTEM DELETION VIA MUNICIPAL AGREEMENT	MAP A, SEGMENT 5
66030603	ON SLOW	3/6/03		SR 1472		0.16	SYSTEM DELETION VIA MUNICIPAL AGREEMENT	MAP A, SEGMENT 6
66030603	ON SLOW	3/6/03		SR 1473		0.23	SYSTEM DELETION VIA MUNICIPAL AGREEMENT	MAP A, SEGMENT 7
66030603	ON SLOW	3/6/03		SR 1474		0.30	SYSTEM DELETION VIA MUNICIPAL AGREEMENT	MAP A, SEGMENT 8
66030603	ON SLOW	3/6/03		SR 1719		0.05	SYSTEM DELETION VIA MUNICIPAL AGREEMENT	MAP A, SEGMENT 9
66030603	ON SLOW	3/6/03		SR 1720		0.10	SYSTEM DELETION VIA MUNICIPAL AGREEMENT	MAP A, SEGMENT 10
66030603	ON SLOW	3/6/03		SR 1720		0.07	SYSTEM DELETION VIA MUNICIPAL AGREEMENT	MAP A, SEGMENT 11
66030603	ON SLOW	3/6/03		SR 1721		0.08	SYSTEM DELETION VIA MUNICIPAL AGREEMENT	MAP A, SEGMENT 12
66030603	ON SLOW	3/6/03		SR 1721		0.13	SYSTEM DELETION VIA MUNICIPAL AGREEMENT	MAP A, SEGMENT 13

MUNICIPALITY	COUNTY	APPROVAL DATE	NEW NUMBER	EXISTING NUMBER	STREET NAME	LENGTH (miles)	TYPE OF CHANGE	REMARKS (See Attached Map)
66030603	ONSIOW	3/6/03		SR 1722		0.56	SYSTEM DELETION VIA MUNICIPAL AGREEMENT	MAP A, SEGMENT 14
66030603	ONSIOW	3/6/03		SR 1722		0.10	SYSTEM DELETION VIA MUNICIPAL AGREEMENT	MAP A, SEGMENT 15
66030603	ONSIOW	3/6/03		SR 1723		0.06	SYSTEM DELETION VIA MUNICIPAL AGREEMENT	MAP A, SEGMENT 16
66030603	ONSIOW	3/6/03		SR 1724		0.10	SYSTEM DELETION VIA MUNICIPAL AGREEMENT	MAP A, SEGMENT 17
66030603	ONSIOW	3/6/03		SR 1724		0.20	SYSTEM DELETION VIA MUNICIPAL AGREEMENT	MAP A, SEGMENT 18
66030603	ONSIOW	3/6/03		SR 1725		0.25	SYSTEM DELETION VIA MUNICIPAL AGREEMENT	MAP A, SEGMENT 19
66030603	ONSIOW	3/6/03		SR 1741		0.10	SYSTEM DELETION VIA MUNICIPAL AGREEMENT	MAP A, SEGMENT 20
66030603	ONSIOW	3/6/03		SR 1797		0.48	SYSTEM DELETION VIA MUNICIPAL AGREEMENT	MAP A, SEGMENT 21

PETITION # : _____

CO: Onslow Co.

SR #: 1741, 1797
1451, 1466, 1467,

1468, 1472, 1473,

1474, 1719, 1720,

1721, 1722, 1723

MAP A
DATE 11/05/03

ADDITION 1724, 1725

DELETION _____

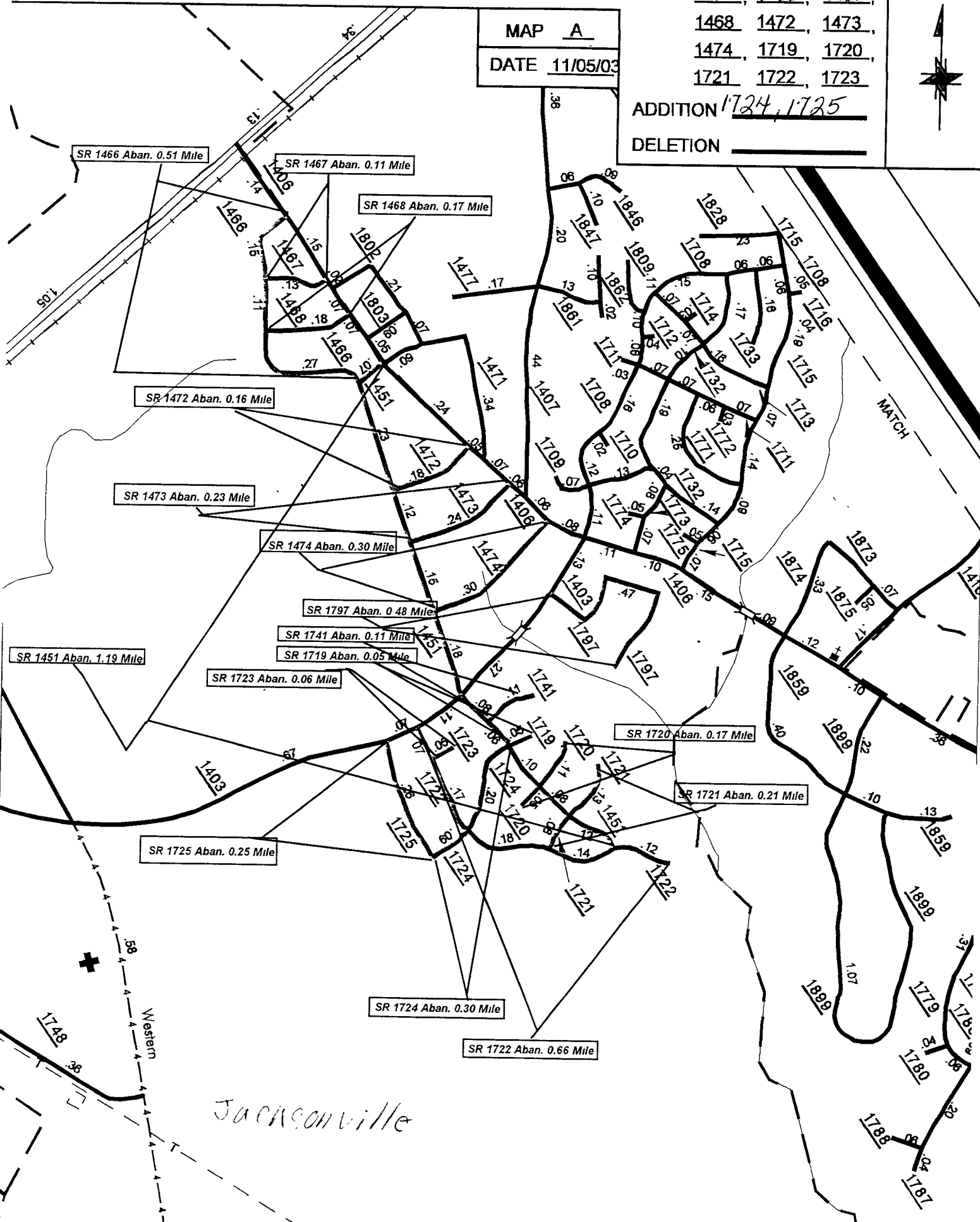

SOURCE : PLAT

SHEET : 2 OF 5

NAME : BCH

SCALE : 4:1