



STATE OF NORTH CAROLINA
DEPARTMENT OF TRANSPORTATION

MICHAEL F. EASLEY
GOVERNOR

April 08, 2005

LYNDO TIPPETT
SECRETARY

MEMORANDUM TO: Mr. Mike Mills, PE
Division Engineer
Division 7

FROM: Forrest L. Robson, PE
GIS Director

SUBJECT: Road System Changes

The Road Inventory Section has been authorized to make the following changes to the state road system as indicated below. We request that you make similar changes to the related maps and files in your Division and District offices, and install appropriate road number signs if necessary. We have updated our records and county maps accordingly. If our system changes do not conform to the actual conditions in the field, please return this memorandum with recommendations.

TIP Number	County	Approval Date
I-2402,A,B,C,D	GUILFORD	8/26/03

Inquires about secondary road petition changes should be referred to Ron Tucker, Secondary Roads Group Supervisor at (919) 212-6080. Inquires about TIP Project changes should be referred to Tom Schroeder, Primary Highway Group Supervisor at (919) 212-6074. If you have further questions, please contact Hardee Cox, Road Inventory Manager at (919) 212-6060. Thank you for your assistance.

FLR/hrc
enclosures ()

cc: BSIP
Bridge Maintenance
Pavement Management
Permit Unit
Right of Way
Safety Management
State Road Maintenance
Traffic Engineering
Traffic Surveys

MAILING ADDRESS:
NC DEPARTMENT OF TRANSPORTATION
GEOGRAPHIC INFORMATION SYSTEMS
1587 MAIL SERVICE CENTER
RALEIGH NC 27699-1587



DELIVERY ADDRESS:
3401 CARL SANDBURG CT.
RALEIGH, NC 27610
PHONE: (919) 212-6000
FAX: (919) 212-5999

Road System Changes

TIP NUMBER	COUNTY	APPROVAL DATE	NEW NUMBER	EXISTING NUMBER	STREET NAME	LENGTH (miles)	TYPE OF CHANGE	REMARKS (See Attached Map)
I-2402,A,B,C,D	GUILFORD	8/26/03		SR 1481		0.02	SYSTEM DELETION VIA TIP PROJECT	MAP A, SEGMENT 1
I-2402,A,B,C,D	GUILFORD	8/26/03	SR 3278	SR 1125		0.05	NUMBER REASSIGNMENT VIA TIP PROJECT	MAP A, SEGMENT 2
I-2402,A,B,C,D	GUILFORD	8/26/03		SR 1125		0.35	TIP PROJECT SYSTEM DELETION VIA TIP PROJECT	MAP A, SEGMENT 3
I-2402,A,B,C,D	GUILFORD	8/26/03		SR 3278		0.09	SYSTEM ADDITION VIA TIP PROJECT	MAP A, SEGMENT 4
I-2402,A,B,C,D	GUILFORD	8/26/03		SR 1117		0.34	SYSTEM DELETION VIA TIP PROJECT	MAP A, SEGMENT 5
I-2402,A,B,C,D	GUILFORD	8/26/03		SR 1419		0.62	SYSTEM DELETION VIA TIP PROJECT	MAP A, SEGMENT 6
I-2402,A,B,C,D	GUILFORD	8/26/03		SR 1419		0.14	SYSTEM ADDITION VIA TIP PROJECT	MAP A, SEGMENT 7
I-2402,A,B,C,D	GUILFORD	8/26/03		SR 1282		0.31	SYSTEM DELETION VIA TIP PROJECT	MAP A, SEGMENT 8
I-2402,A,B,C,D	GUILFORD	8/26/03		SR 3285		0.38	SYSTEM ADDITION VIA TIP PROJECT	MAP B, SEGMENT 9
I-2402,A,B,C,D	GUILFORD	8/26/03		SR 3287		0.02	SYSTEM ADDITION VIA TIP PROJECT	MAP B, SEGMENT 10
I-2402,A,B,C,D	GUILFORD	8/26/03	SR 3287	SR 3314		0.25	TIP PROJECT NUMBER REASSIGNMENT VIA TIP PROJECT	MAP B, SEGMENT 11
I-2402,A,B,C,D	GUILFORD	8/26/03		SR 3287		0.06	SYSTEM DELETION VIA TIP PROJECT	MAP B, SEGMENT 12
I-2402,A,B,C,D	GUILFORD	8/26/03		SR 3314		0.18	SYSTEM DELETION VIA TIP PROJECT	MAP B, SEGMENT 13

TIP NUMBER	COUNTY	APPROVAL DATE	NEW NUMBER	EXISTING NUMBER	STREET NAME	LENGTH (miles)	TYPE OF CHANGE	REMARKS (See Attached Map)
I-2402,A,B,C,D	GUILFORD	8/26/03	SR 3284	SR 1005		0.40	NUMBER REASSIGNMENT VIA TIP PROJECT	MAP B, SEGMENT 14
I-2402,A,B,C,D	GUILFORD	8/26/03		SR 3284		0.16	SYSTEM DELETION VIA TIP PROJECT	MAP B, SEGMENT 15
I-2402,A,B,C,D	GUILFORD	8/26/03		SR 3284		0.10	SYSTEM DELETION VIA TIP PROJECT	MAP B, SEGMENT 16
I-2402,A,B,C,D	GUILFORD	8/26/03	SR 3285	SR 3314		0.94	NUMBER REASSIGNMENT VIA TIP PROJECT	MAP B, SEGMENT 17
I-2402,A,B,C,D	GUILFORD	8/26/03		SR 1005		0.40	SYSTEM ADDITION VIA TIP PROJECT	MAP B, SEGMENT 18
I-2402,A,B,C,D	GUILFORD	8/26/03		SR 3269		1.60	SYSTEM ADDITION VIA TIP PROJECT	MAP C, SEGMENT 19
I-2402,A,B,C,D	GUILFORD	8/26/03		SR 3142		0.05	SYSTEM DELETION VIA TIP PROJECT	MAP C, SEGMENT 20
I-2402,A,B,C,D	GUILFORD	8/26/03		SR 3142		0.38	SYSTEM ADDITION VIA TIP PROJECT	MAP C, SEGMENT 21
I-2402,A,B,C,D	GUILFORD	8/26/03	SR 3286	SR 3046		0.19	NUMBER REASSIGNMENT VIA TIP PROJECT	MAP C, SEGMENT 22
I-2402,A,B,C,D	GUILFORD	8/26/03		SR 3286		0.07	SYSTEM DELETION VIA TIP PROJECT	MAP C, SEGMENT 23
I-2402,A,B,C,D	GUILFORD	8/26/03		SR 3038		0.24	SYSTEM ADDITION VIA TIP PROJECT	MAP D, SEGMENT 24
I-2402,A,B,C,D	GUILFORD	8/26/03		SR 3038		0.27	SYSTEM DELETION VIA TIP PROJECT	MAP D, SEGMENT 25
I-2402,A,B,C,D	GUILFORD	8/26/03		SR 3314		0.31	SYSTEM ADDITION VIA TIP PROJECT	MAP D, SEGMENT 26
I-2402,A,B,C,D	GUILFORD	8/26/03		SR 3314		0.31	SYSTEM DELETION VIA TIP PROJECT	MAP D, SEGMENT 27

TIP NUMBER	COUNTY	APPROVAL DATE	NEW NUMBER	EXISTING NUMBER	STREET NAME	LENGTH (miles)	TYPE OF CHANGE	REMARKS (See Attached Map)
I-2402-A,B,C,D	GUILFORD	8/26/03		SR 3674		0.04	SYSTEM DELETION VIA TIP PROJECT	MAP D, SEGMENT 28
I-2402-A,B,C,D	GUILFORD	8/26/03		SR 3738		0.07	SYSTEM DELETION VIA TIP PROJECT	MAP D, SEGMENT 29
I-2402-A,B,C,D	GUILFORD	8/26/03	SR 3279	SR 1125		0.60	NUMBER REASSIGNMENT VIA TIP PROJECT	MAP E, SEGMENT 30
I-2402-A,B,C,D	GUILFORD	8/26/03	SR 3281			0.25	TIP PROJECT SYSTEM ADDITION VIA TIP PROJECT	MAP E, SEGMENT 31
I-2402-A,B,C,D	GUILFORD	8/26/03		SR 1281		0.90	SYSTEM DELETION VIA TIP PROJECT	MAP E, SEGMENT 32
I-2402-A,B,C,D	GUILFORD	8/26/03		SR 1406		0.02	SYSTEM DELETION VIA TIP PROJECT	MAP E, SEGMENT 33
I-2402-A,B,C,D	GUILFORD	8/26/03		SR 1383		0.42	SYSTEM ADDITION VIA TIP PROJECT	MAP E, SEGMENT 34
I-2402-A,B,C,D	GUILFORD	8/26/03		SR 1383		0.42	SYSTEM DELETION VIA TIP PROJECT	MAP E, SEGMENT 35
I-2402-A,B,C,D	GUILFORD	8/26/03		SR 1104		0.06	SYSTEM DELETION VIA TIP PROJECT	MAP F, SEGMENT 36
I-2402-A,B,C,D	GUILFORD	8/26/03	SR 3283	SR 1104		0.08	NUMBER REASSIGNMENT VIA TIP PROJECT	MAP F, SEGMENT 37
I-2402-A,B,C,D	GUILFORD	8/26/03	SR 3283			0.03	TIP PROJECT SYSTEM ADDITION VIA TIP PROJECT	MAP F, SEGMENT 38
I-2402-A,B,C,D	GUILFORD	8/26/03		SR 1104		0.14	TIP PROJECT SYSTEM DELETION VIA TIP PROJECT	MAP F, SEGMENT 39
I-2402-A,B,C,D	GUILFORD	8/26/03		SR 1221		0.15	TIP PROJECT SYSTEM DELETION VIA TIP PROJECT	MAP F, SEGMENT 40
I-2402-A,B,C,D	GUILFORD	8/26/03		SR 3459		0.08	SYSTEM DELETION VIA TIP PROJECT	MAP F, SEGMENT 41

TIP NUMBER	COUNTY	APPROVAL DATE	NEW NUMBER	EXISTING NUMBER	STREET NAME	LENGTH (miles)	TYPE OF CHANGE	REMARKS (See Attached Map)
I-2402,A,B,C,D	GUILFORD	8/26/03	SR 3282	SR 1117		0.66	NUMBER REASSIGNMENT VIA TIP PROJECT	MAP G, SEGMENT 42
I-2402,A,B,C,D	GUILFORD	8/26/03		SR 3559		0.26	SYSTEM DELETION VIA TIP PROJECT	MAP G, SEGMENT 43
I-2402,A,B,C,D	GUILFORD	8/26/03		SR 3029		0.31	SYSTEM ADDITION VIA TIP PROJECT	MAP G, SEGMENT 44
I-2402,A,B,C,D	GUILFORD	8/26/03		SR 3029		0.31	SYSTEM DELETION VIA TIP PROJECT	MAP G, SEGMENT 45
I-2402,A,B,C,D	GUILFORD	8/26/03	SR 3289	SR 3000		0.19	NUMBER REASSIGNMENT VIA TIP PROJECT	MAP H, SEGMENT 46
I-2402,A,B,C,D	GUILFORD	8/26/03		SR 3000		0.20	SYSTEM ADDITION VIA TIP PROJECT	MAP H, SEGMENT 47
I-2402,A,B,C,D	GUILFORD	8/26/03		SR 3289		0.02	SYSTEM ADDITION VIA TIP PROJECT	MAP H, SEGMENT 48
I-2402,A,B,C,D	GUILFORD	8/26/03		SR 3289		0.04	SYSTEM DELETION VIA TIP PROJECT	MAP H, SEGMENT 49
I-2402,A,B,C,D	GUILFORD	8/26/03		SR 3289		0.11	SYSTEM DELETION VIA TIP PROJECT	MAP H, SEGMENT 50
I-2402,A,B,C,D	GUILFORD	8/26/03	SR 3288			0.09	SYSTEM ADDITION VIA TIP PROJECT	MAP H, SEGMENT 51
I-2402,A,B,C,D	GUILFORD	8/26/03		I-85		12.96	SYSTEM ADDITION VIA TIP PROJECT	MAP I, SEGMENT 52
I-2402,A,B,C,D	GUILFORD	8/26/03	I-85 BUS	I-85		3.41	NUMBER REASSIGNMENT VIA TIP PROJECT	MAP J, SEGMENT 53
I-2402,A,B,C,D	GUILFORD	8/26/03		I-85		0.43	SYSTEM DELETION VIA TIP PROJECT	MAP J, SEGMENT 54
I-2402,A,B,C,D	GUILFORD	8/26/03		I-85 BUS		0.75	SYSTEM ADDITION VIA TIP PROJECT	MAP J, SEGMENT 55

TIP NUMBER	COUNTY	APPROVAL DATE	NEW NUMBER	EXISTING NUMBER	STREET NAME	LENGTH (miles)	TYPE OF CHANGE	REMARKS (See Attached Map)
I-2402,A,B,C,D	GUILFORD	8/26/03		SR 1007		0.25	SYSTEM DELETION VIA TIP PROJECT	MAP K, SEGMENT 56
I-2402,A,B,C,D	GUILFORD	8/26/03		SR 1007		0.25	SYSTEM ADDITION VIA TIP PROJECT	MAP K, SEGMENT 57

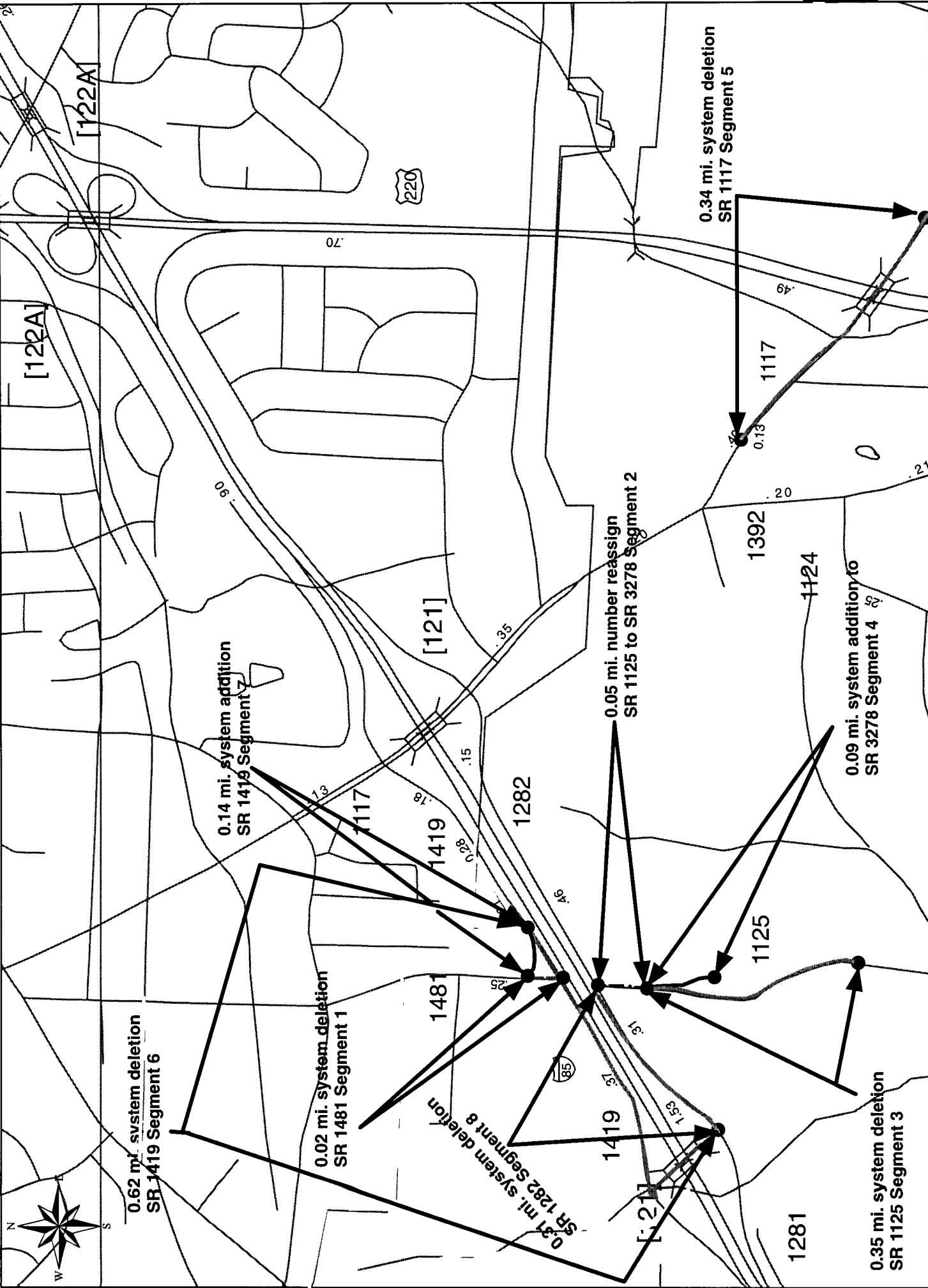

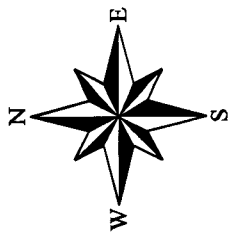

0.94 mi. number reassign from
SR 3314 to SR 3285
Segment 17

3307

0.18 mi system deletion
SR 3314 Segment 13

3314

0.25 mi. number reassign from
SR 3314 to SR 3287 Segment 11

0.06 mi. system deletion from
SR 3287 Segment 12

0.38 mi. system addition
SR 3285 Segment 9

0.40 mi. number reassign from
SR 1005 to SR 3284
Segment 14

1005

0.02 mi. system addition
SR 3287 Segment 10

0.16 mi. system deletion
SR 3284 Segment 15

0.10 mi. system deletion
SR 3284 Segment 16

0.40 mi. system addition
SR 1005 Segment 18

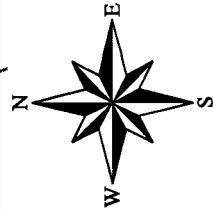
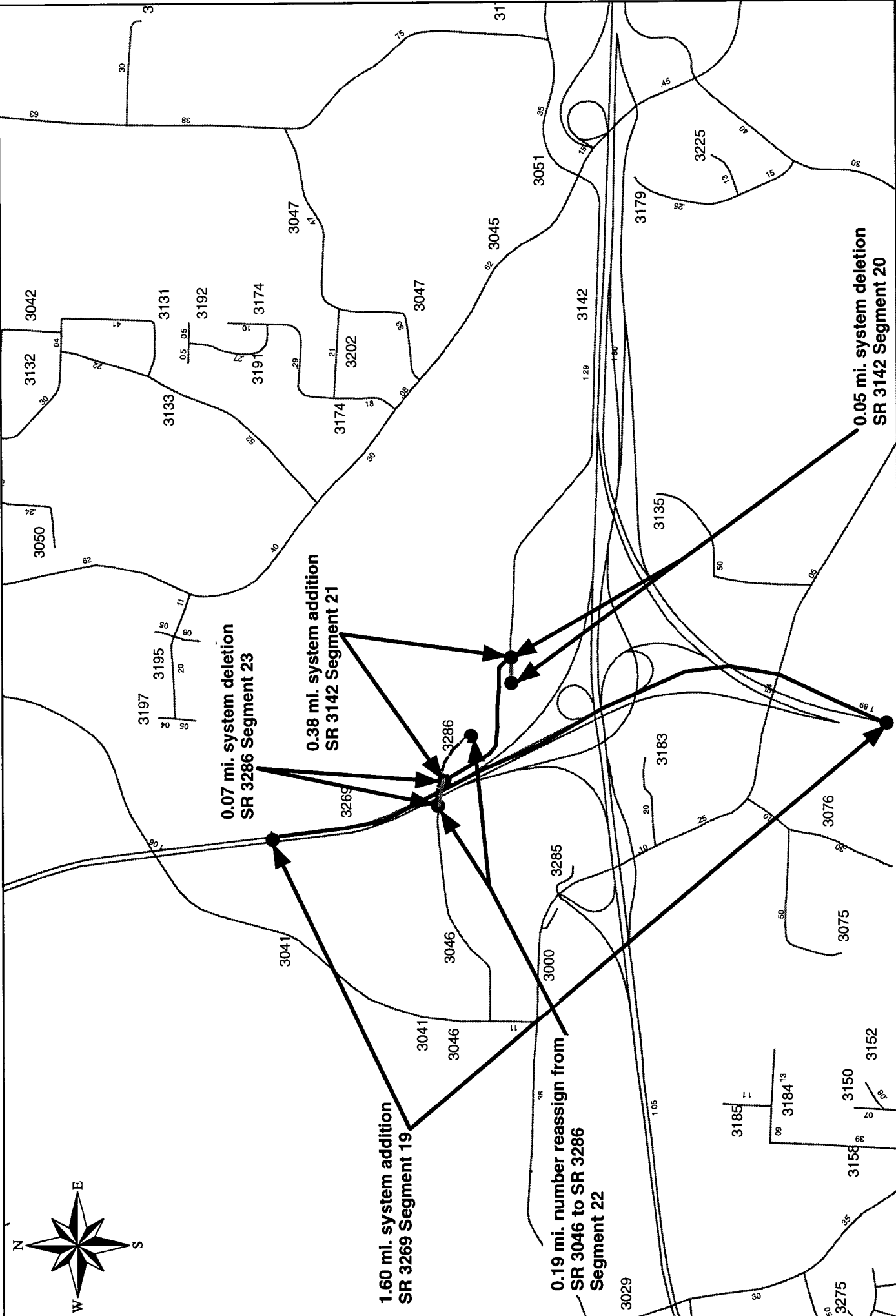

**1.60 mi. system addition
SR 3269 Segment 19**

**0.07 mi. system deletion
SR 3286 Segment 23**

**0.38 mi. system addition
SR 3142 Segment 21**

**0.19 mi. number reassign from
SR 3046 to SR 3286
Segment 22**

**0.05 mi. system deletion
SR 3142 Segment 20**

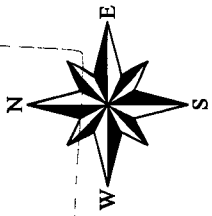

0.31 mi. system deletion
SR 3314 Segment 27

0.31 mi. System addition
SR 3314 Segment 26

0.27 mi. system deletion
SR 3038 Segment 25

0.24 mi. system addition
SR 3038 Segment 24

0.04 mi. system deletion
SR 3674 Segment 28

0.07 mi. system deletion
SR 3738 Segment 29



3559

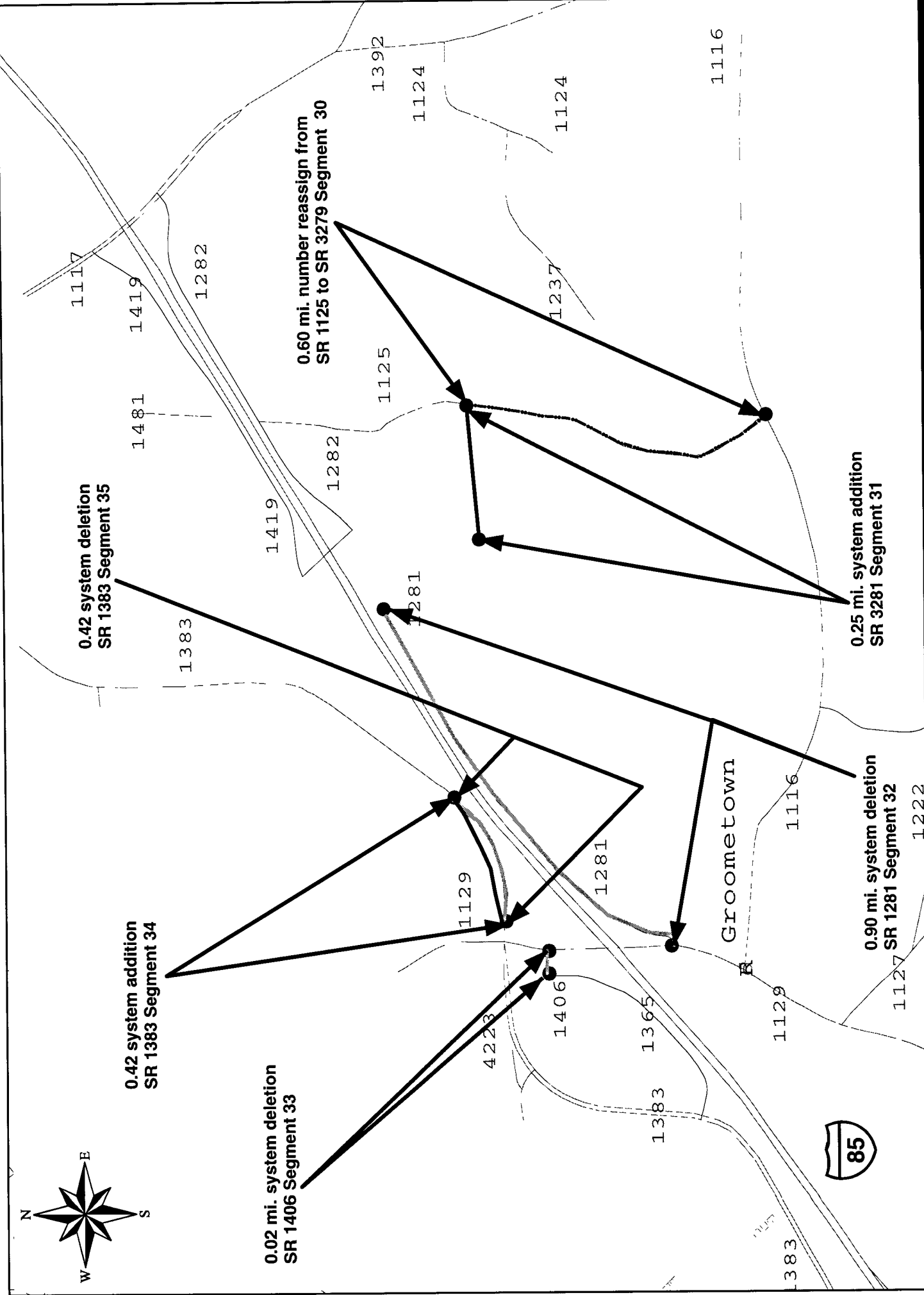
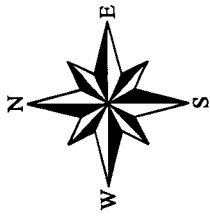

0.42 system deletion
SR 1383 Segment 35

0.42 system addition
SR 1383 Segment 34

0.02 mi. system deletion
SR 1406 Segment 33

0.60 mi. number reassign from
SR 1125 to SR 3279 Segment 30

0.25 mi. system addition
SR 3281 Segment 31

0.90 mi. system deletion
SR 1281 Segment 32

Groometown



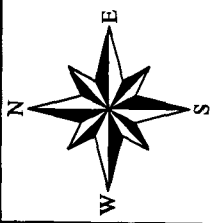

Rehobeth

Randjeman

0.15 mi. system deletion
SR 1221 Segment 40

0.06 mi. system deletion
SR 1104 Segment 36

0.14 mi. system deletion
SR 1104 Segment 39

0.08 mi system deletion
SR 3459 Segment 41

0.08 mi. number reassign
from SR 1104 to SR 3283
Segment 37

0.03 mi. system addition
SR 3283 Segment 38

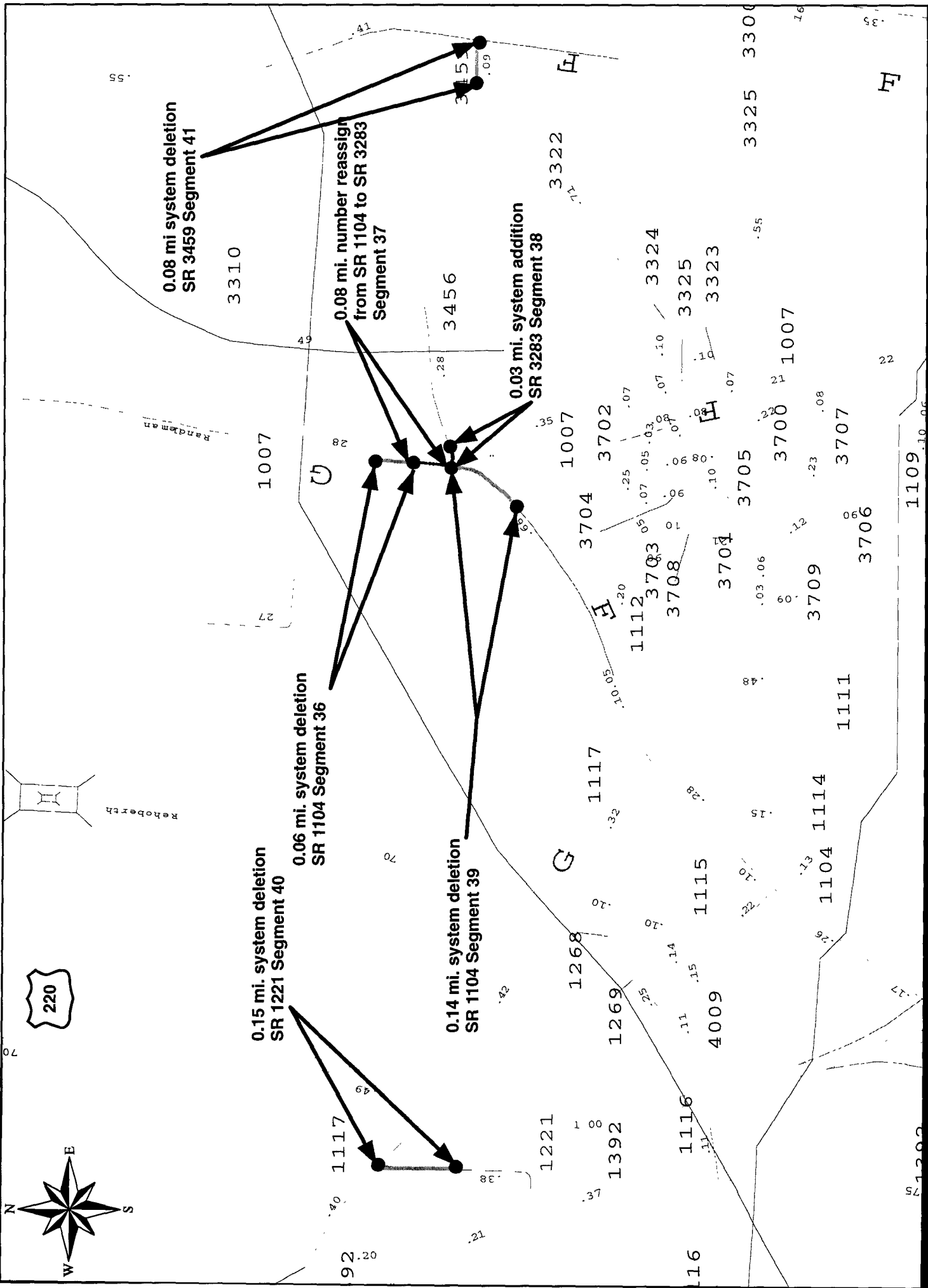

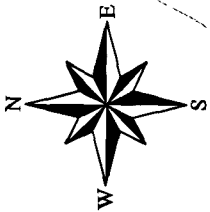

0.31 mi. system addition
SR 3029 Segment 44

0.31 mi. system deletion
SR 3029 Segment 45

0.66 mi. number reassign
from SR 1117 to SR 3282
Segment 42

0.26 mi. system deletion
SR 3559 Segment 43

7.80

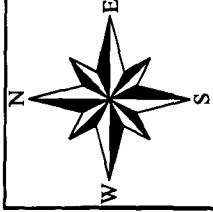

0.20 mi. system addition
SR 3000 Segment 47

0.02 mi. system addition
SR 3289 Segment 48

0.09 mi. system addition
SR 3288 Segment 51

0.04 mi. system deletion
SR 3289 Segment 49

0.19 number reassign from
SR 3000 to SR 3289
Segment 46

0.11 mi. system deletion
SR 3289 Segment 50

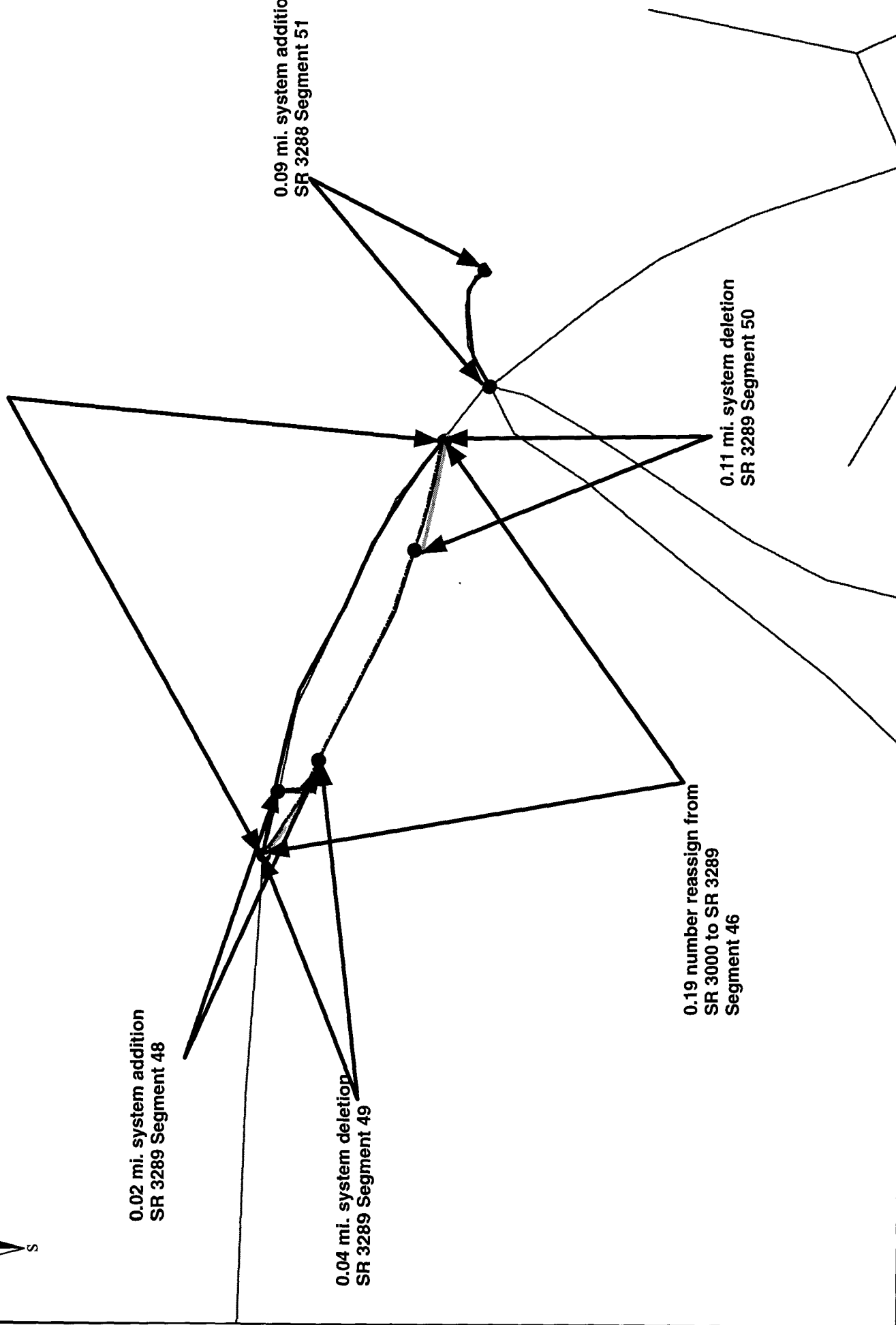

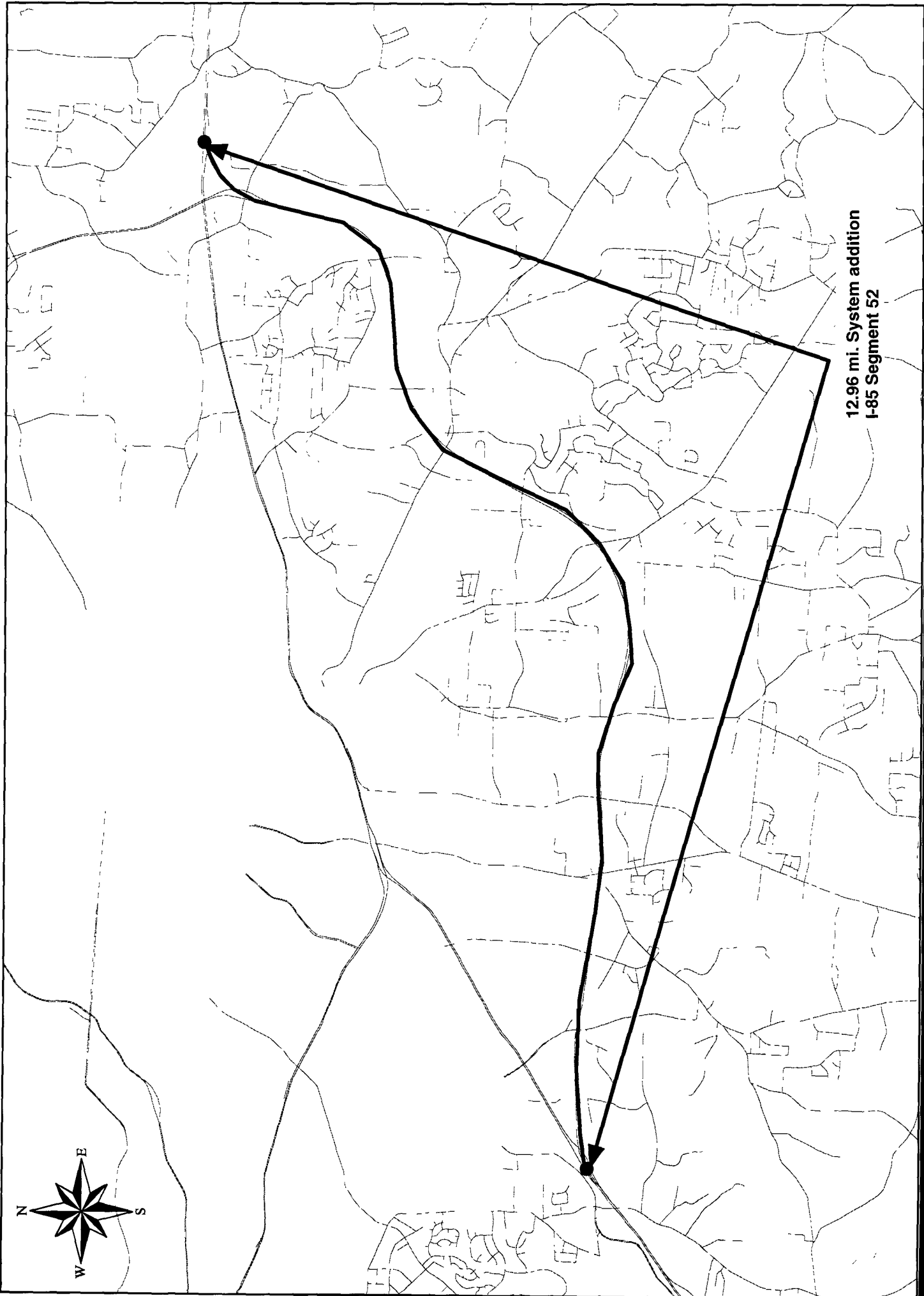

12.96 mi. System addition
I-85 Segment 52

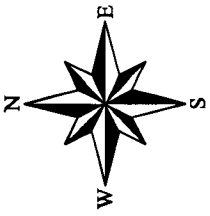

0.43 mi. system deletion
I-85 Segment 54

3.41 mi. number reassign
from I-85 to I-85 Bus
Segment 53

0.75 mi. system addition
I-85 Bus Segment 55

