



STATE OF NORTH CAROLINA
DEPARTMENT OF TRANSPORTATION

MICHAEL F. EASLEY
GOVERNOR

November 25, 2003

LYNDO TIPPETT
SECRETARY

MEMORANDUM TO: Mr. Mike Mills, PE
Division Engineer
Division 7

FROM: Forrest L. Robson, PE
GIS Director

SUBJECT: Road System Changes

The Road Inventory Section has been authorized to make the following changes to the state road system as indicated below. We request that you make similar changes to the related maps and files in your Division and District offices, and install appropriate road number signs if necessary. We have updated our records and county maps accordingly. If our system changes do not conform to the actual conditions in the field, please return this memorandum with recommendations.

Project/ Petition Number	County	Approval Date
46588	GUILFORD	8/7/03

Inquires about secondary road petition changes should be referred to Ron Tucker, Secondary Roads Group Supervisor at (919) 212-6080. Inquires about TIP Project changes should be referred to Tom Schroeder, Primary Highway Group Supervisor at (919) 212-6074. If you have further questions, please contact Hardee Cox, Road Inventory Manager at (919) 212-6060. Thank you for your assistance.

FLR/hrc
enclosures ()

- cc: BSIP
Bridge Maintenance
Pavement Management
Permit Unit
Right of Way
Safety Management
State Road Maintenance
Traffic Engineering
Traffic Surveys

MAILING ADDRESS:
NC DEPARTMENT OF TRANSPORTATION
GEOGRAPHIC INFORMATION SYSTEMS
1587 MAIL SERVICE CENTER
RALEIGH NC 27699-1587



www.ncdot.org/statewide/planning/gis

DELIVERY ADDRESS:
3401 CARL SANDBURG CT.
RALEIGH, NC 27610
PHONE: (919) 212-6000
FAX: (919) 212-5999

Road System Changes

PROJECT/ PETITION #	COUNTY	APPROVAL DATE	NEW NUMBER	EXISTING NUMBER	STREET NAME	LENGTH	TYPE OF CHANGE	REMARKS (See Attached)
46588	GUILFORD	8/7/03	SR 3734		LIBERTY VALLEY RD	0.21	SYSTEM ADDITION VIA PETITION	MAP A

PETITION #: 46588

CO: GUILFORD

SR #: 3734

MAP A

DATE 2/9/04

ADDITION X

DELETION _____

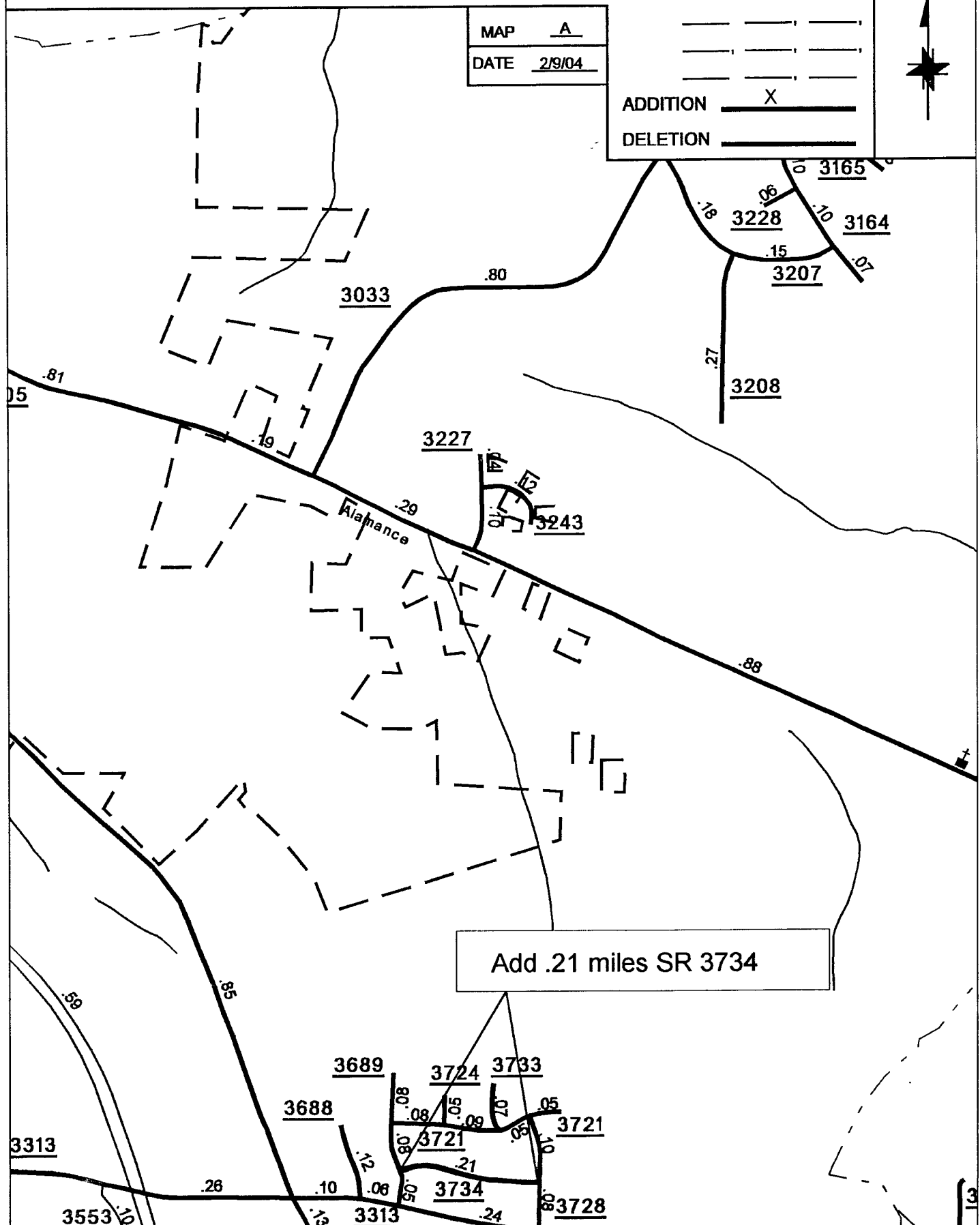

Add .21 miles SR 3734

SOURCE: Plat

SHEET: 6 OF 10

NAME: RLN

SCALE: NTS