



STATE OF NORTH CAROLINA
DEPARTMENT OF TRANSPORTATION

MICHAEL F. EASLEY
GOVERNOR

March 09, 2004

LYNDO TIPPETT
SECRETARY

MEMORANDUM TO: Mr. C.E. Lassiter, PE
Division Engineer
Division 2

FROM: Forrest L. Robson, PE
GIS Director

SUBJECT: Road System Changes

The Road Inventory Section has been authorized to make the following changes to the state road system as indicated below. We request that you make similar changes to the related maps and files in your Division and District offices, and install appropriate road number signs if necessary. We have updated our records and county maps accordingly. If our system changes do not conform to the actual conditions in the field, please return this memorandum with recommendations. *R-2719EA*

Project Number	County	Approval Date
8.2200103	LENOIR	8/1/03

Inquires about secondary road petition changes should be referred to Ron Tucker, Secondary Roads Group Supervisor at (919) 212-6080 Inquires about TIP Project changes should be referred to Tom Schroeder, Primary Highway Group Supervisor at (919) 212-6074 If you have further questions, please contact Hardee Cox, Road Inventory Manager at (919) 212-6060. Thank you for your assistance.

FLR/hrc
enclosures ()

- cc: BSIP
Bridge Maintenance
Pavement Management
Permit Unit
Right of Way
Safety Management
State Road Maintenance
Traffic Engineering
Traffic Surveys

MAILING ADDRESS:
NC DEPARTMENT OF TRANSPORTATION
GEOGRAPHIC INFORMATION SYSTEMS
1587 MAIL SERVICE CENTER
RALEIGH, NC 27699-1587



www.ncdot.org/statewide/planning/gis

DELIVERY ADDRESS:
3401 CARL SANDBURG CT.
RALEIGH, NC 27610
PHONE (919) 212-6000
FAX (919) 212-5999

Road System Changes

PROJECT NUMBER	COUNTY	APPROVAL DATE	NEW NUMBER	EXISTING NUMBER	STREET NAME	LENGTH (miles)	TYPE OF CHANGE	REMARKS (See Attached Map)
8 2200103	LENOIR	8/1/03		SR 2010	CRESCENT ROAD	2.10	SYSTEM ADDITION VIA PROJECT	MAP A, SEGMENT 1
8 2200103	LENOIR	8/1/03		SR 1575		0.17	SYS. LTM DELETION VIA PROJECT	MAP A, SEGMENT 2
8 2200103	LENOIR	8/1/03		SR 1575	POOLE ROAD	0.16	SYSTEM DELETION VIA PROJECT	MAP B, SEGMENT 3
8 2200103	LENOIR	8/1/03		SR 1607	SHACKLEFORD RD	0.31	SYSTEM DELETION VIA PROJECT	MAP B, SEGMENT 4
8 2200103	LENOIR	8/1/03		SR 2014		0.07	SYS. LTM ADDITION VIA PROJECT	MAP B, SEGMENT 5
8 2200103	LENOIR	8/1/03		SR 1575		0.24	SYSTEM ADDITION VIA PROJECT	MAP B, SEGMENT 6
8 2200103	LENOIR	8/1/03	SR 2013	SR 1575		0.43	NUMBER REASSIGNMENT VIA PROJECT	MAP C, SEGMENT 7
8 2200103	LENOIR	8/1/03	SR 2015	SR 1607		0.25	NUMBER REASSIGNMENT VIA PROJECT	MAP C, SEGMENT 8
8 2200103	LENOIR	8/1/03	SR 2014	SR 1575		0.15	NUMBER REASSIGNMENT VIA PROJECT	MAP C, SEGMENT 9
8 2200103	LENOIR	8/1/03		SR 1574	ROBINSON ROAD	0.14	SYSTEM DELETION VIA PROJECT	MAP D, SEGMENT 10

Project: 8.2200103
TIP # R-2719 BA
Lenoir Co.

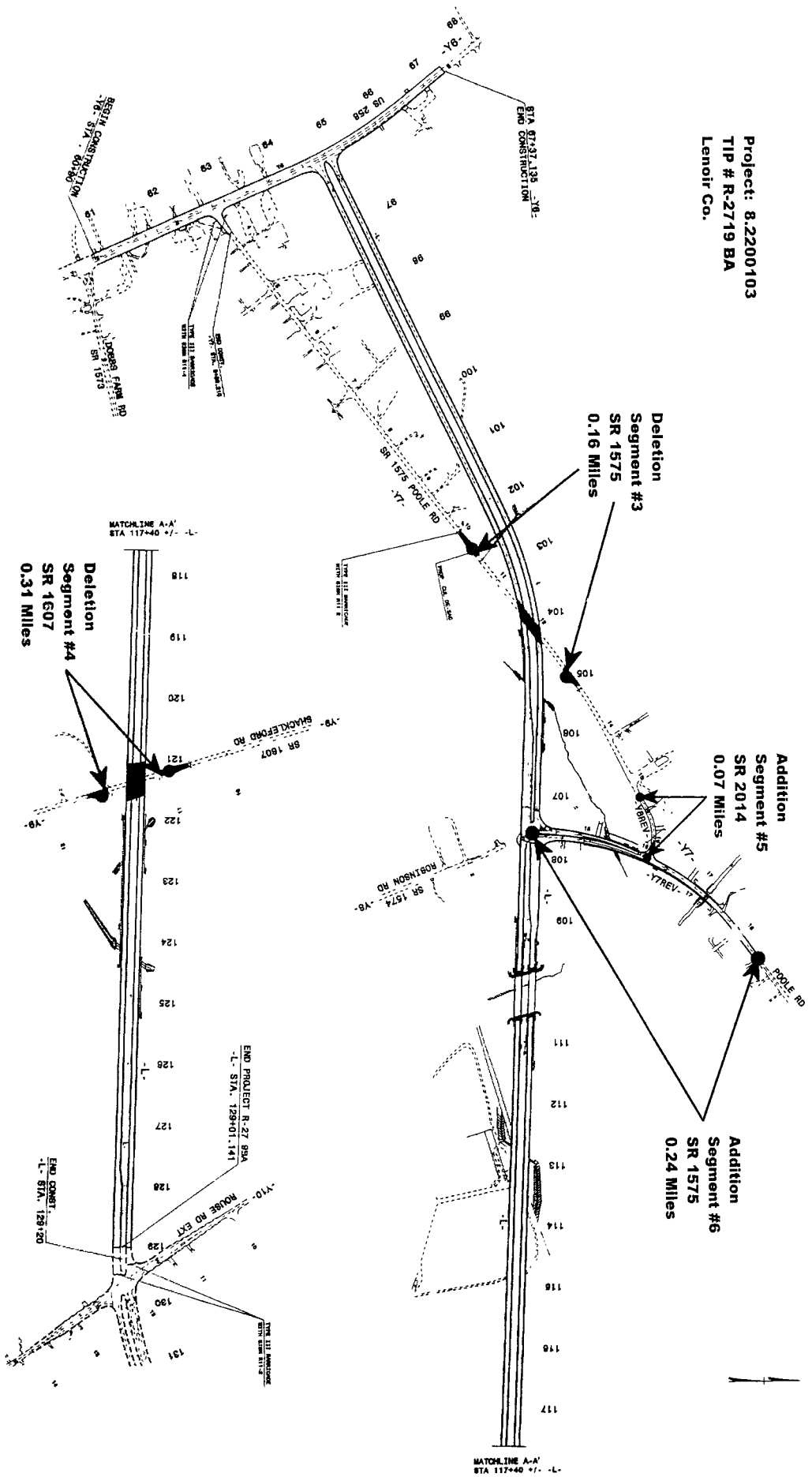

Map B

Project: 8.2200103
TIP # R-2719 BA
Lenoir Co.

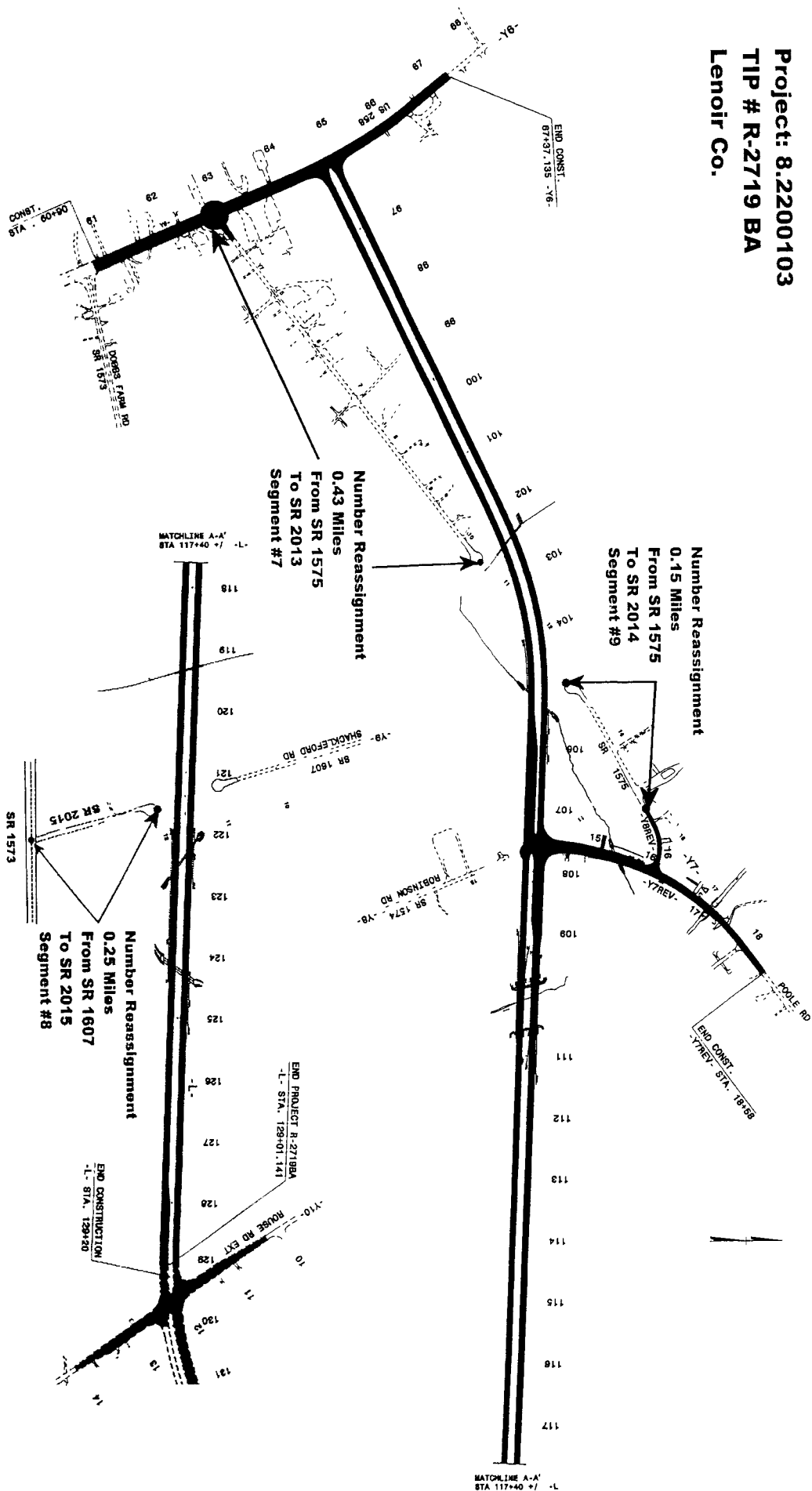

Map C

Project: 8.2200103
TIP # R-2719 BA
Lenoir Co.

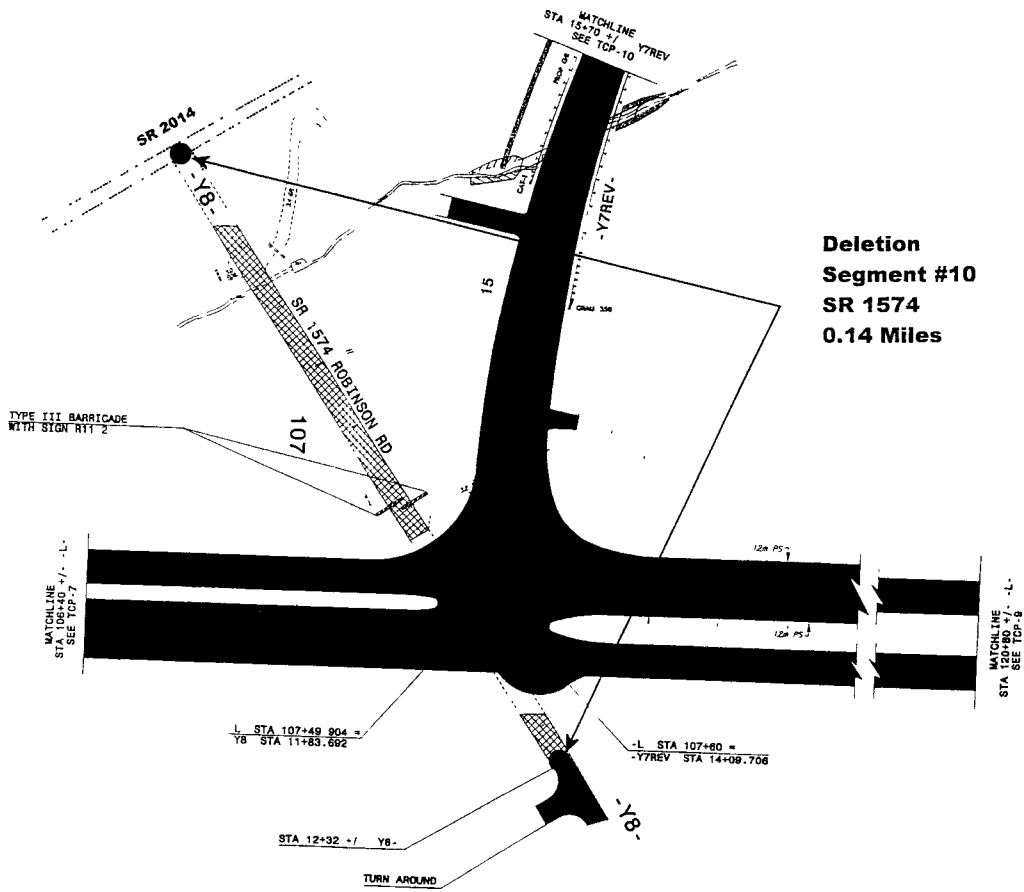

**Deletion
Segment #10
SR 1574
0.14 Miles**

Map D