



STATE OF NORTH CAROLINA  
DEPARTMENT OF TRANSPORTATION

MICHAEL F. EASLEY  
GOVERNOR

April 28, 2004

LYNDO TIPPETT  
SECRETARY

**MEMORANDUM TO:** Mr. D.R. Conner, PE  
Division Engineer  
Division 1

**FROM:** Forrest L. Robson, PE  
GIS Director

**SUBJECT:** Road System Changes

The Road Inventory Section has been authorized to make the following changes to the state road system as indicated below. We request that you make similar changes to the related maps and files in your Division and District offices, and install appropriate road number signs if necessary. We have updated our records and county maps accordingly. If our system changes do not conform to the actual conditions in the field, please return this memorandum with recommendations.

Hwy. Ordinance #	County	Approval Date
1997-70	MARTIN	7/25/97
2003-165	MARTIN	9/15/03
6.099010T	MARTIN	8/29/03

Inquires about secondary road petition changes should be referred to Ron Tucker, Secondary Roads Group Supervisor at (919) 212-6080. Inquires about TIP Project changes should be referred to Tom Schroeder, Primary Highway Group Supervisor at (919) 212-6074. If you have further questions, please contact Hardee Cox, Road Inventory Manager at (919) 212-6060. Thank you for your assistance.

FLR/hrc  
enclosures ( )

- cc: BSIP  
Bridge Maintenance  
Pavement Management  
Permit Unit  
Right of Way  
Safety Management  
State Road Maintenance  
Traffic Engineering  
Traffic Surveys

MAILING ADDRESS:  
NC DEPARTMENT OF TRANSPORTATION  
GEOGRAPHIC INFORMATION SYSTEMS  
1587 MAIL SERVICE CENTER  
RALEIGH NC 27699-1587



[www.ncdot.org/statewide/planning/gis](http://www.ncdot.org/statewide/planning/gis)

DELIVERY ADDRESS:  
3401 CARL SANDBURG CT.  
RALEIGH, NC 27610  
PHONE: (919) 212-6000  
FAX: (919) 212-5999

# Road System Changes

PROJECT NUMBER	COUNTY	APPROVAL DATE	NEW NUMBER	EXISTING NUMBER	STREET NAME	LENGTH (miles)	TYPE OF CHANGE	REMARKS (See Attached Map)
6.099010T	MARTIN	8/29/03		US 13/64		1.71	SYSTEM ADDITION VIA PROJECT	MAP A, SEGMENT 1
6.099010T	MARTIN	8/29/03		US 13/ US 17		0.20	SYSTEM ADDITION VIA PROJECT	MAP A, SEGMENT 2
6.099010T	MARTIN	8/29/03		US 13/17		0.36	SYSTEM ADDITION VIA PROJECT	MAP A, SEGMENT 2
6.099010T	MARTIN	8/29/03		SR 1598		0.13	SYSTEM REASSIGNMENT VIA PROJECT	MAP B, SEGMENT 3
6.099010T	MARTIN	8/29/03		SR 1598		0.11	SYSTEM ADDITION VIA PROJECT	MAP B, SEGMENT 4
6.099010T	MARTIN	8/29/03		US 13/17 BYPASS		0.34	SYSTEM DELETION VIA PROJECT	MAP B, SEGMENT 5
2003-165	MARTIN	9/15/03	US 17 BUS	US 17		1.61	NUMBER REASSIGNMENT VIA HIGHWAY TRAFIC ORD	MAP C, SEGMENT 6
1997-70	MARTIN	7/25/97	US 64 ALT	US 13-17-64		0.48	NUMBER REASSIGNMENT VIA HIGHWAY TRAFIC ORD	MAP C, SEGMENT 7
1997-70	MARTIN	7/25/97	US 64 ALT	US 64		0.25	NUMBER REASSIGNMENT VIA HIGHWAY TRAFIC ORD	MAP C, SEGMENT 8

**PROJECT: 6.099010T**

**R-2112BB**

# MARTIN COUNTY

**Location: US 64 From US 17 South of Williamston  
To US 13-17 In Williamston**

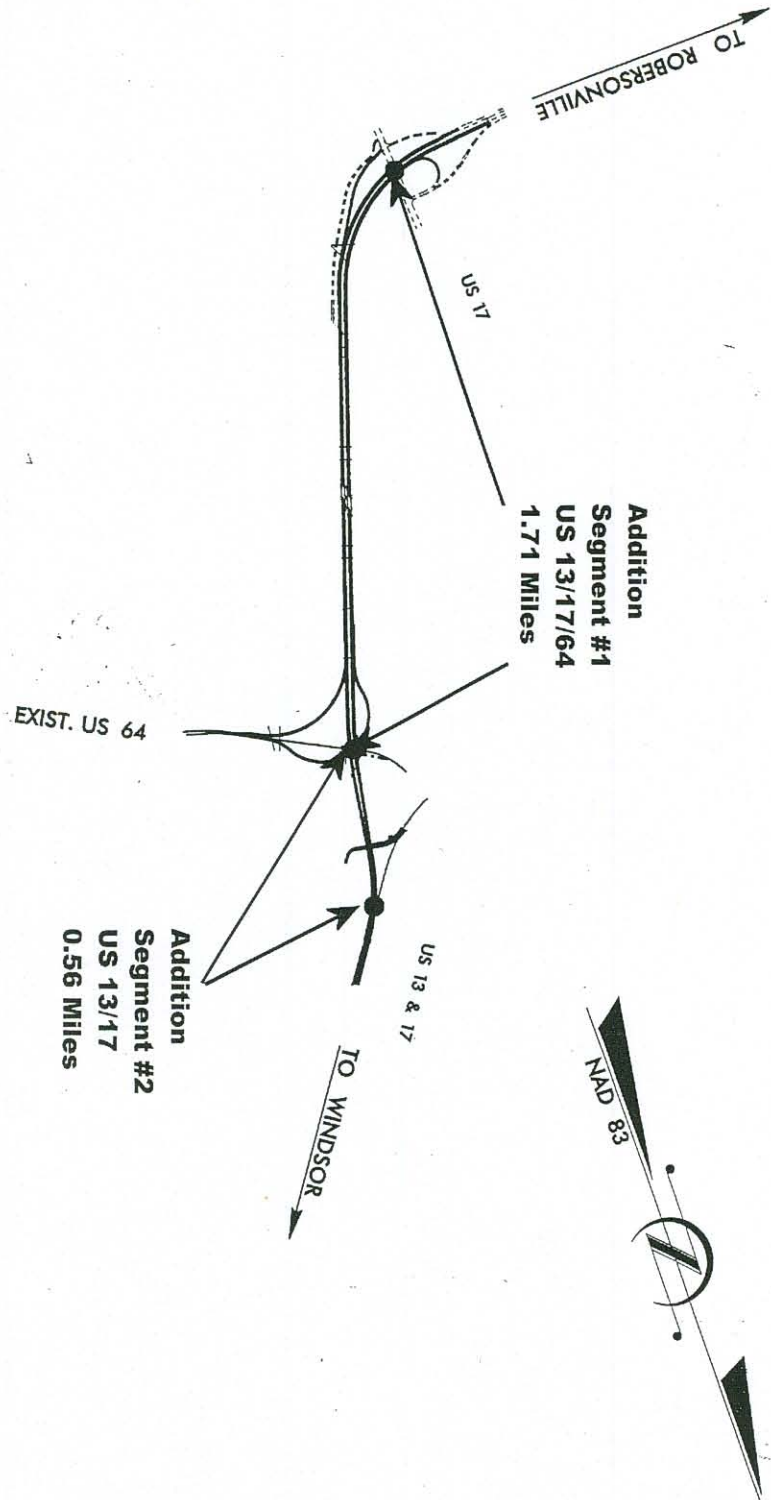

Map A



**Project : 6.099010T**

**Martin Co.**

**R-2112BB**

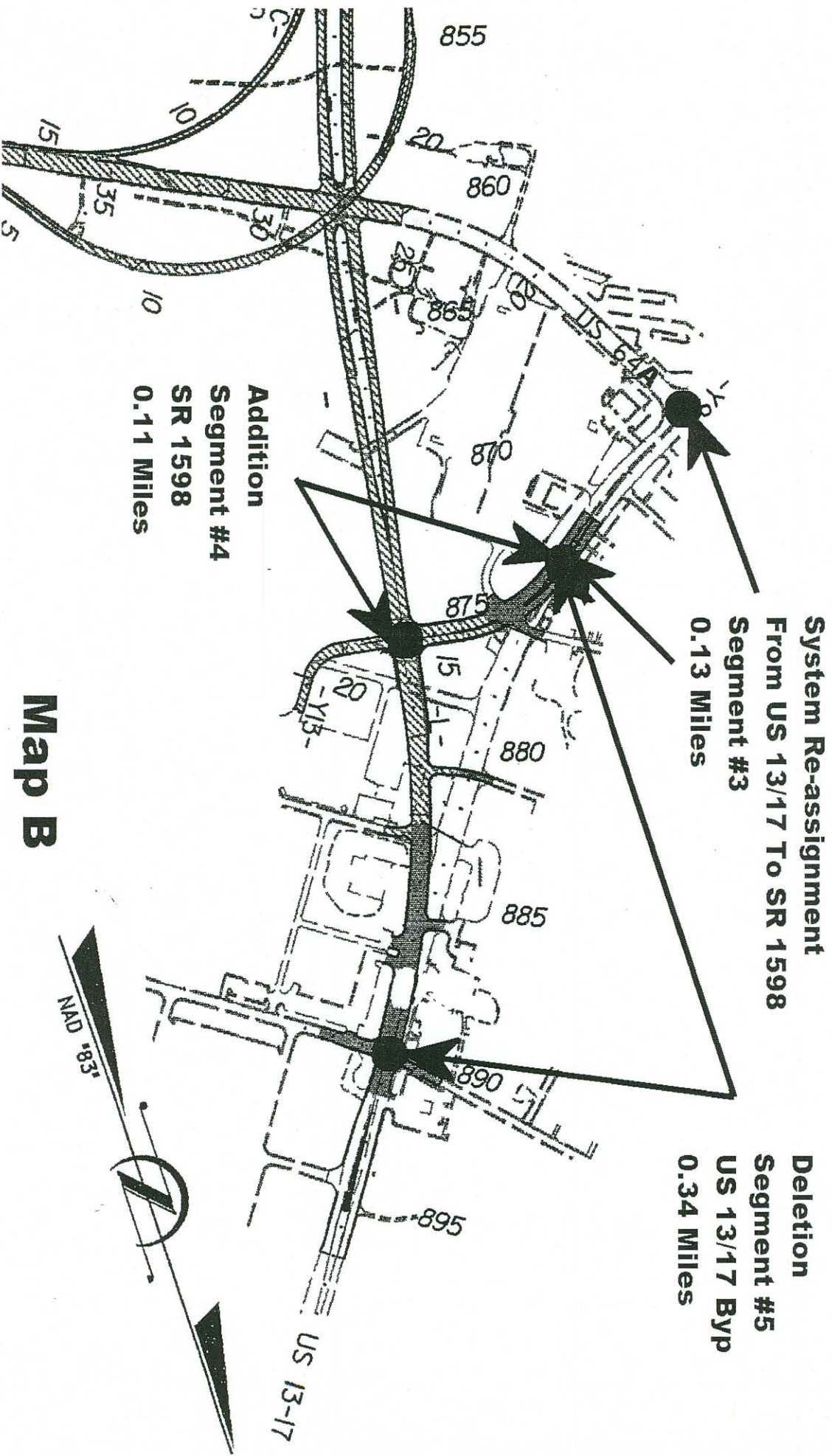

**Map B**

Project: 6.099010T  
TIP # R-2112BB  
Martin Co.

*Number Re-assignment  
From US 13-17-64 To  
US 64 Alt  
Segment #7  
0.48 Miles*

*Number Re-assignment  
From US 64 To US 64  
Alt  
Segment #8  
0.25 Miles*

*Number Re-assignment  
From US 17 To US 17  
Bys  
Segment #6  
1.61 Miles*

Map C

