



STATE OF NORTH CAROLINA  
DEPARTMENT OF TRANSPORTATION

MICHAEL F. EASLEY  
GOVERNOR

December 12, 2003

LYNDO TIPPETT  
SECRETARY

**MEMORANDUM TO:** Mr. Michael L. Holder, PE  
Division Engineer  
Division 12

**FROM:** Forrest L. Robson, PE  
GIS Director

**SUBJECT:** Road System Changes

The Road Inventory Section has been authorized to make the following changes to the state road system as indicated below. We request that you make similar changes to the related maps and files in your Division and District offices, and install appropriate road number signs if necessary. We have updated our records and county maps accordingly. If our system changes do not conform to the actual conditions in the field, please return this memorandum with recommendations.

Project/ Petition Number	County	Approval Date
46502	GASTON	6/5/03

Inquires about secondary road petition changes should be referred to Ron Tucker, Secondary Roads Group Supervisor at (919) 212-6080. Inquires about TIP Project changes should be referred to Tom Schroeder, Primary Highway Group Supervisor at (919) 212-6074. If you have further questions, please contact Hardee Cox, Road Inventory Manager at (919) 212-6060. Thank you for your assistance.

FLR/hrc  
enclosures ( )

- cc: BSIP  
 Bridge Maintenance  
 Pavement Management  
 Permit Unit  
 Right of Way  
 Safety Management  
 State Road Maintenance  
 Traffic Engineering  
 Traffic Surveys

**MAILING ADDRESS:**  
 NC DEPARTMENT OF TRANSPORTATION  
 GEOGRAPHIC INFORMATION SYSTEMS  
 1587 MAIL SERVICE CENTER  
 RALEIGH NC 27699-1587



[www.ncdot.org/statewide/planning/gis](http://www.ncdot.org/statewide/planning/gis)

**DELIVERY ADDRESS:**  
 3401 CARL SANDBURG CT  
 RALEIGH, NC 27610  
 PHONE (919) 212-6000  
 FAX (919) 212-5999

# Road System Changes

PROJECT/ PETITION #	COUNTY	APPROVAL DATE	NEW NUMBER	EXISTING NUMBER	STREET NAME	LENGTH	TYPE OF CHANGE	REMARKS (See Attached)
46502	GASTON	6/5/03		SR 1251 EXT.	US 29/74 SERVICE ROAD	0.07	SYSTEM ADDITION VIA PETITION	MAP A

PETITION #: 46502

CO: Gaston

SR #: 3131

MAP A

DATE 12/18/03

ADDITION \_\_\_\_\_

DELETION \_\_\_\_\_

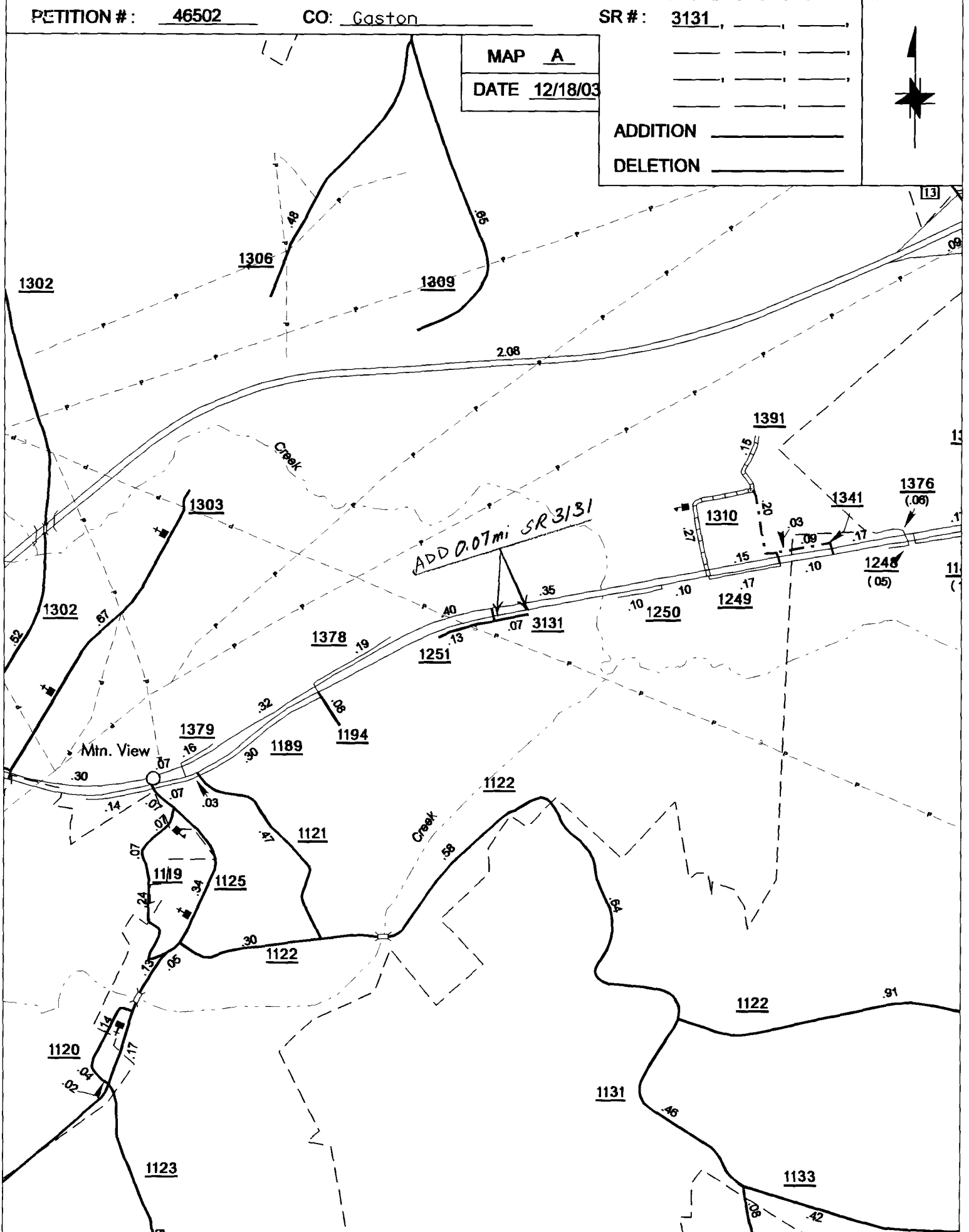

SOURCE: Plat

SHEET: 2 OF 5

NAME: SRC

SCALE: 1:4