



STATE OF NORTH CAROLINA
DEPARTMENT OF TRANSPORTATION

MICHAEL F. EASLEY
GOVERNOR

Tuesday, May 18, 2004

LYNDO TIPPETT
SECRETARY

MEMORANDUM TO: Mr. Mike Mills, PE
Division Engineer
Division 7

FROM: Forrest L. Robson, PE
GIS Director

SUBJECT: Road System Changes

The Road Inventory Section has been authorized to make the following changes to the state road system as indicated below. We request that you make similar changes to the related maps, and files in your Division and District offices, and install appropriate road number signs if necessary. We have updated our records and county maps accordingly. If our system changes do not conform to the actual conditions in the field, please return this memorandum with recommendations.

40-0708-06-03

Municipality	County	Approval Date
GREENSBORO	GUILFORD	6/18/03

Inquires about secondary road petition changes should be referred to Ron Tucker, Secondary Roads Group Supervisor at (919) 212-6080. Inquires about TIP Project changes should be referred to Tom Schroeder, Primary Highway Group Supervisor at (919) 212-6074. If you have further questions, please contact Hardee Cox, Road Inventory Manager at (919) 212-6060. Thank you for your assistance.

FLR/hrc
enclosures ()

- cc: BSIP
- Bridge Maintenance
- Pavement Management
- Permit Unit
- Right of Way
- Safety Management
- State Road Maintenance
- Traffic Engineering
- Traffic Surveys

MAILING ADDRESS:
NC DEPARTMENT OF TRANSPORTATION
GEOGRAPHIC INFORMATION SYSTEMS
1587 MAIL SERVICE CENTER
RALEIGH NC 27699-1587



www.ncdot.org/statewide/planning/gis

DELIVERY ADDRESS:
3401 CARL SANDBURG CT.
RALEIGH, NC 27610
PHONE: (919) 212-6000
FAX: (919) 212-5999

Road System Changes

MUNICIPALITY	COUNTY	APPROVAL DATE	NEW NUMBER	EXISTING NUMBER	STREET NAME	LENGTH (miles)	TYPE OF CHANGE	REMARKS (See Attached Map)
GREENSBORO	GUILFORD	6/18/03		SR 4126	BRIDFORD PARKWAY	0.17	SYSTEM DELETION VIA MUNICIPAL AGREEMENT	MAP A, SEGMENT 14
GREENSBORO	GUILFORD	6/18/03		SR 3300	ELM STREET	0.86	SYSTEM DELETION VIA MUNICIPAL AGREEMENT	MAP A, SEGMENT 13
GREENSBORO	GUILFORD	6/18/03		SR 3300	ELM STREET	0.04	SYSTEM DELETION VIA MUNICIPAL AGREEMENT	MAP A, SEGMENT 12
GREENSBORO	GUILFORD	6/18/03		SR 3300	ELM STREET	0.20	SYSTEM DELETION VIA MUNICIPAL AGREEMENT	MAP A, SEGMENT 11
GREENSBORO	GUILFORD	6/18/03		SR 3300	ELM STREET	0.37	SYSTEM DELETION VIA MUNICIPAL AGREEMENT	MAP A, SEGMENT 10
GREENSBORO	GUILFORD	6/18/03		SR 3300	ELM STREET	0.24	SYSTEM DELETION VIA MUNICIPAL AGREEMENT	MAP A, SEGMENT 9
GREENSBORO	GUILFORD	6/18/03		SR 3300	ELM STREET	0.20	SYSTEM DELETION VIA MUNICIPAL AGREEMENT	MAP A, SEGMENT 8
GREENSBORO	GUILFORD	6/18/03		SR 3300	ELM STREET	0.43	MUNICIPAL AGREEMENT	MAP A, SEGMENT 7
GREENSBORO	GUILFORD	6/18/03		SR 2835	MCKNIGHT MILL ROAD	0.18	MUNICIPAL AGREEMENT	MAP A, SEGMENT 6
GREENSBORO	GUILFORD	6/18/03		SR 2835	MCKNIGHT MILL ROAD	0.22	SYSTEM DELETION VIA MUNICIPAL AGREEMENT	MAP A, SEGMENT 5
GREENSBORO	GUILFORD	6/18/03		SR 2176	BENJAMIN PARKWAY	0.55	MUNICIPAL AGREEMENT	MAP A, SEGMENT 4
GREENSBORO	GUILFORD	6/18/03		SR 2176	BENJAMIN PARKWAY	0.34	SYSTEM DELETION VIA MUNICIPAL AGREEMENT	MAP A, SEGMENT 3

MUNICIPALITY	COUNTY	APPROVAL DATE	NEW NUMBER	EXISTING NUMBER	STREET NAME	LENGTH (miles)	TYPE OF CHANGE	REMARKS (See Attached Map)
GREENSBORO	GUILFORD	6/18/03		SR 2176	BENJAMIN PARKWAY	0.10	SYSTEM DELETION VIA MUNICIPAL AGREEMENT	MAP A, SEGMENT 2
GREENSBORO	GUILFORD	6/18/03		SR 2176	BENJAMIN PARKWAY	0.50	SYSTEM DELETION VIA MUNICIPAL AGREEMENT	MAP A, SEGMENT 1

PETITION #: Mun Agr

CO: Gulford

SR #: 2176

MAP A

DATE 5/17/04

ADDITION _____

DELETION X



SR 2176 Abd. 1.49 miles

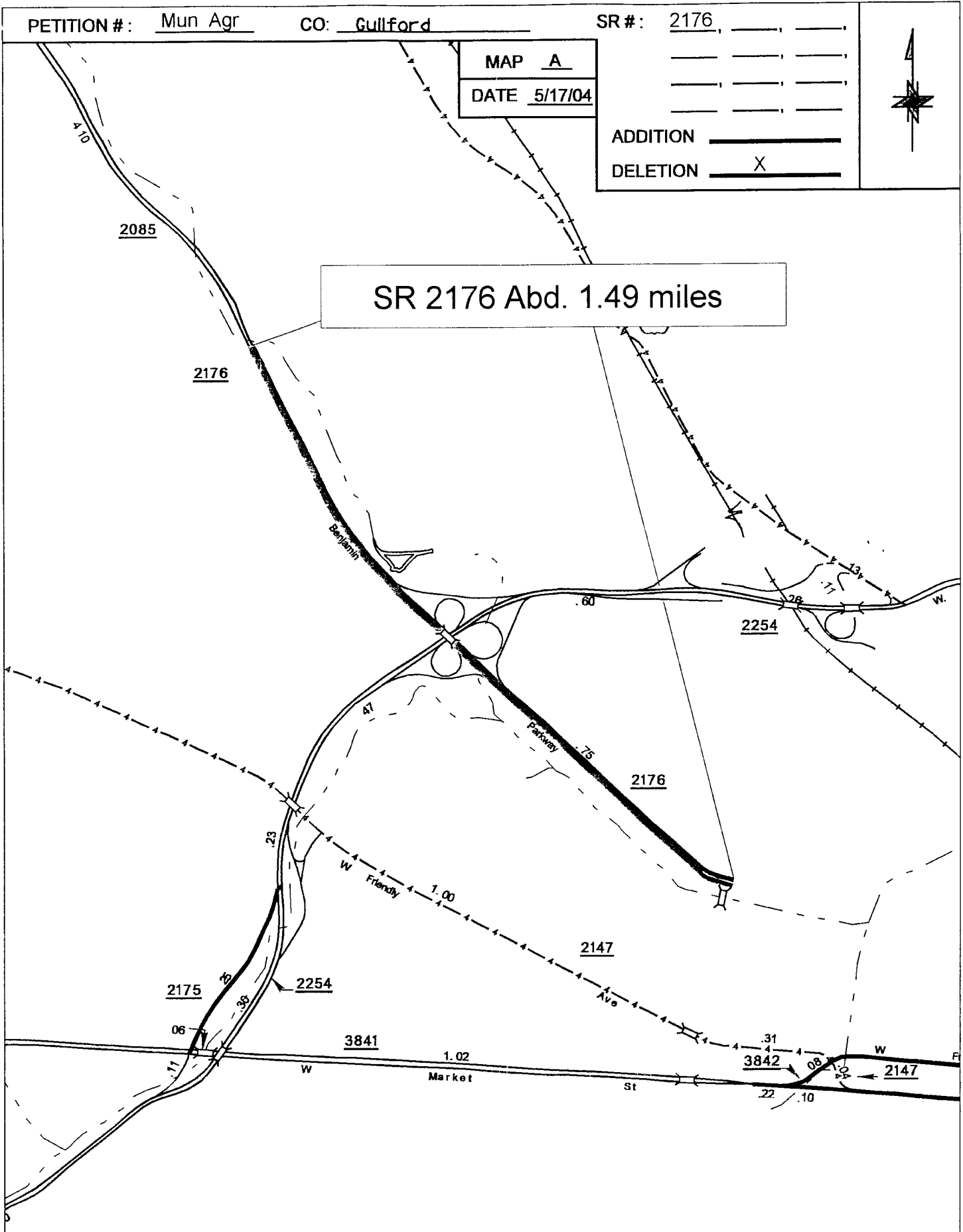

SOURCE: SID

SHEET: 6 OF 10

NAME: RLN

SCALE: 4 to 1

PETITION #: Mun. Agr.

CO: Gulford

SR #: 2835

MAP A

DATE 5/17/04

ADDITION _____

DELETION X



SR 2835 abd. .40 miles

2526

Summit

3.47

Alv

2611

2610

2611

2612

2835

2876

.42

.40

.37

.40

.36

.36

.40

.08

.98

2937

.37

.20

.30

2837

2838

.25

.05

.15

.05

.05

.15

.15

.45

.15

.40

.15

.15

.15

.15

.15

.15

.15

.15

.15

.15

.15

.15

.15

2866

2868

.37

.05

.10

.11

.25

.05

.05

.09

.09

.18

.15

.15

.15

.15

.15

.15

.15

.15

.15

.15

.15

.15

.15

.15

.15

.15

.15

.15

.15

.15

.15

.15

.15

2867

.10

.10

.21

.12

.10

.10

.10

.10

.10

.10

.10

.10

.10

.10

.10

.10

.10

.10

.10

.10

.10

.10

.10

.10

.10

.10

.10

.10

.10

.10

.10

.10

.10

.10

2869

.10

.10

.10

.10

.10

.10

.10

.10

.10

.10

.10

.10

.10

.10

.10

.10

.10

.10

.10

.10

.10

.10

.10

.10

.10

.10

.10

.10

.10

.10

.10

.10

.10

.10

SOURCE: SID

SHEET: 6 OF 10

NAME: RLN

SCALE: 4 to 1

PETITION #: Mun. Agr.

CO: Gulford

SR #: 3300

MAP A

DATE 5/17/04

ADDITION _____

DELETION X

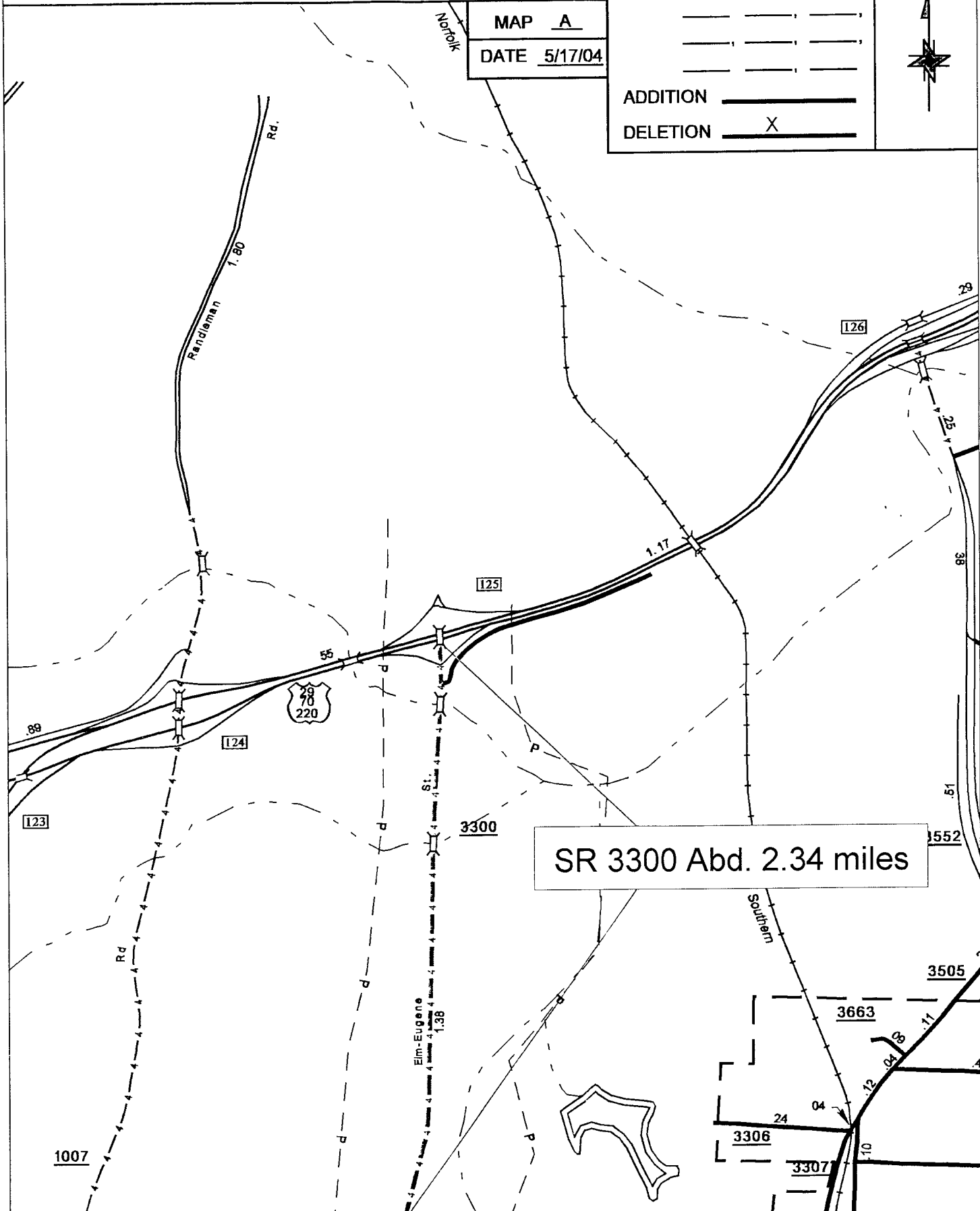

SR 3300 Abd. 2.34 miles

SOURCE: SID

SHEET: 6 OF 10

NAME: RLN

SCALE: 4 to 1

PETITION #: Mun. Agr CO. Gulford

SR #: 4126

MAP A
DATE 5/17/04

ADDITION _____

DELETION X _____



SR 4126 Abd. .17 miles

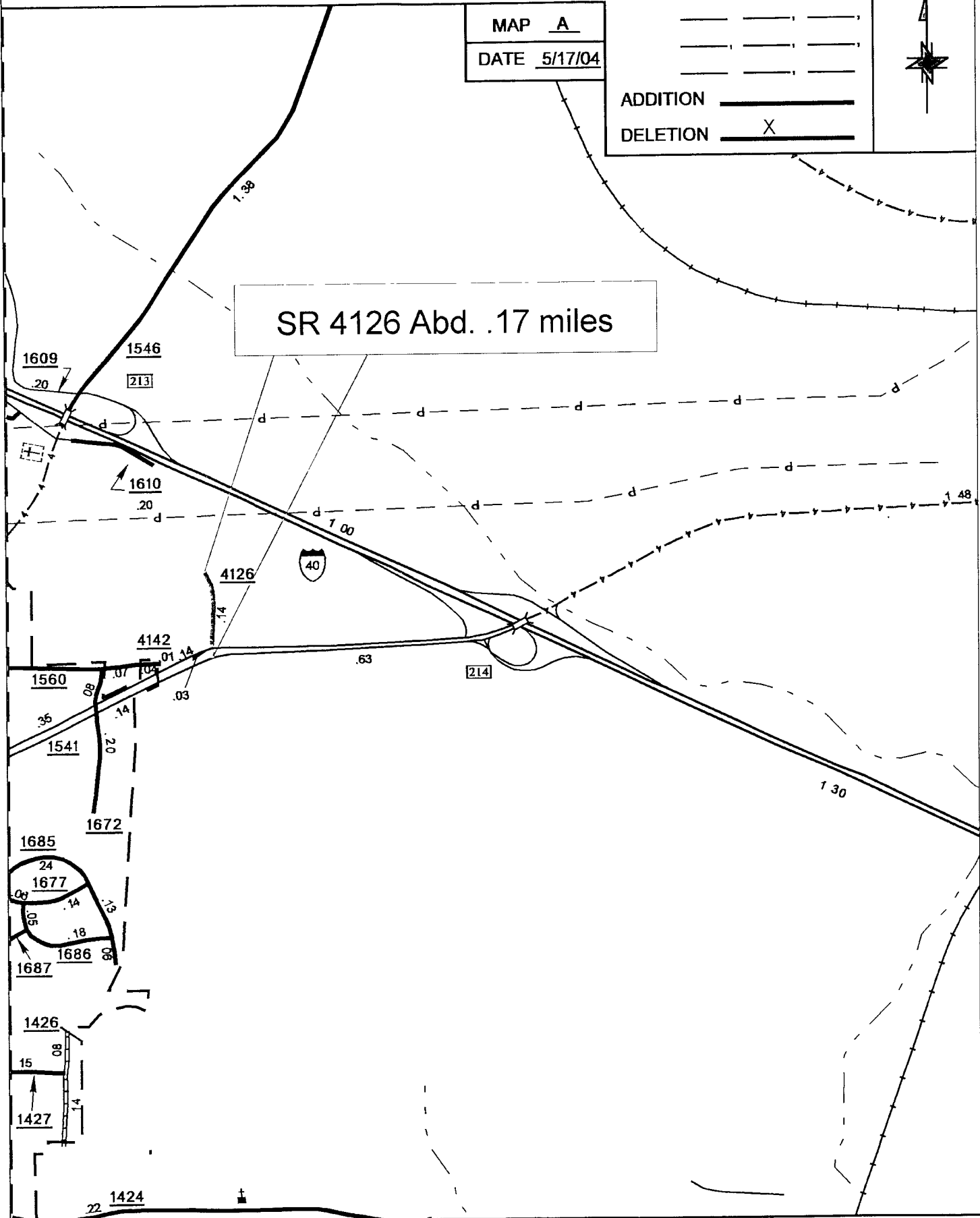

SOURCE: SID SHEET: 6 OF 10 NAME: RLN SCALE: 4 to 1