



STATE OF NORTH CAROLINA
DEPARTMENT OF TRANSPORTATION

MICHAEL F. EASLEY
GOVERNOR

November 05, 2003

LYNDO TIPPETT
SECRETARY

MEMORANDUM TO: Mr. Mike Mills, PE
Division Engineer
Division 7

FROM: Forrest L. Robson, PE
GIS Director

SUBJECT: Road System Changes

The Road Inventory Section has been authorized to make the following changes to the state road system as indicated below. We request that you make similar changes to the related maps and files in your Division and District offices, and install appropriate road number signs if necessary. We have updated our records and county maps accordingly. If our system changes do not conform to the actual conditions in the field, please return this memorandum with recommendations.

40_0708_06_03

| Project/ Petition Number | County | Approval Date |
|--------------------------|----------|---------------|
| 06120340 | GUILFORD | 6/12/03 |

Inquires about secondary road petition changes should be referred to Ron Tucker, Secondary Roads Group Supervisor at (919) 212-6080. Inquires about TIP Project changes should be referred to Tom Schroeder, Primary Highway Group Supervisor at (919) 212-6074. If you have further questions, please contact Hardee Cox, Road Inventory Manager at (919) 212-6060. Thank you for your assistance.

FLR/hrc
enclosures ()

- cc: BSIP
Bridge Maintenance
Pavement Management
Permit Unit
Right of Way
Safety Management
State Road Maintenance
Traffic Engineering
Traffic Surveys

MAILING ADDRESS:
NC DEPARTMENT OF TRANSPORTATION
GEOGRAPHIC INFORMATION SYSTEMS
1587 MAIL SERVICE CENTER
RALEIGH NC 27699-1587



www.ncdot.org/statewide/planning/gis

DELIVERY ADDRESS:
3401 CARL SANDBURG CT.
RALEIGH, NC 27610
PHONE: (919) 212-6000
FAX: (919) 212-5999

Road System Changes

| MUNICIPALITY | COUNTY | APPROVAL DATE | NEW NUMBER | EXISTING NUMBER | STREET NAME | LENGTH | TYPE OF CHANGE | REMARKS (See Attached Map) |
|--------------|----------|---------------|------------|-----------------|-----------------|--------|---|-------------------------------|
| 06120340 | GUILFORD | 6/12/03 | SR 4771 | SR 2790 | REEDY FORK PKWY | 0.28 | NUMBER REASSIGNMENT VIA MUNICIPAL AGREEMENT | MAP A, SEGMENT |
| 06120340 | GUILFORD | 6/12/03 | SR 4771 | | REEDY FORK PKWY | 0.14 | SYSTEM ADDITION VIA MUNICIPAL AGREEMENT | MAP A, SEGMENT |
| 06120340 | GUILFORD | 6/12/03 | | SR 2790 | ECKERSON ROAD | 0.28 | SYSTEM DELETION VIA MUNICIPAL AGREEMENT | MAP A, SEGMENT |
| 06120340 | GUILFORD | 6/12/03 | | SR 2790 | ECKERSON ROAD | 0.21 | SYSTEM ADDITION VIA MUNICIPAL AGREEMENT | MAP A, SEGMENT |

PETITION #:

CO: Gulford

SR #: 2790, 4771

MAP A

DATE 2/9/04

ADDITION X

DELETION _____



Greensboro

Add .14 miles Sr 4771 NL

Add .21 miles Sr 2790 NL

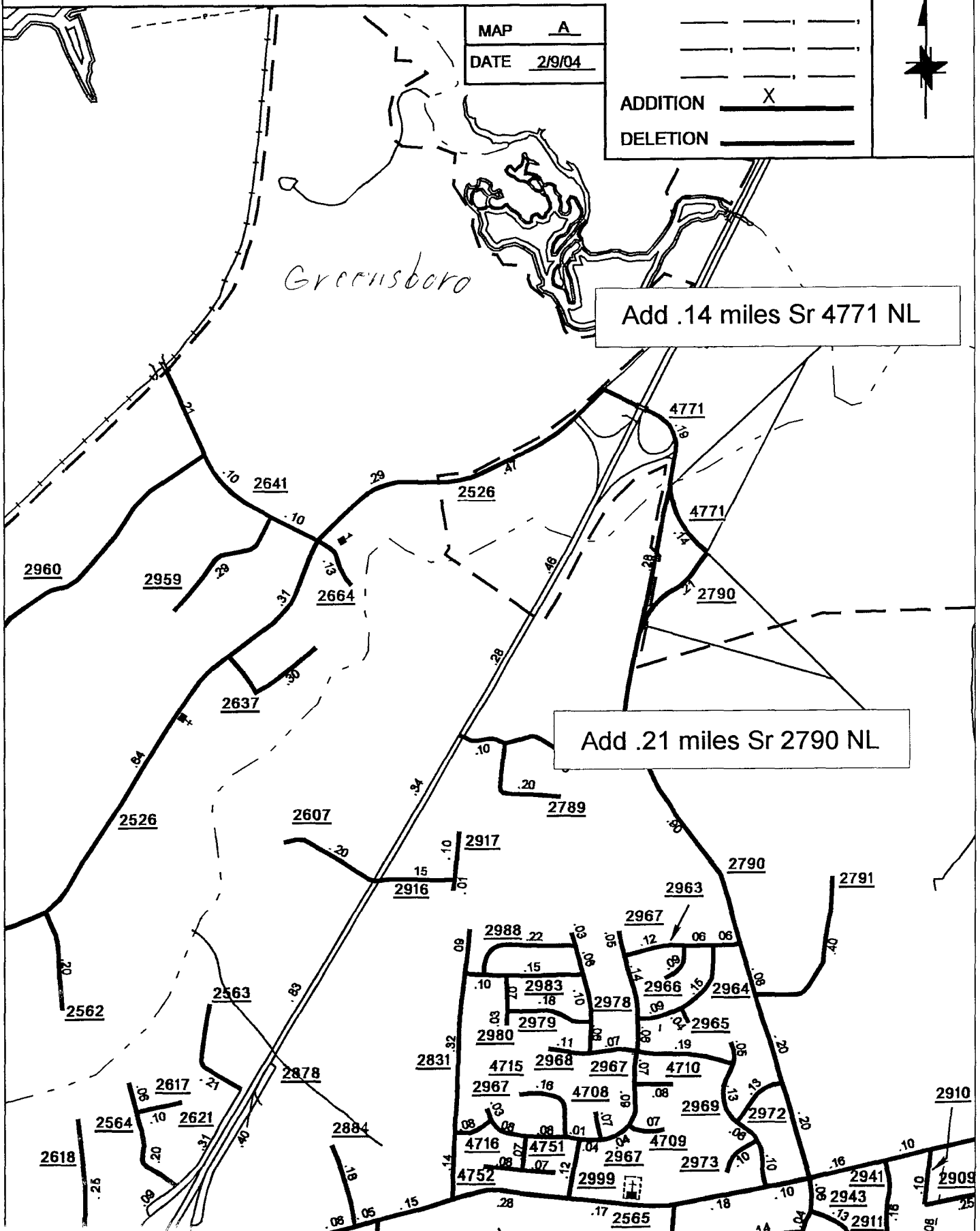

SOURCE: DOQQ

SHEET: 3 OF 10

NAME: RLN

SCALE: 4 to 1

PETITION #:

CO: Gulford

SR #: 2790

MAP A
DATE 2/9/04

ADDITION _____
DELETION X



Abd. .28 miles Sr 2790

2960

2959

2637

2664

2637

2526

2607

2788

2789

2917

2916

2790

2791

2563

2831

4715

2968

2967

4710

2617

2878

2884

4716

4751

2967

4709

2969

2972

2910

2618

2564

2621

2884

2884

2884

2884

2884

2884

2884

2884

2884

2884

2884

2884

2884

2884

2884

SOURCE: DOQQ

SHEET: 3 OF 10

NAME: RLN

SCALE: 4 to 1