



STATE OF NORTH CAROLINA  
DEPARTMENT OF TRANSPORTATION

MICHAEL F. EASLEY  
GOVERNOR

January 08, 2004

LYNDO TIPPETT  
SECRETARY

**MEMORANDUM TO:** Mr. Mike Mills, PE  
Division Engineer  
Division 7

**FROM:** Forrest L. Robson, PE  
GIS Director

**SUBJECT:** Road System Changes

The Road Inventory Section has been authorized to make the following changes to the state road system as indicated below. We request that you make similar changes to the related maps and files in your Division and District offices, and install appropriate road number signs if necessary. We have updated our records and county maps accordingly. If our system changes do not conform to the actual conditions in the field, please return this memorandum with recommendations.

*I-ZACZAC*

Project/ Petition Number	County	Approval Date
8.2496503	GUILFORD	4/14/03

Inquires about secondary road petition changes should be referred to Ron Tucker, Secondary Roads Group Supervisor at (919) 212-6080. Inquires about TIP Project changes should be referred to Tom Schroeder, Primary Highway Group Supervisor at (919) 212-6074. If you have further questions, please contact Hardee Cox, Road Inventory Manager at (919) 212-6060. Thank you for your assistance.

FLR/hrc  
enclosures ( )

- cc: BSIP
- Bridge Maintenance
  - Pavement Management
  - Permit Unit
  - Right of Way
  - Safety Management
  - State Road Maintenance
  - Traffic Engineering
  - Traffic Surveys

MAILING ADDRESS:  
NC DEPARTMENT OF TRANSPORTATION  
GEOGRAPHIC INFORMATION SYSTEMS  
1587 MAIL SERVICE CENTER  
RALEIGH NC 27699-1587



[www.ncdot.org/statewide/planning/gis](http://www.ncdot.org/statewide/planning/gis)

DELIVERY ADDRESS:  
3401 CARL SANDBURG CT  
RALEIGH, NC 27610  
PHONE: (919) 212-6000  
FAX: (919) 212-5999

# Road System Changes

PROJECT/ PETITION #	COUNTY	APPROVAL DATE	NEW NUMBER	EXISTING NUMBER	STREET NAME	LENGTH	TYPE OF CHANGE	REMARKS (See Attached)
8.2496503	GUILFORD	4/14/03	SR 1104	SR 1112		5.36	NUMBER REASSIGNMENT VIA PROJECT	MAP A
8.2496503	GUILFORD	4/14/03		SR 1104		0.09	SYSTEM DELETION VIA PROJECT	MAP B
8.2496503	GUILFORD	4/14/03	SR 1104			0.02	SYSTEM ADDITION VIA PROJECT	MAP C

# Map A

5.36 mi. Number change  
from SR 1104 to SR 1112

SR 1104

US 220

*Cobles?*

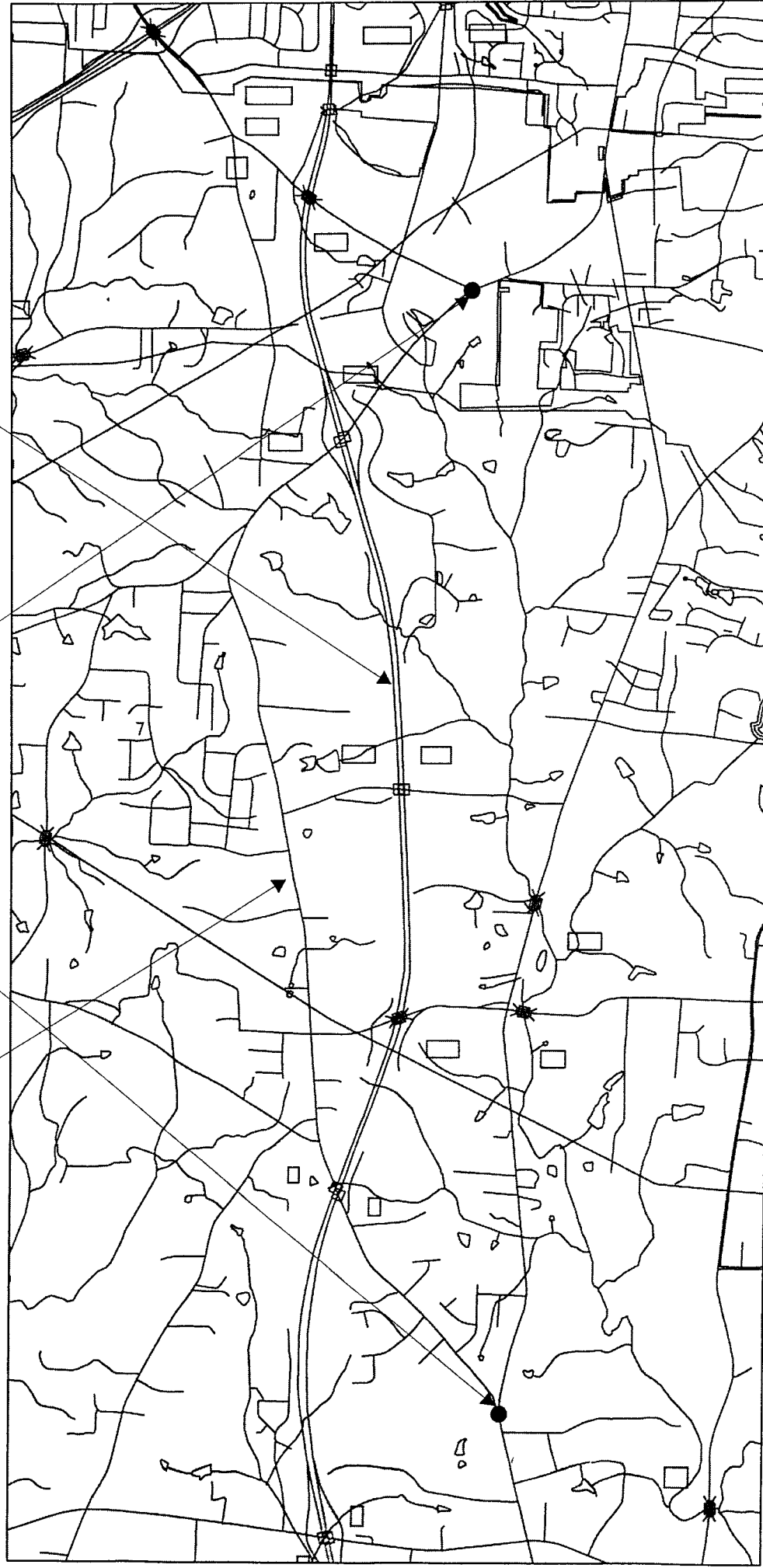
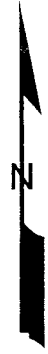

# Map B

0.09 mi. abandoned SR 1104

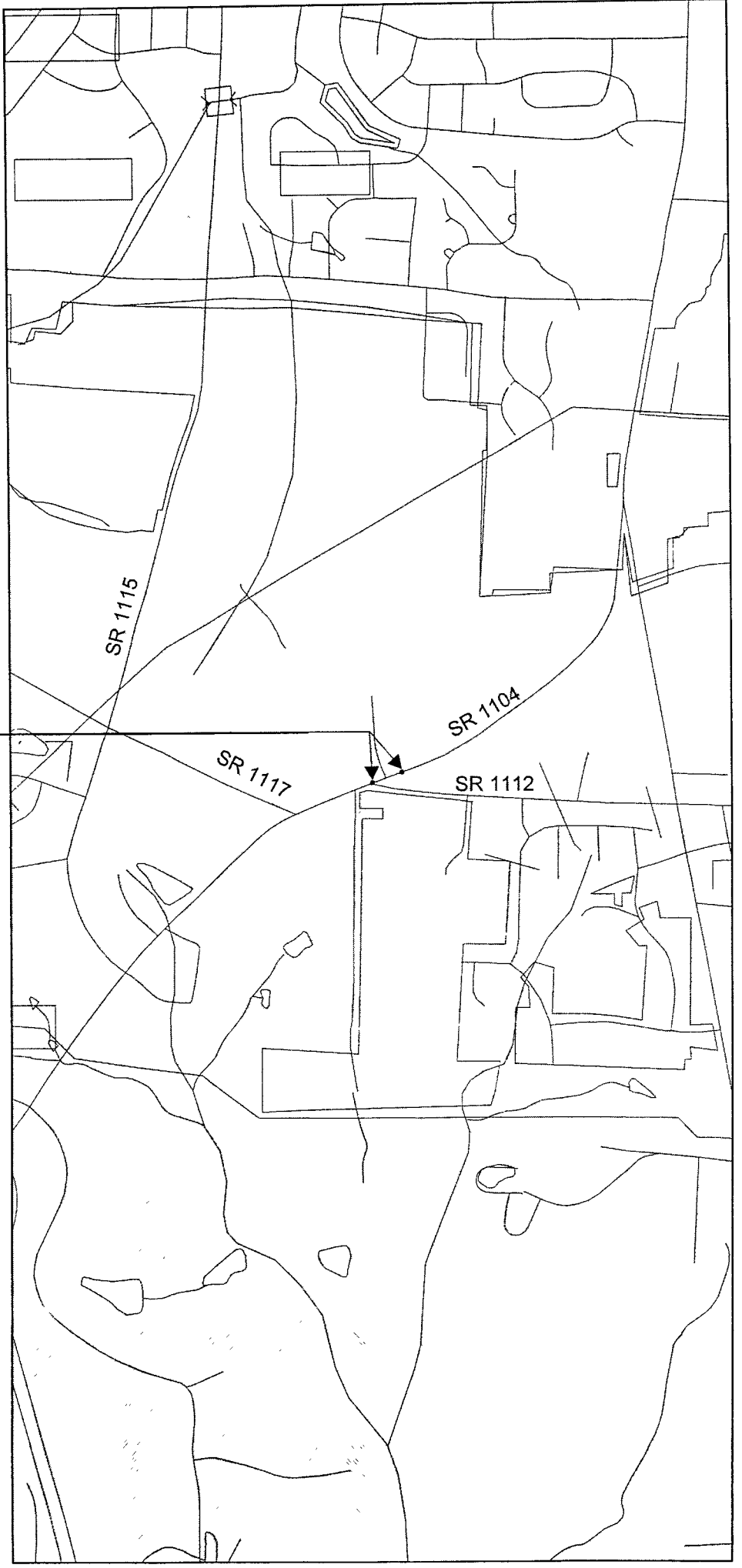

# Map C

0.02 mi. SR 1104 built by NL

