



STATE OF NORTH CAROLINA
DEPARTMENT OF TRANSPORTATION

MICHAEL F EASLEY
GOVERNOR

August 27, 2003

LYNDO TIPPETT
SECRETARY

MEMORANDUM TO: Mr. Terry R. Gibson, PE
Division Engineer
Division 6

FROM: Forrest L. Robson, PE
GIS Director

SUBJECT: Road System Changes

The Road Inventory Section has been authorized to make the following changes to the state road system as indicated below. We request that you make similar changes to the related maps and files in your Division and District offices, and install appropriate road number signs if necessary. We have updated our records and county maps accordingly. If our system changes do not conform to the actual conditions in the field, please return this memorandum with recommendations.

Project/ Petition Number	County:	Approval Date:
46295	HARNETT	2/6/03

Inquires about secondary road petition changes should be referred to Ron Tucker, Secondary Roads Group Supervisor at (919) 212-6080. Inquires about TIP Project changes should be referred to Tom Schroeder, Primary Highway Group Supervisor at (919) 212-6074. If you have further questions, please contact Hardee Cox, Road Inventory Manager at (919) 212-6060. Thank you for your assistance

HRC/flr

- cc BSIP
- Bridge Maintenance
- Pavement Management
- Permit Unit
- Right of Way
- Safety Management
- State Road Maintenance
- Traffic Engineering
- Traffic Surveys

Road System Changes

PROJECT/ PETITION #	COUNTY	APPROVAL DATE	NEW NUMBER	EXISTING NUMBER	STREET NAME	LENGTH	TYPE OF CHANGE	REMARKS (See Attached)
46295	HARNETT	2/6/03	SR 2189		SONYA COURT	0.20	SYSTEM ADDITION VIA PETITION	MAP A
46295	HARNETT	2/6/03	SR 2188		ANDREA COURT	0.06	SYSTEM ADDITION VIA PETITION	MAP A
46295	HARNETT	2/6/03	SR 2187		BRYTE TERRACE	0.06	SYSTEM ADDITION VIA PETITION	MAP A
46295	HARNETT	2/6/03	SR 2186		SEAN LANE	0.33	SYSTEM ADDITION VIA PETITION	MAP A
46295	HARNETT	2/6/03	SR 2185		NICOLE DRIVE	0.96	SYSTEM ADDITION VIA PETITION	MAP A
46295	HARNETT	2/6/03	SR 2195		KATE LANE	0.14	SYSTEM ADDITION VIA PETITION	MAP A
46295	HARNETT	2/6/03	SR 2194		JESSICA COURT	0.06	SYSTEM ADDITION VIA PETITION	MAP A
46295	HARNETT	2/6/03	SR 2193		CHERRY BERRY ROAD	0.29	SYSTEM ADDITION VIA PETITION	MAP A
46295	HARNETT	2/6/03	SR 2192		KATHLEEN TERRACE	0.21	SYSTEM ADDITION VIA PETITION	MAP A
46295	HARNETT	2/6/03	SR 2191		CHRISTOPHER DRIVE	0.22	SYSTEM ADDITION VIA PETITION	MAP A
46295	HARNETT	2/6/03	SR 2190		MARZY COURT	0.06	SYSTEM ADDITION VIA PETITION	MAP A

PETITION #: 46295

CO: Harnett

SR #: 2185, 2186, 2187,
2188, 2189, 2190,
2191, 2192, 2193,
2194, 2195, _____

ADDITION

DELETION _____

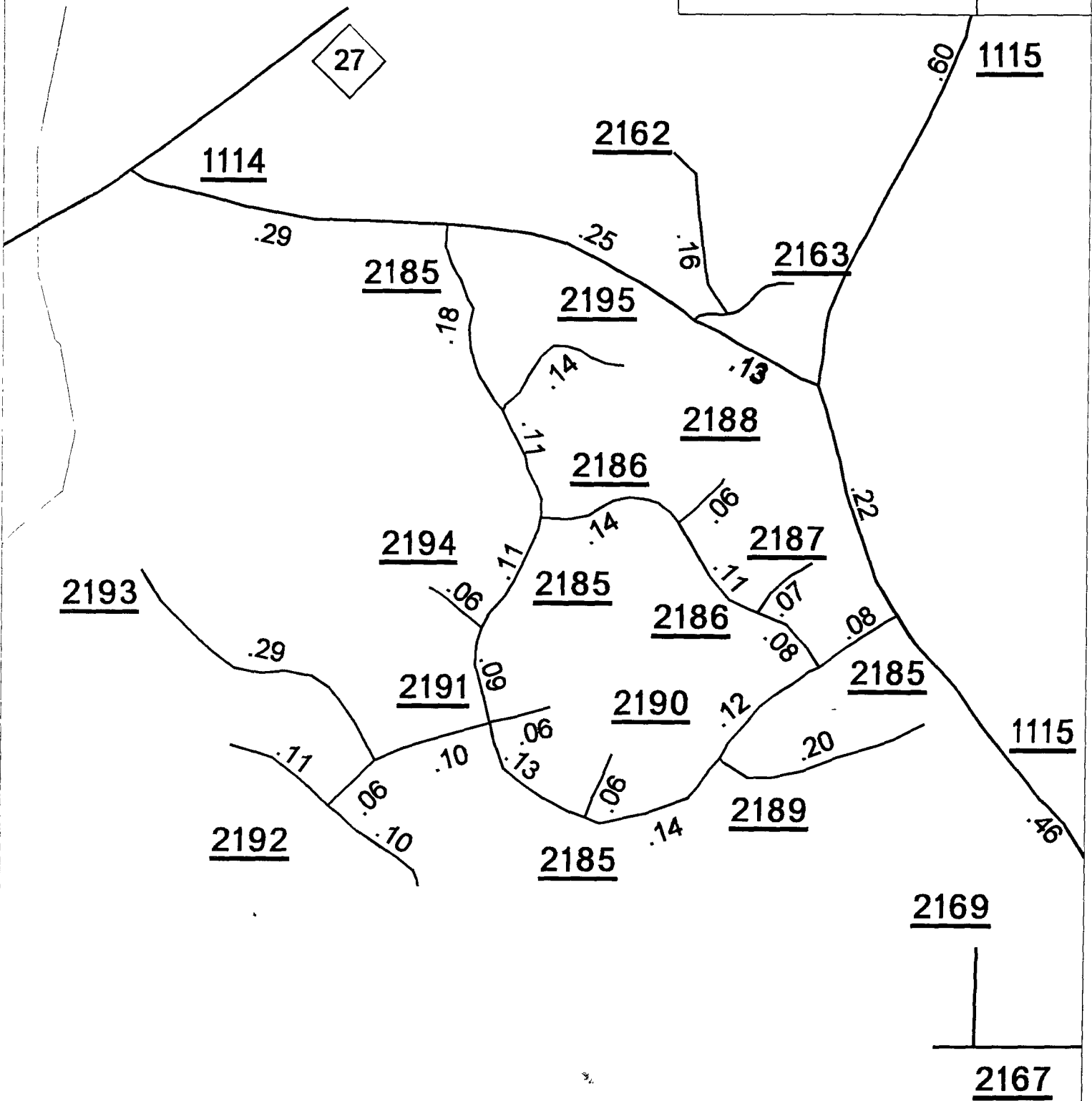

SOURCE: Plat

SHEET: 1 OF 2

NAME: BCS

SCALE: NTS