



STATE OF NORTH CAROLINA
DEPARTMENT OF TRANSPORTATION

MICHAEL F. EASLEY
GOVERNOR

August 21, 2003

LYNDO TIPPETT
SECRETARY

MEMORANDUM TO: Mr. Jon G. Nance, PE
Division Engineer
Division 5

FROM: Forrest L. Robson, PE
GIS Director

SUBJECT: Road System Changes

The Road Inventory Section has been authorized to make the following changes to the state road system as indicated below. We request that you make similar changes to the related maps and files in your Division and District offices, and install appropriate road number signs if necessary. We have updated our records and county maps accordingly. If our system changes do not conform to the actual conditions in the field, please return this memorandum with recommendations

Project/ Petition Number	County:	Approval Date:
46291	WAKE	2/6/03

Inquires about secondary road petition changes should be referred to Ron Tucker, Secondary Roads Group Supervisor at (919) 212-6080. Inquires about TIP Project changes should be referred to Tom Schroeder, Primary Highway Group Supervisor at (919) 212-6074. If you have further questions, please contact Hardee Cox, Road Inventory Manager at (919) 212-6060. Thank you for your assistance.

HRC/flr

cc: BSIP
Bridge Maintenance
Pavement Management
Permit Unit
Right of Way
Safety Management
State Road Maintenance
Traffic Engineering
Traffic Surveys

Road System Changes

PROJECT/ PETITION #	COUNTY	APPROVAL DATE	NEW NUMBER	EXISTING NUMBER	STREET NAME	LENGTH	TYPE OF CHANGE	REMARKS (See Attached)
46291	WAKE	2/6/03	SR 4967		MORAR STREET	0.04	SYSTEM ADDITION VIA PETITION	MAP A
46291	WAKE	2/6/03	SR 4966		DARNLEY STREET	0.12	SYSTEM ADDITION VIA PETITION	MAP A
46291	WAKE	2/6/03	SR 4965		VITEX STREET	0.56	SYSTEM ADDITION VIA PETITION	MAP A
46291	WAKE	2/6/03		SR 3856 EXT	ALONZO STREET	0.16	SYSTEM ADDITION VIA PETITION	MAP A

PETITION #: 46291

CO: WAKE

SR #: 3856 ext., 4965, 4966

MAP A

DATE 8/20/03

4967 _____

ADDITION _____

DELETION _____

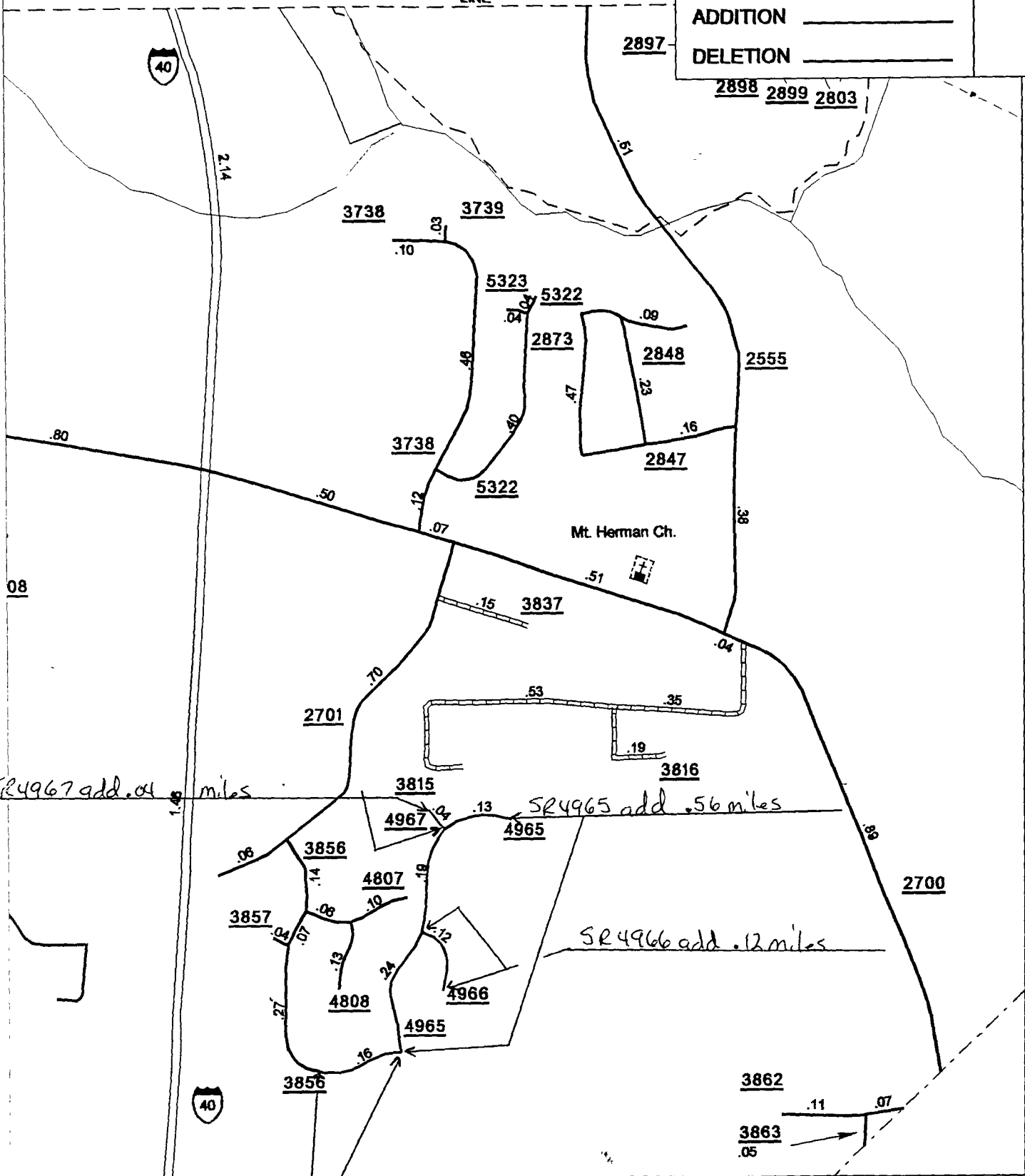

08

SR 4967 add .04 miles

SR 4965 add .56 miles

SR 4966 add .12 miles

Inset 3

SR 3856 ext. add .16 miles