



STATE OF NORTH CAROLINA
DEPARTMENT OF TRANSPORTATION

MICHAEL F. EASLEY
GOVERNOR

September 04, 2003

LYNDO TIPPETT
SECRETARY

MEMORANDUM TO: Mr. Mike Mills, PE
Division Engineer
Division 7

FROM: Forrest L. Robson, PE
GIS Director

SUBJECT: Road System Changes

The Road Inventory Section has been authorized to make the following changes to the state road system as indicated below. We request that you make similar changes to the related maps and files in your Division and District offices, and install appropriate road number signs if necessary. We have updated our records and county maps accordingly. If our system changes do not conform to the actual conditions in the field, please return this memorandum with recommendations.

Project/ Petition Number	County:	Approval Date:
46217	GUILFORD	1/9/03

Inquires about secondary road petition changes should be referred to Ron Tucker, Secondary Roads Group Supervisor at (919) 212-6080. Inquires about TIP Project changes should be referred to Tom Schroeder, Primary Highway Group Supervisor at (919) 212-6074. If you have further questions, please contact Hardee Cox, Road Inventory Manager at (919) 212-6060. Thank you for your assistance.

HRC/flr

cc: BSIP
Bridge Maintenance
Pavement Management
Permit Unit
Right of Way
Safety Management
State Road Maintenance
Traffic Engineering
Traffic Surveys

Road System Changes

PROJECT/ PETITION #	COUNTY	APPROVAL DATE	NEW NUMBER	EXISTING NUMBER	STREET NAME	LENGTH	TYPE OF CHANGE	REMARKS (See Attached)
46217	GUILFORD	1/9/03	SR 4376		WALL MEADOW LANE	0.23	SYSTEM ADDITION VIA PETITION	MAP A
46217	GUILFORD	1/9/03	SR 4375		HOSKINS RIDGE DRIVE	0.37	SYSTEM ADDITION VIA PETITION	MAP A
46217	GUILFORD	1/9/03	SR 4374		HUNTERS CROSSING TR.	0.13	SYSTEM ADDITION VIA PETITION	MAP A

PETITION #: 46217

CO: Gulford

SR #: 4374, 4375, 4376

MAP	<u>A</u>
DATE	<u>8/26/03</u>

ADDITION	<input checked="" type="checkbox"/>
DELETION	<input type="checkbox"/>

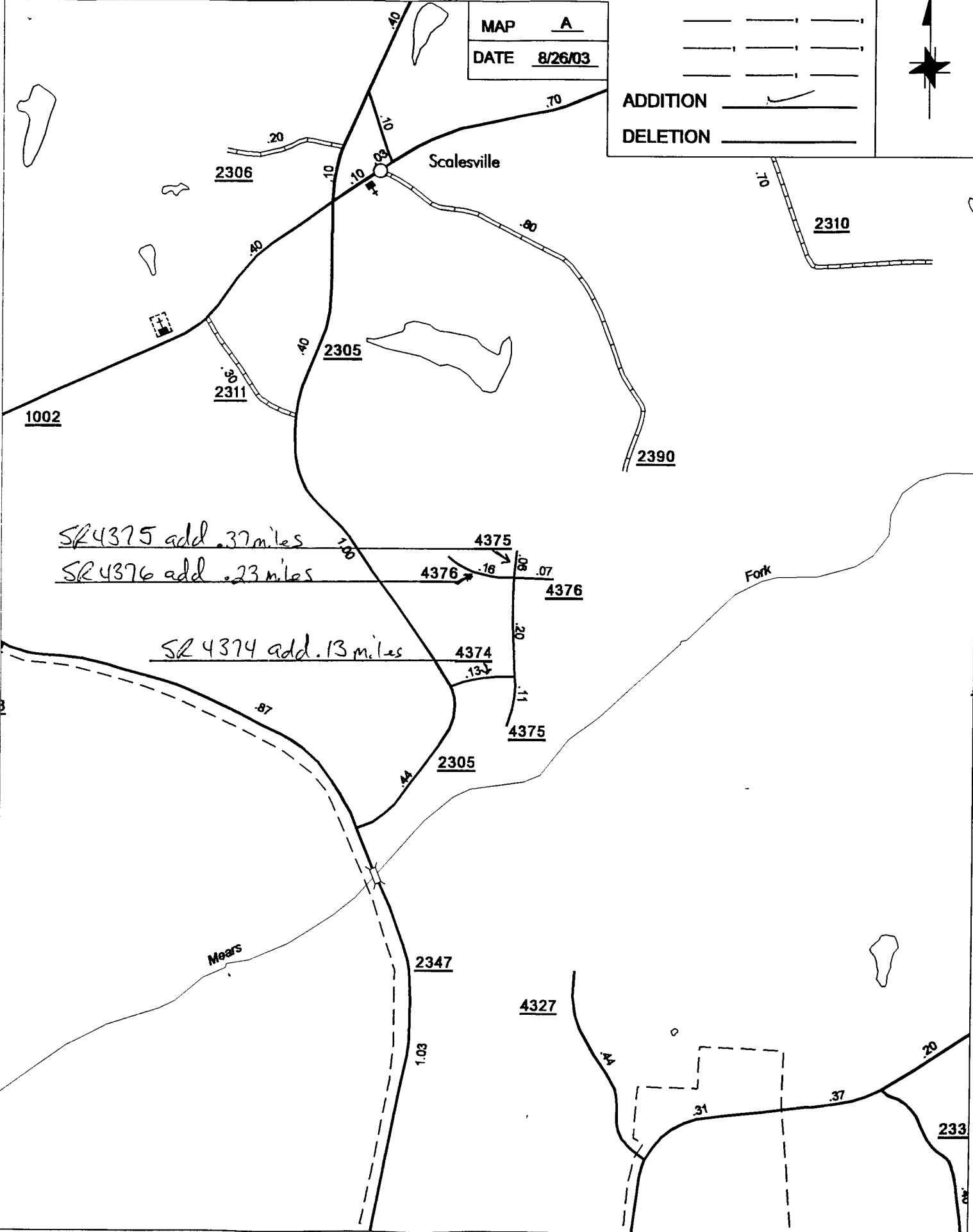

SR 4375 add .37 miles
 SR 4376 add .23 miles

SR 4374 add .13 miles