



STATE OF NORTH CAROLINA
DEPARTMENT OF TRANSPORTATION

BEVERLY EAVES PERDUE
GOVERNOR

Wednesday, May 16, 2012

EUGENE A. CONTI, JR.
SECRETARY

MEMORANDUM TO: Mr. J. Wally Bowman, PE
Division Engineer
Division 5

FROM: John C. Farley, Manager
Geographic Information Systems Unit

SUBJECT: 2012 District 1 Road Sytem Changes

The Data Conversion Group has been authorized to make the following changes to the state road system as indicated below. We request that you make similar changes to the related maps and files in your Division and District offices, and install appropriate road number signs if necessary. we have updated our records accordingly. If our system changes do not conform to the actual conditions in the field, please return this memorandum with recommendations.

| Request Number | County | Approval Date |
|----------------|--------|---------------|
| FR_91_03-01_1 | WAKE | 3/16/2001 |

Inquiries about changes should be referred to the GIS Help Desk at (919) 707-2152.
Thank you for your assistance.

JCF

cc: BSIP
Bridge Maintenance
Division Right of Way
IMG
Pavement Management
Permit Unit
State Road Maintenance
Traffic Engineering
Traffic Surveys

MAILING ADDRESS:
NC DEPARTMENT OF TRANSPORTATION
GEOGRAPHIC INFORMATION SYSTEMS
1521 MAIL SERVICE CENTER
RALEIGH NC 27699-1521

gis
NCDOT
WWW.NCDOT.ORG/IT/GIS

Delivery Address:
4101 CAPITAL BLVD.
RALEIGH, NC 27604
PHONE: (919) 707-2152
FAX: (919) 707-2214

2012 ROAD SYSTEM CHANGES

| FIELD REQUEST | COUNTY | APPROVAL DATE | NEW ROUTE | EXISTING ROUTE | STREET NAME | LENGTH (miles) | TYPE OF CHANGE | REMARKS (See Attached Map) |
|----------------------|---------------|----------------------|------------------|-----------------------|--------------------|-----------------------|--|-----------------------------------|
| FR_91_03-01_1 | WAKE | 3/16/2001 | | SR 1667 | | 0.21 | SYSTEM ADDITION - EXISTING VIA FIELD REQUEST | MAP , SEGMENT |
| FR_91_03-01_1 | WAKE | 3/16/2001 | | SR 1667 | | 0.25 | SYSTEM DELETION VIA FIELD REQUEST | MAP , SEGMENT |

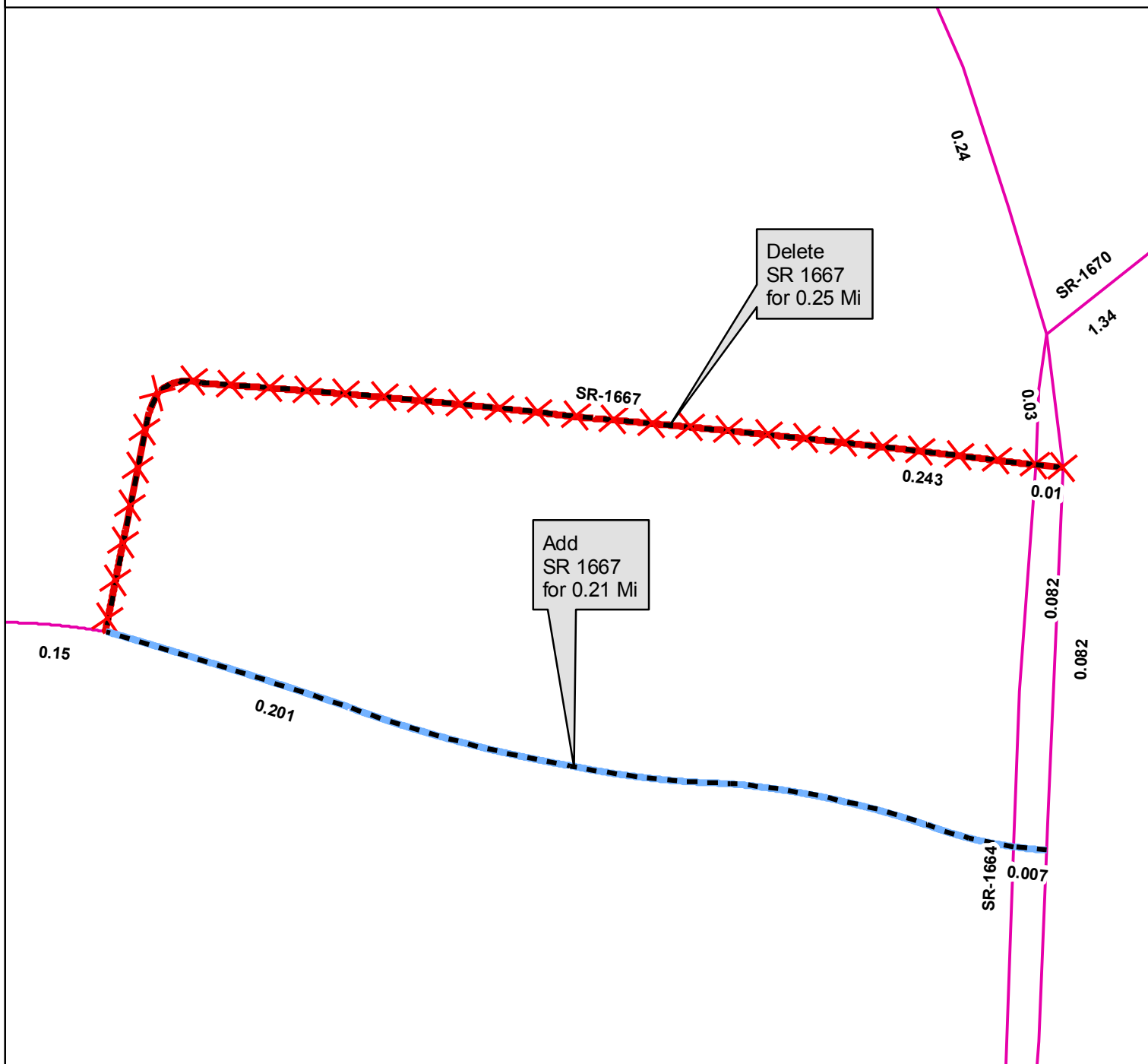

Delete
SR 1667
for 0.25 Mi

Add
SR 1667
for 0.21 Mi

Legend

- Addition
- Deletion
- Reassignment
- SR
- NC
- US
- Interstate
- Ramp

N
↑

