



STATE OF NORTH CAROLINA
DEPARTMENT OF TRANSPORTATION

ROY COOPER
GOVERNOR

J. ERIC BOYETTE
SECRETARY

DATE: June 29, 2021
TO: H.L. "Drew" Cox, PE
 Division Engineer
 Division 6
FROM: Erin Lesh, GISP
 Supervisor, Spatial Data Operations Group
 Geographic Information Systems Unit
SUBJECT: 2021 District 2 Road System Changes **- REVISED**

The GIS Unit's Spatial Data Operations Group has been authorized to make the changes indicated below to the state road system. We request that you update the related maps and files in your offices and install appropriate road number signs, if necessary. If our system changes do not conform to the actual conditions in the field, please return this memorandum with recommendations.

Document Number	County	Approval Date
R-2230A	CUMBERLAND	04/03/1999

Questions or comments about changes should be referred to the GIS Help Desk at GISHelp@ncdot.gov.

Thank you for your assistance.

EAL

cc: BSIP
 Bridge Maintenance
 Division Right of Way
 IMG
 Pavement Management
 Permit Unit
 State Road Maintenance
 Traffic Engineering
 Traffic Surveys

MAILING ADDRESS:
 NC DEPARTMENT OF TRANSPORTATION
 GEOGRAPHIC INFORMATION SYSTEMS UNIT
 1521 MAIL SERVICE CENTER
 RALEIGH, NC 27699-1521

Telephone: (919) 707-2165
 FAX: 919-707-2210
 Customer Service: 1-877-368-4968
 Website: www.ncdot.gov

LOCATION:
 4101 CAPITAL BLVD.
 RALEIGH, NC 27604

2021 Road System Changes

TIP Name: R-2230A
Date: 04/03/1999
County: CUMBERLAND

Additions

Route	Street Name	Mileage	Map
SR 4414		0.02	B

Deletions

Route	Street Name	Mileage	Map
SR 1451		0.08	B
SR 1601		0.02	A

Reassignments

Existing Route	New Route	Street Name	Mileage	Map
SR 1451	SR 4414		0.1	B
SR 2598	SR 1451		0.07	B
SR 2597	SR 1601		0.04	A
SR 1601	SR 2597		0.08	A

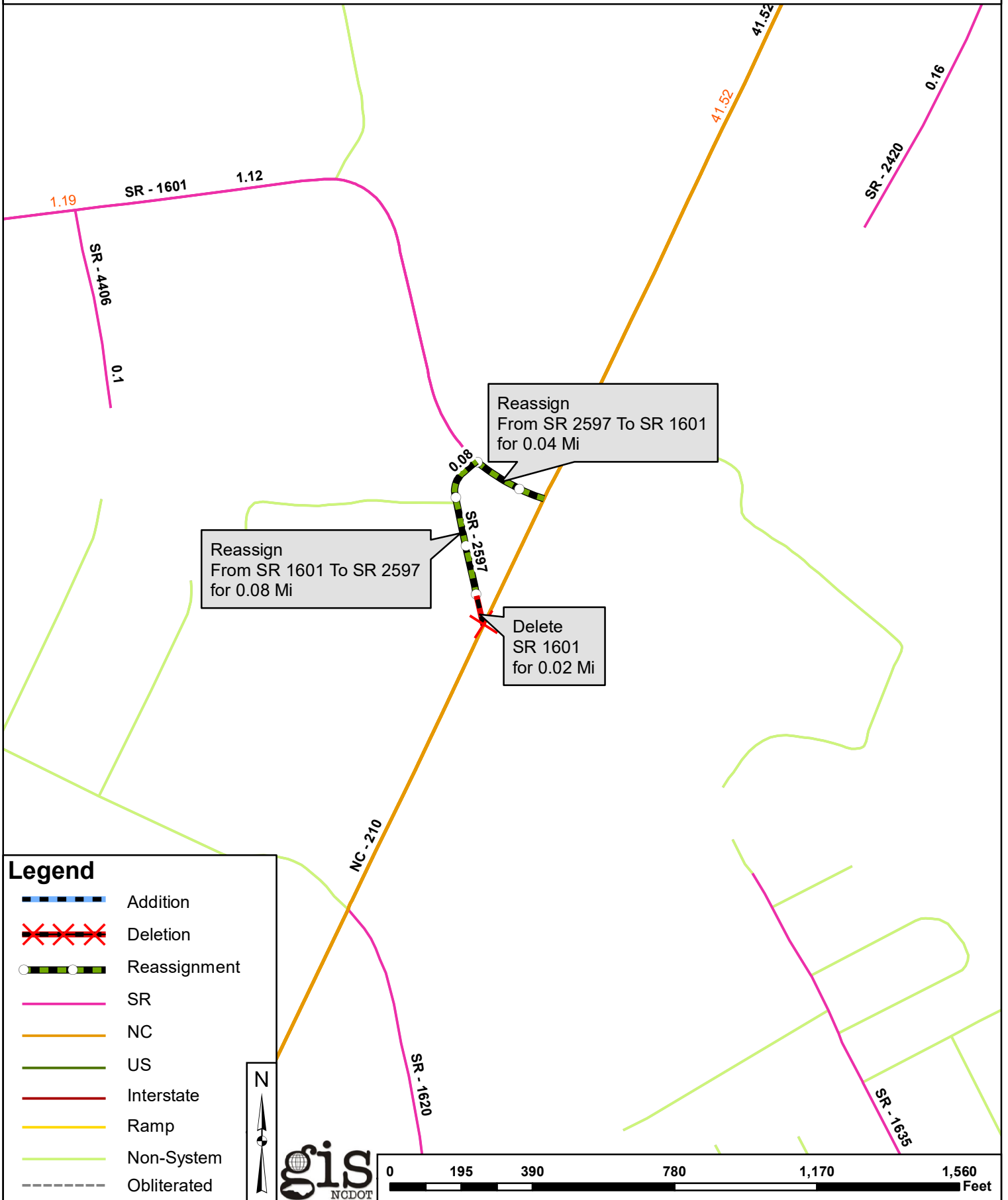

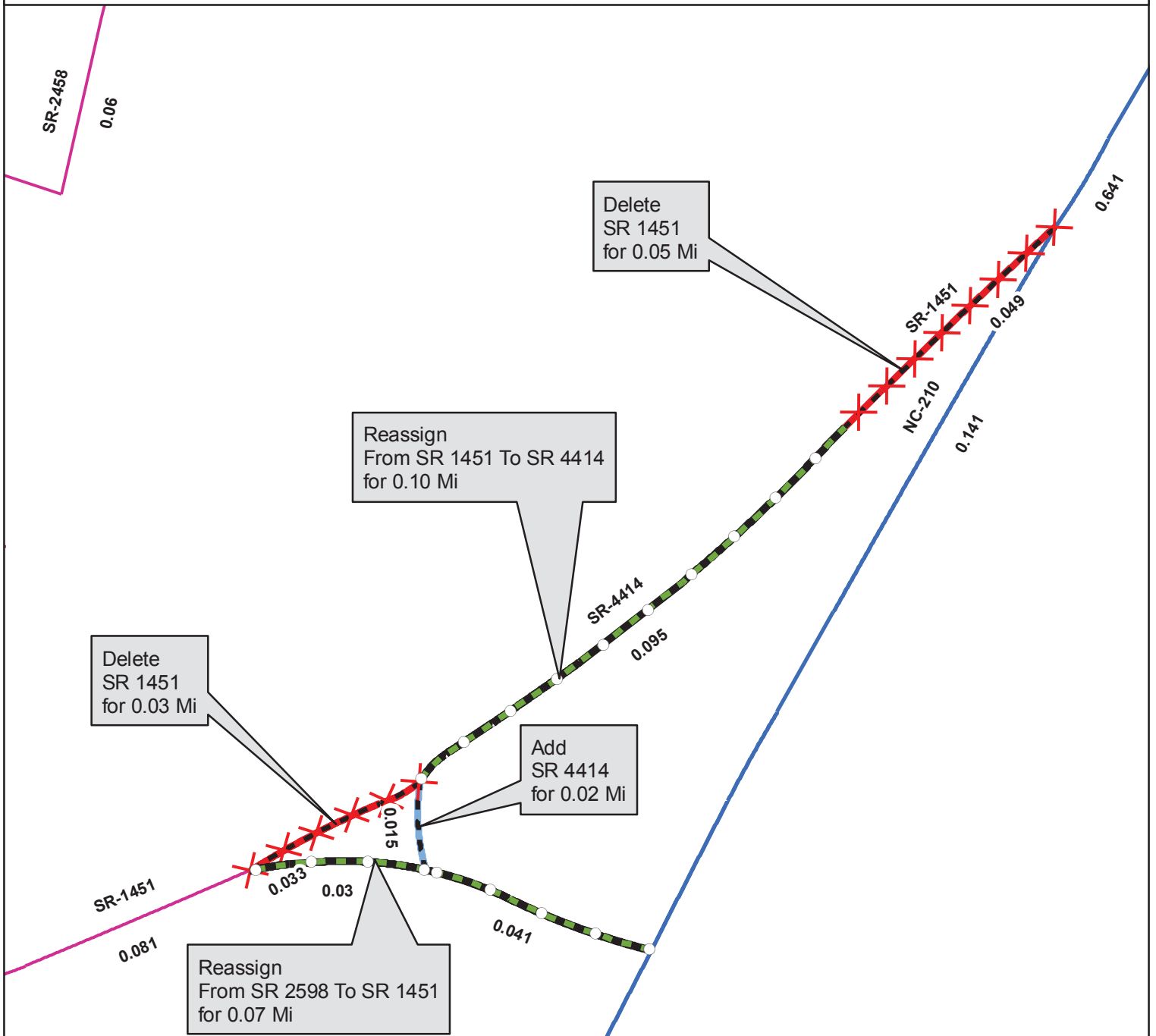

Legend

-  Addition
-  Deletion
-  Reassignment
-  SR
-  NC
-  US
-  Interstate
-  Ramp

