



STATE OF NORTH CAROLINA
DEPARTMENT OF TRANSPORTATION

BEVERLY EAVES PERDUE
GOVERNOR

Tuesday, October 16, 2012

EUGENE A. CONTI, JR
SECRETARY

MEMORANDUM TO: Mr. J. B. (Joel) Setzer, P.E.
Division Engineer
Division 14

FROM: John C. Farley, Manager
Geographic Information Systems Unit

SUBJECT: 2012 District 2 Road System Changes

The Data Conversion Group has been authorized to make the following changes to the state road system as indicated below. We request that you make similar changes to the related maps and files in your Division and District offices, and install appropriate road number signs if necessary. we have updated our records accordingly. If our system changes do not conform to the actual conditions in the field, please return this memorandum with recommendations.

LRS Change	County	Approval Date
LRS_5629_10-12	HAYWOOD	2/18/1999

Inquiries about changes should be referred to the GIS Help Desk at (919) 707-2152.
Thank you for your assistance.

JCF

- cc: BSIP
- Bridge Maintenance
- Division Right of Way
- IMG
- Pavement Management
- Permit Unit
- State Road Maintenance
- Traffic Engineering
- Traffic Surveys

MAILING ADDRESS:
NC DEPARTMENT OF TRANSPORTATION
GEOGRAPHIC INFORMATION SYSTEMS
1521 MAIL SERVICE CENTER
RALEIGH NC 27699-1521



Delivery Address:
41 01 CAPITAL BLVD.
RALEIGH, NC 27604
PHONE: (919) 707-2152
FAX: (919) 707-2214

2012 ROAD SYSTEM CHANGES

LRS	COUNTY	APPROVAL DATE	NEW ROUTE	EXISTING ROUTE	STREET NAME	LENGTH (miles)	TYPE OF CHANGE	REMARKS (See Attached Map)
LRS_5629_10-12	HAYWOOD	2/18/1999	SR 1272	SR 1147		0.43	REASSIGNMENT VIA LRS CHANGE	MAP , SEGMENT
LRS_5629_10-12	HAYWOOD	2/18/1999	SR 1272			0.31	SYSTEM ADDITION - NEW VIA LRS CHANGE	MAP , SEGMENT
LRS_5629_10-12	HAYWOOD	2/18/1999		SR 1147		0.11	SYSTEM DELETION VIA LRS CHANGE	MAP , SEGMENT

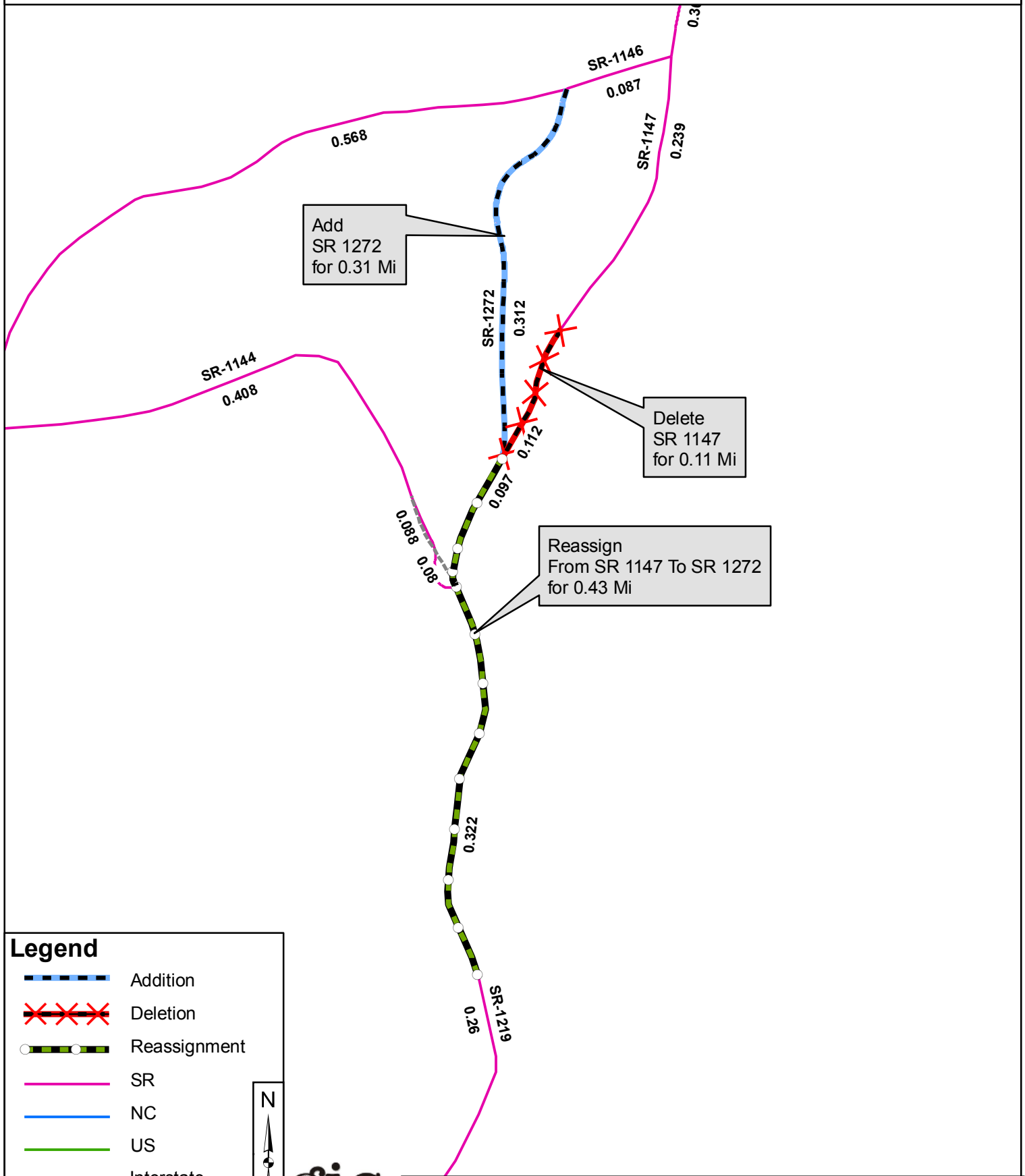









Add
SR 1272
for 0.31 Mi

Delete
SR 1147
for 0.11 Mi

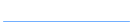
Reassign
From SR 1147 To SR 1272
for 0.43 Mi

Legend

-  Addition
-  Deletion
-  Reassignment
-  SR
-  NC
-  US
-  Interstate
-  Ramp

